

## **MACHINING OF 250 KGS.BOMB BODY AS PER DRAWING NO. ARDE 9501-01**

### **SPECIFICATION –**

MACHINING OF 250 KGS. BOMB BODY AS PER DRAWING NO. ARDE 9501-01, SPECIAL TERM AND CONDITIONS FOR THE MACHINING OF 250 KGS AERIAL BOMB BODY (OUT SIDE GIF PREMISES) AS PER ANNEXURE – A & OTHER IMPORTANT TERMS & CONDITIONS ALSO INCORPORATED IN THE CUSTOM BID ON GEM PORTAL AS PER ANNEXURE – B

## Other Important Terms &amp; Conditions also incorporated in the custom bid on GeM portal.

No.	Term	Decision
1	Item Code & Item Descriptions	1002000017 (MACHINING OF 250 KGS.BOMB BODY)
2	Item Specification	MACHINING OF 250 KGS.BOMB BODY AS PER DRAWING NO.ARDE 9501-0 1.OTHER TERM & CONDITIONS AS PER ANNEXURE"A" ENCLOSED
3	Qty.	50 Nos
4	Type of TE	SDOTE (Source developed General Open Tender)
5	Eligibility criteria	<p>1) Though Tender is floated on GeM being SDOTE, Firms have to register themselves with GIF on Vendor registration portal of OFB as per the procedure given below in point no. 2</p> <p>2) Firms should apply for registration at the link for online vendor registration at "http://ofb.gov.in/vendor" and submit VRRF((Vendor Registration request forms) in Online mode only before closing date of submission of bid floated on GeM portal with supported <b>by all the relevant documents (viz. Details of Plant and Machinery, Manufacturing Capability, test equipments, Details of manpower, Manufacturing process of above item, Experience of Supplies, Balance Sheet &amp; Profit Loss statements, Income Tax Return of last three years, Registration with sister Ordnance Factories, NSIC, DGS&amp;D etc.) also submit Initial Assessment Fee</b> :-As per existing guidelines, Initial Assessment Fee must be submitted by the participant firms <b>(which do not have any valid registration certificate for same/similar item in GIF, Jabalpur )</b> during submission of VRRF (Vendor Registration request forms) on OFB online vendor registration portal i.e. "http://ofb.gov.in/vendor" as below:  For Large Scale Industries: Rs. 10000/- (Rupees Ten Thousand Only)  For Medium Scale Industries: Rs. 5000/- (Rupees Five Thousand Only)  For Small Scale Industries: Rs. 3000/- (Rupees three Thousand Only)  For micro scale industries Rs. 2000/- (Rupees Two Thousand Only)  <b>Initial Assessment Fee to be paid through payment Gateway online. Offline mode of payment will not be acceptable.</b>  Assessment of participant firm will be carried out only after receipt of Initial Assessment Fee and if required, it will be followed by Capacity Verification based on documents submitted firm for finalization of registration. Hence, participant firms are requested to transmit /submit Fee, between date of publication of advertisement &amp; bid submission closing date. after submission of the requisite fee the details of NEFT/RTGS &amp; Date is to be filled at the time of filing of online VRRF as per details mentioned on OFB Online Vendor Registration Portal i.e. "http://ofb.gov.in/vendor" and proof of fee transfer details also to be attached while submitting their offer against above bid in GeM portal. It may be noted that initial Assessment fee is non refundable please. <b>Also noted that if vendor submits VRRF (Vendor Registration request forms) after due date of bid submission closing date it will not be considered for instant bid.</b></p> <p>3) Bidder Annual Turnover should be 1/3 of estimated value as per GeM  4) Since this is SDOTE case, hence there is no requirement of Experience criteria as defined in point no. 2.</p>
6	No of Bids	Two Bid
7	EMD (Bid security declaration as per OFB L/No.14//Policy/MM(P&C), Dt. 17.11.2020)	Bid security declaration will be applicable(Bidder should comply that if they withdraw or modify their bids during the period of validity, or if they are awarded the contract or they fail to sign the contract, or to submit a performance security before the deadline defined in the request for bid document, they will be suspended for the period of one year in GIF form being eligible to submit bids for contracts)
8	Option Clause	25%
9	Delivery Period	120 Days
10	Pre-Contract Integrity Clause	Not applicable
11	Inspection Type	Inspection of the Stores will be carried out at GIF, Jabalpur
12	Scope of Work	As per Annexure-A
13	Inspection Authority	GM/GIF
14	Inspection Officer	Authorized representative of GM/GIF
15	Price Variation Clause	Not applicable
16	Distribution of TE Qty	Not applicable
17	Conflict of Interest Clause	Applicable
18	Effective date of contract	From the placement of supply order
19	Specification/ Drawing/ QAP attached or not	Drawing & QAP attached
20	Warranty clause as per specification	Applicable for 1 year
21	Contract termination clause	Applicable
22	Product support clause	Applicable
23	Earliest year of manufacture clause	Not applicable
24	Payment Term	As per The standard payment terms shall be 100% payment against Seller's bill by Account transfer through NEFT/RTGS only for accepted materials within 30 days from the date of receipt of material or submission of bills/documents, whichever is later
25	Performance Security Deposit	Applicable
26	Material Security Deposit	Rs. 3.5 Lakhs for each casting (Firm should submit the MSD for those no. of bombs only which Firm want to lift from GIF before lifting of casting)
27	Validity of offer	90 Days
28	Quantity & weighbridge tolerance clause	Not Applicable
29	Tender opening date	21 Days from publication

SPECIAL TERM AND CONDITIONS FOR THE MACHINING OF 250 Kgs. AERIAL BOMB BODY  
(OUT SIDE GIF PREMISES)

1. These term and conditions are restricted for machining of 250 kgs. Aerial Bomb Body to be carried out in the firm's premises as per Drg No. ARDE 9501-01.
2. GIF will issue castings as per drawing no. GIF 70-5397. Transportation of casting from GIF and delivering back the machined bomb bodies to GIF shall be completely firms responsibility (Including loading and unloading at both ends)
3. To qualify for technical suitability in two bid system, the firm must have following machines and other infrastructure capable of undertaking above said machining. Please note that the infrastructure shown below is bare minimum requirement for capability demonstration and it is not the complot set of machines required for undertaking the said job.
  - (i) Suitable overhead crane/material handling arrangement capable of handling the bomb body.
  - (ii) Conventional lathe capable of roughOD turning of the casting.
  - (iii) At least two CNC lathe out of which one is capable of undertaking ID operation (i.e. I.D. turning of the bomb body as per machining Drg No. ARDE 9501-01.
  - (iv) CNC Horizontal machining centre capable of tail end (large dia of the bomb body) side operations.
  - (v) Suitable drilling/milling machine for undertaking bomb body drilling operation for lug welding.
4. The firms claiming to have above said facilities shall be subjected to capacity verification by GIF team whose decision regarding suitability/capacity of the machine and the infrastructure shall be final.
5. Apart from others, the supply order execution shall governed by the following terms and conditions-
  - A) Minimum 06 nos. of castings shall be provided at a time.
  - B) Casting having blow holes less than 12 nos. can be rectified by welding subject to depth of blow hole less than  $1/3^{rd}$  of the wall thickness and diameter less than 12 mm shall be rectified by the firm keeping in mind that the density of leaky holes shall not be more than 04 holes within a radius of 25 mm and holes shall be not touching each other by the electrodes of nearly same chemical composition of the bomb body casting.
  - C) After welding, the area of the blow holes will be grinded & machined to match the adjacent surface. Castings having more blow holes or greater depth of blowholes will be returned without rectification as bad material.

- D) The casting found defective during machining (for which machining could not be completed) due to casting defects (as mentioned in point no.-4(B)) are to be returned to GIF as bad material (BM). Firm will not be entitled to claim any machining charges for the rejected & defective casting during machining. Replacement of such bad material will be provided by GIF without any cost implication on either side.
- E) For the machined bomb bodies rejected at GIF due to machining defects such as castings having tool marks, chattering marks, dimensions not as per drawing etc. The firm will not be paid for the machining charges upto 1% rejection. Beyond 1% rejection, apart from not providing machining charges, cost of the bomb body casting will also be recovered from the firm bills.
- F) The cause for the rejection of machined casting (whether it is due to machining defects or casting defects) will be decided by GIF.
- G) The machined bomb body rejected due to inherent casting defects like cracks, pin holes etc, but accepted in respect of all machining dimensions, the firm will be paid for machining of that casting.
- H) The steel swarf/scrap generated during machining of the castings will be retained by the firm and only finished machined castings are to be supplied back to GIF. Accordingly, the firm will quote the rate for machining of casting after adjusting the value of swarf/scrap.
- I) The machined casting should be returned back to GIF within a period of two weeks from the date of receiving the castings at firm's premises. In case of delay on the part of the firm resulting into production discontinuity at GIF, as a matter of penalty, a token amount @ Rs.100/- per casting per day shall be charged.
- J) The firm will be issued Job completion certificate every month by the user section for the machined castings after final acceptance by AQAW (A) in GIF against which the firm can raise bill for claiming payment.
6. Firm has to prove its machining capability by machining one casting on No cost- No commitment (NC-NC) basis. The firm has to lift the casting by submitting the material security deposit (MSD) as asked by Material Management Group (MMG), which should be submitted after order placement.

WM/GSK

JWM/MS

Jt. GM/TBD

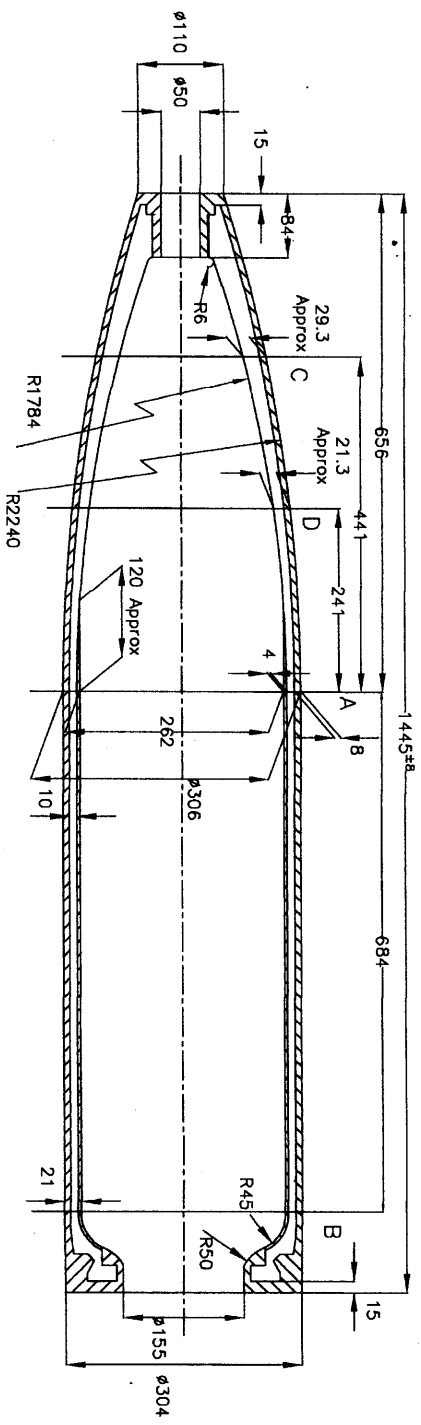

\* Chemical Composition (Percentage)

- C-0.28 to 0.33
- Si-0.30 Max
- Mn-1.3 to 1.50
- S&P-0.03 Max Each
- Ni-0.75 to 1.25
- Cr-0.60 to 1.00
- Mo-0.35 to 0.55

Mechanical Properties

- (a) UTS-100Kgf/mm<sup>2</sup> Min.
- (b) Y.S.-85 Kgf/mm<sup>2</sup> Min.
- (c) Elongation-14% Min
- (d) IZOD Value-3.00m Kgf (Min.)
- (e) Hardness-300-340 BHN

NOTE :-  
 1. Casting Tolerance as per IS 4897  
 Class-2(Hand Moulding)  
 2. For Casting Drg without Internal  
 Machining Refer Drg No.70-5308.

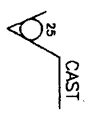

DATE	NO.	DETAIL	AUTH.	ITEM	DETAIL	WT.	MATR.	QTY.	REMARKS
VEH.				M/C					
TITLE				CASTING FOR 250 KG BOMB BODY					
(REF DRG. NO OFM:10057)									
DRG. NO.				70-5397					
SCALE				1 : 1					
DRAWN		15 APRIL		S K V					
CHECK		11 JULY		SKP					
APPR.		11 JULY		SKP					
YEAR		19		DATE					
NAME									
DRG. NO.				70-5397					
SHT. 1				TOTAL SHTS. 1					



GREY IRON FOUNDRY JABALPUR



DRAWING CONVENTIONS CONFORM TO IS:   
 DIMNS ARE IN mm. UNLESS OTHERWISE STATED   
 GEN. TOL MEDIUM CLASS TO IS: 2102

DRG No. ARDE 9501-01

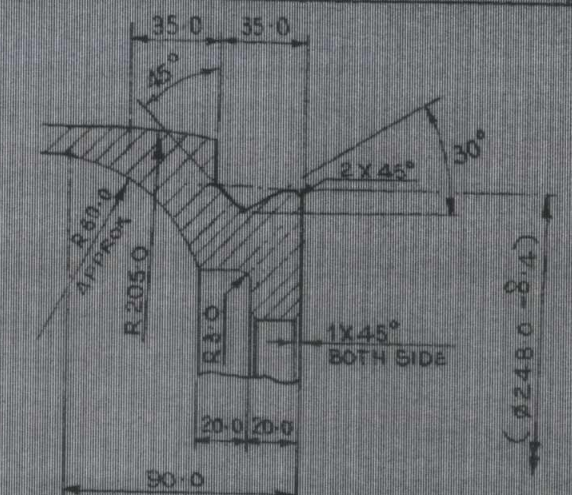
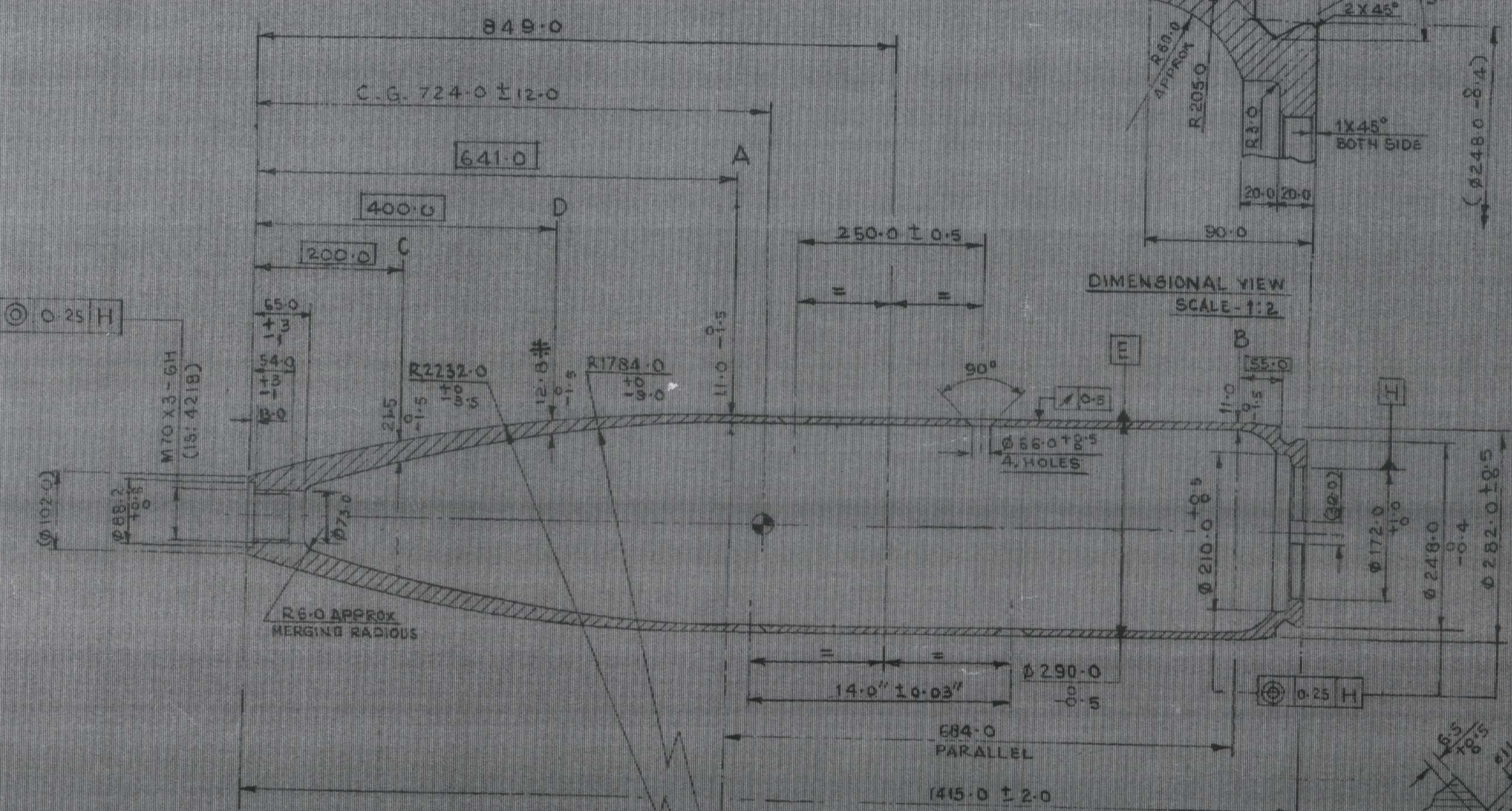

MECHANICAL PROPERTIES:—  
 a) UTS — 100 Kg/mm<sup>2</sup> (MIN)  
 b) YS — 85 Kg/mm<sup>2</sup> (MIN)  
 c) ELONGATION — 14% (MIN)  
 d) IZOD VALUE — 5 m kgf (MIN)  
 e) HARDNESS — HB 300 TO 340

ARDE PUNE-411 021  
 DESIGN AUTHORITY  
 DATE 15-5-24

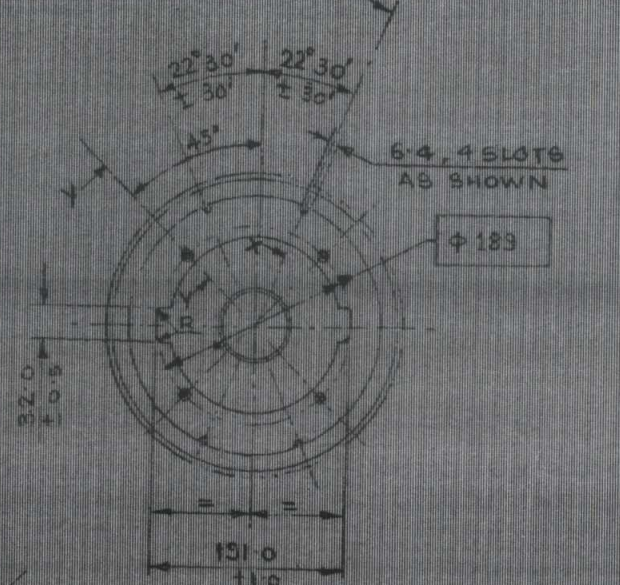

NOTES:-

1. ALL SHARP EDGES AND BURRS ARE TO BE REMOVED.
2. SCREW THREADS RUNOUTS & UNDERCUTS TO BE IN ACCORDANCE WITH SPEC 15 1369
3. DIMENSIONS ARE APPLICABLE AFTER HEAT TREATMENT AND MACHINING.
4. WALL THICKNESS IS TO BE MEASURED AT POSITIONS A, B, C & D AT FOUR POINTS CIRCUMFERENTIALLY 90° APART & LYING IN SAME LONGITUDINAL LINE OF THE BODY.

PROTECTIVE FINISH:- THE INTERNAL SURFACE IS TO BE COATED WITH VARNISH SUITING AMMUNITION TO SPEC. JSS 800-28 CAPC 2 11 GRADE 1 SPECIAL

SURFACE FINISH - 6.3 INSIDE 6.3 OUTSIDE

\* WALL THICKNESS IS REQUIRED TO BE MAINTAINED BY VARYING THE INTERNAL AND EXTERNAL RADIUS.

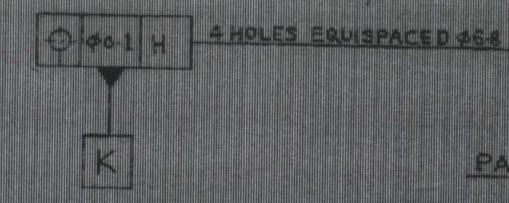

PART SECTION 'YY' SCALE-1:2

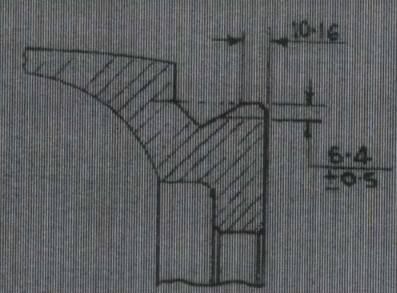

PART SECTION 'XX' SCALE-1:2

DRN	CHK	TRD	COMP	ASSY ORG	ARDE 9501-01/2
ED	ASST	SCALE	E/S	DESIGN AUTHORITY	
APPROVED		EST. WASH. 1103 5K4		ARDE PUNE-411 021	
DATE	15-5-24	DATE	15-5-24		
MATL.	STEEL TO IS 507 DR 17 90.9				
DRG NO.	ARDE 9501-01				
DET. NO.	1/2				
PART NO.					

BOMB BODY



**Format of Bid security declaration certificate submitted by the bidders in their letter head**

**“BID SECURITY DECLARATION AGAINST EMD”**

I/We, M/s....., address.....,  
have participated in tender issued by Grey Iron Foundry Jabalpur, Tender ID....., Tender  
Reference No....., Tender Description.....  
....., Tender Publication Date.....I/We hereby declare(s) that “In  
case I/We, withdraw(s) or modify(s) my/our bids during period of validity etc., I/We  
M/s....., address.....,  
agree to be suspended for the period of 1 year in GIF.

Date:-

Seal & signature of Proprietor