

29/40

SIZE	ZONE	REF. No	PART No	NOMENCLATURE	Qty	REMARKS
				DOCUMENTS		
			2A46 . C5 21-16 C5 ✓	ASSEMBLY DRAWING		
				ASSEMBLY UNITS		
		4				
		1	2A20 . C5 21-17	CONTACT PLATE	1	Part list mentioned in drawing
				COMPONENTS		
		2	2A46 . 21-46 ✓	SLIDER	1	
		3	2A20 . 21-50 ✓	COVER PLATE	1	
		4	2A20 . 21-53 ✓	THRUST PLATE	1	
				STANDARD ARTICLES		
		5		WASHER 6.01.06	1	COATING: CHEMICAL PHOSPHATING, CHROMIUM, OIL FINISHED
				GOST 6958-79		
		6		SCREW BМ6 - 89, x16.66		COATING, CHEMICAL PHOSPHATING, CHROMIUM, OIL FINISHED
				GOST 1491.80		

16313-W SCH. SEALED PROV. 22-4-85

16707-W PROV. SEALING 6-12-88 CANCELLED

SIGNATURE AND DATE

DUPLICATE INVENTORY No.

ORIGINAL INVENTORY No.

SIGNATURE AND DATE

174-97-W 28-12-92 | SCH SEALED PROV. | KGVCS / CJD

2A46 . C5 21-16 (63)

DESIGNER	CHECKED BY	CHIEF OF OSN. DEPARTMENT	INSPECTOR	APPROVED
	<i>[Signature]</i>			<i>[Signature]</i>

CONTACT SLIDER

LETTER	SHEET	No. OF SHEET
	1	2
CQA(W)		
JABALPUR		

2446 C8 21-16 C8
A0653-81

FIRST ANGLE PROJECTION

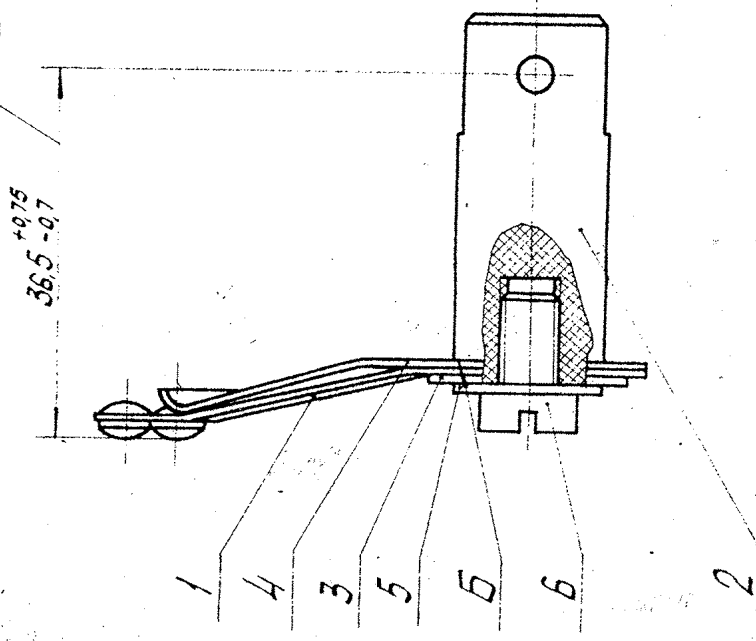

1. Dimension A is to be ensured by selection of thrust plates 4 or fitting of surface 5 of slider 2.
3. Mark the index of the article and part number, ~~on the part.~~
4. * Dimension for reference.
2. Apply compound (item 7) to set bolt 6.

1. Размер А обеспечивать подбором пластин упорных поз. 4 или припилькой поверхности 5 ползуна поз. 2.
2. Для сборки резьбы винта поз. 6 покрыть клеем поз. 7.
3. Маркировать индекс изделия и обозначение детали на бурке.
4. * Размер для справок.
5. Установку винта поз. 6 производить на компаунде поз. 7.

सिवाय त्रुटि नस्य
CERTIFIED CORRECT COPY OF
शुद्ध चित्रण अथवा
SEALED DRAWING AS OR
आवश्यकता अनुसार
FOR CONTROLLER OF QUALITY
आवश्यकता अनुसार (50 अथवा 500) अंशित अथवा
ASSURANCE (AVA) AVADI, CHEVNAI 54

18814-W	HINDI NOMEN	DRG
22-10-03	ADDED	DRG
174-97-W	DRG SEALED PROV.	195482 CID
28-12-92		
16707-W	PROV. SEALING	
6-12-86	CANCELLED	
16313-W	DRG SEALED PROV	
22-4-85		

OS CAT No. 5325-008819		2446 C8 21-16 C8	
ISSUE DATE	OS CAT No. ADDED	SCALE	SCALE
27/04/84	24/06/84	10:1	0-023 2:1
APPROVED	REFERENCE	CONTACT SLIDER	
CHECKED		Assembley drawing	
DRAWN		MATERIAL.	
C.Q.A (AVA) AVAD			

6 138 1382

21-50

89676-V

▽1 остальное

FIRST ANGLE PROJECTION

▽1 unless otherwise specified.

ALT. MATL:—

SHEET TO IS: 1079-86 GDE Fe 410 OR BS:1449

Plt I: 83 GDE 22 HS

*

РАЗМЕРЫЕ ВОСПЕЧАТАТЬ

19707-W PROV. SEALING
6-12-88 CANCELLED

17068-W PROV SEALING CANCELLED &
c10 7-5-91 DRG SEALED

18010-W ALT MATL AMENDED.
30-7-94

19913-W DRG SEALED PROV
22-4-85

DS CAT No. ADDED.
19.12.06

17633-W ALT MATL & PHOSPHATING
29-5-93 NOTE ADDED.

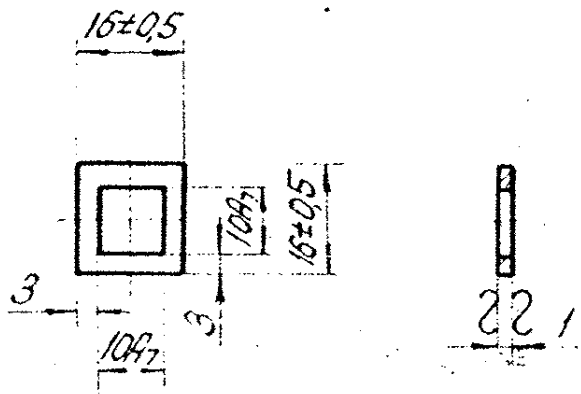

1. Sheet 5 -1 GOST 19903-74.
2. Internal angles $R \approx 0.4\text{mm}$.
3. Blunt sharp edges, $R \approx 0.6\text{mm}$,
4. Coating: Chemical phosphating, chromium, oil finished.

* COATING:— PHOSPHATING TO JSS: 0465-01 CLASS II, FINISH 13 (g)

DS CAT No. 5310-239541

8 10

2-17497-W 28-12-92 DRG SEALED PROV. 17497-W 28-12-92 DRG SEALED PROV. 16523-70

174-97-W 28-12-92	DRG SEALED PROV.	2A20
94 WASHER		21-50 78
		SHEET MASS SCALE 1 of 1 0.0013 1:1
ISSUE DATE REFERENCE		
APPROVED <i>[Signature]</i> 22/1/84	MATERIAL:	C.Q.A(AVA)AVADI
CHECKED <i>[Signature]</i> 21/1/84	STEEL 25 cm 3 cm	
DRAWN <i>[Signature]</i> 21/1/84	GOST 16523-70	

16313-W DRG SEALED PROV 22-4-85
 18010-W ALT MATL 30-7-94 AMENDE
 16707-W PROV SEALING 6-12-88 CANCELLED
 7-5-91 CANCELLED & DRG SEALED
 199VJ
 199VJ
 199VJ
 199VJ

РАСШИРЕНИЕ ВОСПРЕЖАТЕЛЯ

18607-W ALT MATL AMENDE
 2-1-2001

21-53



896V6-V

▽1 unless otherwise specified.

FIRST ANGLE PROJECTION

▽1 OCTАЛЬНОЕ

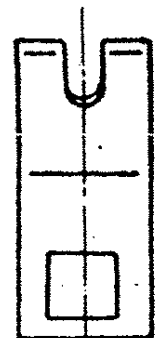

DEVELOPED VIEW
 Развертка

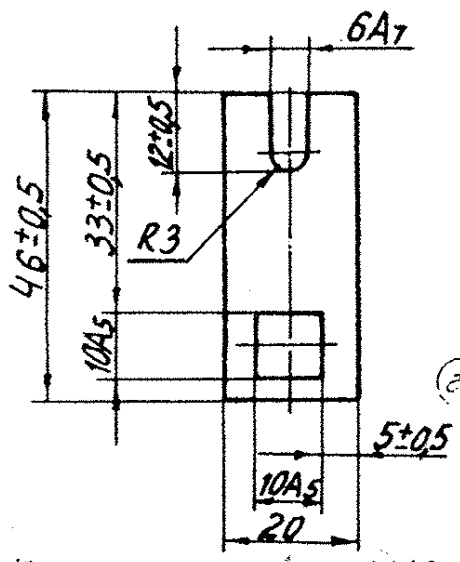
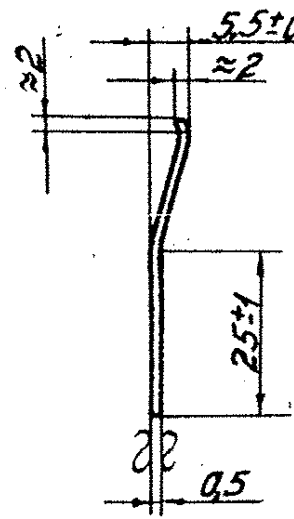

ALT MATL:- IS:2507-75 DESIGNATION 55
 Si 7 Gr 9 WITH S AND P RESTRICTED
 TO 0.35 EACH.

OR
 BS: 1449 (Pt-1)-83 SECTION 4 Gde 60
 CS (En 43 J)

HARDNESS:- TO BE HARDENED TO
 HRC 54-58.

COATING:- CHEMICAL PHOSPHATING
 TO ISS:0465-01 CLASS-II.

ADHESIVE WITH THE FOLLOWING
 REQUIREMENT:- SOLUTION OF
 POLYVINYLE ACETONE AND RESOL
 PHYNOL FORMALDEHYDE RESIN
 IN ALCOHAL.

- Strip 0.5 x 20 GOST 2263-69.
- Radu of bend $R \approx 1mm$
- Internal angles $R \approx 0.4mm$
- Blunt sharp edges, $R \approx 0.6mm$
- Harden. Hrc = 54-58, HS 73-76.
- Coating: chemical phosphating, hastened, chromium
 adhesive 6-4 OR 6-2 WITH nigrosine Black (3 layers)
- Technical Requirements as per H0 3607-61, GROUP 2.

DS CAT No. 9515-013955

17497-W DRG SEALED PROV. 28-12-92

2A20

0071-AVA 11-01-11	DS CAT NO. ADDED	X
17768-W 20-10-93	ALT MATL AMENDE	199VJ CIB
17717-W 14.9.93	ALT MATL & COAT- ING NCTE ADDED.	199VJ CIB
ISSUE	DATE	REFERENCE
APPROVED		22/10/92
CHECKED	B.G.V.	22/10/92
DRAWN	L.P. Thyagar	21/10/92

132
 THRUST PLATE

21-53

SHEET	MASS	SCALE
1 of 1	0.003	1:1

MATERIAL:
 STEEL 60 C2
 GOST 2283-69

C.Q.A(AVA)AVADI

КОМУ ОБЪЕКТУ: ТРОКОВ

УДОМЪТ 11

AR-3