

8

7

6

5

4

3

2

1

PART NO

DRG. CONVENTIONS CONFORM TO IS: 696.
DIMENSIONS ARE IN mm.



F D.C. 35324-A

2.5/ [✓]

NOTE :- 1* DIMNS. ARE ENSURED BY TOOL.
2** DIMN IS GIVEN FOR REFERENCE

COATING :- CHEMICAL PASSIVATION FOLLOWED
BY SHELLAC (4-7%) COAT.

INDIGENOUS MATERIAL :-

ALUMINIUM IS: 737-2008 DESGN.-19500. CONDN.'0'

SPECIFIED MATL :-

ALUMINIUM FOIL,
GRADE A5-M-0.12, GOST 618-73

56 C
D2040

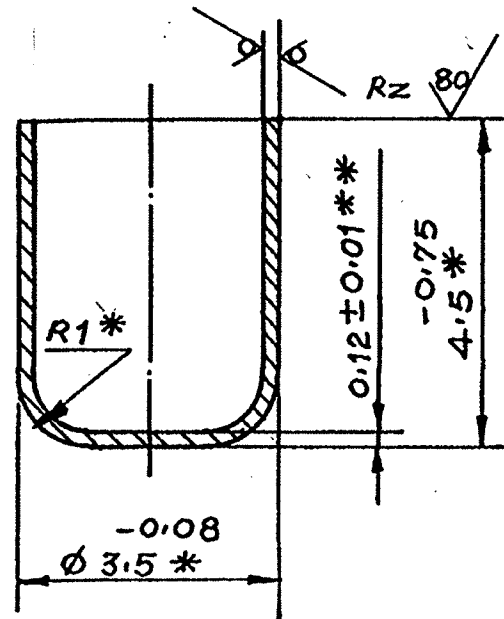

D

C

B

	05-01-2011	DGQA S.O. Sec. I Chap 10 para 40	Drg. scan, clean & edit without change 8. m/c replaced in supersession of existing dilapidated copy of same No.			
	08-11-10	DC. 37271-A	INDIGENOUS MATL UPDATED.			
	5-8-92		TRACED WITHOUT CHANGE.			
	18-5-92	D.C. 35324-A	DRG. PROV. SEALED.			
R NO	DATE	AUTHORITY	RIVISION	ZONE	AHSP D.O. SIG.	
DRG. SEALED :- 18-5-92						

DRN.	CHD.	TRD. ALP	COMP. ✓
SD/- C.D MAN	SD/- O.I/C.D.O.	SCALE :- 10:1	EST. MASS :- 0.014g
APPD.	SD/- FOR CQA(A)	GAUGE SCHD :-	DATE :- 10-4-92
MATL :- AS ABOVE			
PROTECTIVE FINISH :- AS ABOVE			

ASSY. DRG.

DESIGNER'S REF. CQA(A)/AMN/2859 DET. 1
PART NO
D.S. CAT. NO
AHSP :- CQA(A) KIRKEE

A

CAP I-1

(AS PER OCT B84-1558-78)