

1	2	3	4
JSS	C	V	∇∇
V 0 0 0	4 0 0	5 0	1 0
			2 0
			1 0
			1 0 1 2

DRG No.

GENERAL TOL. : FINE / MEDIUM / COARSE CLASS TO IS: 2102

DRG. CONVENTIONS CONFIRM TO INDIAN STANDARDS DIMENSIONS ARE IN mm UNLESS OTHERWISE STATED.

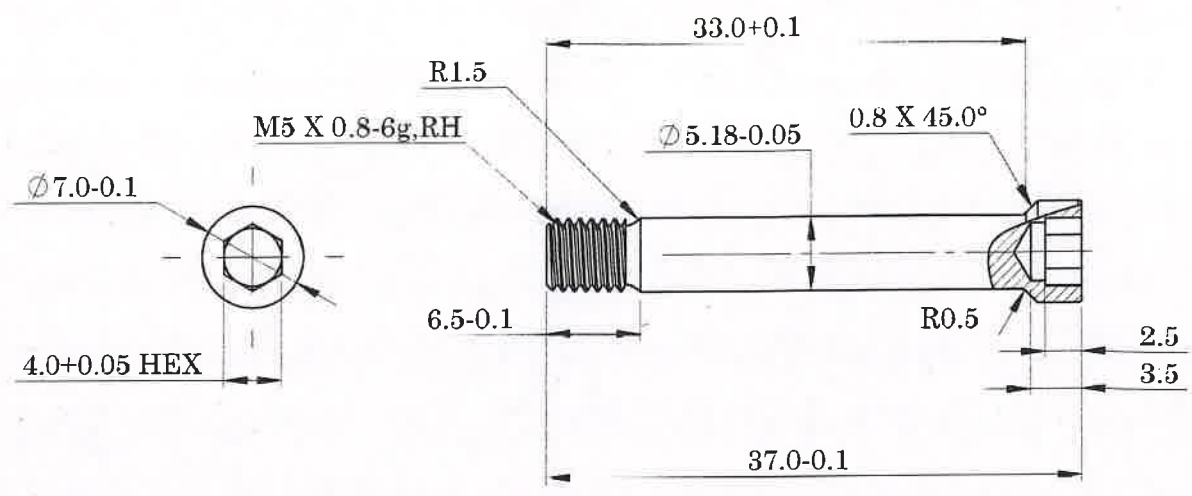

NOTE:

- 1.REMOVE ALL SHARP EDGES AND BURRS.
- 2.DIMENSIONS ARE TO BE READ AFTER APPLYING PROTECTIVE FINISH.
- 3.IF THE COMPONENT IS TO BE MANUFACTURED THROUGH MIM ROUTE, REFER ARDE SPECN No: DRDO-ARDE-MIM-TSP-051-2019.
- 4.HARDNESS BEFORE COATING: 350 TO 400 HV.
- 5.HEAT TREATMENT:- FERRITIC NITRO CARBURIZING AS PER SAE SPECIFICATION No. AMS 2753C
COATING HARDNESS : 600±100 HV.
COATING THICKNESS: 15 µm Min.
- 6.ALT. MATERIAL:- STEEL TO IS:5517-1993,Gd.40Ni6Cr4Mo3(EN-24)
- 7.SURFACE FINISH ∇∇ ALL OVER UNLESS OTHERWISE SPECIFIED.

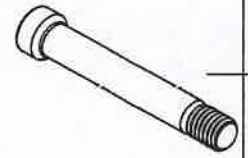

Sr. No.	DATE	AUTHORITY	BRIEF RECORD	ZONE	CD	GO
					SIGN	

DRN: SOURABH SIGN: DATE:24/08/2022	<i>Sourabh</i> CHECKED	MATERIAL: STEEL TO IS:5517-1993,Gd.42Cr4Mo2 COND 'T' (EN-19 'T')
APPD. DATE:24/08/2022	<i>Sourabh</i> FOR DIRECTOR	PROTECTIVE FINISH: SEE NOTE
SEALED DATE:		
SHEET SIZE: A4 SCALE: 2:1	EST. MASS 5.21 gm	TITLE: SCREW BARREL MOUNT
DESIGN AUTHORITY ARDE PUNE 411021		

DRG No.	2 1 0 1	0 1	0 2	0 1	0 5	0 0 4	0 0 D A
	IC	SS	S	AA	A	C	SST
9 mm	PART No.	DS CAT No.	AHSP				