

4
D S CAT No
5970-002812

3 2 1
FOR EXPLANATION OF DIMENSIONING ETC. SEE ARDE NOTE No 1
DIMENSIONS ARE IN mm

| | |
|-----------------|------------------|
| Ø 20.0 e 8 | -0.040 -0.073 |
| Ø 8.0 H8 | +0.022 0 |
| NOM. SIZE & FIT | DEVIATION |

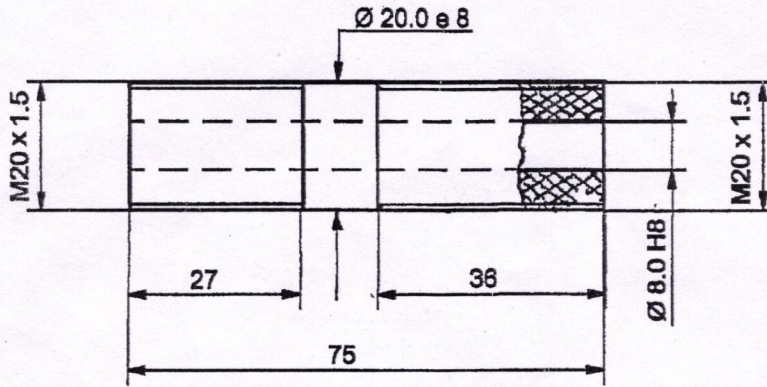

NOTE:-
THREADS CONFORM TO IS:4218
MATERIAL:- PHENOLIC LAMINATED SHEET GRADE F2 TO SPEC IS: 2036.



| | | | | | | | |
|---|------|------|------------|----------|--------|----------------------------|---------------|
| | | | | | | CQA(W) JABALPUR | |
| | | | | | | DRN | CHD |
| 30-8-06 18997-W | | | | | | SCANNED <i>Mukesh</i> | CHD <i>ew</i> |
| D.S.CAT. No. & NOMEN. AMENDED. | | | | | | APPROVED | AHSP |
| SCANMED & PRINTED WITHOUT CHANGE | | | | | | DO | FOR CQAW |
| DATE | AUTH | ZONE | AMENDMENTS | SIG AHSP | SIG DO | ASSY DRG. | |
| PREV DC Nos: 15961-W & 16095-W Dt 23-12-83 | | | | | | 5315-000987 | |
| DRG SEALED :- 16095-W, Dt 23-12-83 | | | | | | DESIGN No. D6P - 120302 | |
| SCALE 1:1 | | | ESTD MASS | DATE :- | | PART No. IFL 7077 | |
| MATERIAL :- AS ABOVE | | | | | | DS CAT No. 5970-002812 | |
| INSULATION SLEEVING ELECTRICAL इंसुलेशन स्लीविंग इलेक्ट्रिकल | | | | | | | |