

DRG. NO. 29 P 0047

DIMENSIONS ARE IN mm.
INFORMATION MARKED THUS 'T' TO BE MARKED ON
UNTOLERATED DIMENSIONS AS PER IS. 2102 (MEDIUM)

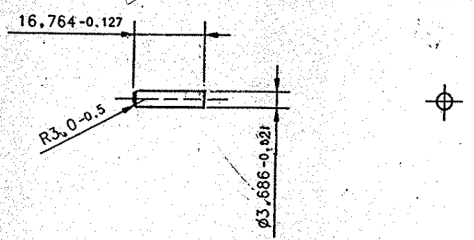

NOTE :- FOR EXPLANATION OF DIMENSION ETC
SEE D.D.NOTE SHT.No.3(LATEST ISSUE)

MATERIAL :- STEEL BS:1429 En 42 B OR STEEL BS: 1408 RANGE-1

PROTECTIVE FINISH :- PHOSPHATE TO SPECN. JSS 0465-01:1988
CLASS-I PAINT ~~RFU STOVING BLACK TO~~
SPECN.JSS.8010-37 MATT.FINISH

PART NO.	DESCRIPTIONS	NO OFF	MATERIAL	TREATMENT	REMARKS
----------	--------------	--------	----------	-----------	---------

DA.No.
8996/14/
DDO/01
29.5.09

SIGNATURE & DATE
 TRACED
 DRAWN
 CHECKED
 VOIC/D&DO V. Vallurthi
 PROD. OFFICER
 DIV.OFFICER D&DO
 SIG. & DATE
 APPROVED ON:

SUB: **PIN CATCH MAGAZINE**
 FOR:
 OF: **.315" SPORTING RIFLE**
 DES. REF. NO: **SP-47**
 DRG. NO: **29 P 0047 ***

SCALE
1:1
 STORE DRG. NO.
 OPERATION NO.
 SHEETS:
 SHEET NO:

FT **ORDNANCE FACTORY**
TIRUCHIRAPALLI-16.