

D:\NOMVA\RES\610-01-1205-1\Drawing.dwg

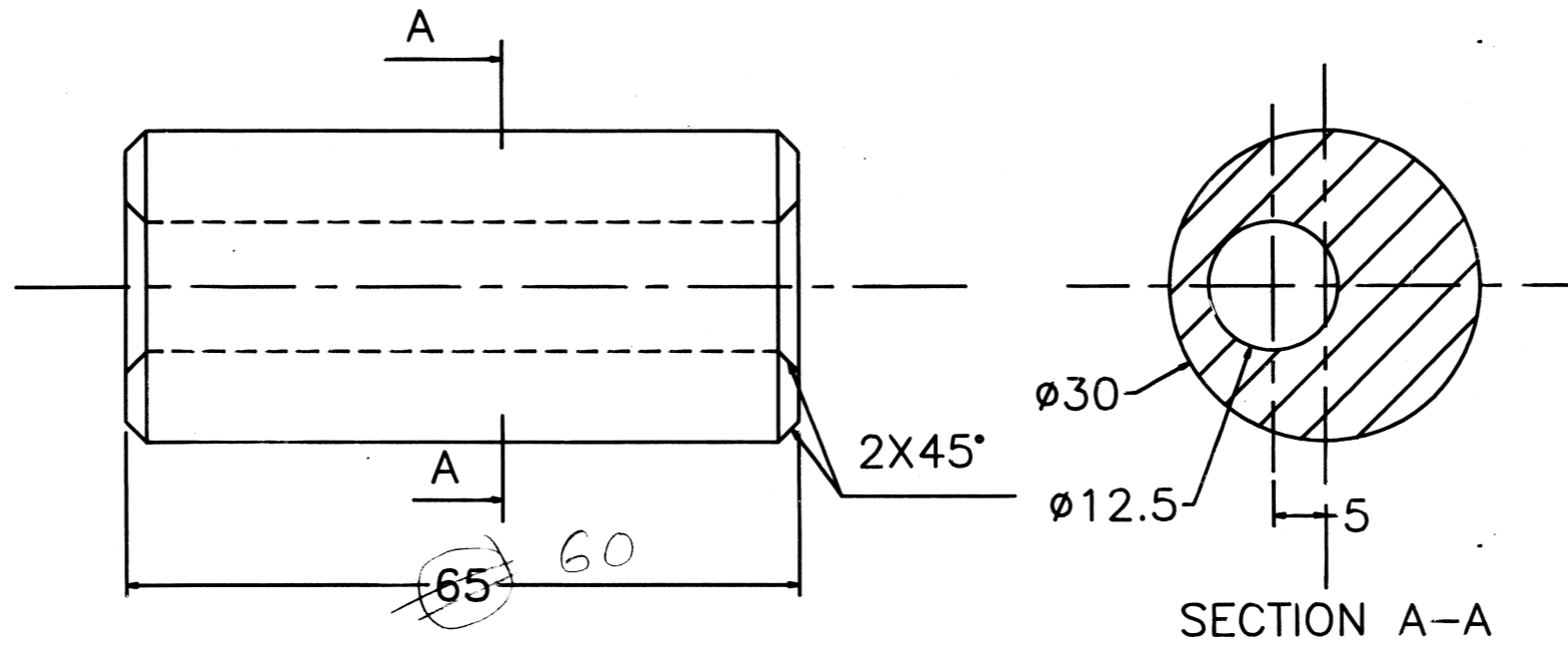

DESIGNER: \_\_\_\_\_  
 DEVELOPER: \_\_\_\_\_  
 DATE: \_\_\_\_\_  
 No. OF SHEETS: \_\_\_\_\_  
 NOS/RAT: \_\_\_\_\_

**NOTE:**

1. ALL DIMENSIONS ARE IN MM.
2. UNSPECIFIED LIMIT DEVIATIONS ARE  $\pm 1$ mm.
3. HOLE WILL BE IN OFF-SET AS SHOWN IN THE DWG.
4. MATERIAL: EN9. BS:970
- (B) 5. COATING: PHOSPHATING - 9microns

(C)	27/2/14	Diem 60 was 65	USED ON QTY/VEH	78
(B)	M. K. D.	Intern. Notes point No 4 & 5 are newly added	M.M.P.V	
(A)	19/6/12	1. FLAT MILLING REMOVED 2. HOLE OFF-SET BY 5mm IS ADDED		
ISSUE	APPRD.	NATURE OF AMENDMENT		
AUTHD B.YESU		DRG. NO: 610-01-1205-1/C		
APRD. M.S.P		SLEEVE (FOR GLASS MOUNTING)	SHEET NO	SCALE
CHKD. M.M.K.				WEIGHT
DRWN M.V.K.				
	NAME SIGN DATE			
ORDNANCE FACTORY MEDAK		MATERIAL:		
			THIRD ANGLE PROJECTION	