

DS CAT No  
5970-002173

DIMENSIONS ARE IN mm									

UNLESS OTHERWISE SPECIFIED

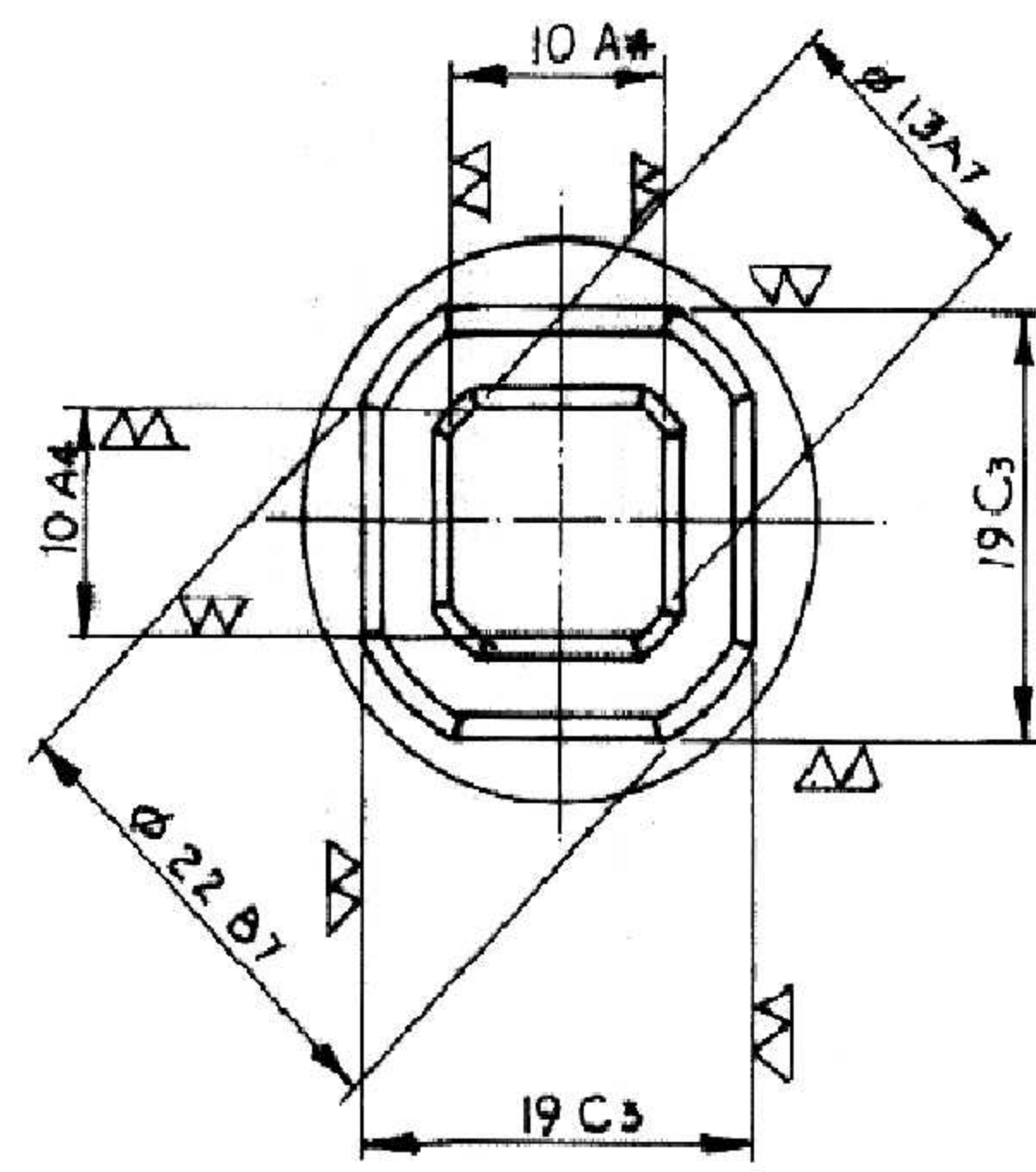
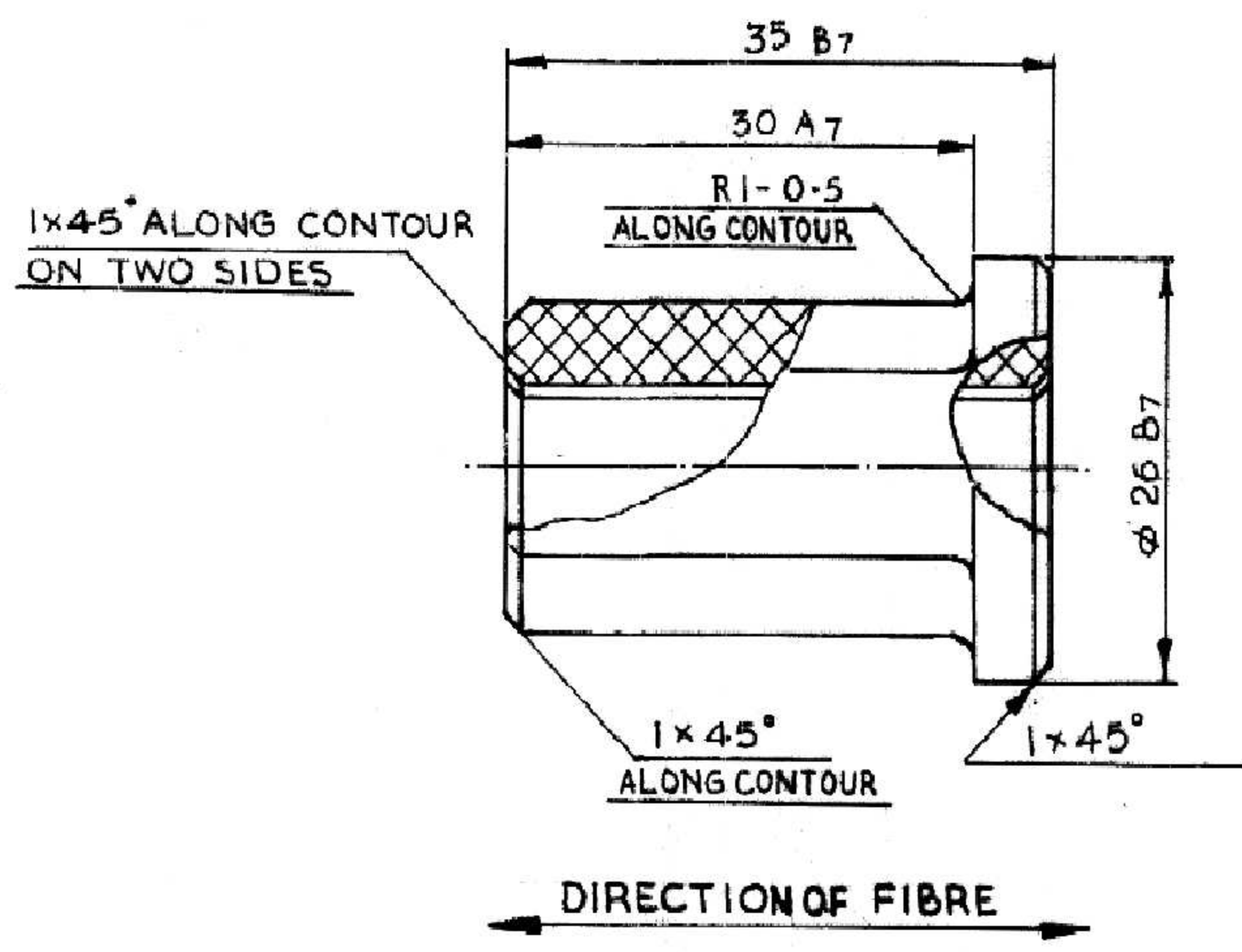

NOTES

- a. ALTERNATE MATL: PHENOLIC LAMINATED SHEET GRADE G-II TO SPEC. NEMALI-1-1977 OR AS PER JSS 1097. MATL IS MADE FROM SEVERAL LAYERS OF COTTON OR ASBESTOS CLOTH SOAKED IN THERMO-REACTIVE PHENOL FORMALDEHYDE/OTHER FORMALDEHYDES. THE MATERIAL MUST CONFIRM THE FOLLOWING REQUIREMENTS:-
- i) EVEN SMOOTH SURFACE WITHOUT FOREIGN INCLUSIONS.
  - ii) PERMISSIBLE SAG: 4 mm/m.
  - iii) DENSITY 1.3 TO 1.4 g/cm<sup>3</sup>.
  - iv) SHEARING STRESS AT RUPTURE: 147 MPa MINIMUM.
  - v) TENSILE STRENGTH AT RUPTURE: 98 MPa MINIMUM.
  - vi) COMPRESSION STRESS AT RUPTURE
    - a) PARALLEL TO LAYER: 152 MPa MIN.
    - b) PERPENDICULAR TO LAYER: 250 MPa MIN.
  - vii) IMPACT STRENGTH KJ/M<sup>2</sup>: 36 MPa MIN.
  - viii) HARDNESS: NOT SPECIFIED.
- IX) RESISTANCE TO SPLITTING ALONG THE THREAD OF THE WRAP
- a) ON UNNOTCHED SPECIMENS 195 KN/N MINIMUM
  - b) ON NOTCHED SPECIMENS; NOT SPECIFIED.
- X) TARTENSE HEAT STABILITY: 140°C MINIMUM
- XI) WATER ABSORPTION: 0.7% MAXIMUM.
- XII) THERMAL RESISTANCE: NOT SPECIFIED.

b. NUMERICAL VALUES OF TOLERANCE SYSTEM ARE AS UNDER:-

DIMENSION	NOMINAL	LOW LIMIT	HIGH LIMIT
DISTANCE 10 A 4	10	0	+0.100
Ø 13 A 7	Ø 13	0	+0.430
DISTANCE 19 C 3	19	-0.045	0
Ø 22 B 7	Ø 22	-0.520	0
DISTANCE 35 B 7	35	-0.620	0
DISTANCE 30 A 7	30	0	+0.520
Ø 25 B 7	Ø 25	-0.520	0

IT IS ALLOWED TO MANUFACTURE FROM MOULDING MATERIAL AC-4-B GOST 20437-75 OR FROM ACB-2P-2M-0 GOST 17478-72 WITH TECHNICAL REQUIREMENTS ACCORDING TO OST 3-4223-79

INDIGENOUS ALT. MATERIAL : FOR T-90  
GLASS FIBRE FILLED PHENOMIC MOULDING MATERIAL  
IND/NE/95 (PROV.)  
(Authority : CQA(ME) L/No. CQA/ME/7200/T-90S, Dt. 24.06.2005)

ID = 80  
01-02-02

22-10-03 5-6-92	18814-W	HINDI NOMEN. ADDED. RETRACED WITHOUT CHANGE		DRAWN:- TRACED:- R. R. Sharma	CHD:- CHD:- G. P. Shukla	ASSY DRG:- DATE :-	CQA(AVA)AVADI	
PREV DC (U) Nos 16313-W, 16881-W, 17068-W & 17219-W DT. 10-2-92				AHSP	SCALE:- 2:1			
DATE	AUTHORITY	ZONE	NATURE	SIG AHSP	SIG DO		CHIEF D'MAN	DO FOR CQA(W)
AMENDMENTS				MATERIAL- FABRIC-BASED LAMINATE 17 TK GOST 5-78			DESIGN No.	
DRG SEALED:- 17068-W 7-5-91				FOR CQA(W)			PROTECTIVE FINISH	PART No. <b>2A26-02-154</b>
<div style="display: flex; justify-content: space-around; align-items: center;"> <span>बुश</span> <span style="font-size: 2em; font-weight: bold;">BUSH</span> </div>							DS CAT No. 5970-002173	