

LIST OF DOCUMENTATION IN ALBUM No. 7

2-1/12

Ser. No.	Designation	Denomination	Inventory number	Quantity of sheets	Number of sheet in album
1	2	3	4	5	6
	6X5/E2				
1	6X5.C6/E2	Knife-bayonet assembly (SK-6653/TE)	40-A0317	1	1
2	6X5.C6CB/E2	Knife-bayonet assembly. (SK-6552/TE)	40-A0318	1	2
		Assembly drawing			
3	6X5.E1/E2	Knife-bayonet assembly. (SK-6613/TE)	40-A0319	1	3
		Structure diagram			
4	6X5.BC/E2	Knife-bayonet assembly. (SK-6654/TE)	40-A0320	1	4
		List of specifications			
5	6X5.БД/E2	Knife-bayonet assembly. (SK-6655/TE)	40-A0321	4	5-8
		List of reference documents			
6	6X5.C61/E2	Knife-bayonet (SK-6656/TE)	40-A0322	1	9
7	6X5.C61CB/E2	Knife-bayonet. (SK-6558/TE)	40-A0323	1	10
		Assembly drawing			
8	6X5.C62/E2	Scabbard assembly (SK-6657/TE)	40-A0324	1	11
9	6X5.C62CB/E2	Scabbard assembly. (SK-6555/TE)	40-A0325	1	12
		Assembly drawing			
10	6X5.C61-1/E2	Blade with handle (SK-6658/TE)	40-A0326	1	13
11	6X5.C61-1CB/E2	Blade with handle. (SK-6551/TE)	40-A0327	1	14
		Assembly drawing			
12	6X5.C62-1/E2	Scabbard (SK-6659/TE)	40-A0328	1	15
13	6X5.C62-1CB/E2	Scabbard. (SK-6550/TE)	40-A0329	1	16
		Assembly drawing			
14	6X5.C62-2/E2	Belt assembly (SK-6660/TE)	40-A0330	1	17
15	6X5.C62-2CB/E2	Belt assembly. (SK-6661/TE)	40-A0331	1	18
		Assembly drawing			
16	6X5.C62-3/E2	Suspension assembly (SK-6662/TE)	40-A0334	2	19-20
17	6X5.C62-3CB/E2	Suspension assembly. (SK-6663/TE)	40-A0335	1	21
		Assembly drawing			
18	6X5.C62-4/E2	Cutter assembly (SK-6664/TE)	40-A0332	1	22
19	6X5.C62-4CB/E2	Cutter assembly. (SK-6652/TE)	40-A0333	1	23
		Assembly drawing			
20	6X5.C62-5/E2	Scabbard with retainer (SK-6665/TE)	40-A0336	1	24
21	6X5.C62-5CB/E2	Scabbard with retainer. (SK-6666/TE)	40-A0337	1	25
		Assembly drawing			
22	6X5.1-1/E2	Blade (SK-6580/TE)	40-A0338	1	26
23	6X5.1-2/E2	Ring (SK-6579/TE)	40-A0339	1	27
24	6X5.1-7/E2	Spring (SK-6571/TE)	40-A0340	1	28
25	6X5.1-8/E2	Pin (SK-6569/TE)	40-A0341	1	29
26	6X5.1-12/E2	Clip (SK-6577/TE)	40-A0342	1	30
27	6X5.1-13/E2	Latch (SK-6572/TE)	40-A0343	1	31
28	6X5.1-14/E2	Latch (SK-6578/TE)	40-A0344	1	32
29	6X5.2-2/E2	Cutter (SK-6576/TE)	40-A0345	1	33
30	6X5.2-3/E2	Swivel (SK-6573/TE)	40-A0346	1	34
31	6X5.2-4/E2	Swivel (SK-6570/TE)	40-A0347	1	35
32	6X5.2-7/E2	Belt (SK-6567/TE)	40-A0348	1	36
33	6X5.2-8/E2	Retainer (SK-6568/TE)	40-A0349	1	37
34	6X5.2-9/E2	Pin (SK-6566/TE)	40-A0350	1	38

IRPL CONFIDENTIAL COPY NO.1

Ser. No.	Designation	Denomination	Inventory number	Quantity of sheets	Number of sheet in album
1	2	3	4	5	6
35	6X5.2-10/E2	Snap hook _____ (SK-6564/TE)	40-A0351	2	39-40
36	6X5.2-12/E2	Rivet _____ (SK-6565/TE)	40-A0352	1	41
37	6X5.2-14/E2	Belt fastener _____ (SK-6563/TE)	40-A0353	1	42
38	6X5.2-15/E2	Washer _____ (SK-6562/TE)	40-A0354	1	43
39	6X5.2-16/E2	Belt _____ (SK-6561/TE)	40-A0355	1	44
40	6X5.2-18/E2	Suspension _____ (SK-6560/TE)	40-A0356	1	45
41	6X5.2-19/E2	Suspension _____ (SK-6559/TE)	40-A0357	1	46
42	6X5.2-20/E2	Ring _____ (SK-6575/TE)	40-A0358	1	47
43	6X5.2-22/E2	Stop _____ (SK-6557/TE)	40-A0359	1	48
44	6X5.2-23/E2	Snap hook _____ (SK-6553/TE)	40-A0360	1	49
45	6X5.2-24/E2	Stop _____ (SK-6554/TE)	40-A0361	1	50
46	6X5.2-25/E2	Ring _____ (SK-6556/TE)	40-A0362	1	51
					Total qty of sheets 51

JUN/1992

आरेखण की सही प्रमाणित
प्रतिलिपि दिनांक.....
Certified as correct copy
of drg. on.....

क. कारशंका प्रसाद
Jr. Works Manager
डी.डी.सी.

DRG. NO. - SK-6551/TE

D.A. NO.

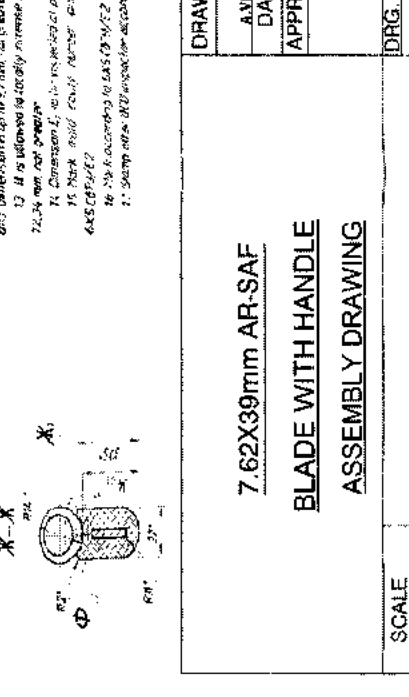
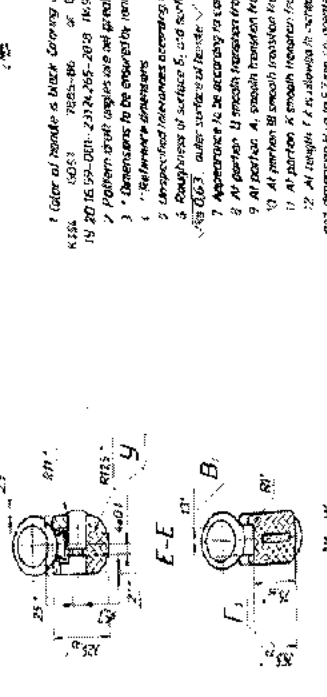
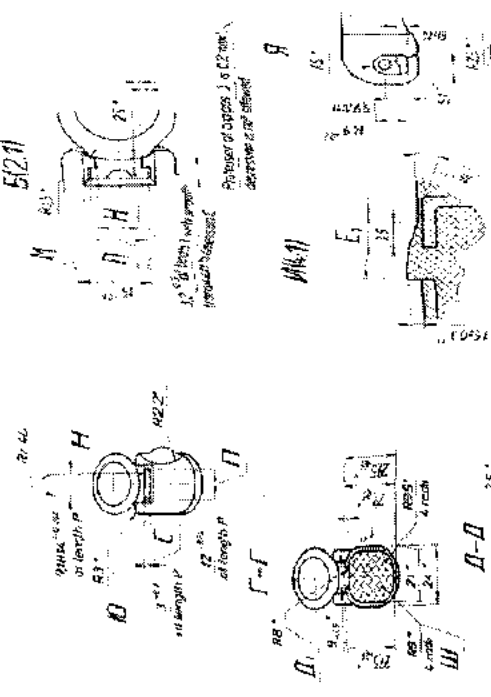
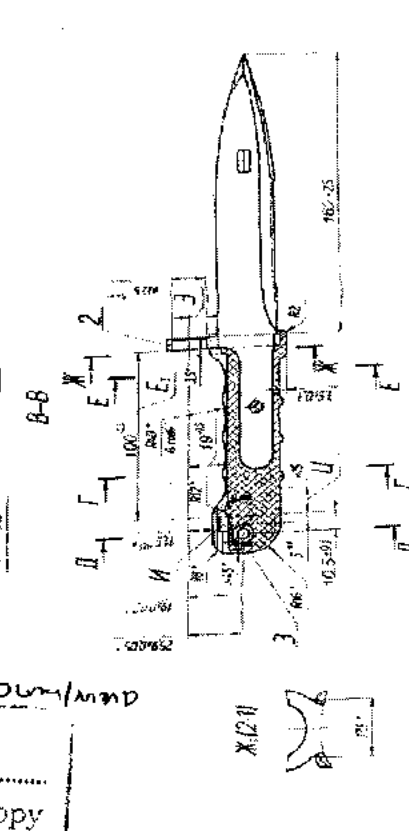
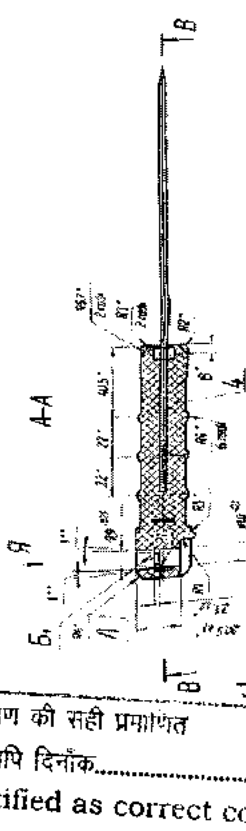
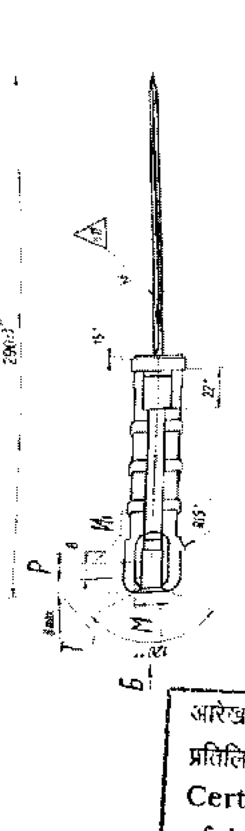
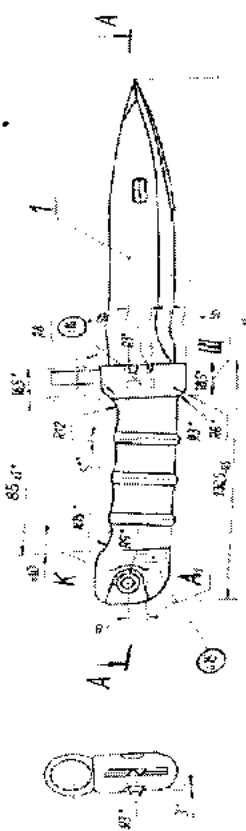
5/21/1



अखण की सही प्रमाथत
प्रतिलिपि दिनांक.....
Certified as correct copy
of drg. on.....

क. कारशासक
Jr. Works Manager

7.62X39mm AR-SAF
BLADE WITH HANDLE
ASSEMBLY DRAWING

SMALL ARMS FACTORY
KANPUR

SCALE
1:1



DRAWN	TRACED	CHECKED
DATE	29-09-2023	
APPROVED		
DRG. NO. SK-6551/TE		
SHT. 1 OF 1		

J.W.M./D.D.O.

1. Color of handle is black. Drawing shall be carbon black or grade 4324 5053 7055-86 or 64540. Use carbon.
2. Pattern draft angles are not greater than 1°.
3. Dimensions to be specified by inch.
4. Reference dimensions.
5. Unspecified tolerances according to AS 15 (19/72).
6. Depth of surface is 0.06 mm for casting dimensions F, G, H.
7. Appearance to be according to common sample.
8. All parton to smooth transition from radius R to radius R.
9. All parton A, smooth transition from radius R to radius R.
10. All parton B smooth transition from radius R to radius R.
11. All parton C smooth transition from radius R to radius R.
12. All length L to smooth transition dimension R up to 12.5 mm.
13. If it is allowed to locally increase dimension R to length L, it is 7.25 mm not greater.
14. Dimension L, which is marked as parton J.
15. Mark shall have number and R.D. number according to AS 15 (19/72).
16. To be according to AS 15 (19/72).
17. Stamp shall be according to AS 15 (19/72).

DRG. NO. SK-553/TE

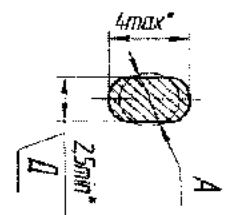
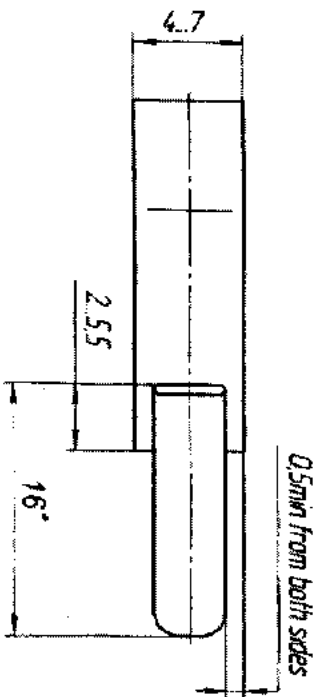
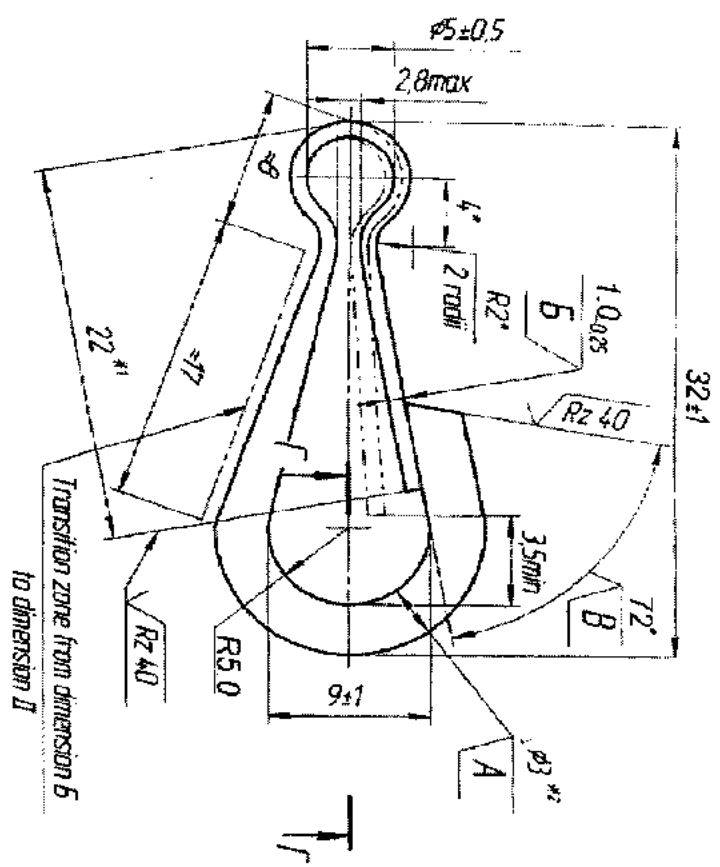

F-15.11

✓ Ra 2.5 (✓)

भारतीय रिजर्व
 Certified as correct copy
 of dwg. on.....

Dr. J. Works
 Dr. Works
 31/05/23

- 1 * Dimensions to be ensured by tool.
- 2 * Reference dimension.
- 3 * Dimension of work piece.
- 4 Unspecified tolerances according to 6X5.019/E2.
- 5 It is allowed to increase angle B up to 90°.
- 6 Diamond knurling Q6 GOST 21474-75 is allowed on inner surface.
- 7 Appearance and surface roughness according to control sample.

7.62X39mm AR-SAF
 SNAP HOOK

SMALL ARMS FACTORY
 KANPUR

DRAWN	TRACED	CHECKED
DATE	29-09-2023	
APPROVED		

DRG. NO. J.W.M./D.D.O.
 SK-6553/TE

SHT. 1 OF 1

DRG. NO. - SK-6556/TE

D.A. NO.

✓✓✓

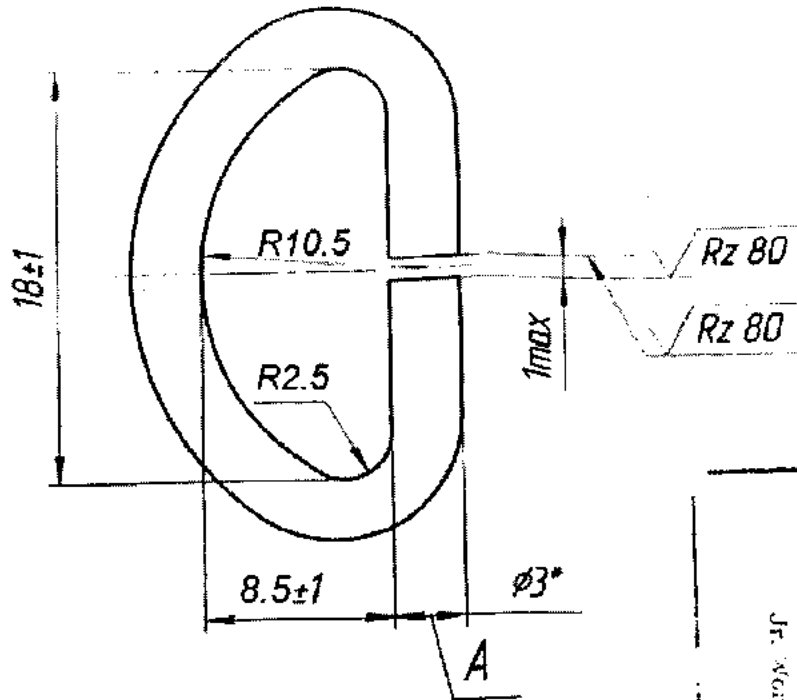

आरक्षण की तारीख प्रमाणित
 प्रमाणित दिनांक.....
 Certified as correct copy
 of drg. on.....

Dr. J. Verma
 Jr. Works Manager
 Kanpur

Dr. J. Verma

- 1 Dimensions to be ensured by tool, except dimension A.
- 2 * Reference dimension.
- 3 Unspecified tolerances according to 6X5.CÖTY/E2.

7.62X39mm AR-SAF
RING

DRAWN	TRACED	CHKD.
A. VERMA		
DATE	30-09-2023	
APPROVED		
JWM/DDO		

SCALE
1 : 1

SMALL ARMS FACTORY
KANPUR

DRG. NO.
SK-6556/TE
SHEET 1 OF 1

DRG. NO. - SK-6557/TE

D.A. NO.

V/V

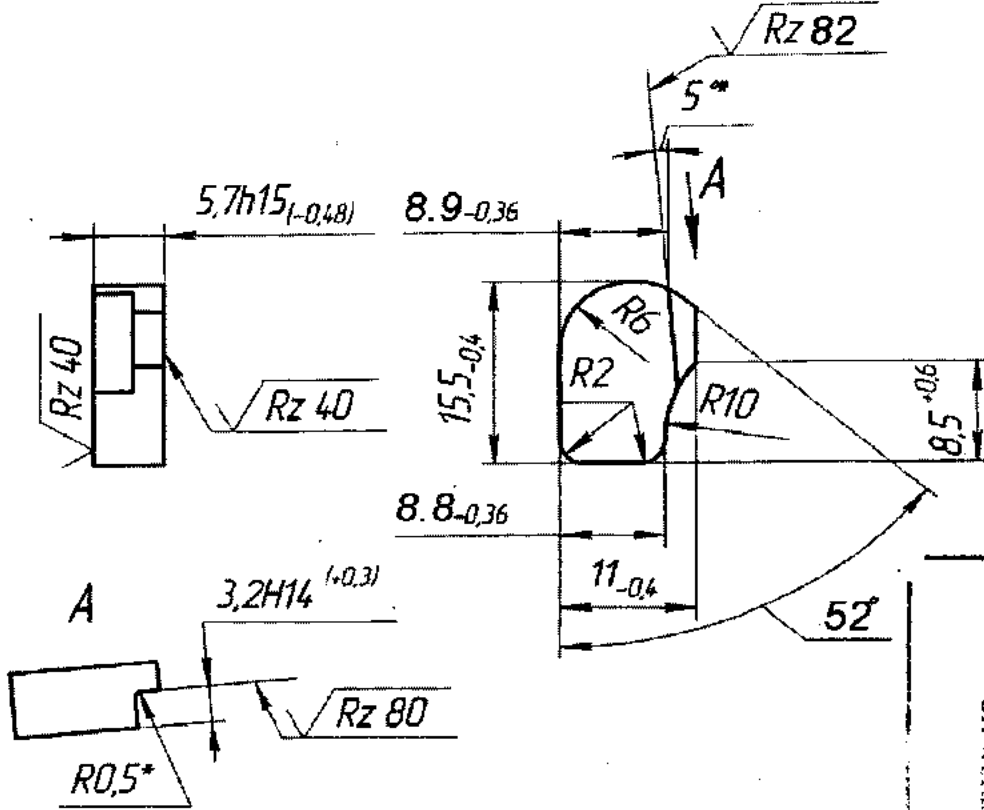

Certified as correct copy
of drg. on.....

Dr. J. Verma
Jr. Works Manager

- 1 Unspecified tolerances according to 6X5.C8TY/E2.
- 2 * Dimensions to be ensured by tool.
- 3 Quality of surfaces to be according to GOST 1051-73, gr. B, h11.
- 4 Other requirements to be according to TY 14-11-245-88.

7.62X39mm AR-SAF

STOP

DRAWN	TRACED	CHKD.
-------	--------	-------

A.VERMA

DATE	30-09-2023
------	------------

APPROVED

JWM/DDO

SCALE

1 : 1

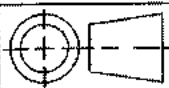

SMALL ARMS FACTORY
KANPUR

DRG.NO.

SK-6557/TE

SHEET 1 OF 1

DRG. NO. - SK-6558/TE

D.A. NO.

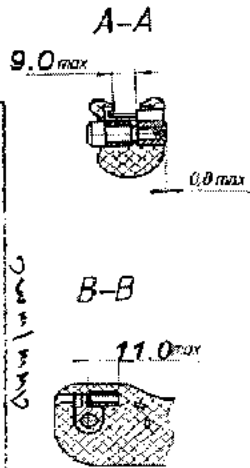
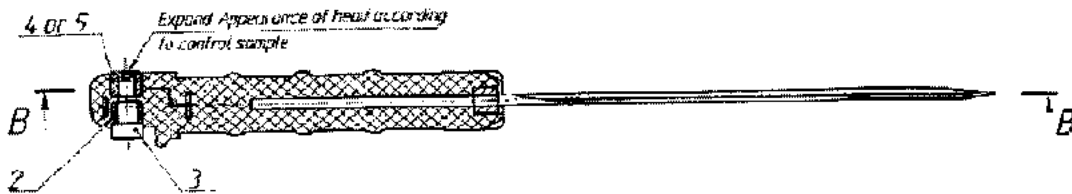
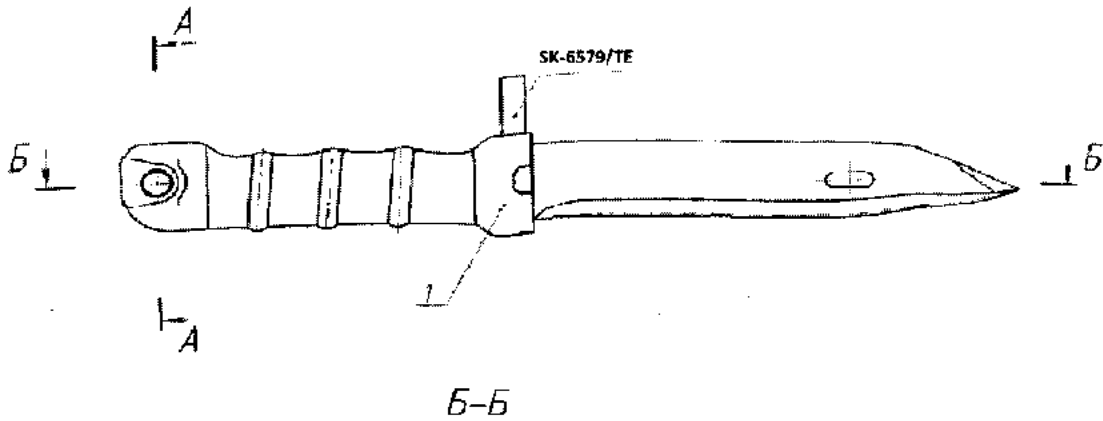

1 After pressing latch pin pos. 3, latch pos. 4 or pos. 5 should vigorously and freely return into original position by spring force. Force protruding of latch pin over handle top is not allowed.
 2 Locking of latch, latch pin rev. GOST 2/177 in case of whitewashing, phosphating primer 8/1-02 GOST 12707-73 and nickel plated on 186/2A premium quality grade GOST 94-95 black color. Allowed coating phosphating primer 8/1-02 GOST 12707-73 and nickel plated-15. block GOST 18335-93

शस्त्रों की तारी प्रमाणित
 प्रमाणित प्रमाणित
 Certified as correct copy
 of drg. on.....

**7.62X39mm AR-SAF
 KNIFE-BAYONET
 ASSEMBLY DRAWING**

DRAWN	TRACED	CHKD.
A.VERMA		
DATE	30-09-2023	
APPROVED		
JWM/DDO		
DRG.NO.		
SK-6558/TE		
SHEET 1 OF 1		

SCALE
 1:1

**SMALL ARMS FACTORY
 KANPUR**

$\sqrt{Rz\ 80\ (\checkmark)}$

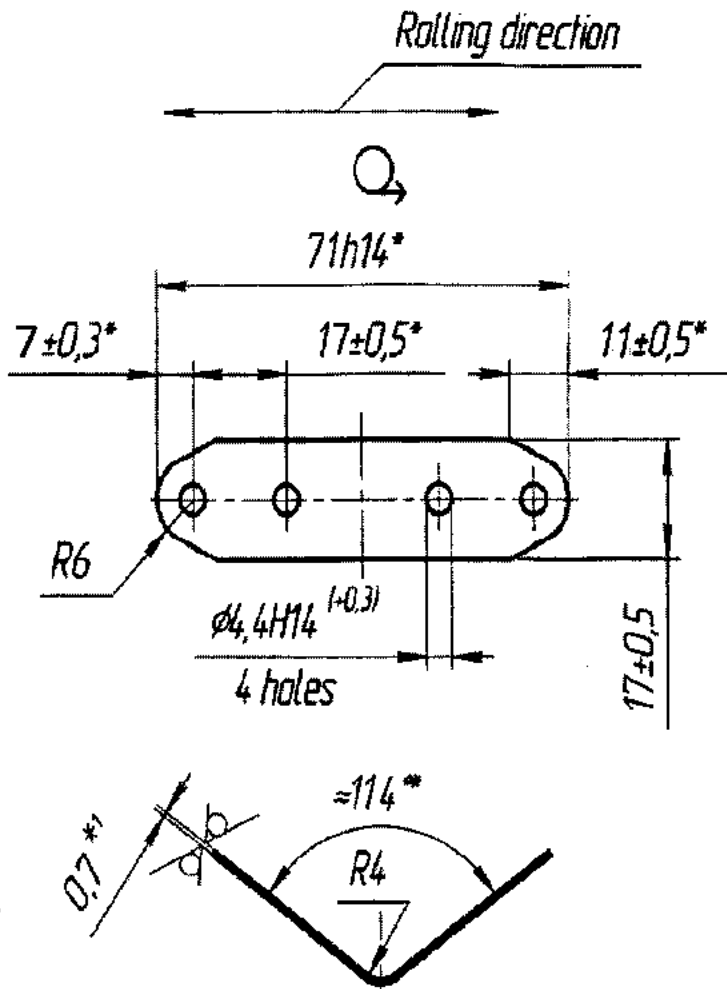

प्रमाणित प्रमाणित
 Certified as correct copy
 of drg. on.....
 29/09/23
 Mr. Anshuman Kumar
 Jr. Works Manager
 S.A.S.I.

- 1 * Dimensions to be ensured by tool.
- 2 ** Reference dimension.
- 3 Unspecified tolerances according to 6X5.C8T9/E2.
- 4 Coating is X9. m.

MATL. — Sheet A-11B-0-0.7 GOST 19904-90
5-11-F-20 GOST 16523-97
 Weight 6 g

**7.62x39mm AR-SAF
suspension**

DRAWN	TRACED	CHKD.
S P SONI		
DATE	29.09.23	
APPROVED		
HJS/DDO		

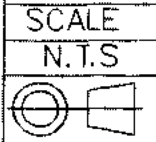

SMALL ARMS FACTORY
KANPUR

DRG. NO.
SK-6559 TE

$\sqrt{Rz\ 80\ (\checkmark)}$

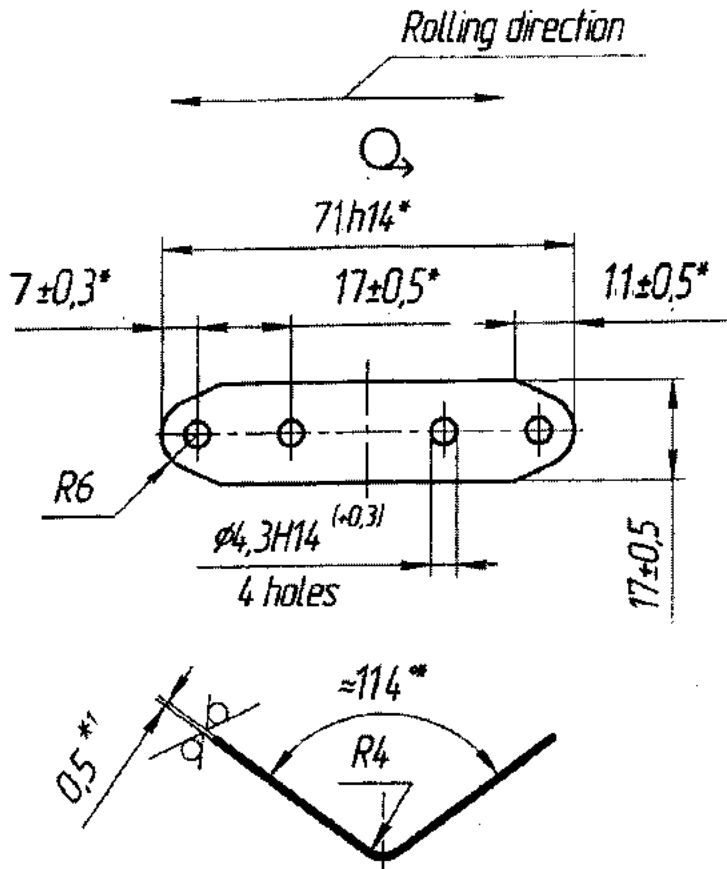

संस्कृत की सेवा प्रणाली
 प्रमाणित किया गया
 Certified as correct copy
 of drg. on.....
 R. RAJESH KUMAR
 Jr. Works Manager
 29.09.23

- 1 * Dimensions to be ensured by tool.
- 2 * Reference dimension.
- 3 Unspecified tolerances according to 6X5 COTY/E2.

MATL. - Strip 0,5x115-M-HT-0-12X18H9-3-II

GOST 4986-79

Weight 6 g

**7.62x39mm AR-SAF
 suspension**

DRAWN	TRACED	CHKD.
S P SONI		
DATE	29.09.23	
APPROVED		
HOS/DDO		

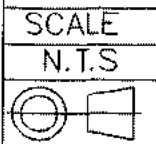

SMALL ARMS FACTORY
KANPUR

DRG. NO.
SK-6560 TE

DRG. NO. SK-6561TE

D.A NO.

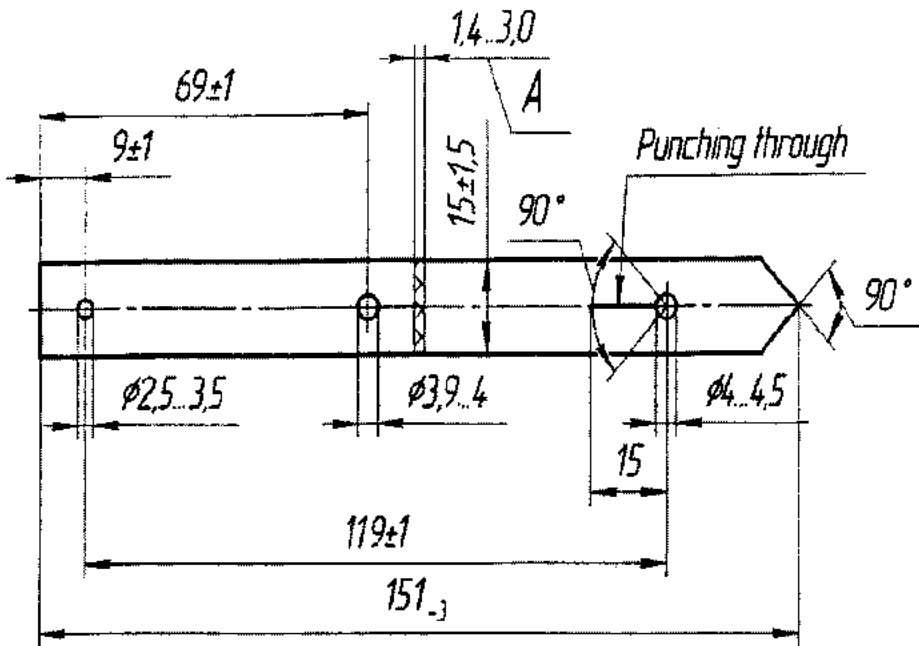

अनुमोदित है कि यह प्रति
 प्रमाणित है कि यह प्रति
 Certified as correct copy
 of drg. on.....
 Dr. Anil Kumar
 Jr. Works Manager
 29/09/23

- 1 Dimensions to be ensured by tool, except dimension A
- 2 Unspecified tolerances according to 6X5.COTY/E2.
- 3 Blemishes on belt leather are according to control sample.
- 4 When cutting out belt and punching holes, tears and cracks in leather are not allowed.
- 5 Delamination of coating is not allowed.
- 6 Brittleness test to be performed according to GOST 938.30-78.

MATL. — Russia smooth or embossed leather for saddlery,
 black color GOST 1904-81

Weight 5g

**7.62x39mm AR-SAF
 BELT**

DRAWN	TRACED	CHKD.
S P SONI		
DATE	29.09.23	
APPROVED		
HOS/DDO		

SCALE
 N.T.S

SMALL ARMS FACTORY
KANPUR

DRG. NO.

SK-6561TE

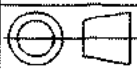

MVA

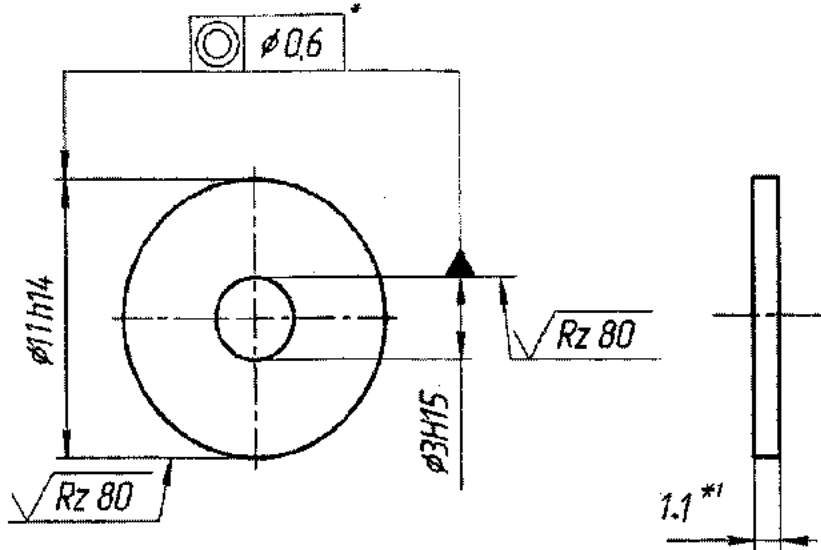

- 1 * Dimension to be ensured by tool.
- 2 ** Reference dimension.
- 3 Coating is Chem. Phos. chr/impreg. with 5Φ-4 glue GOST 12172-2016 with nigrosine of grade A GOST 9307-78.

30/09/23
 प्रमाणित किया गया
 Certified as correct copy
 of drg. on.....
 Dr. Manoj Kumar
 Jr. Maths Assistant
 30/09/23

MATL. - Strip 40-C-1-1x36
 GOST 2284-79
 Weight 1 g

**7.62x39mm AR-SAF
WASHER**

DRAWN	TRACED	CHKD.
S P SONI		
DATE	29.09.23	
APPROVED		
HOS/DDO		

SCALE
N.T.S

**SMALL ARMS FACTORY
KANPUR**

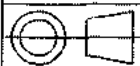

DRG. NO.
SK-6562 TE

DRG. NO. SK-6563 TE

D.A. NO.

√ Rz 20 (✓)

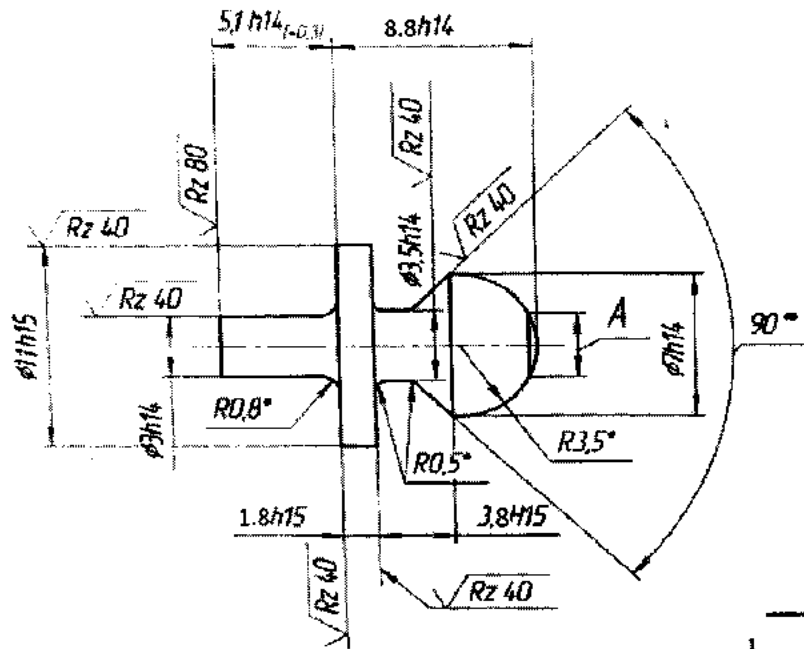

- 1 *Dimensions to be ensured by tool.
- 2 Unspecified tolerances according to 6X5 CBT4/E2
- 3 Partion A ϕ 2 mm, not greater, is allowed
- 4 Coating is Chem. Phos. chr/impreg. with 5 ϕ -4 glue GOST 12172-2016 with nigrosine of grade A GOST 9307-78.

Certified as correct copy
 of drg. on.....
 Mr. Jyoti Prasad
 Sr. Works Manager
 Kanpur

MATL. - Round bar 10-h11 GOST 7417-75
 15-H-8 GOST 1051-73

Weight 3 g

**7.62x39mm AR-SAF
 BELT FASTENER**

DRAWN	TRACED	CHKD.
S P SONI		
DATE	29.09.23	
APPROVED		
HOS/DDO		

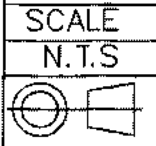

**SMALL ARMS FACTORY
 KANPUR**

DRG. NO.
SK-6563 TE

PRG. NO. SK-6564TE

Schematic diagram (2.1)

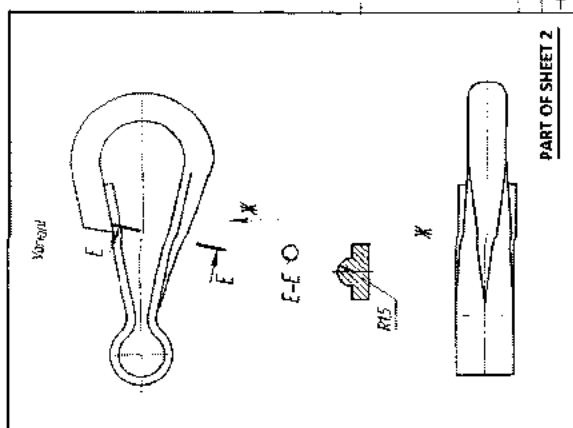
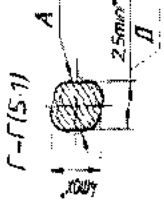
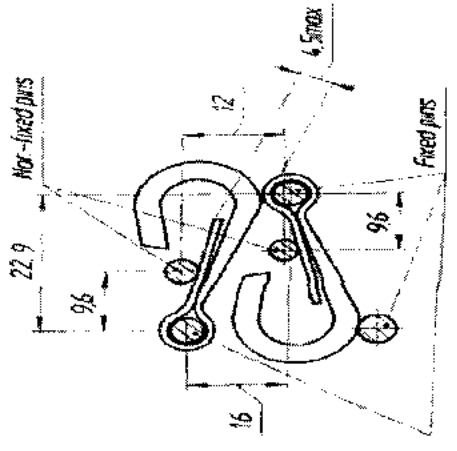
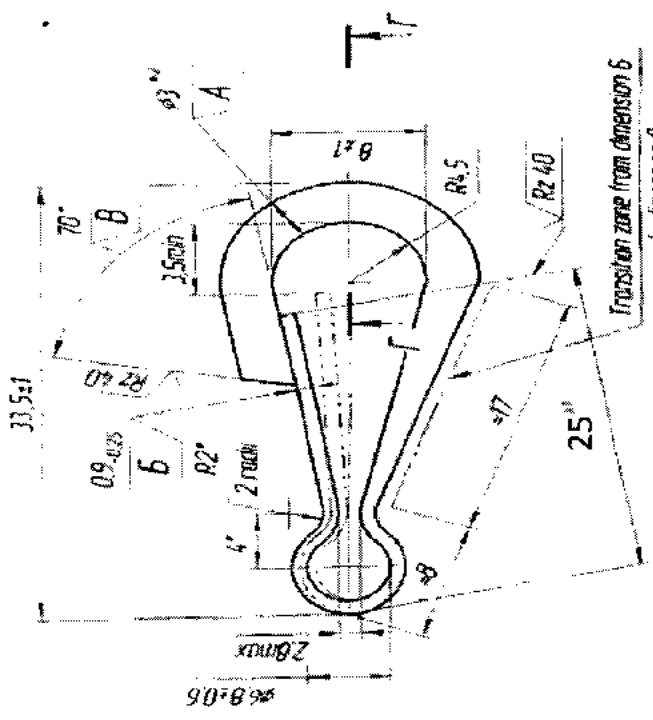

$\sqrt{Ra 2.5 (1)}$

- 1 332. 391 HV5.
- 2 * Dimensions to be ensured by tool
- 3 ** Reference dimension
- 4 *** Dimension of work piece
- 5 Unspecified tolerances according to GOST 10719/EZ.
- 6 It is allowed to increase angle 8 up to 90°.
- 7 Coating is XPM. Appearance and surface roughness according to control sample. Allowed coating is (175) chr.
- 8 Elasticity test to be performed according to schematic diagram during 12 hours 5% of parts but not less than 10 pcs from lot are subject to testing. No clearance should be between spring element and spring after testing fore-point contact is allowed in case of least one piece features clearance, while lot is subject to testing and inspection.
- 9 Diamond knurling 0.6 GOST 2474-75 is allowed on inner surface.

MATL. - Wire 3-35
GOST 5663-79
Weight 5 g

7.62x39mm AR-SAF
SNAP HOOK

SCALE	1:1
DATE	28/09/2023
APPROVAL	
DRG. NO.	SK-6564TE
SHEET	1 OF 1

SMALL ARMS FACTORY
KANIPIUR

PART OF SHEET 2

Certified as correct copy of drg. on

Dr. MUKESH PRASAD
Jr. Works Manager

(Signature)

शरद्वर का शीत काल ...
श्रीनिधि शिर्का

W/V

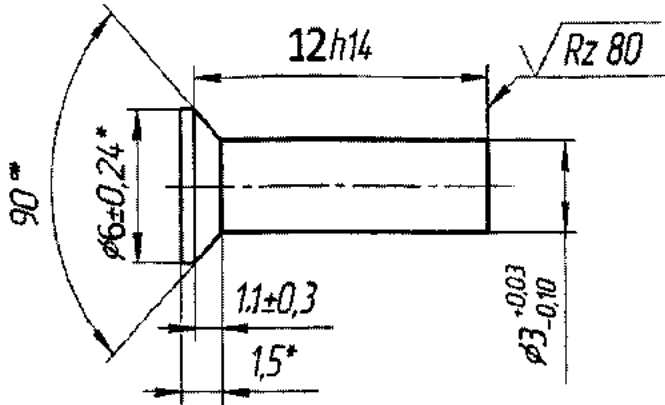

अनुभव की गई प्रमाणित
 प्रमाणित किया गया
 Certified as correct copy
 of drg. on.....
 क. मनिष कुमार
 Jr. WORKS MANAGER
 29/09/23

- 1. 317 ... 376 HV.
- 2 * Dimensions to be ensured by tool.
- 3 Unspecified tolerances according to 6X5.C0T4/E2.

MATL. - Wire 2,95-2-45
 GOST 5663-79
 Weight 1,5 g

7.62x39mm AR-SAF RIVET

DRAWN	TRACED	CHKD.
S P SONI		
DATE	29.09.23	
APPROVED		
HOS/DDO		

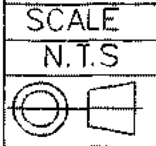

SMALL ARMS FACTORY
KANPUR

DRG.NO.
SK-6565TE

$\sqrt{Rz\ 20\ (\checkmark)}$

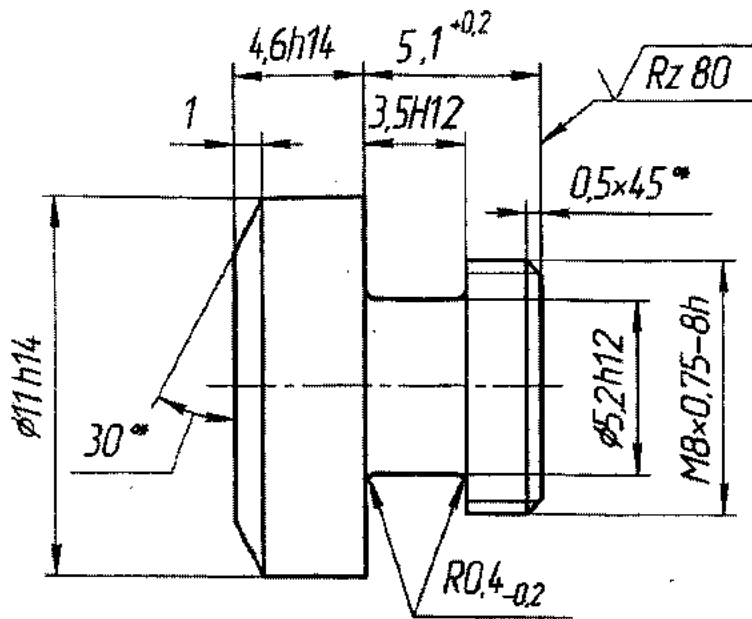

महाराष्ट्र शासनाचे
सुरक्षा विभाग
Certified as correct copy
of drg. on.....
श. अशोक कुमार
Jr. Works Manager
29/09/23

- 1 * Dimensions to be ensured by tool.
- 2 Unspecified tolerances according to 6X5.C8TY/E2.

MATL. - Round bar $\frac{12-h11\ GOST\ 7417-75}{8X\phi-B\ GOST\ 5950-2000}$

Weight 7 g

**7.62x39mm AR-SAF
PIN**

DRAWN	TRACED	CHKD.
S P SONI		
DATE	29.09.23	
APPROVED		
HOS/DDO		

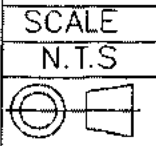

SMALL ARMS FACTORY
KANPUR

DRG. NO.
SK-6566TE

DRG. NO. SK-6567TE

D.A. NO.

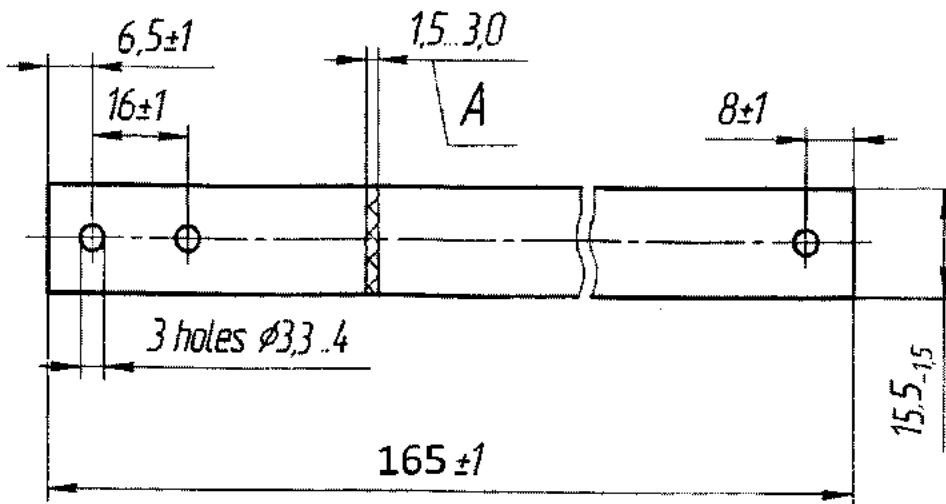

- 1 Dimensions to be ensured by tool, except dimension A.
- 2 Blemishes on belt leather are according to control sample.
- 3 When cutting out belt and punching holes, tears and cracks in leather are not allowed.
- 4 Delamination of coating is not allowed.
- 5 Brittleness test to be performed according to GOST 938.30-78.

Certified as correct copy
 of drg. on.....
 R. BHARTI SINGH
 Jr. Works Manager
 29.09.23

MATL. - Russia smooth or embossed leather
 for saddlery, black color GOST 1904-81
 Weight 6 g

**7.62x39mm AR-SAF
BELT**

DRAWN	TRACED	CHKD.
S P SONI		
DATE	29.09.23	
APPROVED		
HOS/DDO		

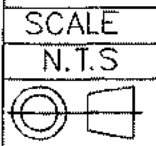

**SMALL ARMS FACTORY
KANPUR**

DRG. NO.
SK-6567TE

SK-6569/TE

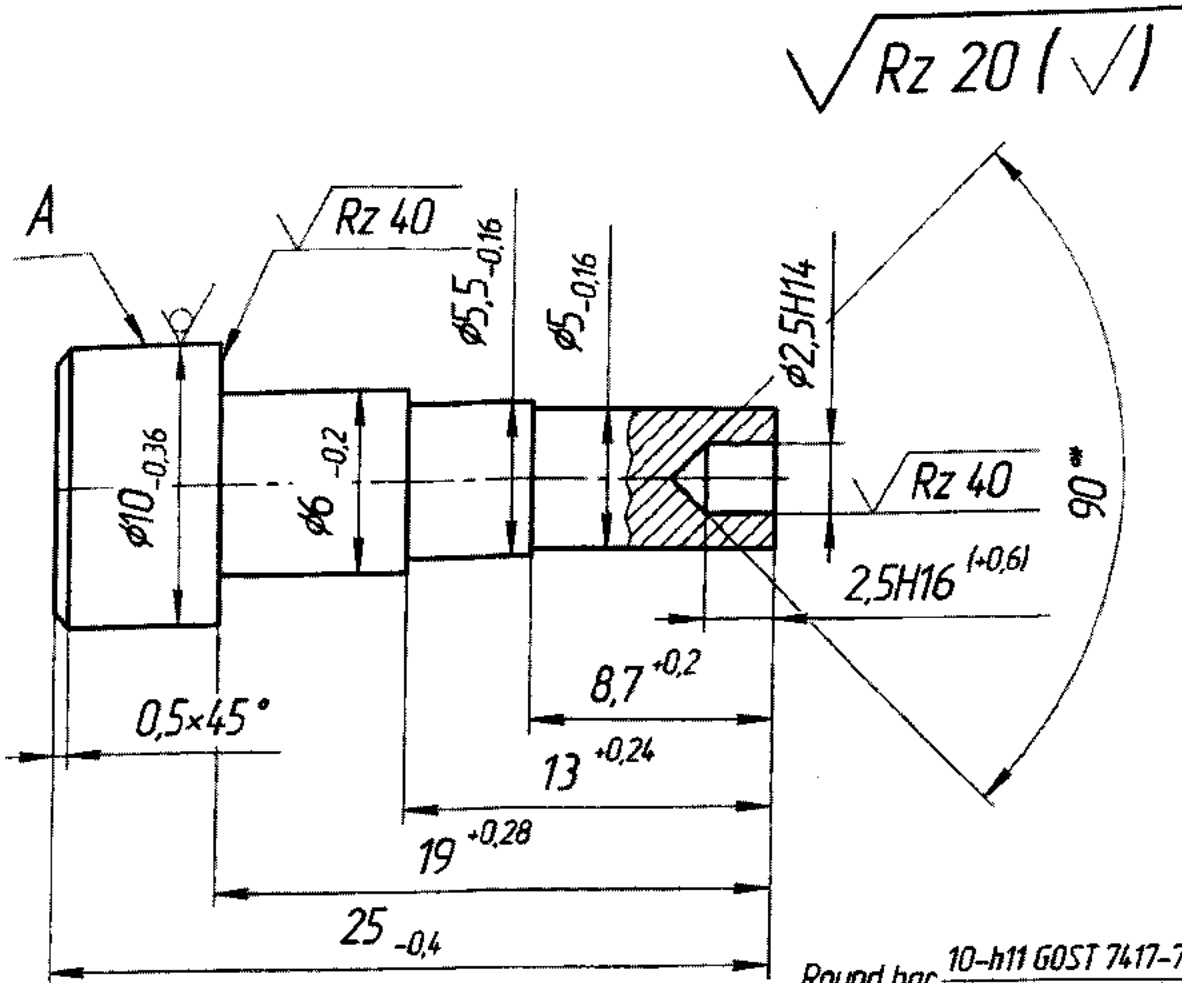

Round bar 10-h11 GOST 7417-75
35H-B GOST 1051-73

- 1 Unspecified tolerances according to 6X5.COTY/E2.
- 2 * Dimension to be ensured by tool.
- 3 Surface A is allowed to be processed.
- 4 Coating is Chem. Phos. chr/impreg. with БФ-4 glue GOST 12172-2016 with nigrosine of grade A GOST 9307-78.

आरेखण की सही प्रमाणित
प्रतिलिपि दिनांक.....
Certified as correct copy
of drg. on.....

क. कार्यालय प्रमुख
Jr. Works Manager
क. कार्यालय

Weight: 9 g

7.62X39mm AR-SAF		DRAWN	SEEN BY	CHECKED
		DATE		
Latch pin		APPROVED		
SCALE	SMALL ARMS FACTORY	DRG. NO.		
NTS		SK-6569/TE		
	KANPUR	SHT. 1 OF 1		

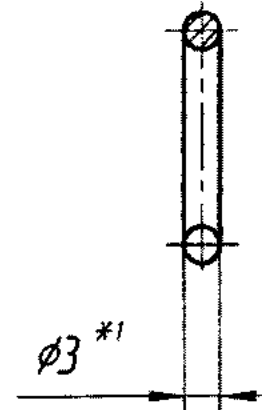
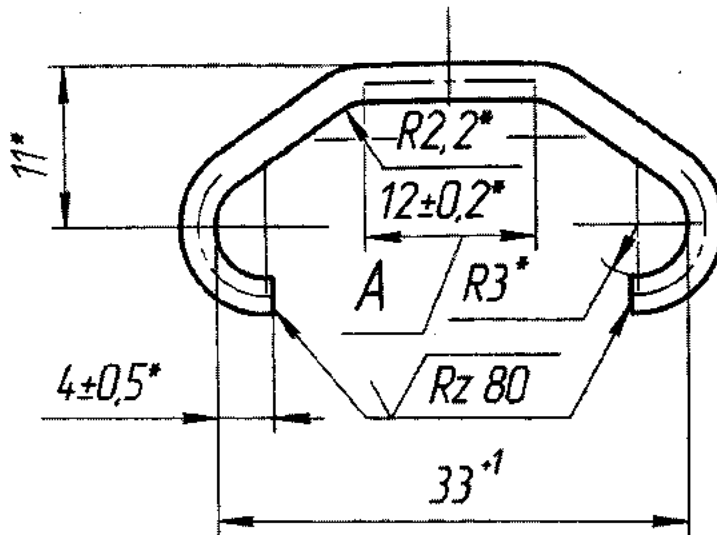

- 1 * Dimensions to be ensured by tool.
- 2 *¹ Reference dimension.
- 3 Unspecified tolerances according to 6X5.C6TY/E2.

2. wire mark

आरेख्य की सही प्रमाणात
प्रतिलिपि तिनोक.....
Certified as correct copy
of drg. on.....

[Signature]
क. कार्तिकेय शर्मा
Jr. Works Manager

Wire 3,0-TC-1-12X18H10T
GOST 18143-72

Weight: 1,5 g

<p><u>7.62X39mm AR-SAF</u></p> <p><i>Swivel</i></p>		<table border="1" style="width: 100%; border-collapse: collapse;"> <tr> <th style="width: 33%;">DRAWN</th> <th style="width: 33%;">SEEN BY</th> <th style="width: 33%;">CHECKED</th> </tr> <tr> <td> </td> <td> </td> <td> </td> </tr> <tr> <td colspan="2">DATE</td> <td style="text-align: center;">05/10/2023</td> </tr> <tr> <td colspan="3">APPROVED</td> </tr> </table>	DRAWN	SEEN BY	CHECKED				DATE		05/10/2023	APPROVED		
DRAWN	SEEN BY	CHECKED												
DATE		05/10/2023												
APPROVED														
<table border="1" style="width: 100%; border-collapse: collapse;"> <tr> <td>SCALE</td> <td rowspan="2" style="text-align: center; vertical-align: middle;"> <p>SMALL ARMS FACTORY</p> <p>KANPUR</p> </td> </tr> <tr> <td>NTS</td> </tr> <tr> <td style="text-align: center;"> </td> <td> </td> </tr> </table>	SCALE	<p>SMALL ARMS FACTORY</p> <p>KANPUR</p>	NTS			<p>DRG. NO.</p> <p>SK-6570/TE</p> <p>SHT. 1 OF 1</p>								
SCALE	<p>SMALL ARMS FACTORY</p> <p>KANPUR</p>													
NTS														

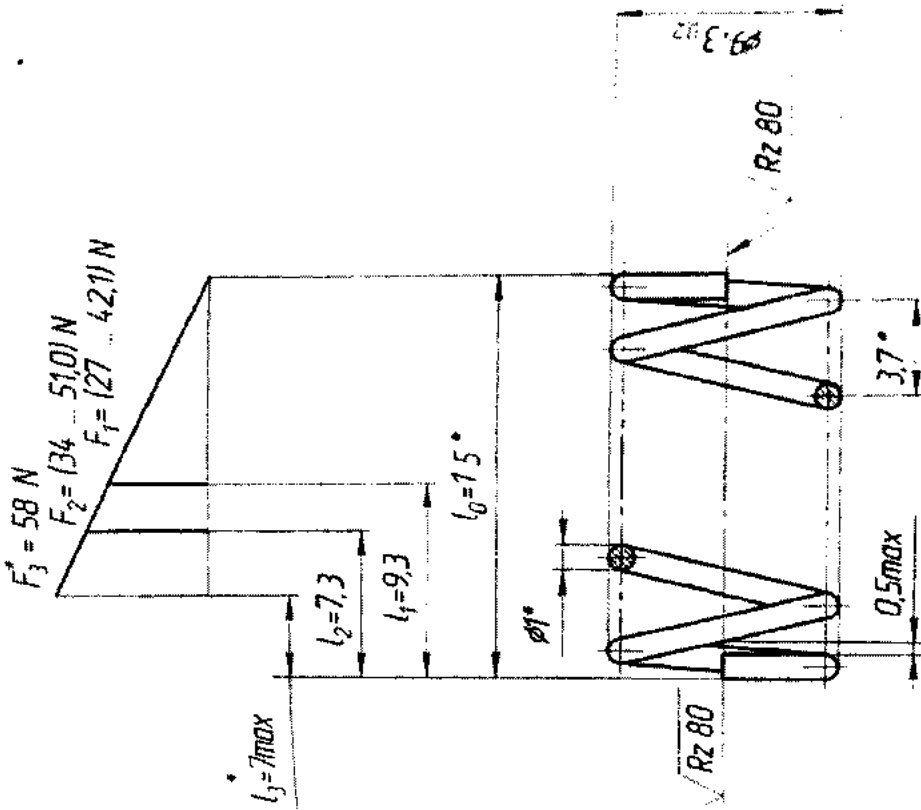

- 1 $G^* = 78.5 \text{ GPa}$
- 2 $\tau_j^* = 14 \text{ GPa}$
- 3 $n = 4$
- 4 $n_p = 5.5 \pm 0.25$
- 5 Tempering from 240°C to 260°C
- 6 $D_f = 10 \text{ mm}$
- 7 $D_c = 6.5 \text{ mm}$
- 8 * Reference dimensions and parameters
- 9 Unspecified tolerances according to 6XS CATY/E2.
- 10 $l = 152 \text{ mm}$
- 11 Pressress until coils come into contact. Pressressing time is not less than 12 hours

Wire 1-10
GOST 9389-75

DRAWN		SEEN BY		CHECKED	
DATE		DATE		DATE	
APPROVED		APPROVED		APPROVED	
DRG. NO.		DRG. NO.		DRG. NO.	
SCALE		SCALE		SCALE	
NTS		NTS		NTS	
7.62X39mm AR-SAF				Weight: 1.5 g	
Spring					
SMALL ARMS FACTORY				SK-6571/TE	
KANPUR				SHT. 1 OF 1	

अनुपेक्षण की सही प्रमाणित
प्रतिलिपि दिनांक.....
Certified as correct copy
of drg. on.....
[Signature]
क. कार्यालय प्रमुख
Jr. Works Manager

✓/✓/✓

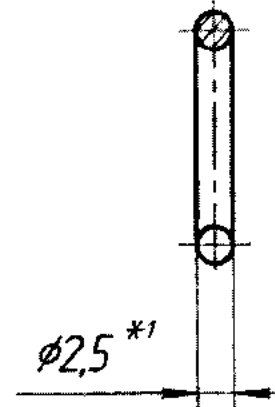
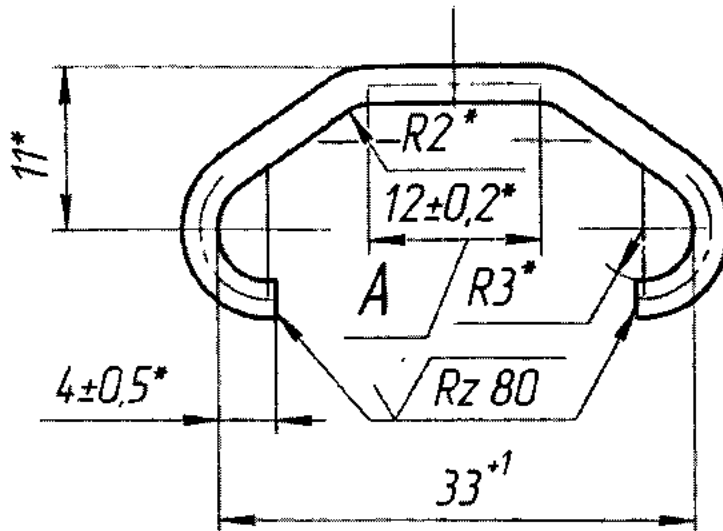

आरेखण की सही प्रमाणित प्रतिलिपि दिनांक.....
 Certified as correct copy of drg. on.....
 K. Kanungo
 Jr. Works Manager
 डी.डी.फे.

- 1 386 ... 487 HV5.
- 2 * Dimensions to be ensured by tool.
- 3 *1 Reference dimension.
- 4 Unspecified tolerances according to 6X5.C8TY/E2.
- 5 Coating of surface at section A - X18 ... X48, at rest of surface coating thickness is not standardized.

Wire 2,5-50 GOST 17305-91

Weight: 3g

7.62X39mm AR-SAF

Swivel

DRAWN	SEEN BY	CHECKED
DATE	05/10/2023	
APPROVED		

SCALE

N T S

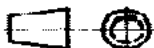

SMALL ARMS FACTORY
KANPUR

DRG. NO.

SK-6573/TE

SHT. 1 OF 1

SK-6575/TE

DRG. NO.

✓/✓/✓

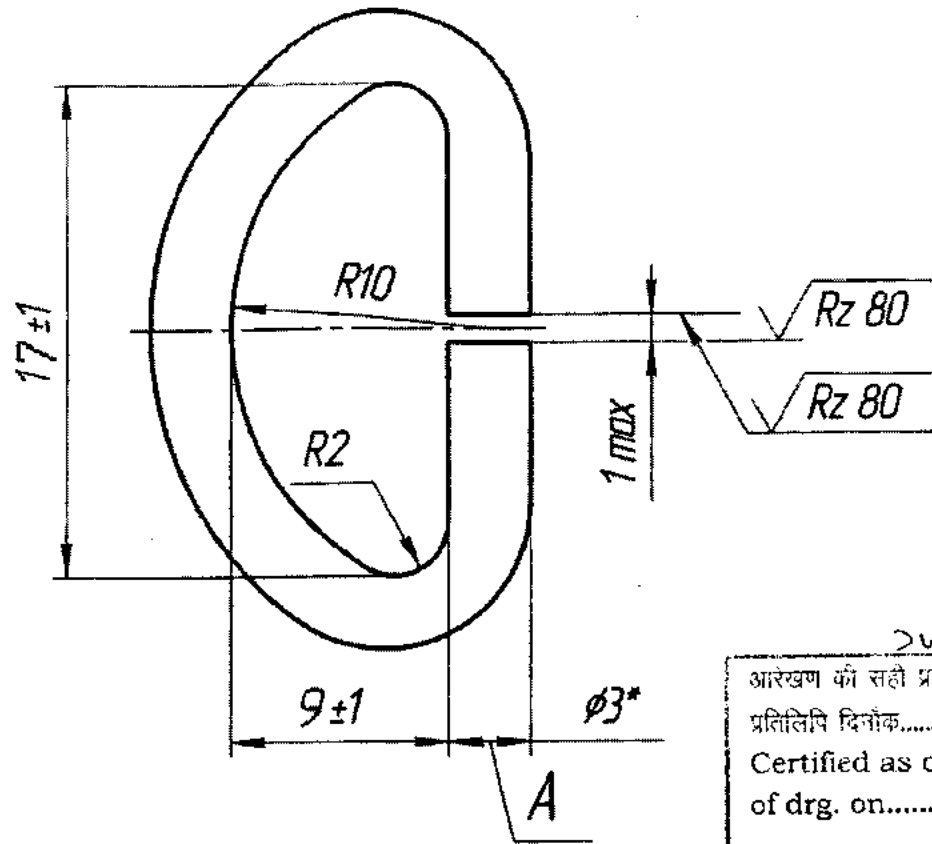

2 Wn/mmp

आरेखण की सही प्रमाणित प्रतिलिपि दिनांक.....
 Certified as correct copy of drg. on.....

[Signature]
 क. कारखाना प्रमुख
 Jr. Works Manager

- 1 Dimensions to be ensured by tool, except dimension A
- 2 * Reference dimension.
- 3 Unspecified tolerances according to 6X5.C0TY/E2.
- 4 Coating is X9. m.

Wire 3-45 GOST 5663-79

Weight: 3g

7.62X39mm AR-SAF

Ring

DRAWN	SEEN BY	CHECKED
DATE	05/10/2023	
APPROVED		

SCALE
 N T S

SMALL ARMS FACTORY
KANPUR

DRG. NO.
SK-6575/TE

SHT. 1 OF 1

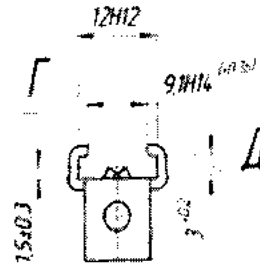
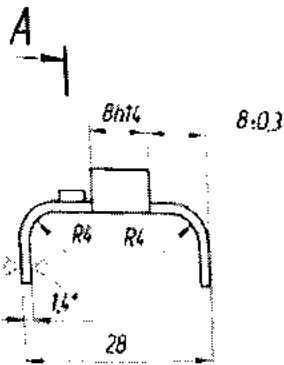

A-A(4:1)

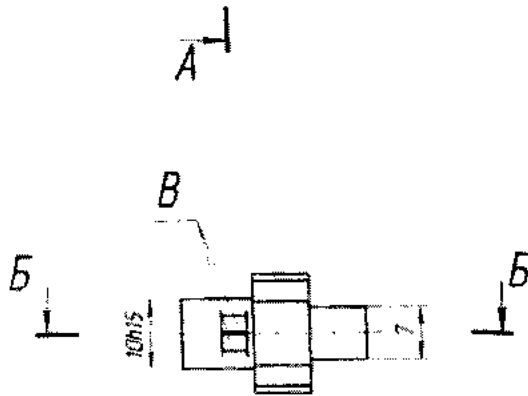

B-B(4:1)

Rupture is allowed

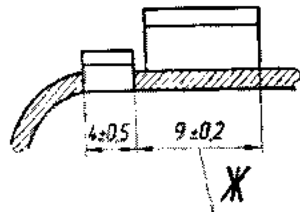
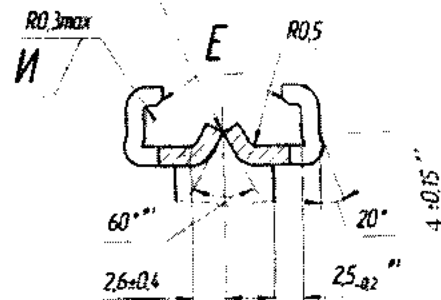

X

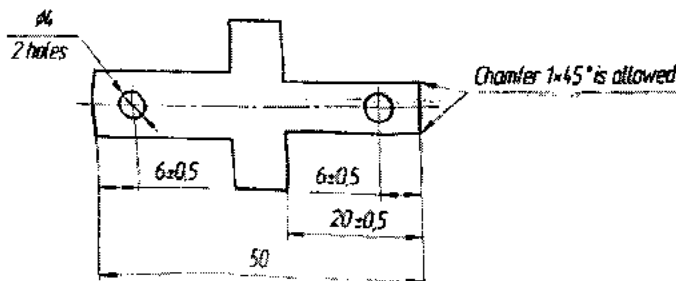

Rolling direction

Strip 35-14-60
GOST 2284-79

अरक्षण की सही प्रमाणित
प्रतिलिपि दिनांक.....
Certified as correct copy
of drg. on.....

क. कार्यालय प्रमुख
Jr. Works Manager
20/10/2023

- 1 65. 71HRA
- 2 * Reference dimension.
- 3 **Dimensions for tool contouring.
- 4 Dimensions to be insured by tool, except dimension f, B, X, Y
- 5 Unspecified tolerances according to 6X5COT4/E2
- 6 Appearance of protruded surfaces B and deformation of edges E according to control sample.
- 7 Coating is Chem Phos chr

7.62X39mm AR-SAF		Weight: 7.2	
Clip		DRAWN	SEEN BY
		DATE	20/10/2023
SMALL ARMS FACTORY KANPUR		APPROVED	
SCALE	1:1	DRG. NO.	
NTS		SK-6577/TE	
1 OF 1		1 OF 1	

$\sqrt{Rz 20}$ (M)

- 1 37-44 HRC. At hardness test point local smoothing of surface is allowed of depth up to 0.1 mm
- 2 Unspecified tolerances according to GKS 01/1/12
- 3 Position, size and quantity of technological defects, trace from mold spill, traces from ejectors should not exceed those specified by control sample
- 4 Rounding radii of outer and inner angles are 0.5 mm
- 5 0.05 % of parts but not less than 5 pcs from each lot are tested by static load (after machining and heat treatment) according to schematical diagram 1. Parts should not break down from 5000 N force. After testing, parts are checked for surface defects with flow detector. Parts subjected to load testing should not be used for assembly
- 6 Coating is Chem. Phos. chr./mpreg with Ep-4 glue GOST 12172-2016 with negative of grade A GOST 9307-78
- 7 Mark mold cavity number Font 2 (top) GOST 26008-85

MM-440 6065-10019/12

7.62X39 mm AR-SAF	SK-6578/TE
Latch	1 X 1
SMALL ARMS FACTORY	
NARFUR	
DATE 06.03.2023	
APP. 2023020	

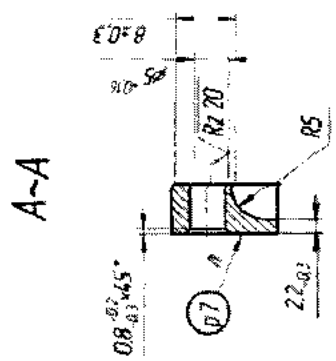

Schematic diagram 1 Static load testing

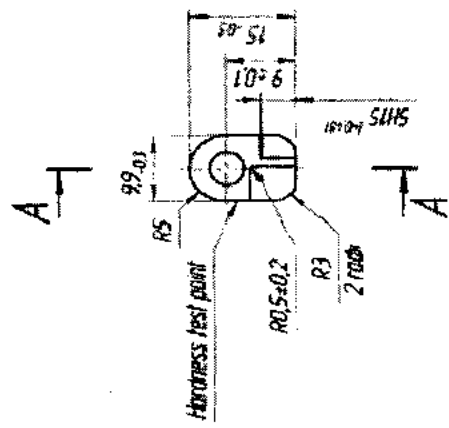
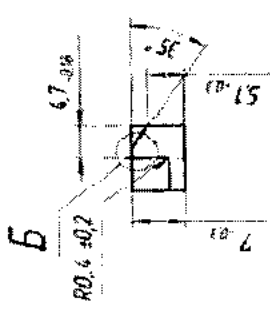
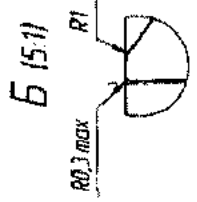
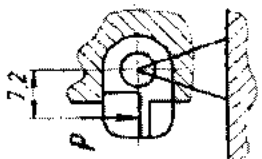

2023/2510
 आरेखण की सही प्रमाणित प्रतिलिपि दिनांक.....
 Certified as correct copy of drg. on.....
 क. कारिनाला प्रबन्धक
 Jr. Works Manager
 2023/02

SK-6578/TE

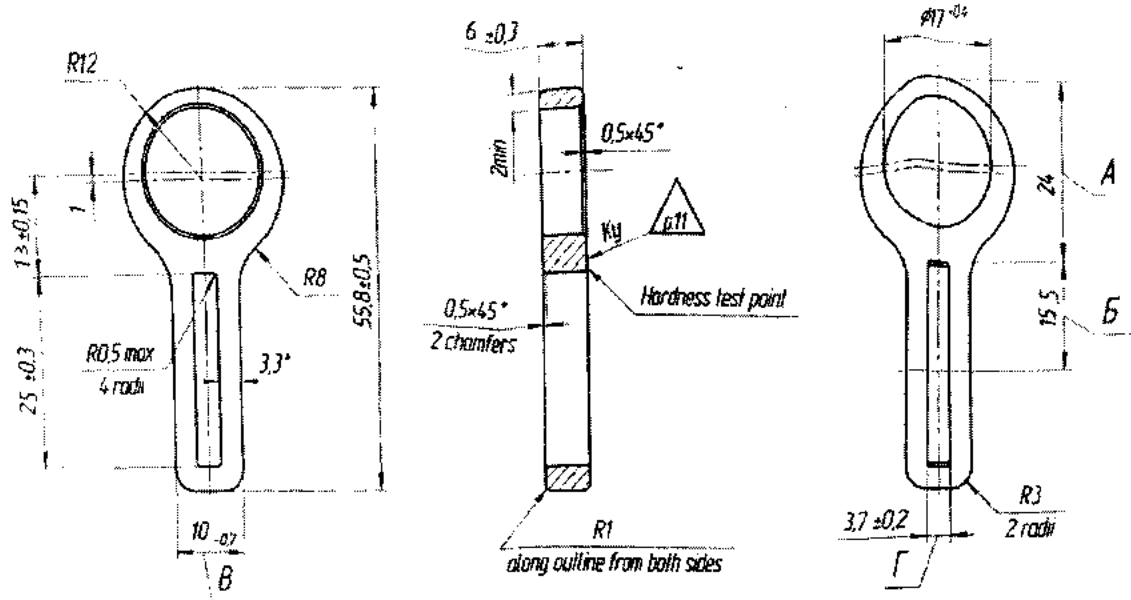

अखण्ड की सही प्रमाणित प्रतिलिपि दिनीक
 Certified as correct copy of drg. on.....
 क. कार्यालय प्रमुख
 Jr. Works Manager

- 1 34.0 - 39.5 HRC
- 2 Cast work piece is inspected with X-ray unit according to 6145-1.0879/E2
- 3 Position, size and quantity of cast defects, trace from mold split - according to control sample
- 4 Gate residue is allowed on side wall - not greater than 2 mm according to control sample
- 5 Pattern draft angles up to 1° to each side, increasingly
- 6 Unspecified tolerances according to 6X5C879/E2
- 7 * Reference dimension
- 8 ** Roughness to be ensured by tool
- 9 It is allowed to increase dimensions B and Γ by 0.4 mm at length B
- 10 Coating is Chem. Phos. chr; Coating of zone A is Chem Phos chr/impreg with 50-4 glue GOST 12172-2016 with nigrosine of grade A GOST 9307-78.
- 11 Stamp after QCD inspection according to 6X5C879/E2

7.62X39mm AR-SAF		Weight: 25 g	
Ring		DRAWN	BY
		DATE	CHECKED
SCALE NTS		APPROVE	
SMALL ARMS FACTORY KANPUR		DRG. NO. SK-6579/TE	
		SHT. 1 OF 1	

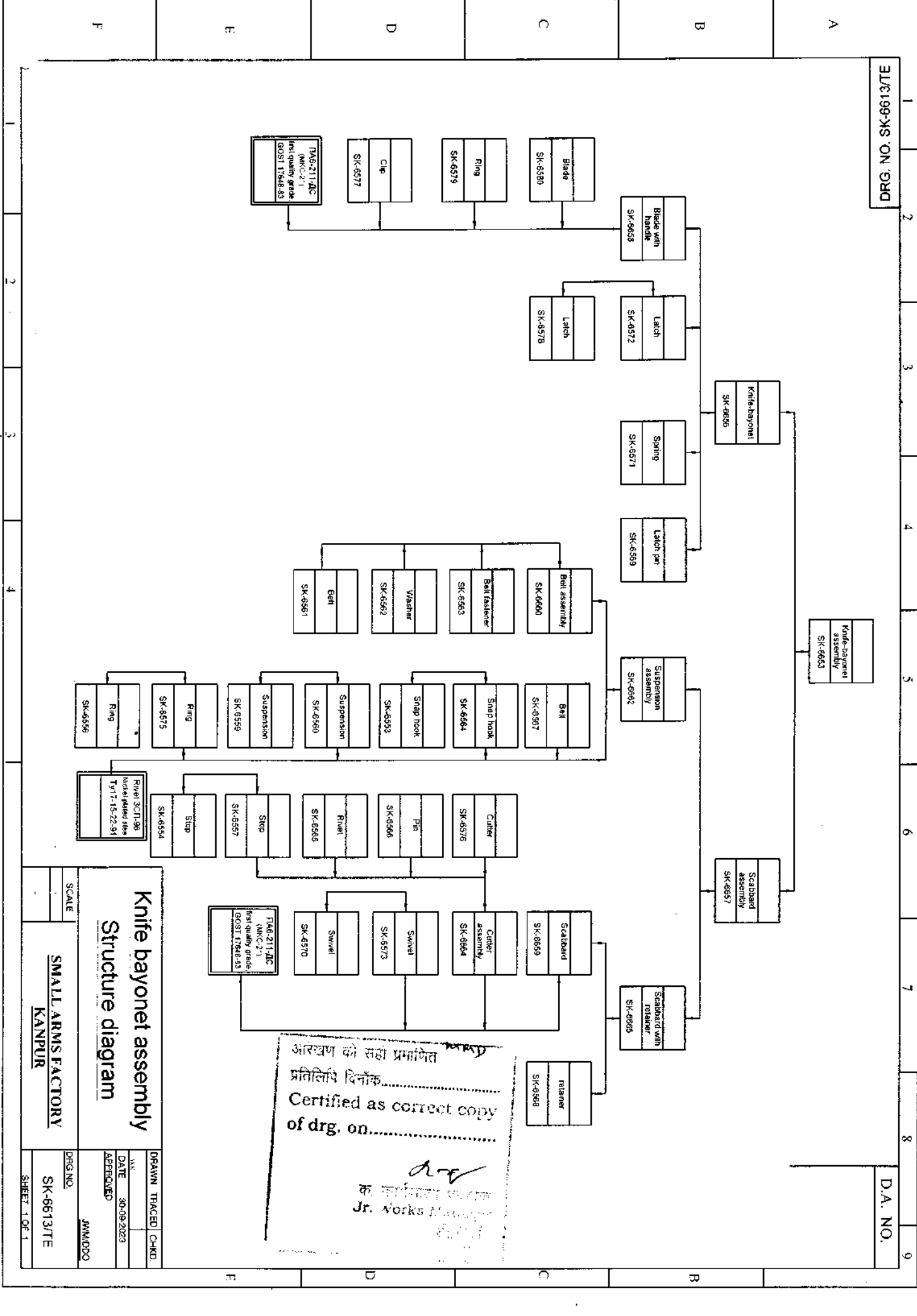

TM6-211-AC
(MCC-2-1)
First quality grade
GOST 17648-83

TM6-211-AC
(MCC-2-1)
First quality grade
GOST 17648-83

Rival 301-96
Nickel plated steel
Tj17-15-22-91

अखण्ड को सही प्रमाणित
प्रतिलिपि दिनांक
Certified as correct copy
of drg. on.....
क. लालिदा शर्मा
Jr. Works Manager

Knife bayonet assembly
Structure diagram

SMALL ARMS FACTORY
KANPUR

SCALE	DRAWN TRACED	CHD.
DATE	30-09-2023	
APPROVED	JMM/DDO	
DRG. NO.	SK-6613/TE	
SHEET	1 OF 1	

D-D

A-A

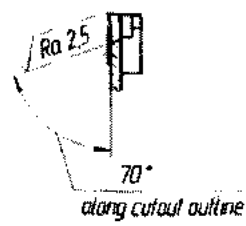
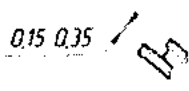
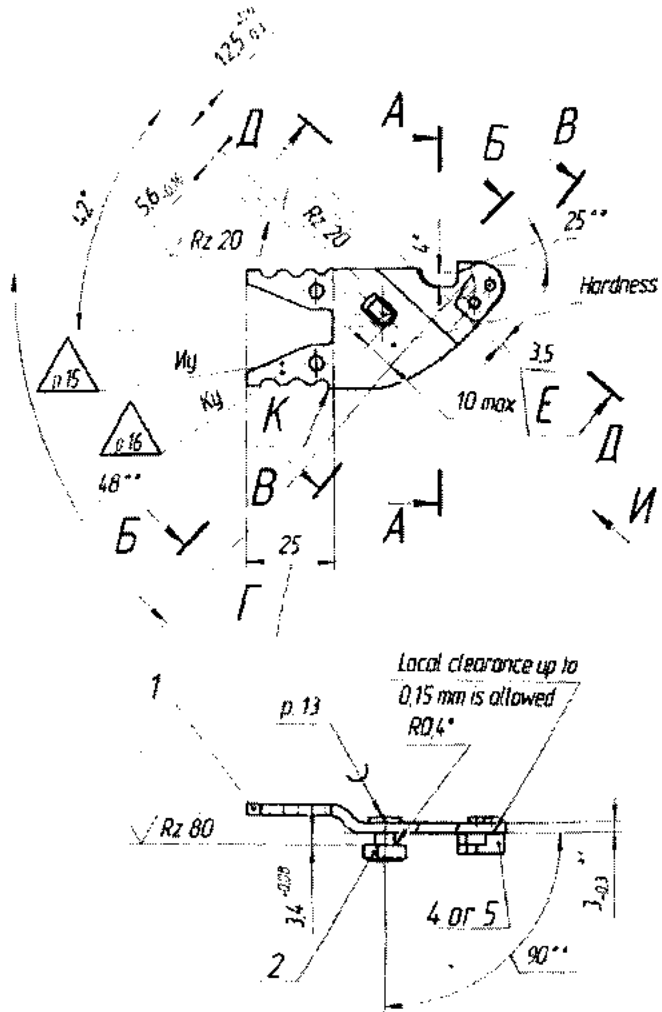

Rivets pos. 3, stop pos. 4 or pos. 5 not shown

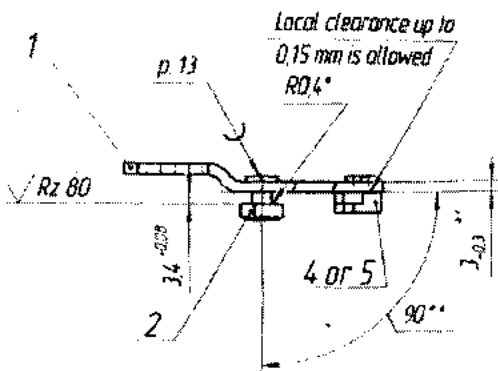
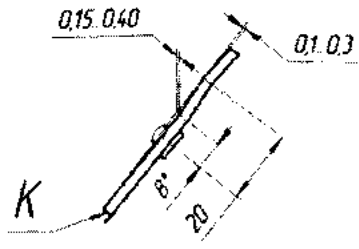

B-B(2:1)

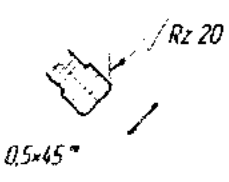

B-B(2:1)

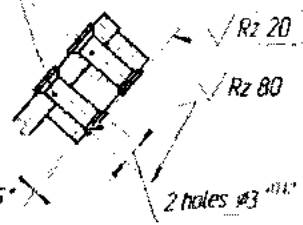

आरेखण की सही प्रमाणित
प्रतिलिपि दिनेक
Certified as correct copy
of drg. on.....
dc
क. आरेखण प्रमाणित
Jr. works Kanpur

- 1 51.5 - 57.0 HRC, harden without rivets pos. 3, stop pos. 4 or pos. 5. At hardness test point local smoothing of surface is allowed at depth up to 0.2 mm
- 2 * Dimensions to be ensured by tool
- 3 ** Reference dimension
- 4 Unspecified tolerances according to 6X5 C8T9/E2
- 5 Bend cutter pos. 1 after mounting pin pos. 2, according to view K
- 6 Holes X in stop 6X5.2-22/E2 to be made according to cutter holes
- 7 Stop protrusion beyond cutter outline is not allowed, depression - according to control sample. It is allowed to smooth stop with surface roughness $\sqrt{Rz 80}$
- 8 Rivets to be flattened out and smoothed to level of base surface. No smoothing is allowed. Appearance according to control sample
- 9 Do not blunt cutting edges of cutter
- 10 Motion of pin and stop is not allowed
- 11 Cutting edges of cutter should be overlapped by rotating blade-type gauge to stop not less than by 1.5 mm
- 12 Clearance not greater than 0.4 mm is allowed at zone E between cutter and stop
- 13 Solder is from band 0,3 alloy Г70HX or Г40HX ТУ 1-92-54-93, flux is NB200 GOST 23178-78
- 14 Coating is Chem Phos chr/impreg with 6Ф-4 glue GOST 12172-2016 with nigrosine of grade A GOST 9307-78. Coating of section Г is Chem Phos chr.
- 15 Stamp according to 6X5 C8T9/E2 after flaw detector check
- 16 Stamp after QCD inspection according to 6X5 C8T9/E2

7.62x39mm AR-SAF
Cutter assembly
Assembly drawing

SMALL ARMS FACTORY KANPUR	DRAWN: TRACED: CHKD:
	DATE: 20.09.21 APPROVED:
DRG. NO. SK-6652 / TE	R.S.000

Size	Zone	Pos.	Designation	Denomination	Qty.	Remark
				<i>Documentation</i>		
A1			6X5.C8CB/E2 (SK 6552/TE)	Assembly drawing		
A1			6X5.E1/E2 (SK 66613/TE)	Structure diagram		
A3			6X5.BC/E2 (SK 6654/TE)	List of specifications		
A4			6X5.BD/E2 (SK 6655/TE)	List of reference documents		
A4			6X5.C8TY/E2	Specifications		
				<i>Assembly units</i>		
A4	1		6X5.C81/E2 (SK 6656/TE)	Knife-bayonet	1	
A4	2		6X5.C82/E2 (SK 6657/TE)	Scabbard assembly	1	

आखण की सही प्रमाणित
प्रतिलिपि सिर्गाक.....
Certified as correct copy
of drg. on.....

क. प्रमोद कुमार
Jr. Works Manager
क. क.

7.62x39mm AR-SAF
Knife -bayonet assembly

DRAWN	TRACED	CHKD.
-------	--------	-------

S P SONI

DATE	29.09.23
------	----------

APPROVED

HOS/DDO

SCALE
N.T.S

SMALL ARMS FACTORY
KANPUR

DRG.NO.

SK-6653 / TE



Line No.	Designation	Denomination	Included in		Total Qty	Remark
			Designation	Qty		
1	6X5.C0/E2 (SK 6653/TE)	Knife-bayonet assembly			1	
2						
3	6X5.C01/E2 (SK 6656/TE)	Knife-bayonet	6X5.C0/E2	1	1	
4	6X5.C02/E2 (SK 6657/TE)	Scabbard assembly	6X5.C0/E2	1	1	
5						
6	6X5.C01-1/E2 (SK 6658/TE)	Blade with handle	6X5.C01/E2	1	1	
7	6X5.C02-1/E2 (SK 6659/TE)	Scabbard	6X5.C02-5/E2	1	1	
8	6X5.C02-2/E2 (SK 6660/TE)	Belt assembly	6X5.C02-3/E2	1	1	
9	6X5.C02-3/E2 (SK 6662/TE)	Suspension assembly	6X5.C02/E2	1	1	
10	6X5.C02-4/E2 (SK 6664/TE)	Cutter assembly	6X5.C02-1/E2	1	1	
11	6X5.C02-5/E2 (SK 6665/TE)	Scabbard with retainer	6X5.C02/E2	1	1	
12						
13						
14						
15						
16						
17						
18						
19						
20						
21						
22						
23						

20/11/20

अखण्ड को सही प्रमाणित
प्रतिलिपि दिनांक.....
Certified as correct copy
of drg. on.....

K. K. Sharma
Jr. Works Manager

7.62x39mm AR-SAF
Knife bayonet assembly
List of specifications

DRAWN	TRACED/CHKD
S.P. SONI	
DATE	29.09.23
APPROVED	

HOS/DOO

DRG. NO. **SK-6654 / TE**

SMALL ARMS FACTORY
KANPUR

SCALE
N.T.S.

LINE No.	Designation	Denomination
1		Company documents
2		
3	6П45-1.08 TY/E2	7,62 mm AK203 Kalashnikov assault rifle
4		Specifications
5		
6		Industry documents
7		
8	TY 1-92-54-93	Solder bands and strips of grades Г70HX and Г40HX. Specifications
9		
10	TY 3-1303-12-90	Steel shaped profiles of steel 8XΦ.
11		Specifications
12	TY 6-10-1344-78	Enamel HJ-5134. Specifications
13	TY 6-14-571-80	Organic coloring agent
14		Brown kaprozol 4K. Specifications
15	TY 14-11-245-88	High precision steel shaped profiles.
16		Specifications
17	TY 17-15-22-91	Eyelet rings, grommets, rivets for light
18		industry items.
19		Specifications
20	TY 20.16.59-001-23124265-2018	BASKO concentrates.
21		Specifications
22		
23		

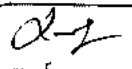
अखण्ड को सही प्रमाणित प्रतिलिपि दिनांक.....
 Certified as correct copy of drg. on.....

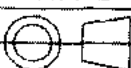
 K. Karim
 Jr. Works Manager

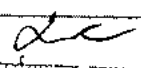
<p align="center">7.62x39mm AR-SAF</p> <p align="center">Knife bayonet assembly</p> <p align="center">List of referance documents</p>		DRAWN	TRACED	CHKD.
		S P SONI		
		DATE	29.09.23	
		APPROVED		
SCALE		HOS/DDO		
N.T.S		DRG.NO.		
		SMALL ARMS FACTORY		
		KANPUR		
		SK-6655- / TE		
		1 of 4 sheets		

Line No.	Designation	Denomination
1		State documents
2		
3	GOST 26.008-85	Fonts for inscriptions applied by
4		engraving method.
5		Executive dimensions
6	GOST 938.30-78	Leather. Test methods for brittleness
7		and fragility.
8	GOST 977-88	Steel castings.
9		General specifications
10	GOST 1050-2013	Metal products from nonalloyed
11		structural quality and special steels.
12		General specifications
13	GOST 1051-73	Gauged bars.
14		General specifications
15	GOST 1904-81	Leather for saddlery.
16		Specifications
17	GOST 2284-79	Cold-rolled carbon structural steel strip.
18		Specifications
19	GOST 4986-79	Cold-rolled strips of corrosion-resistant
20		and heat-resistant steel.
21		Specifications
22	GOST 5663-79	Cold heading carbon steel wire.
23		Specifications
24	GOST 5950-2000	Tool alloy steel bars, strips and coils.
25	अखण्ड को सही प्रमाणित प्रतिलिपि प्रमाणित	General specifications
26	Certified as correct copy	
27	of drg. on.....	
28		
29	क. कर्मचारी प्रमुख Jr. Works Man	
		SK-6655-/ TE
		2 of 4 sheets
Rev	Sheet	Doc. No.
		Sign
		Date
		Size
		A4
		Sheet
		2

Line No.	Designation	Denomination
1	GOST 7417-75	Calibrated round steel.
2		Dimensions
3	GOST 7885-86	Carbon black for rubber industry.
4		Specifications
5	GOST 9307-78	Organic dyes. Alcohol soluble nigrosine.
6		Specifications
7	GOST 9389-75	Carbon steel spring wire.
8		Specifications
9	GOST 9439-85	Polyvinylbutyral.
10		Specifications
11	GOST 12172-2016	Phenol-polyvinylacetyl adhesives.
12		Specifications
13	GOST 12707-77	Wash primers.
14		Specifications
15	GOST 16523-97	Rolled sheets from quality and ordinary
16		carbon steel for general purposes.
17		Specifications
18	GOST 17305-91	Wire of carbon constructional steel.
19		Specifications
20	GOST 17648-83	Glass filled polyamides.
21		Specifications
22	GOST 18143-72	High-alloy corrosion-resistant and heat-
23		resistant steel wire.
24		Specifications
25		Certified as correct copy
26		of drg. on.....
27		
28		
29		

40-A0324	14.07.22	40-A0324	14.07.22
Rev	Sheet	Doc No	Sign Date

SK-6655 / TE
3 of 4 Sheets

Sheet
3

Line No.	Designation	Denomination
1	GOST 18335-83	Enamel HL-184.
2		Specifications
3	GOST 19904-90	Cold-rolled steel sheets.
4		Dimensions
5	GOST 21474-75	Straight and diamond knurls.
6		Form and basic dimensions
7	GOST 23178-78	High-temperature fluoroborate and boride
8		halogenide fluxes for soldering.
9		Specifications
10		
11		
12		
13		
14		
15		
16		
17		
18		
19		
20		
21		
22		
23		
24		
25		
26		
27		
28		
29		

200 / 15.10.77

अनुपम को सही प्रमाणित
प्रमाणित दितांक

Certified as correct copy
of drg. on.....

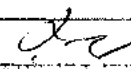
क. कर्णेश्वर प्रसाद
Jr. Works Manager

					SK 6655 / TE 4 of 4 Sheets	Sheet 4
Rev	Sheet	Doc. No.	Sign.	Date		

Size	Zone	Pos.	Designation	Denomination	Qty.	Remark
				<u>Documentation</u>		
A2			6X5.C81C6/E2 (SK 6558/TE)	Assembly drawing		
				<u>Assembly units</u>		
A4		1	6X5.C81-1/E2 (SK 6658/TE)	Blade with handle	1	
				<u>Parts</u>		
A3		2	6X5.1-7/E2 (SK 6571/TE)	Spring	1	
A3		3	6X5.1-8/E2 (SK 6566/TE)	Latch pin	1	
A3		4	6X5.1-13/E2 (SK 6572/TE)	Latch		1 pc, allowed to be replaced with pos.5
*1		5	6X5.1-14/E2 (SK 6578/TE)	Latch		*1) A4x3 1 pc, use instead of pos.4

आरेखण की सही प्रमाणीत
प्रतिलिपि दिनांक.....
Certified as correct copy
of drg. on.....

[Signature]
क. कार्यालय
Jr. Works

<p>7.62x39mm AR-SAF Knife bayonet</p>		DRAWN	TRACED	CHKD.
		S.P. SONI		
<p>SCALE N.T.S.</p>		DATE	29.09.23	
		APPROVED		
<p>SMALL ARMS FACTORY KANPUR</p>		HOS/DDO		
		DRG.NO.	SK-6656 / TE	

Size	Zone	Pos.	Designation	Denomination	Qty	Remark
				<u>Documentation</u>		
A1			6X5.C81-1CB/E2 (SK 6551/TE)	Assembly drawing		
				<u>Parts</u>		
A1		1	6X5.1-1/E2 (SK 6580/TE)	Blade	1	
A2		2	6X5.1-2/E2 (SK 6579/TE)	Ring	1	
A2		3	6X5.1-12/E2 (SK 6577/TE)	Clip	1	
				<u>Material</u>		
		4		ПА 6-211-ДЦ (МКС-21), first quality grade, GOST 17648-83		

english

20/09/23

कारखाने की सही प्रमाणित
प्रतिलिपि प्रस्तुत
Certified as correct copy
of drg. on.....

[Signature]
Mr. V. S. ...
Jr. ...

10-00311 7 A 10 03 22	7.62x39mm AR-SAF	DRAWN	TRACED	CHKD.
	Blade with handle	S P SONI		
	SCALE N.T.S.	DATE 29.09.23		
		APPROVED SK-6658 / TE HJS/DDO		
SMALL ARMS FACTORY KANPUR		DRG.NO.		

Prim. Usage	Size	Zone	Pos.	Designation	Denomination	Qty	Remark
Reference No. english					Documentation		
	A4			6X5C82-2CB/E2 (SK 6661/TE)	Assembly drawing		
					Parts		
	A4	1		6X5.2-14/E2 (SK 6563/TE)	Belt fastener	1	
	A4	2		6X5.2-15/E2 (SK 6562/TE)	Washer	1	
	A4	3		6X5.2-16/E2 (SK 6561/TE)	Belt	1	



Sign and Date	Copy Inv. No.	Repl. Inv. No.	Sign and Date

सुप्रसन्न

आदरणीय श्री राजी प्रकाश
प्रतिलिपि विभागात्.....
Certified as correct copy
of drg. on.....

[Signature]
क. कामेश्वर प्रसाद
Jr. works

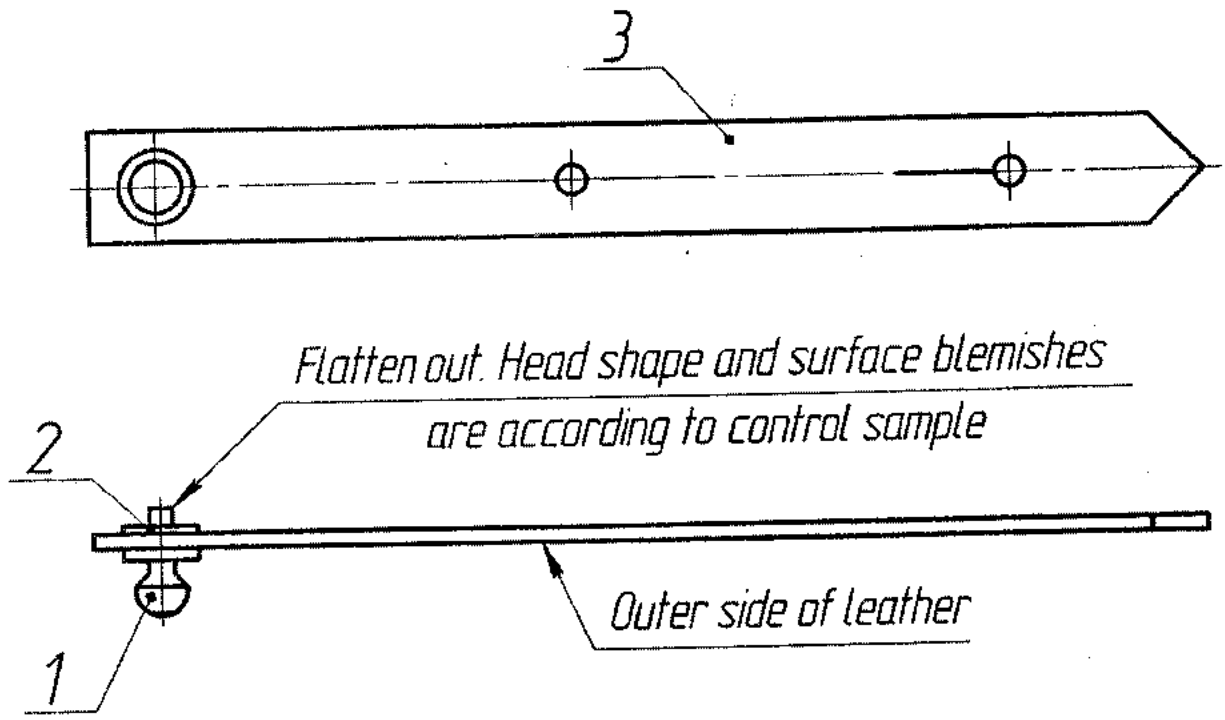
Dwg. Inv. No. 40-A0330	SCALE N.T.S.	SMALL ARMS FACTORY KANPUR	DRAWN	TRACED	CHKD.
Sign and Date C.A. 14.07.22	7.62x39mm AR-SAF Belt Assembly		DATE	29.09.23	
			APPROVED		
			HOS/DDO		
			DRG. NO. SK- 6660 / TE		

Prim. Usage																											
Reference No. english																											
Sign. and Date																											
Copy Inv. No.																											
Repl. Inv. No.																											
Sign. and Date	19/11/14.07.22																										
Drg. Inv. No. 40-A0331	SCALE N.T.S. 	SMALL ARMS FACTORY KANPUR	<table border="1"> <tr> <td>DRAWN</td> <td>TRACED</td> <td>CHKD.</td> </tr> <tr> <td></td> <td></td> <td></td> </tr> <tr> <td colspan="3">S P SONI</td> </tr> <tr> <td>DATE</td> <td colspan="2">29.09.23</td> </tr> <tr> <td colspan="3">APPROVED</td> </tr> <tr> <td colspan="3" style="text-align: right;">HOS/DDO</td> </tr> <tr> <td colspan="3">DRG.NO.</td> </tr> <tr> <td colspan="3">SK- 6661 / TE</td> </tr> </table>	DRAWN	TRACED	CHKD.				S P SONI			DATE	29.09.23		APPROVED			HOS/DDO			DRG.NO.			SK- 6661 / TE		
DRAWN	TRACED	CHKD.																									
S P SONI																											
DATE	29.09.23																										
APPROVED																											
HOS/DDO																											
DRG.NO.																											
SK- 6661 / TE																											

Jumunda

आखण की सही प्रमाणित
प्रतिलिपि मिलीक.....
Certified as correct copy
of drg. on.....

de

क. कारखाना प्रमुख
Jr. works Manager

Size	Zone	Pos.	Designation	Denomination	Qty	Remark
				<u>Documentation</u>		
A3			6X5.C82-3C8/E2 (SK 6663/TE)	Assembly drawing		
				<u>Assembly units</u>		
A4		1	6X5.C82-2/E2 (SK 6660/TE)	Belt assembly	1	
				<u>Parts</u>		
A4		2	6X5.2-7/E2 (SK 6567/TE)	Belt	1	
*1		3	6X5.2-10/E2 (SK 6564/TE)	Snap hook		*1) A4; A4x3 1 pc, combined with pos.5 and pos.6, allowed to be replaced with pos.7 combined with pos.4 and pos.8
				<div style="border: 1px solid black; padding: 5px; width: fit-content;"> <p style="text-align: right;">Sumit</p> <p>आरेखण की सही प्रमाणात प्रतिलिपि दिनांक..... Certified as correct copy of drg. on.....</p> <p style="text-align: right;">फ. कार्तिकेय शर्मा Jr. Verker</p> </div>		
A4		4	6X5.2-18/E2 (SK 6560/TE)	Suspension		1 pc, combined with pos.7 and pos.8, use instead of pos.5 combined with pos.3 and pos.6

Prim Usage
Reference No
english
Sign and Date
Copy Inv. No.
Repl. Inv. No.
Sign and Date
Orig. Inv. No.
40-AD534
2/14.07.22

**7.62x39mm AR-SAF
Suspension assembly**

SCALE
N.T.S.

**SMALL ARMS FACTORY
KANPUR**

DRAWN	TRACED	CHKD.
SP SON		
DATE	29.09.23	
APPROVED		
HJS/DDO		
DRG. NO.		
SK-6662 / TE		
1 of 2 Sheet		

Size	Zone	Pos.	Designation	Denomination	Qty.	Remark
A4		5	6X5.2-19/E2 (SK 6559/TE)	Suspension		1 pc, combined with pos.3 and pos. 6, allowed to be replaced with pos.4 combined with pos.7 and pos.8
A4		6	6X5.2-20/E2 (SK 6575/TE)	Ring		1 pc, combined with pos.3 and pos.5; allowed to be replaced with pos.8 combined with pos.4 and pos.7
A3		7	6X5.2-23/E2 (SK 6553/TE)	Snap hook		1 pc, combined with pos.4 and pos.8, use instead of pos.3 combined with pos.5 and pos.6
A4		8	6X5.2-25/E2 (SK 6556/TE)	Ring		1 pc, combined with pos.4 and pos.7, use instead of pos.6 combined with pos.3 and pos.5
		9		Rivet 3CP-96, nickel steel TY 17-15-22-91	2	

(20 mm)

मोटे कागज की सही प्रतिलिपि
प्रमाणित किया गया
Certified as correct copy
of drg. on.....

df
क. कार्तिकाय शर्मा
Jr. works Manager

Other items

Orig. Inv. No. 40-40334
 Sign. and Date 21/11/07.02.
 Repl. Inv. No.
 Copy. Inv. No.
 Sign. and Date

Prm Usage	Reference No	English	40-A0935	4/14/0722	Sign and date	Copy Inv No	Reel Inv No	40-A0935
-----------	--------------	---------	----------	-----------	---------------	-------------	-------------	----------

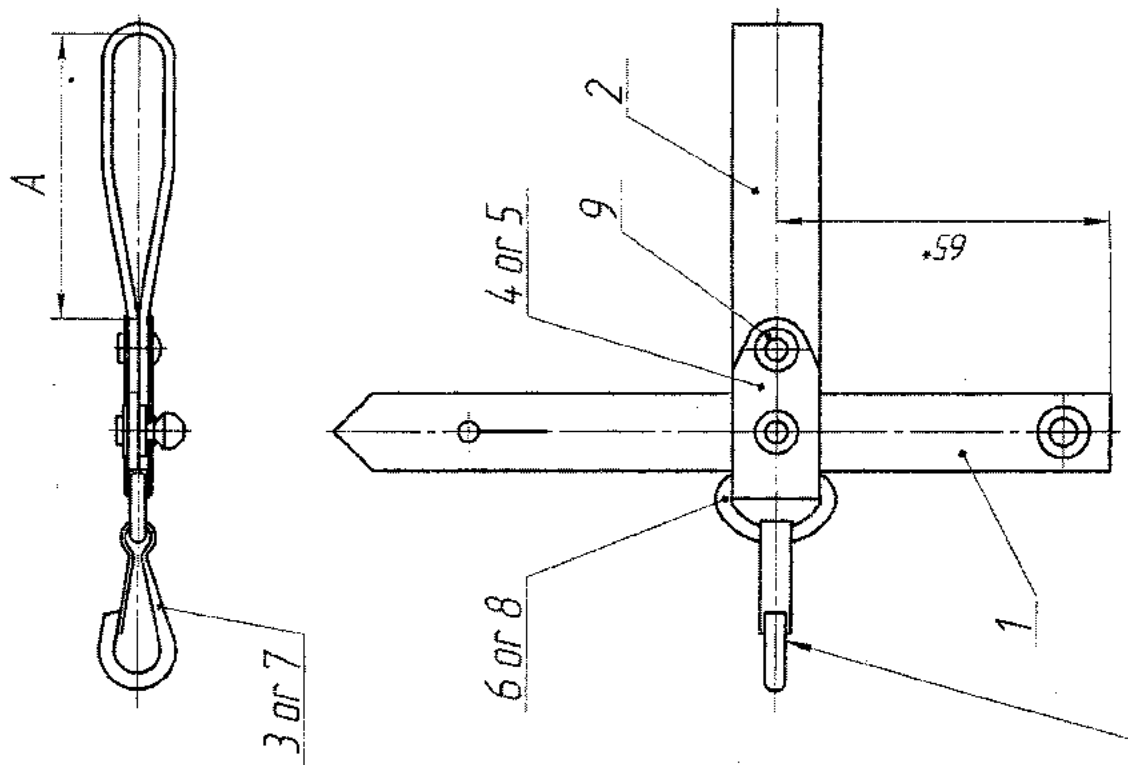

2mm/mm

आरेखण की सही प्रमाणित
प्रतिलिपि दिभोक.....
Certified as correct copy
of drg. on.....

[Signature]
क. क. [Name]
Jr. work [Name]

- 1 * Reference dimension.
- 2 If is allowed to coat inner surface of rivets pos. 9 with enamel HLL-5134k of aluminum color TY 6-10-1344-78.
- 3 Rivet heads are allowed to fit to suspension pos. 4 or 5 with clearance up to 0,2 mm at half circle.
- 4 Ensure that plate with section (3x55) mm can enter dimension A of belt loop pos. 2.

DRAWN		TRACED		CHKD
		S.P. 90M		
DATE		29.09.23		APPROVED
HOS/DDO		HOS/DDO		
7.62x39mm AR-SAF Suspension assembly assembly drawing			DRG. NO. SK-6663 / TE	
SMALL ARMS FACTORY KANPUR			SCALE N.T.S.	

Size	Zone	Pos.	Designation	Denomination	Qty	Remark
				<u>Documentation</u>		
A2			6X5.082-4CB/E2 (SK 6652/TE)	Assembly drawing		
				<u>Parts</u>		
A2		1	6X5.2-2/E2 (SK 6576/TE)	Cutter	1	
A4		2	6X5.2-9/E2 SK 6566/TE	Pin	1	
A4		3	6X5.2-12/E2 SK 6565/TE	Rivet	2	
A4		4	6X5.2-22/E2 SK 6557/TE	Stop		1 pc, allowed to be replaced with pos.5
A3		5	6X5.2-24/E2 SK 6554/TE	Stop		1 pc, use instead of pos.4

29/09/23

अवश्यम वरि सरो प्रमाणित
प्रतिलिपि दिनांक.....
Certified as correct copy
of drg. on.....

[Signature]
क. कार्तिकांत प्रसाद
Jr. Works Manager

Orig. Inv. No. 40-A0332
Sign. and Date 14.07.22

<h2>7.62x39mm AR-SAF Cutter assembly</h2>		DRAWN	TRACED	CHKD.
		S P SONI		
		DATE	29.09.23	
		APPROVED		
		HOS/DDO		
SCALE N.T.S.	SMALL ARMS FACTORY KANPUR		DRG.NO. SK 6664 /TE	

Size	Zone	Pos.	Designation	Denomination	Qty	Remark
				Documentation		
A3			6X5C82-5CB/E2 SK 6666/TE	Assembly drawing		
				Assembly units		
A4	1		6X5C82-1/E2 SK 6659/TE	Scabbard	1	
				Parts		
A1	2		6X5.2-8/E2 SK 6568/TE	Retainer	1	

Oha. Inv. No. 40-80336
 Sign and Date 7.11.14.0922
 Repl. Inv. No.
 Copy Inv. No.
 Sign and Date

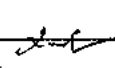
20/11/2014
 भरखण की सही प्रमाणित
 प्रतिरूप दिवस.....
 Certified as correct copy
 of drg. on.....

 क. कार्तिकेय
 Jr. works

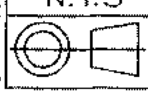
7.62x39mm AR-SAF Scabbard with retainer	DRAWN	TRACED	CHKD.
	S.P. SONI		
	DATE	29.09.23	
	APPROVED		
			HOS/DDO
SCALE N.T.S.	SMALL ARMS FACTORY KANPUR		DRG. NO. SK 6665 / TE

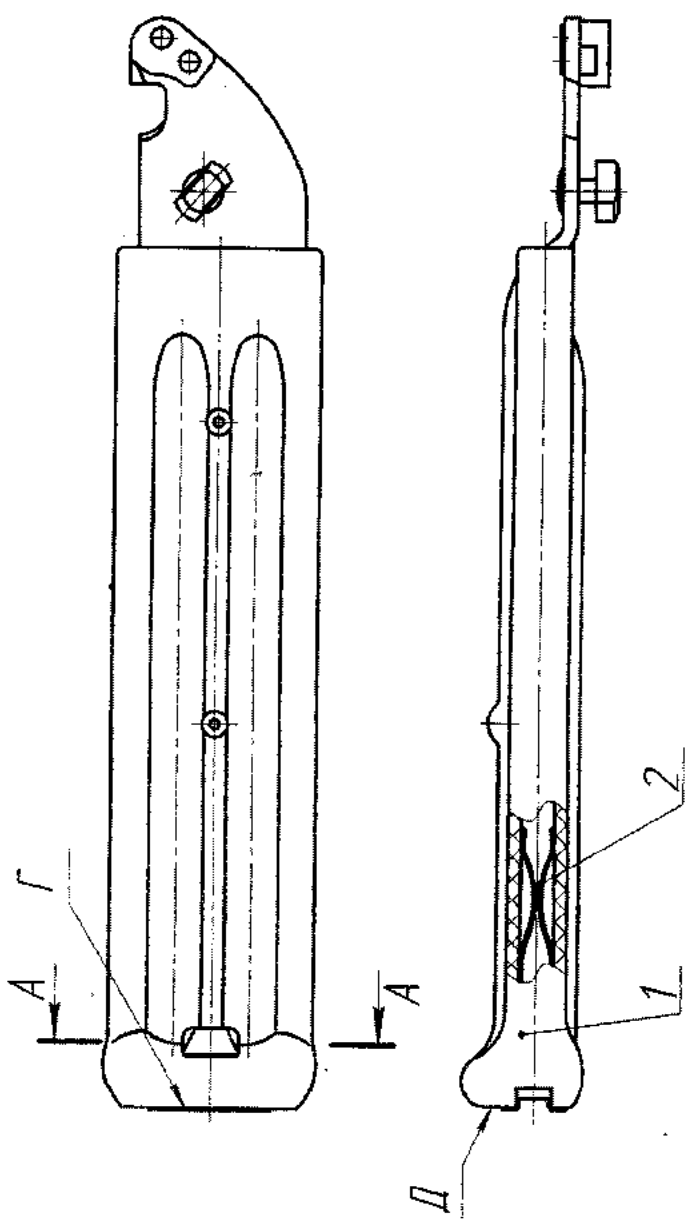

Reference No.	english
Form Usage	

Draw. Inv. No.	HO-00337
Sign. and Date	<i>[Signature]</i>
Repl. Inv. No.	
Copy Inv. No.	
Sign. and Date	



A-A

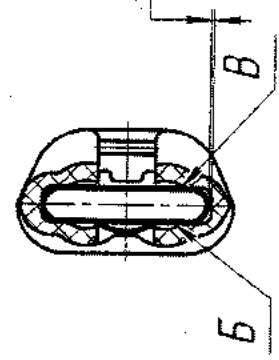

Side clearance up to 1.3 mm is allowed

Swalman

अखण की सही प्रमांयत
प्रतिलिपि दिनांक.....
Certified as correct copy
of drg. on.....

[Signature]

क. कर्मायुध मण्डल
Jr. Works Manager

- 1 Retainer pos. 2 should enter scabbard pos. 1 freely and come out using standard accessories.
- 2 Longitudinal movement of retainer up to 0.6 mm is allowed.
- 3 Ensure tight press of retainer to scabbard along planes B and B.
- 4 When retainer tightly presses side end of scabbard, 0.9 mm feeler should not go between bends Γ of retainer and scabbard side end Δ.

7.62x39mm AR-SAF		DRAWN	TRACED	CHKD
Scabbard with retainer assembly drawing		S.P. SOAN		
		DATE	29.09.23	
		APPROVED		
SCALE	HQS/IDD			
N.T.S.	DRG. NO.			
	SMALL ARMS FACTORY			
	KANPUR			
	SK 6666 /TE			