

NOTE:-

WHERE TOLERANCES ARE NOT SHOWN

DIMENSIONS WITH TWO DECIMAL PLACES ± 0.127 MM.

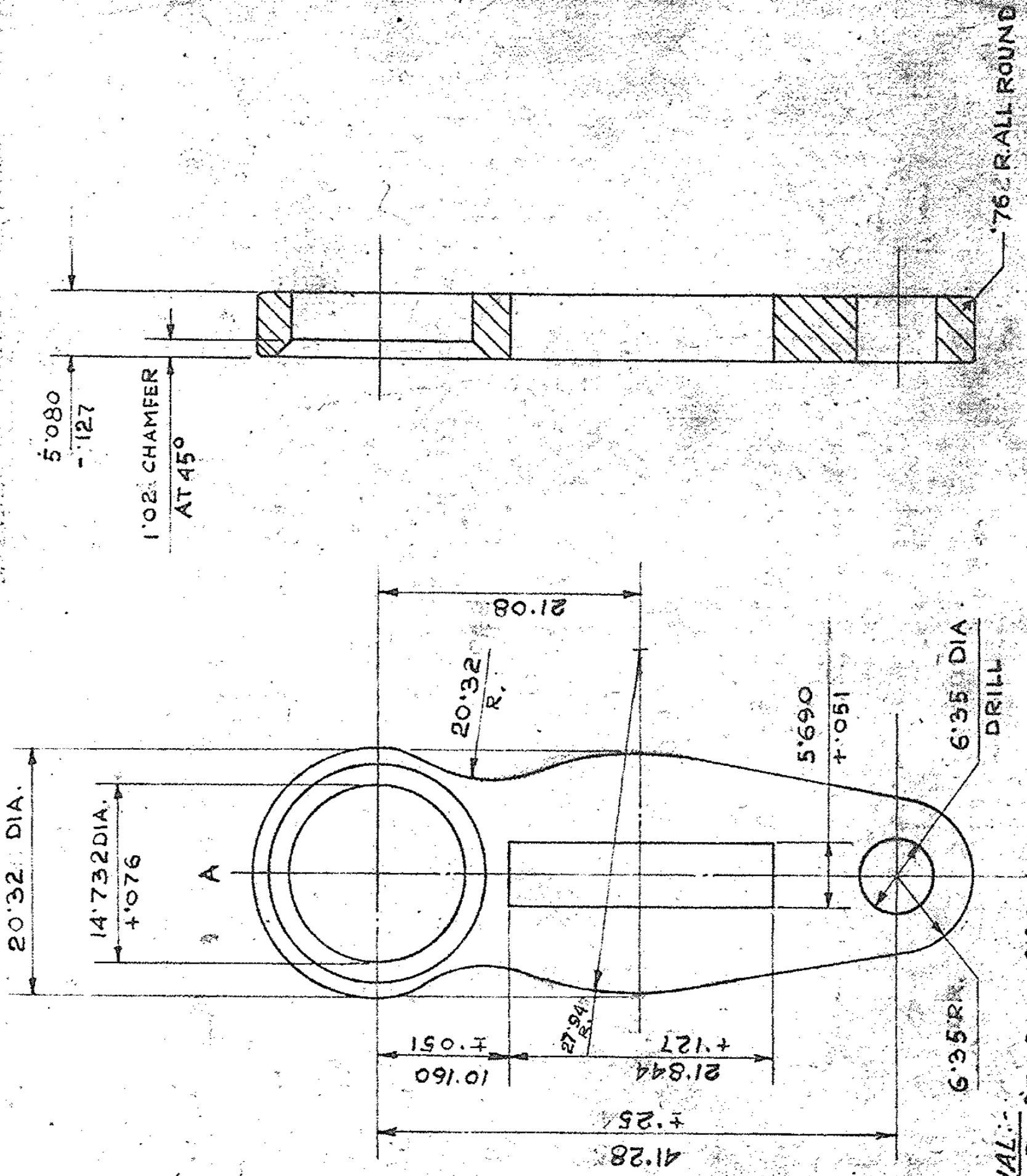

MATERIAL:-
STEEL BS: 970 PT.1: 1983
SEC.2 GR.080 M-40

ALT. MATERIAL:-

IS: 5517-1978 Gr.40 C8.
 HARDENED & TEMPERED CONDITION.

HARDNESS:- 350-400 H.V.

SECTION A-A

METRIC

30.595	22980 -SA				ASSY. DRG. ICR77 SA & DS. CAT. NO. 1005-001720
2-12-92	22072-SA	MATERIAL AMENDED.	ISO	DRAWN CHECKED	TRACED TRN. END
16.4.79	15947-SA	MATL. AMENDED	LTCOL	APPROVED	
22.9.76	14799-SA	DRG. SEALED	DSS		
DATE	AUTHY.	ZONE	NATURE	SIG.	
AMENDMENTS					
SEALED:- D.C.CI) 14799-SA, DT. 22.9.76					
MATERIAL:- STEEL BS: 970 PT.1: 1983 ABOVE					
PROTECTIVE FINISH:- AFTER ASSLY.					
ESTIMATED WEIGHT:-					
SCALE:- 2/1					
DESIGNER'S REF. ARDE 928/3					
DATE 26.6.67					
DESIGNER'S REF. FOR CISA					
DATE 1/6/70					
DESIGNER'S REF. 1005-001722					