

1

159

CAT/PART NO.	NOMENCLATURE	QTY. OF PARTS	DRAWING NO.
	MOUNTING BRACKET ASSEMBLY	1	142 1 01 03 04 05 000
	MOUNTING BRACKET	1	142 1 01 03 04 05 M01
	POST 2 FOR RC CARD	4	142 1 01 03 04 05 M02
	COVER LOGIC CARD	1	142 1 01 03 04 05 M03
	CMOS MOUNT	1	142 1 01 03 04 05 M04
	TEFLON WASHER 2MM	20	142 1 01 03 04 05 M05
	TEFLON WASHER 4MM	20	142 1 01 03 04 05 M06
	TEFLON WASHER 6MM	20	142 1 01 03 04 05 M07
	C CLAMP FOR L3 CCD	1	142 1 01 03 04 05 M08
TRADE ITEMS			
	HEX. SOCKET HD CAP SCREW M2.5x25 IS:2269 'A2' S.S.	4	
	HEX. SOCKET HD CAP SCREW M2.5x12 IS:2269 'A2' S.S.	4	
	HEX. SOCKET HD CAP SCREW M2.5x8 IS:2269 'A2' S.S.	12	
	HEX. SOCKET HD CAP SCREW M5.0x12 IS:2269 'A2' S.S.	6	
	GUIDE PIN Ø8.0 X 10 IS:6689 'A2' S.S.	1	
	GUIDE PIN Ø5.0 X 10 IS:6689 'A2' S.S.	1	
	FLAT WASHER M2.5 IS:2016 'A2' S.S.	22	
	SPRING WASHER M2.5 IS:3063 'A2' S.S.	22	
	FLAT WASHER M5 IS:2016 'A2' S.S.	6	
	SPRING WASHER M5 IS:3063 'A2' S.S.	6	
	HELICOIL INSERT M2x2.5D 'A2' S.S.	4	
	HELICOIL INSERT M2.5x2D 'A2' S.S.	34	
	HELICOIL INSERT M2.5x2.5D 'A2' S.S.	4	
	COUNTER SUNK SLOTTED HD SCREW M2.5x15 'A2' S.S.	20	

FOR TRADE ONLY
 Date of issue: 06/10/2020
[Signature]

ISSUE	AUTH.	DATE	USED ON	NAME & SIG.	DATE
				DESIGNED BY	
				DRAWN BY	
				CHECKED BY	
				APPROVED BY	
				BASED ON	

ALL DIMENSIONS ARE IN MM.

TITLE: MOUNTING BRACKET ASSEMBLY

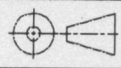

IRDE INSTRUMENTS RESEARCH & DEVELOPMENT ESTABLISHMENT, DEHRA DUN

DRG. NO. 142 1 01 03 04 05 000

SHT OF

2

158

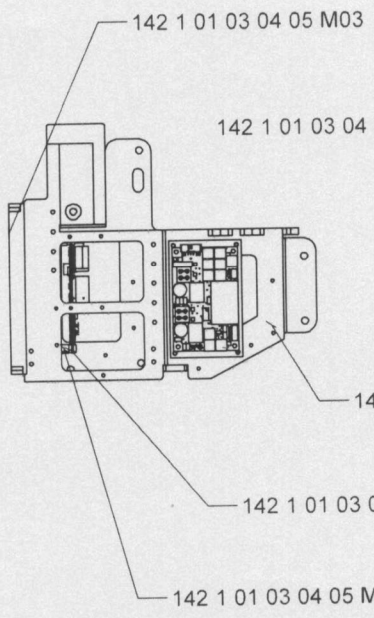
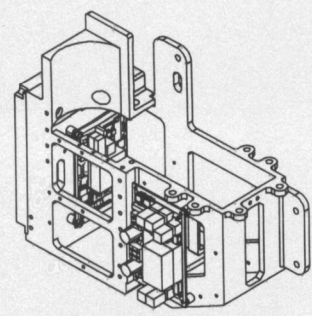
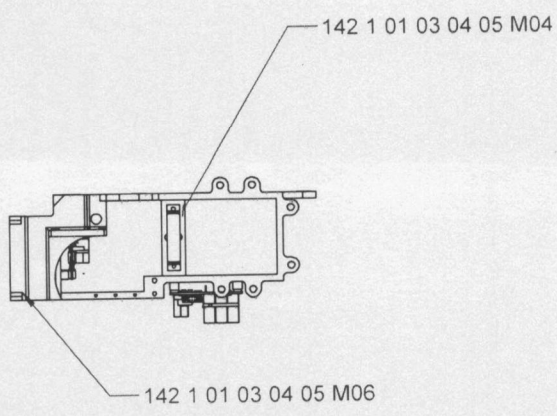

142 1 01 03 04 05 M07

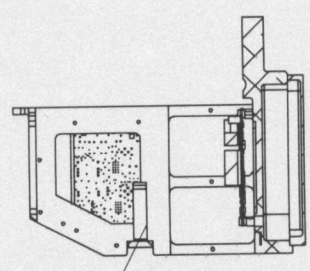
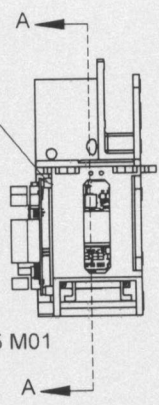

SECTION A-A

FOR TRADE ONLY
 Date of Issue 26/10/2022
 Ref

					MATERIAL : SEE DETAIL DRG							
					FINISH : SEE DETAIL DRG							
					GENERAL MACHINING TOLERANCE :					AUTHORITY		
					LINEAR UP TO 30 ±0.2					DESIGNED BY		
					>30-120 ±0.3					DRAWN BY		
					>120-315 ±0.5					CHECKED BY		
					>315 ±0.8					APPROVED BY		
					ANGULAR ±30'					CAT/ PT. NO.		
					POSITION ±0.1					BASED ON		
					CONCENTRICITY ±0.1					USED ON		
					SURFACE FINISH <12.5 μm							
					CORNER RADIUS 0.5(MAX.)							
					CHAMFER ON EDGES 0.5X0.5							
					ROUGHNESS SYMBOL							
					ROUGHNESS VALUE (μm)							
					50 - 25							
					25 - 6.3							
					6.3 - 0.8							
					0.8 - 0.1							
					< 0.1							
SYMBOL					ORIGINAL							
ZONE					AUTH.							
ISSUE					DATE							
ALL DIMENSIONS ARE IN mm UNLESS OTHERWISE SPECIFIED					TITLE:					IRDE INSTRUMENTS RESEARCH & DEVELOPMENT ESTABLISHMENT, DEHRA DUN		
					MOUNTING BRACKET ASSEMBLY					DRG. NO.142 1 01 03 04 05 000		
										SCALE: 1:5 SHEET 1 OF 1		

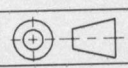

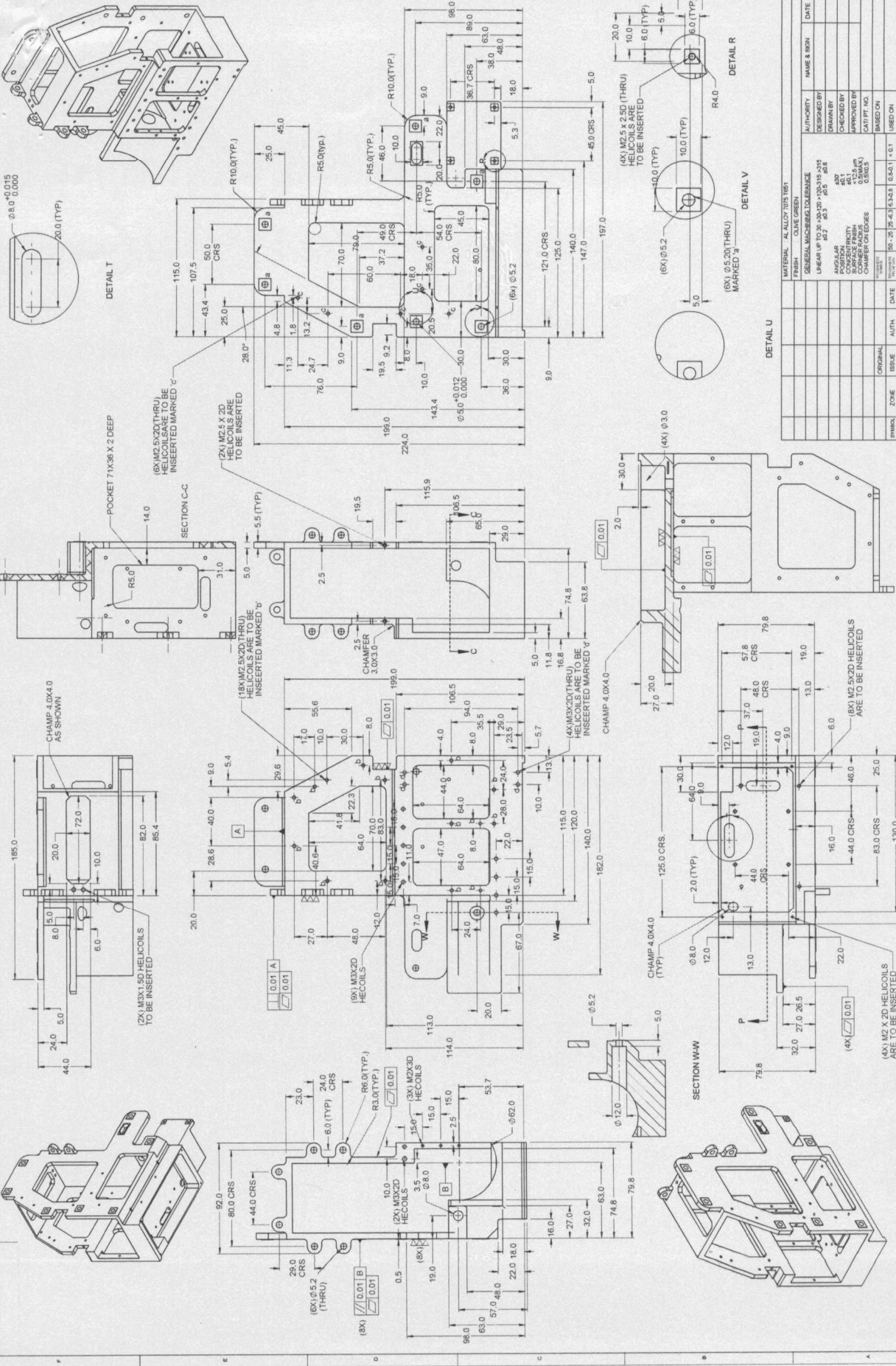

SYMBOL	ZONE	ISSUE	DATE	AUTH.	DESCRIPTION

TITLE: MOUNTING BRACKET

SCALE: 1:1
 SHEET: 01 OF 01

DATE: 09/20/2010

102 TRADE OHM

DATE OF ISS: 09/20/2010

REVISIONS

4

156

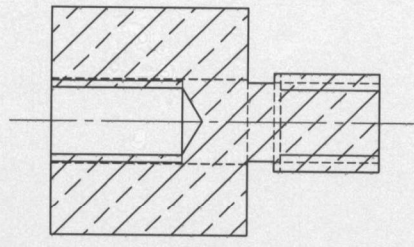
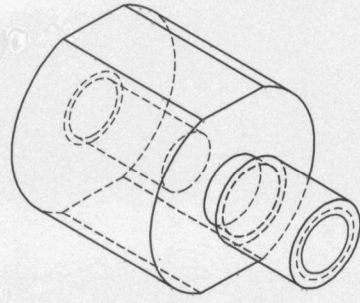

SECTION A-A

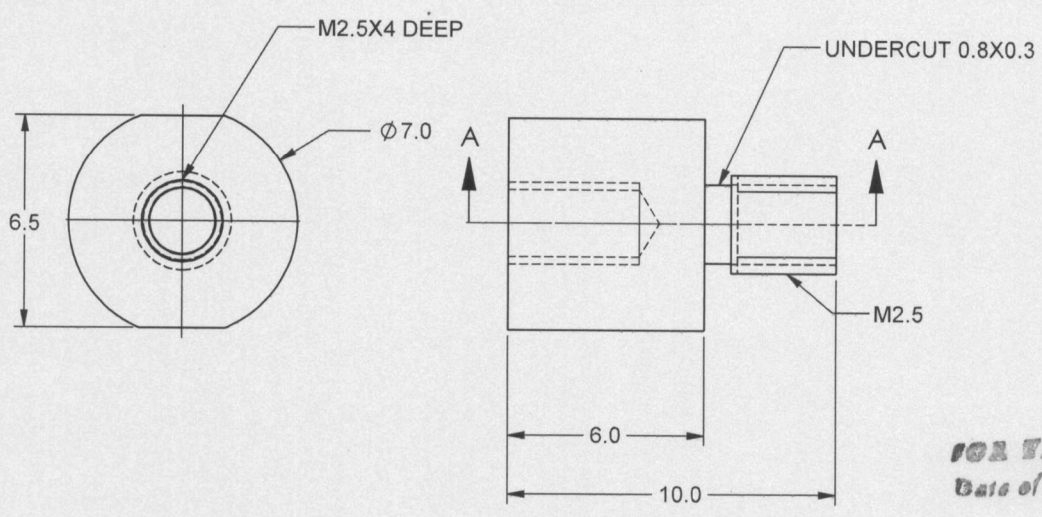

FOR TRADE COPY
Date of Issue 30/09/2020
Rg

Nos. off 04

					MATERIAL : BRASS IS: 319				
					FINISH : BRONZE BLACK				
					GENERAL MACHINING TOLERANCE :				
					LINEAR UP TO 30 ±0.2 >30-120 ±0.3 >120-315 ±0.5 >315 ±0.8 ANGULAR POSITION ±30' CONCENTRICITY ±0.1 SURFACE FINISH <12.5 μm CORNER RADIUS 0.5(MAX.) CHAMFER ON EDGES 0.5X0.5				
					ROUGHNESS SYMBOL		~ ▽ ▽▽ ▽▽▽ ▽▽▽▽		
					ROUGHNESS VALUE (μm)		50 - 25 25 - 6.3 6.3 - 0.8 0.8 - 0.1 < 0.1		
ORIGINAL					AUTHORITY				
					NAME & SIGN				
					DATE				
					DESIGNED BY				
					DRAWN BY				
					CHECKED BY				
					APPROVED BY				
					CAT/ PT. NO.				
					BASED ON				
					USED ON				
SYMBOL					ZONE				
ISSUE					AUTH.				
DATE					DATE				
ALL DIMENSIONS ARE IN mm UNLESS OTHERWISE SPECIFIED 					TITLE: POST 2 FOR RC CARD 				
					INSTRUMENTS RESEARCH & DEVELOPMENT ESTABLISHMENT, DEHRA DUN				
					DRG. NO. 142 1 01 03 04 05 M02				
					SCALE: 5:1		SHEET OF		

5

155

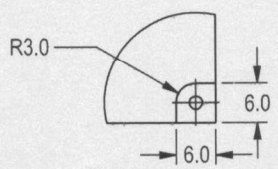
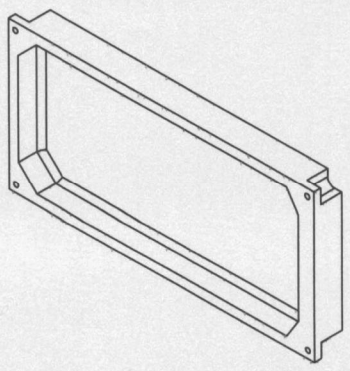
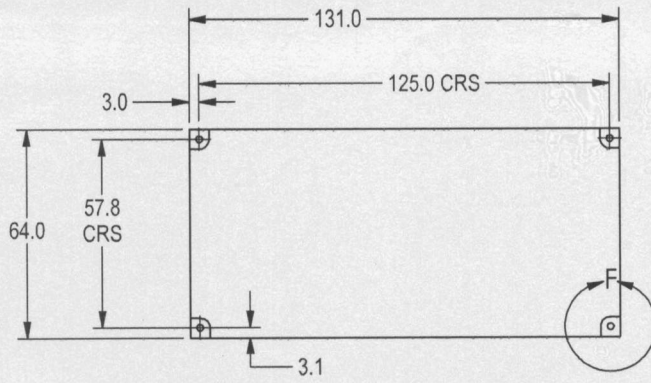

DETAIL F

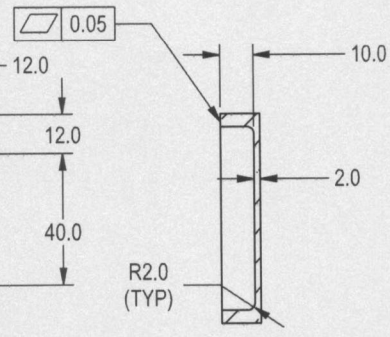
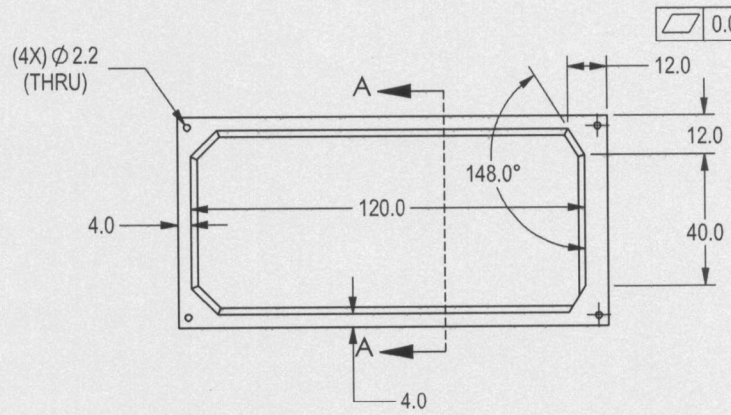
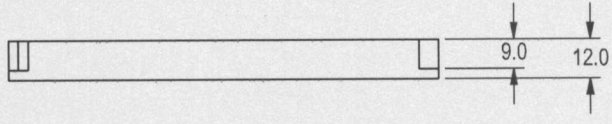

SECTION A-A

FOR TRADE ONLY
 Date of Issue 30/09/2020
Aji

					MATERIAL : AL ALLOY 7075 T651							
					FINISH : OLIVE GREEN							
					GENERAL MACHINING TOLERANCE :					AUTHORITY		
					LINEAR UP TO 30 >30-120 >120-315 >315					DESIGNED BY		
					±0.2 ±0.3 ±0.5 ±0.8					DRAWN BY		
					ANGULAR ±30'					CHECKED BY		
					POSITION ±0.1					APPROVED BY		
					CONCENTRICITY ±0.1					CAT/ PT. NO.		
					SURFACE FINISH <12.5 µm					BASED ON		
					CORNER RADIUS 0.5(MAX.)					USED ON		
					CHAMFER ON EDGES 0.5X0.5							
					ROUGHNESS SYMBOL							
					ROUGHNESS VALUE (µm)							
					50 - 25 25 - 6.3 6.3 - 0.8 0.8 - 0.1 < 0.1							
SYMBOL					ORIGINAL							
ZONE					AUTH.							
ISSUE					DATE							
TITLE:										IRDE INSTRUMENTS RESEARCH & DEVELOPMENT ESTABLISHMENT, DEHRA DUN		
COVER_LOGIC CARD										DRG. NO. 142 1 01 03 04 05 M03		
ALL DIMENSIONS ARE IN mm UNLESS OTHERWISE SPECIFIED										SCALE: 1:1 SHEET OF		

6

154

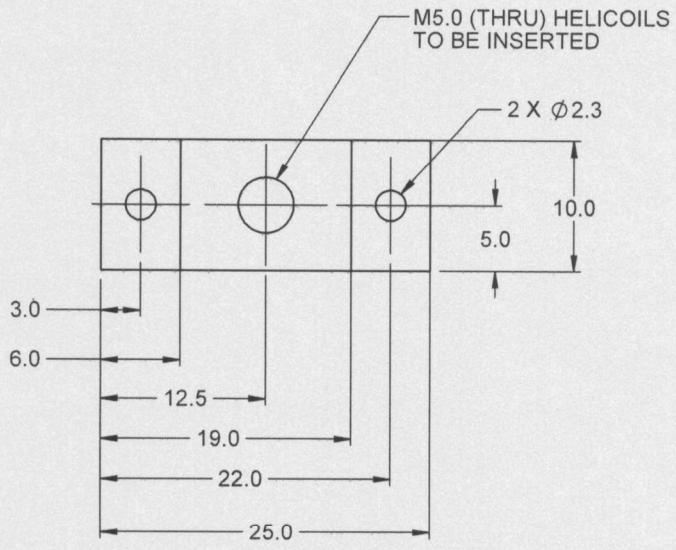
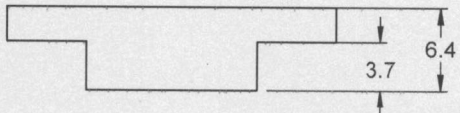
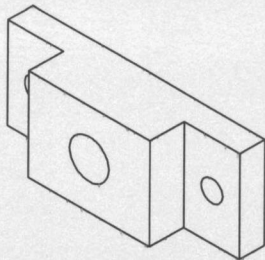

FOR TRADE ONLY

Date of Issue: 30/09/2010

Ag.

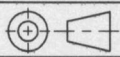
					MATERIAL : AL ALLOY 7075 T651							
					FINISH : ANODISED BLACK							
					GENERAL MACHINING TOLERANCE :					AUTHORITY	NAME & SIGN	DATE
					LINEAR UP TO 30 >30-120 >120-315 >315 ±0.2 ±0.3 ±0.5 ±0.8					DESIGNED BY		
					ANGULAR ±30'					DRAWN BY		
					POSITION ±0.1					CHECKED BY		
					CONCENTRICITY ±0.1					APPROVED BY		
					SURFACE FINISH <12.5 µm					CAT/ PT. NO.		
					CORNER RADIUS 0.5(MAX.)					BASED ON		
					CHAMFER ON EDGES 0.5X0.5					USED ON		
		ORIGINAL			ROUGHNESS SYMBOL	~	▽	▽▽	▽▽▽	▽▽▽▽		
SYMBOL	ZONE	ISSUE	AUTH.	DATE	ROUGHNESS VALUE (µm)	50 - 25	25 - 6.3	6.3 - 0.8	0.8 - 0.1	< 0.1		
ALL DIMENSIONS ARE IN mm UNLESS OTHERWISE SPECIFIED		TITLE: CMOS MOUNT					 INSTRUMENTS RESEARCH & DEVELOPMENT ESTABLISHMENT, DEHRA DUN					
							DRG. NO. 142 1 01 03 04 05 M04					
							SCALE: 2:1 SHEET 1 OF 1					

7

(153)

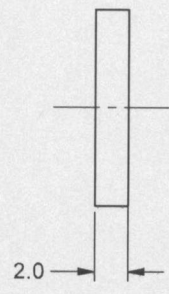
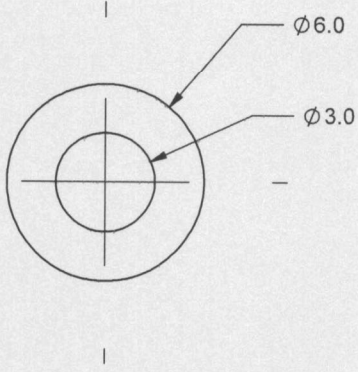
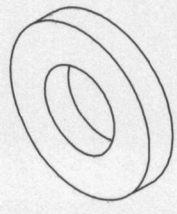

FOR TRADE ONLY
Date of Issue: 30/09/2020
Rgi

NOS. OFF - 20

					MATERIAL : PTFE						
					FINISH : CLEAN						
					GENERAL MACHINING TOLERANCE :				AUTHORITY	NAME & SIGN	DATE
					LINEAR UP TO 30 >30-120 >120-315 >315 ±0.2 ±0.3 ±0.5 ±0.8				DESIGNED BY		
					ANGULAR POSITION ±30'				DRAWN BY		
					CONCENTRICITY ±0.1				CHECKED BY		
					SURFACE FINISH <12.5 μm				APPROVED BY		
					CORNER RADIUS 0.5(MAX.)				CAT/ PT. NO.		
					CHAMFER ON EDGES 0.5X0.5				BASED ON		
					ROUGHNESS SYMBOL	~	▽	▽▽	▽▽▽	▽▽▽▽	USED ON
SYMBOL	ZONE	ISSUE	AUTH.	DATE	ROUGHNESS VALUE (μm)	50 - 25	25 - 6.3	6.3 - 0.8	0.8 - 0.1	< 0.1	
* ALL DIMENSIONS ARE IN mm UNLESS OTHERWISE SPECIFIED	TITLE: TEFLON WASHER 2MM				IRDE	INSTRUMENTS RESEARCH & DEVELOPMENT ESTABLISHMENT, DEHRA DUN					
					DRG. NO.	142 1 01 03 04 05 M05					
					SCALE:	5:1					

8

(152)

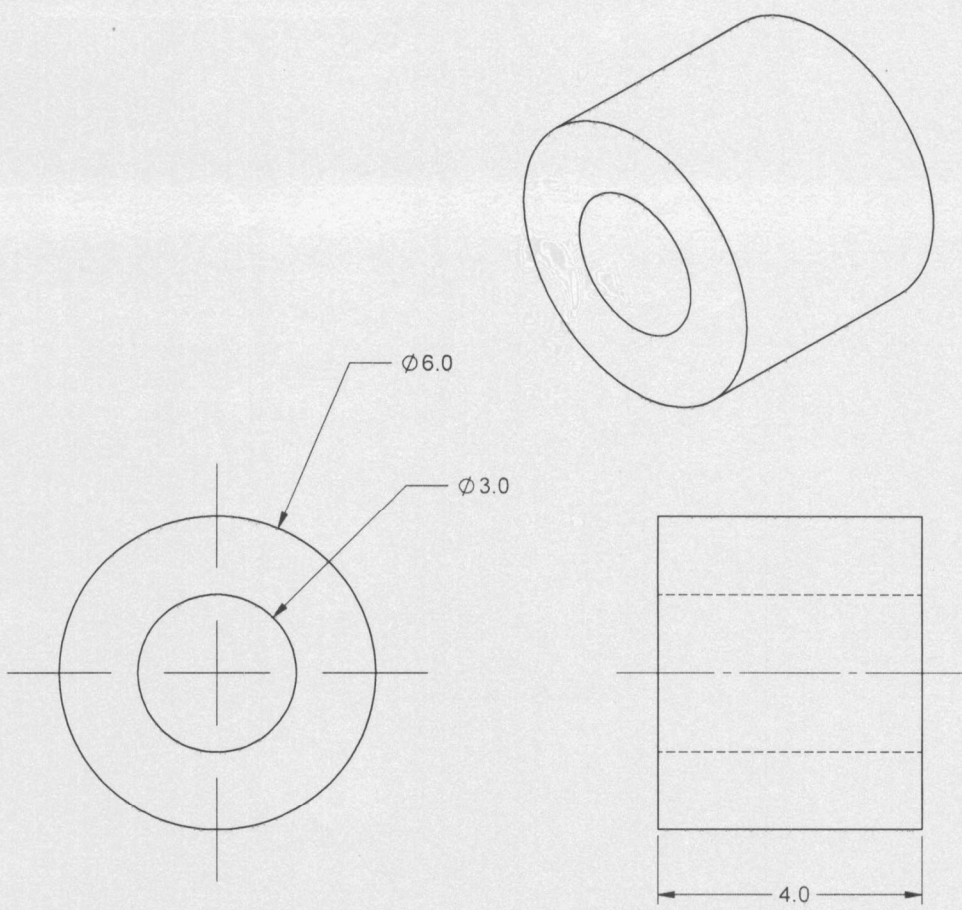

NOS. OFF -20

FOR TRADE CELL
 Date of Issue: 06/10/2020
Rjr

					MATERIAL : PTFE							
					FINISH : CLEAN							
					GENERAL MACHINING TOLERANCE :			AUTHORITY		NAME & SIGN	DATE	
					LINEAR UP TO 30 >30-120 >120-315 >315 ±0.2 ±0.3 ±0.5 ±0.8			DESIGNED BY				
					ANGULAR ±30'			DRAWN BY				
					POSITION ±0.1			CHECKED BY				
					CONCENTRICITY ±0.1			APPROVED BY				
					SURFACE FINISH <12.5 µm			CAT/ PT. NO.				
					CORNER RADIUS 0.5(MAX.)			BASED ON				
					CHAMFER ON EDGES 0.5X0.5			USED ON				
					ROUGHNESS SYMBOL	~	▽	▽▽	▽▽▽	▽▽▽▽		
SYMBOL	ZONE	ISSUE	AUTH.	DATE	ROUGHNESS VALUE (µm)	50 - 25	25 - 6.3	6.3 - 0.8	0.8 - 0.1	< 0.1		
ALL DIMENSIONS ARE IN mm UNLESS OTHERWISE SPECIFIED TITLE: TEFLON WASHER 4 MM						IRDE INSTRUMENTS RESEARCH & DEVELOPMENT ESTABLISHMENT, DEHRA DUN						
						DRG. NO. 142 1 01 03 04 05 M06						
						SCALE: 10:1						

9

(157)

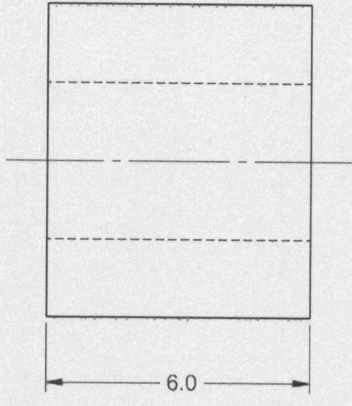
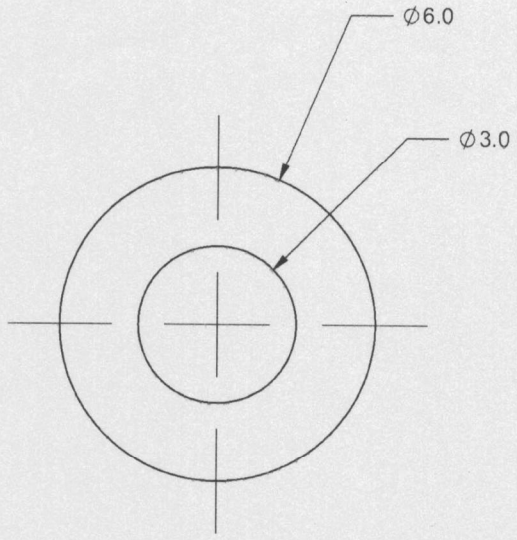
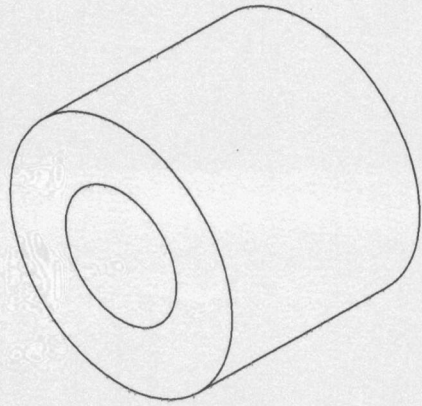

FOR TRADE OFF
Date of Issue 30/09/2010
Raj

NOS. OFF - 20

					MATERIAL : PTFE						
					FINISH : CLEAN						
					GENERAL MACHINING TOLERANCE :			AUTHORITY		NAME & SIGN	DATE
					LINEAR UP TO 30 >30-120 >120-315 >315 ±0.2 ±0.3 ±0.5 ±0.8			DESIGNED BY			
					ANGULAR ±30'			DRAWN BY			
					POSITION ±0.1			CHECKED BY			
					CONCENTRICITY ±0.1			APPROVED BY			
					SURFACE FINISH <12.5 μm			CAT/ PT. NO.			
					CORNER RADIUS 0.5(MAX.)			BASED ON			
					CHAMFER ON EDGES 0.5X0.5			USED ON			
					ROUGHNESS SYMBOL	~	▽	▽▽	▽▽▽	▽▽▽▽	
SYMBOL	ZONE	ISSUE	AUTH.	DATE	ROUGHNESS VALUE (μm)	50 - 25	25 - 6.3	6.3 - 0.8	0.8 - 0.1	< 0.1	
					ORIGINAL						
ALL DIMENSIONS ARE IN mm UNLESS OTHERWISE SPECIFIED					TITLE: TEFLON WASHER 6 MM					IRDE INSTRUMENTS RESEARCH & DEVELOPMENT ESTABLISHMENT, DEHRA DUN	
										DRG. NO. 142 1 01 03 04 05 M07	
										SCALE: 10:1	

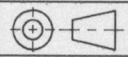

10

150

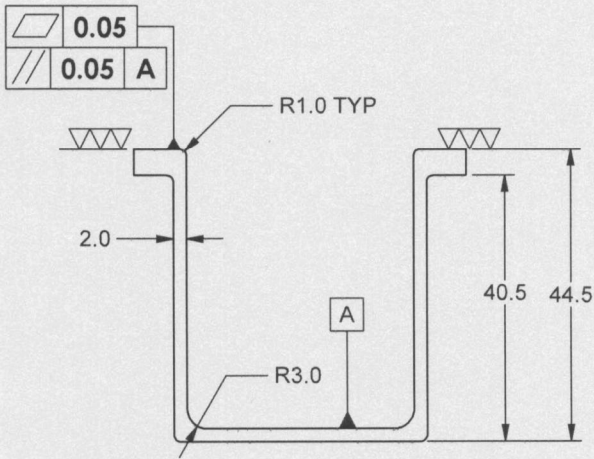
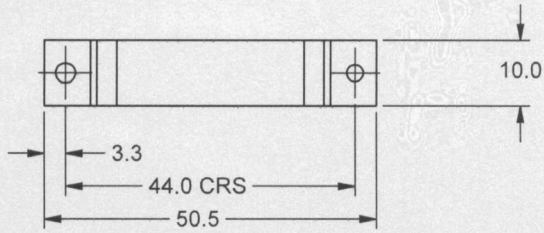
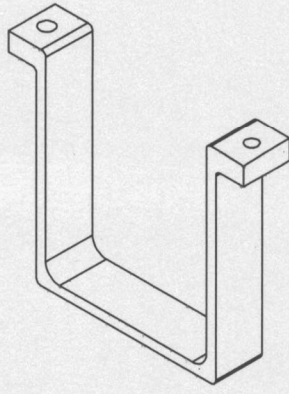

FOR TRADE ONLY
Date of Issue 30/09/2020
Raj

					MATERIAL : ST STEEL IS:1570							
					FINISH : CLEAN							
					GENERAL MACHINING TOLERANCE :					AUTHORITY	NAME & SIGN	DATE
					LINEAR UP TO 30 >30-120 >120-315 >315 ±0.2 ±0.3 ±0.5 ±0.8					DESIGNED BY		
					ANGULAR ±30'					DRAWN BY		
					POSITION ±0.1					CHECKED BY		
					CONCENTRICITY ±0.1					APPROVED BY		
					SURFACE FINISH <12.5 μm					CAT/ PT. NO.		
					CORNER RADIUS 0.5(MAX.)					BASED ON		
					CHAMFER ON EDGES 0.5X0.5					USED ON		
		ORIGINAL			ROUGHNESS SYMBOL	~	▽	▽▽	▽▽▽	▽▽▽▽		
SYMBOL	ZONE	ISSUE	AUTH.	DATE	ROUGHNESS VALUE (μm)	50 - 25	25 -6.3	6.3-0.8	0.8-0.1	< 0.1		
ALL DIMENSIONS ARE IN mm UNLESS OTHERWISE SPECIFIED		TITLE:					IRDE INSTRUMENTS RESEARCH & DEVELOPMENT ESTABLISHMENT, DEHRA DUN					
		C Clamp for L3 CCD					DRG. NO. 142 1 01 03 04 05 M08					
							SCALE: 1:1		SHEET 1 OF 1			