

DRAWING NUMBER
350 - 15

SHEET No. 1 OF 1

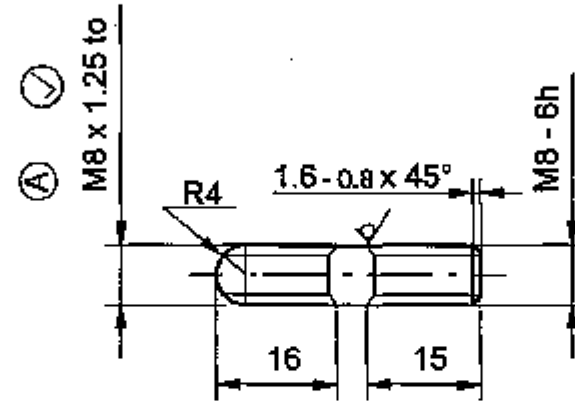

8. EXPLANATORY NOTE :-

MATERIAL QUOTED :- ROUND BAR GOST 7417-75
45 GOST 1051-73

ALTERNATE MATERIAL QUOTED :- 40, 50 GOST 1050-74
PERTAINS TO SIZED COLD ROLLED OR COLD DRAWN STEEL WITH ROUND SECTION
40, 45 AND 50 ARE GRADES OF STEEL GOST 1051-73

CHEMICAL COMPOSITION :

GRADE OF STEEL	CONTENT OF ELEMENTS IN %							
	C	Si	Mn	Cr	P	Cu	S	Ni
40	0.37 - 0.45	0.17 - 0.37	0.50 - 0.80	0.25	0.035	0.25	0.04	0.25
45	0.42 - 0.50	0.17 - 0.37	0.50 - 0.80	0.25	0.035	0.25	0.04	0.25
50	0.47 - 0.55	0.17 - 0.37	0.50 - 0.80	0.25	0.035	0.25	0.04	0.25

MECHANICAL PROPERTIES :

GRADE OF STEEL	TENSILE STRENGTH Kgf/mm ² (min)	YIELD POINT Kgf/mm ² (min)	ELONGATION % (min)	REDUCTION IN AREA % (min)	IMPACT STRENGTH Kgf/mm ² (min)
40	58	34	19	45	6
45	61	36	16	40	5
50	64	38	14	40	4

2. TECHNICAL REQUIREMENTS FOR THREADS AS PER STANDARD 82021-00.
3. DIMENSIONS WITH UNSPECIFIED TOLERANCES AND THE REST OF THE TECHNICAL REQUIREMENTS AS PER STANDARD 82052 - 00.
4. COATING : CADMIUM 3. CHROMATIZING AS PER IIIIJI-104 WITH ELIMINATION OF HYDROGEN EMBRITTELEMENT.
5. THE THREAD MAY BE MADE BY ROLLING WITH THE DIAMETER OF UNTHREADED PORTION WITHIN THE PITCH DIAMETER OF THREADS.
6. MECHANICAL DAMAGES OF THE CADMIUM COATING SUCH AS SCRATCHES, NICKS AND DENTS ARE ALLOWED ON ASSEMBLY UNITS, PROVIDED THE STEEL IS NOT EXPOSED.
7. ALTERNATE MATERIAL : STEEL, GRADES 40 AND 50 GOST 1050-74.
8. HARDNESS :- 27 - 32 HRC.

9. REPAIR SIZE DIMENSIONS ARE ADDED WHERE INDICATED THUS BASED ON OVER HAUL SPECIFICATION PART III REPAIR DRAWINGS.

SL.No.	R	REMARKS
1	M 10 x 1.5 to	ALL OTHER CONDITIONS AS PER STD. DRG.
2	PCD = 9.026 ^{+0.170} _{+0.095}	

* ALT. MATERIAL :- STEEL 709 M40 (EN-19) TO BS : 970 PT. - I-1983.

** Cb 306-01-36 Cb 306-01-20
Cb 306-02-36 Cb 306-02-20
Cb 3301-15-44 Cb 406-05-3
Cb 3308-04-24 Cb 3301-15-30
Cb 3321-14-1

PILOT SAMPLE SHOULD BE APPROVED BY A H S P BEFORE BULK PRODUCTION.

EST. WT. (Kg) TO BE STAMPED OR MARKED WHERE INDICATED THUS # (LETTERS)

ALL SHARP EDGES AND CORNERS TO BE REMOVED UNLESS OTHERWISE STATED MACHINED CORNERS TO HAVE R OUT-SIDE R INSIDE EQUIVALENT CHAMFERS ARE PERMISSIBLE.

DRN	Sd/=	MATERIAL :- ROUND BAR	USED ON :-
CHD	Sd/=	GOST 7417-75 *	Cb 3338-402-4 **
APPD	Sd/=	45 GOST 1051-73 (C)	
DATE	02.05.87	CONTROLLERATE OF QUALITY ASSURANCE (HEAVY VEHICLES) AVADI	
SCALE:- 1 : 1		TITLE:-	
DIMENSIONS IN mm		STUD M8 x 35	
TOLERANCE ON DIMNS UNLESS OTHERWISE STATED IS : 2102-69		D S CAT NUMBER	
ALL THREADS TO CONFORM TO		DRAWING NUMBER	
ISSUE	DATE	350 - 15	

D	26-05-09	Authy: Third Alt. Comm. Minutes Point. 5 Dated 27-02-2009.
C	25.8.08	USED ON NUMBERS ADDED
B	11.01.08	AUTHY: MIN. OF ALT. COM. MEET POINT
A	06.9.95	No. - 2. 12 DL.07.02.07
		REPAIR SIZE DIMNS. ADDED.
		NATURE OF AMENDMENTS

DRG. RE-INDIANISED BASED ON 350-15 ISSUE 'B' COMMON TO V-92S2 ENGINE

F-11
SIZE A1

