

OFB

THIS DRAWING DOCUMENT CONTAINS COMPANY PROPRIETARY INFORMATION. USE OR DISCLOSURE IN WHOLE OR IN PART SHALL NOT BE MADE WITHOUT THE WRITTEN PERMISSION OF OFB

85  
 JWM/CDD  
 DATE: 01.01.2007  
 ALTERNATE/INDIGENOUS MATERIAL SPECN:  
 BS:970 Pt-I:83 GDE 709 M40. Hardened & tempered to "U" condition. A separate test bar shall be heat treated to achieve the hardness 38-42 HRC.  
 (REF: CQA(W) JABALPUR LNo. 3B2402/CQAW/011 Dt. 12 JULY 2005)

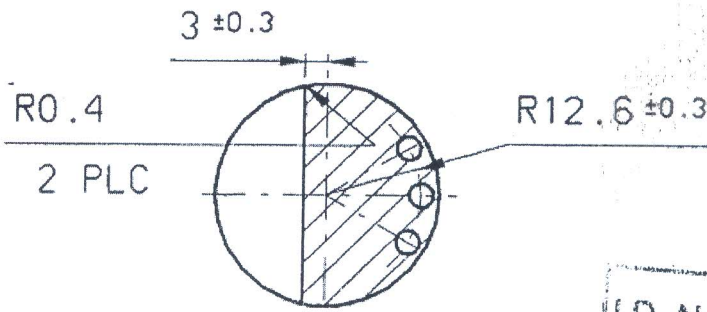
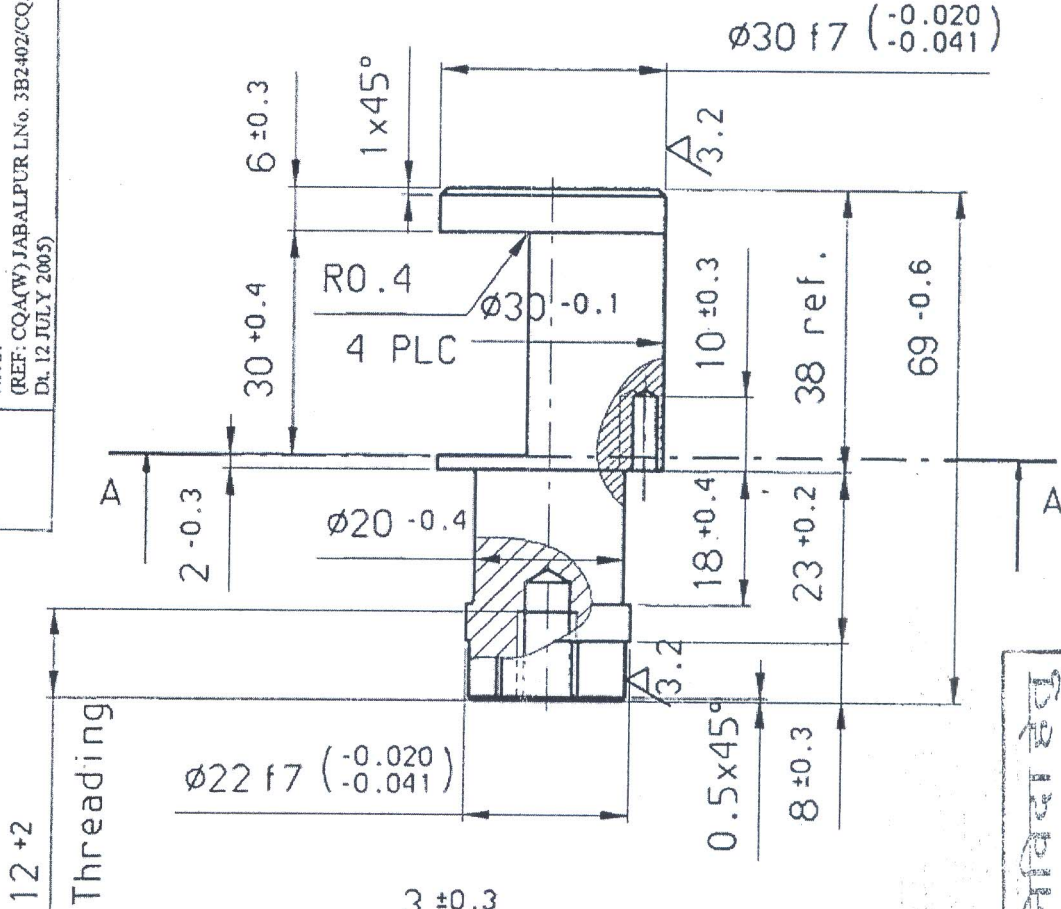
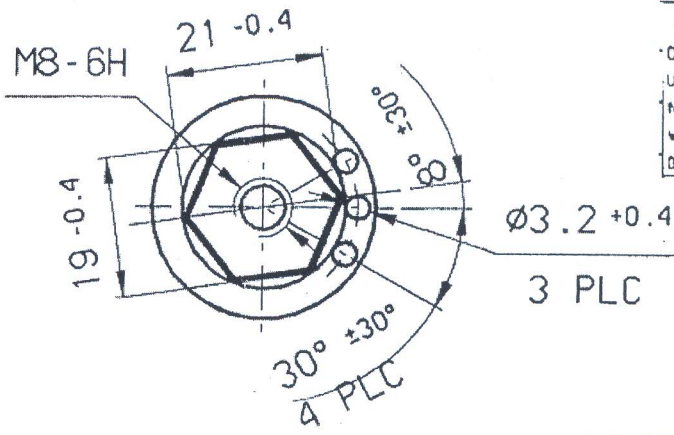

केवल निविदा हेतु  
 मन्त्र मॉग पत्र सं० ३८०१६५  
 दिनांक २५-०५-२०१८

I.D. No. 2097  
 Location S/1/6/101

Dt. 6-6-2005

CQA (W), JABALPUR

MACHINING INSTRUCTIONS

UNSPECIFIED TOLERANCES FOR DIMENSIONS AND ANGLES DIMENSIONS

ANGLES

HEAT TREATMENT

38-42 HRC

FINISH

PHOSPHATE COATING ACCORDING TO DDD-P-16232 TYPE M CL.2

MATERIAL

Round 35 DIN 1013-42CrMo4

SHARANG 130/155MM\_UG\_OFB\_SLB

PART NO.

ASSEMBLY 176-8001

NAME

AXLE

UPDATED

Sh: 1  
of: 1

1:1 A4  
SCALE SIZE

PREP'D	
CHD	
JWM/DO	

APPROVED

DO/DO	DIR/ODC
-------	---------

ORDNANCE DEVELOPMENT CENTRE, OFC, KANPUR

PART NO.

161-713