

DRG. No 000 891 0598 J

SEALED

CERTIFIED CORRECT

COPY DATE

SIGNATURE

ALL DIMENSIONS ARE IN M.M.

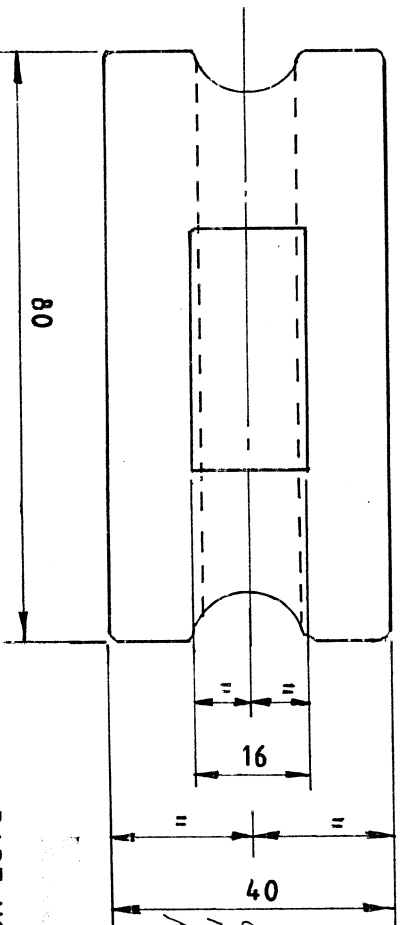
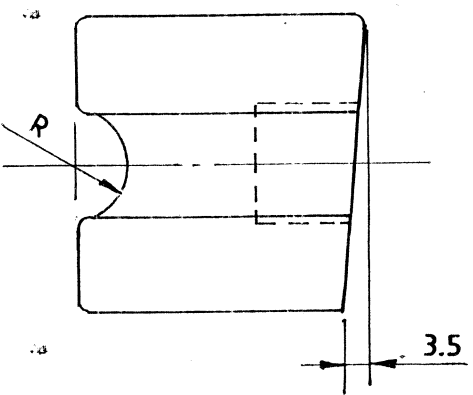
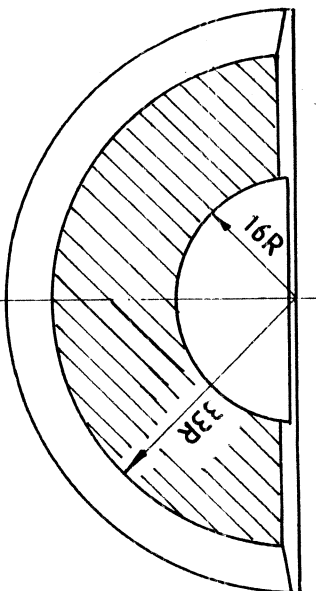

(V1)
NOTE:-
COMPONENT TO BE
MANUFACTURED FROM
PRESSURE DIE CASTING.

SHARP CORNERS TO BE ROUNDED OFF
MATERIAL:- ALU. ALLOY SPECN LM6 (BSS)

PART NO.	DM R
000891 0598 J	7.00
000891 005 983	8±1

PART NO.		DESCRIPTION		MATERIAL		NO. OF		DRG. NO.		REV. DATE	
<p>Gen/Tel/Net Specified</p> <p>Linear Dimension</p> <p>0-6 ±0.1</p> <p>6-30 ±0.2</p> <p>30-120 ±0.3</p> <p>120-315 ±0.5</p> <p>315-1000 ±0.8</p> <p>1000-2000 ±1.2</p> <p>Angular Dim</p> <p>0-10 ±1°</p> <p>10-50 ±30'</p> <p>50-100 ±20'</p> <p>≥ 100 ±10'</p>											
<p>0003 NOTE ADDED. 24-9-10</p> <p>24-9-10 DRG. RETRACED. 4-5-01</p> <p>INDEX ALTERATION Date Sign</p> <p>Umachined</p> <p>▽ Rough</p> <p>▽▽ Smooth</p> <p>▽▽▽ Finish</p> <p>②② C.Hard</p> <p>②②② Hardened</p> <p>①④ Cr after Hard.</p>											
Description			PACKING			Scale			Ref. Drg.		
(U" BOLT)			LPTA-713/32			1:1					
For			Group			Replaced by			Replacement for		
VEHICLE FACTORY			CALCUTTA			000 891 0598 J			V1		

The copy right of this drawing and its contents are reserved for the Ministry of Defence, Govt of India. This drawing may be copied, reproduced in any way or form, or in any medium, without the written permission of the Director General of Ordnance Factories.