

45018204
175 00077 C

MODIFICATIONS & ADDITIONS		SIGN
ISSUE	MODIFICATIONS & N OF A	

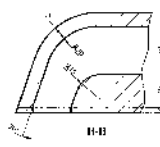
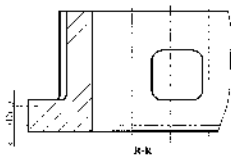
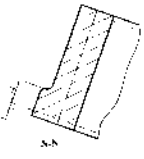
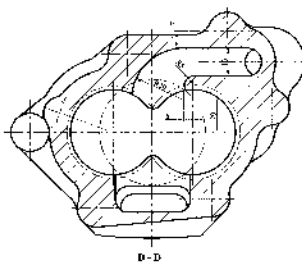
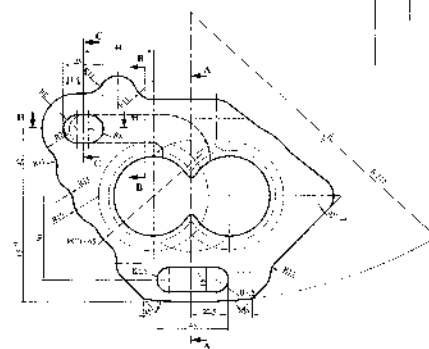
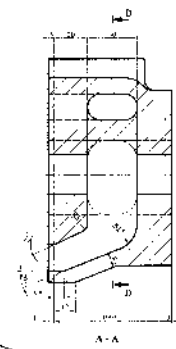
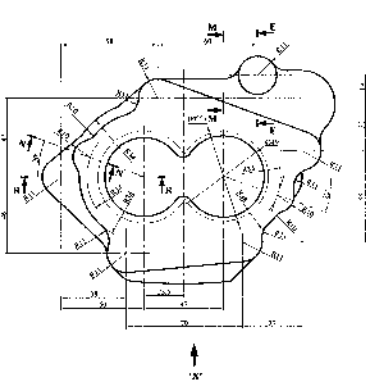

NOTE-

1. HARDNESS TB : 70 - 247 (DIA OF INDENTATION 4.6 - 5.9)
2. DILAT SHRIF D NOT EXCEED 2%
3. UNSPECIFIED CASTING RADI R4 - 6 mm.
4. CASTING SHOULD BE FREE FROM FOUNDRY DEFECTS
5. OTHER CASTING REQUIREMENTS SHOULD COMPLY WITH IS 2177
6. MACHINED DIMENSIONS ARE GIVEN IN BRACKETS
7. ALL DIMENSIONS ARE IN MM
8. PHANTOM LINES INDICATES MACHINED SURFACE
9. * MARKED DIMENSIONS FOR REFERENCE
10. PILOT SAMPLE SHOULD BE APPROVED BEFORE BULK SUPPLY.

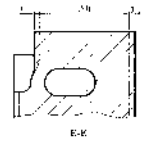
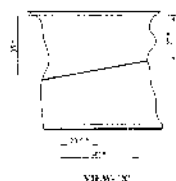
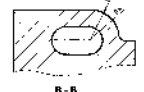
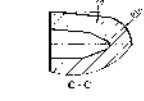
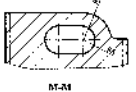

VIEW - V

A.T. MATERIAL
G.L. CASTING GDEFG. 220 TO IS 210 93.

DRAWN BY DESIGNED BY CHECKED BY APPROVED BY	DATE 172.56.0777 C HEAVY VEHICLE TIRON HEAVY VEHICLE FACTORY AVADI, CHENNAI.	
--	--	--