

SIZE A4

DATE 08.10.04

APPD [Signature]

IS: 2102-69

TOLERANCE ON DIMENSIONS UNLESS OTHERWISE STATED

DRN [Signature]

SCALE: 1:1

ISSUE DATE 03-07-16

Authy: Lt. No. 91469/16/IND-VI/NIK Dt. 29.4.16

NATURE OF AMENDMENTS

DIMENSIONS IN mm

CONTRIBUTE OF QUALITY ASSURANCE (HEAVY VEHICLES) AVADI

TITLE: HINGE

D S CAT NUMBER

DRAWING NUMBER 172.04.417

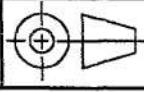

MATERIAL: PROFILE AMT6 PK18428X14
 GOST 8617-81
 USED ON: 188.04.020cbcb
 188.04.021cbcb
 188.04.022cbcb
 188.04.023cbcb

EST. WT. (kg) 0.15

TO BE STAMPED OR MARKED WHERE INDICATED THUS # (LETTERS)

ALL SHARP EDGES AND CORNERS TO BE REMOVED UNLESS OTHERWISE STATED MACHINED CORNERS TO HAVE R OUT-SIDE R INSIDE EQUIVALENT CHAMFERS ARE PERMISSIBLE.

1* Dimensions for reference.
 2. Other requirements are as per 520 TY 1.
 EQ. MATL: ALUMINIUM ALLOY Gds. 54300 TO IS: 737-86
 PILOT SAMPLE SHOULD BE APPROVED BY A H S P BEFORE BULK PRODUCTION.

1* Размеры для справок
 2. Требования медобавки по 520 TY1

** USED ON
 172.04.135Cb-1
 172.04.137Cb
 172.04.146Cb-A
 172.04.147Cb-A
 172.04.158Cb
 172.04.162Cb
 172.04.163Cb

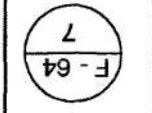
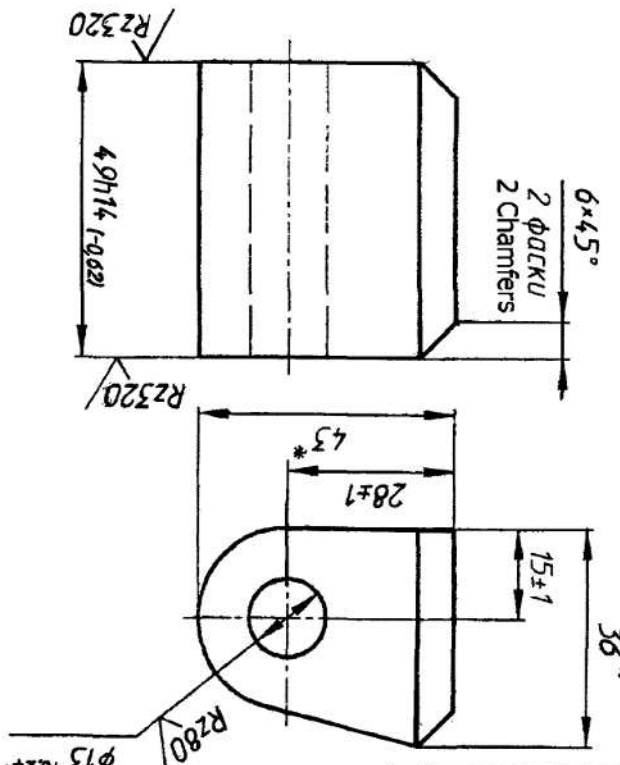

D900#3
U-01-1-2
SUPPLY CODE

356

DRG. INDIANISED BASED ON RUSSIAN ORIGINAL ISSUE -6

COMMON TO T-72.. & BLT

DRAWING NUMBER 172.04.417

SHEET No. 1 OF 1

1 2 3 4

DRAWING NUMBER
184.04.011

SHEET No. 1 OF 1

R2030 ✓

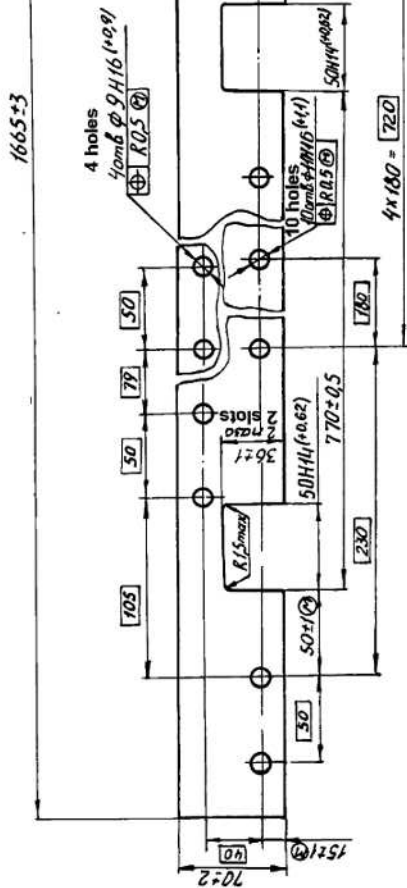

- 2 Допускаются радиусы скруглений 3-3 мм
- 3 Допускается изготавливать из двух частей сваркой ГОСТ14806-80-C21 с зачисткой шваб заплыва
- 4 *Размер для справок
- 5 Остальные требования по 520 ТУ1

2. Rounding of radii 3-3 mm are allowed.
3. The strap can be made of two parts by welding GOST 14806-80-C21 and dressing of welds in flush with.
4. *Dimension for reference.
5. Other requirements are as per 520.TY 1.

DRN	V. O. S.	MATERIAL	USED ON
CHD		SHEET AM 66M 6	184.04.022chCb
APPD	P. O. S.	GOST 21631.76	
DATE	10.04	CONTROLERATE OF QUALITY ASSURANCE (HEAVY VEHICLES)	
		AVADI	
		SCALE: 1:2	
		DIMENSIONS IN mm	
		TOLERANCE ON DIMENS	
		UNLESS OTHERWISE	
		STATED IS: 110-69	
		ALL THREADS TO	
		CONFORM TO	
		ISSUE	
		DATE	
		NATURE OF AMENDMENTS	

PILOT SAMPLE SHOULD BE APPROVED BY A H S P BEFORE BULK PRODUCTION.

EST. WT. (kg) TO BE STAMPED OR MARKED WHERE INDICATED THIS # (LETTERS)

1.84

ALL SHARP EDGES AND CORNERS TO BE REMOVED UNLESS OTHERWISE STATED MACHINED CORNERS TO HAVE R. OUT-SIDE R. INSIDE EQUIVALENT CHAMFERS ARE PERMISSIBLE.

TITLE:
FOURTH RIGHT
HAND STRAP

D S CAT NUMBER

DRAWING NUMBER
184.04.011

356
SUPPLY CODE
U-01-1:2
D90043

F-64
57

SIZE A4x3

DRAWING NUMBER
184.04.022cbCb

SHEET No. 1 OF 1

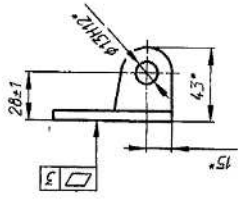
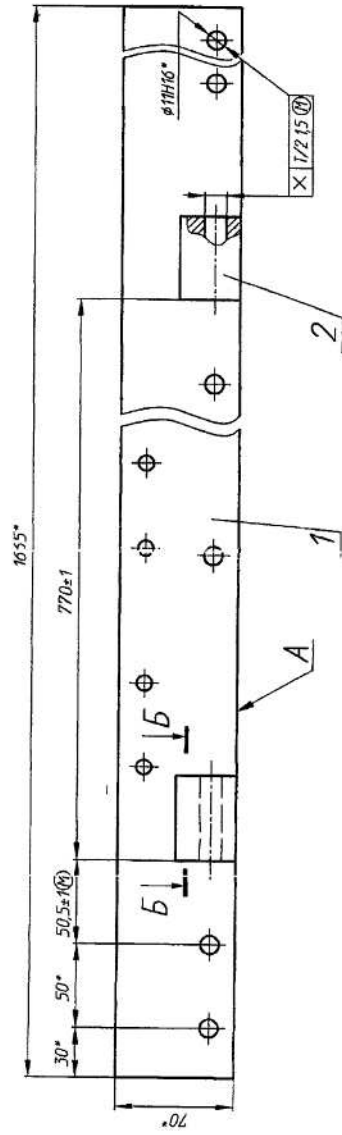

b-b (1:1)

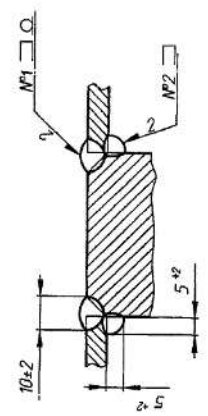

1. Сварные швы №1 и №2 выполнять аргоно-дуговой сваркой.
2. Выступание пелель поз.2 за плоскость А не допускается, запатование не более 1мм
3. Покрытие Грунтэмалка ВЛ-02 Грунтэмалка АК-070 Эмаль ХВ-518 защитная Требования по 520.1У5.
4. *Размеры для справок.
5. Проварку пелель поз.2 контролировать установкой приспособления, имитирующего щитки, при этом планка должна обрабатываться на ось.
6. Остальные требования по 520.1У1.

1. Make the welds No 1 and No 2 by argon-arc welding.
2. Projection of hinges, item 2, beyond the plane A is not allowed, sinkage should not exceed 1 mm.
3. Coating Primer ВЛ-02 Primer АК-070 Enamel ХВ-518, Khaki Requirements are as per 520.1У5.
4. * Dimensions for reference.
5. Check the welding of hinges, item 2, by setting the fixture, similar to the shield, while doing so the strap should turn on the pins.
6. Remaining requirements are as per 520.1У1.

DRN	Mr. Sanyal	MATERIAL:-	USED ON:-
CHD	Mr. Sanyal		184.04.014cbCb
APPD	Mr. Sanyal	CONTROLLER OF QUALITY ASSURANCE (HEAVY VEHICLES)	
DATE	16-6-04	AVADI	
SCALE: 1:2			
DIMENSIONS IN mm			
TOLERANCE ON DIMENS UNLESS OTHERWISE STATED IS: 300-60			
TITLE:- FOURTH RIGHT-HAND STRAP ASSY.			
D S CAT NUMBER			DRAWING NUMBER
CONFORM TO			184.04.022cbCb

PILOT SAMPLE SHOULD BE APPROVED BY A H S P BEFORE BULK PRODUCTION.

EST. WT. (kg) TO BE STAMPED OR MARKED WHERE INDICATED THUS # (LETTERS)

1.99

ALL SHARP EDGES AND CORNERS TO BE REMOVED UNLESS OTHERWISE STATED MACHINED CORNERS TO HAVE R. OUT-SIDE R. INSIDE EQUIVALENT CHAMFERS ARE PERMISSIBLE.

ISSUE DATE NATURE OF AMENDMENTS

