

6LS X01  
PART N<sup>o</sup> 184

FOR EXPLANATION OF DIMENSIONING ETC, SEE ARDE NOTE SH1  
DIMENSIONS ARE IN MM.

D.C.I. 30696-A.

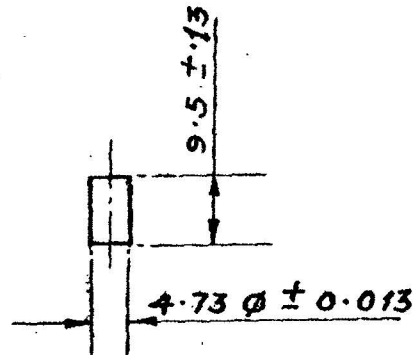

R N <sup>o</sup>	DATE	AUTHORITY	REVISION	ZONE	SDI- AHSP	SDI- O.O. SIGN.
	11-5-11		DRG SCANNED WITHOUT CHANGE & NEG. REPLACED			
	29-6-88	D.C.I. 34416-A	ALTERNATIVE MATERIAL ADDED.			
	27-6-87	D.C.I. 34168-A	DS CAT NO ADDED.			
	31-12-84		RETRACED WITHOUT CHANGE.			
			PREVIOUS D.C.I. N <sup>o</sup> s. - 30696-A, 32055-A & 32115-A			

DRG. SEALED:- 8-5-73 (PROV).

DRN.	CHD.	TRD.-RMR	COMP B	ASSY. DRG.
CD' MAN	SDI- O.V.C. D.O.	SCALE:- 1:1		
APPD.	SDI- FOR C.I. (A).	GAUGE SCHD.		
		EST. MASS:- DATE:- 12-7-71		

MATL:- STEEL STA 27 OR D5 OR SANDVIK 20 AP. DESIGNER'S REF:-  
D6P - A128 SH1 N<sup>o</sup> 3/4  
PROTECTIVE FINISH:- TO BE PHOSPHATED AS  
PART N<sup>o</sup>  
PER SPECN. WPN./GEN/3 CLASS II 13 (1/2)

**PIN**

IQX 579

D.S. CAT N<sup>o</sup>  
1390-000496

AHSP:- C.I. (A) KIRKEE