

FOR EXPLANATION OF DIMENSIONING ETC; SEE CQA(C) GUIDENo.001-1992
THIRD ANGLE PROJECTION; DIMENSIONS ARE IN MILLIMETRES.

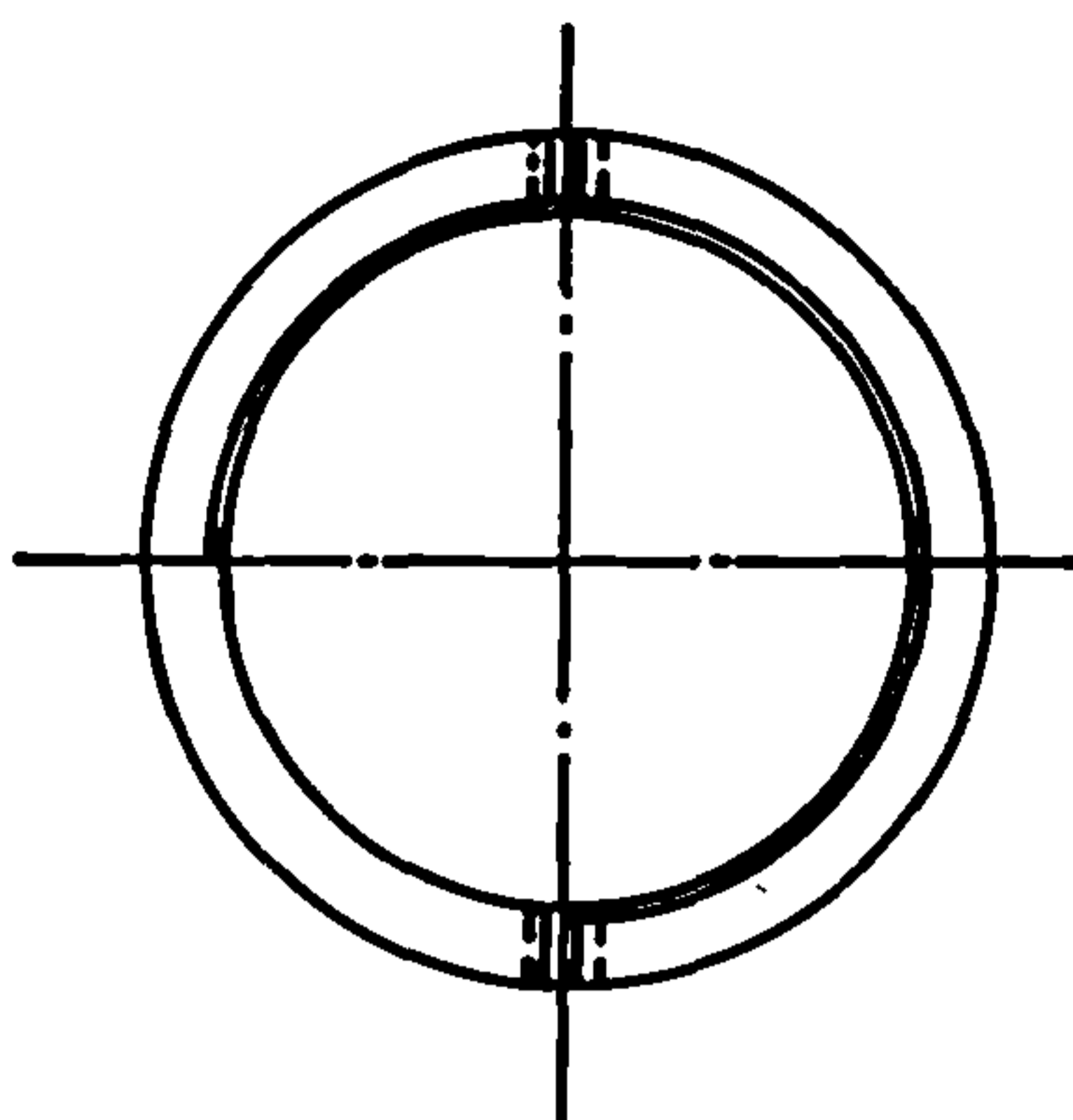

SLOT 1.5 WIDE X 1.5 DEEP

2-HOLES M3

M32 X 1f

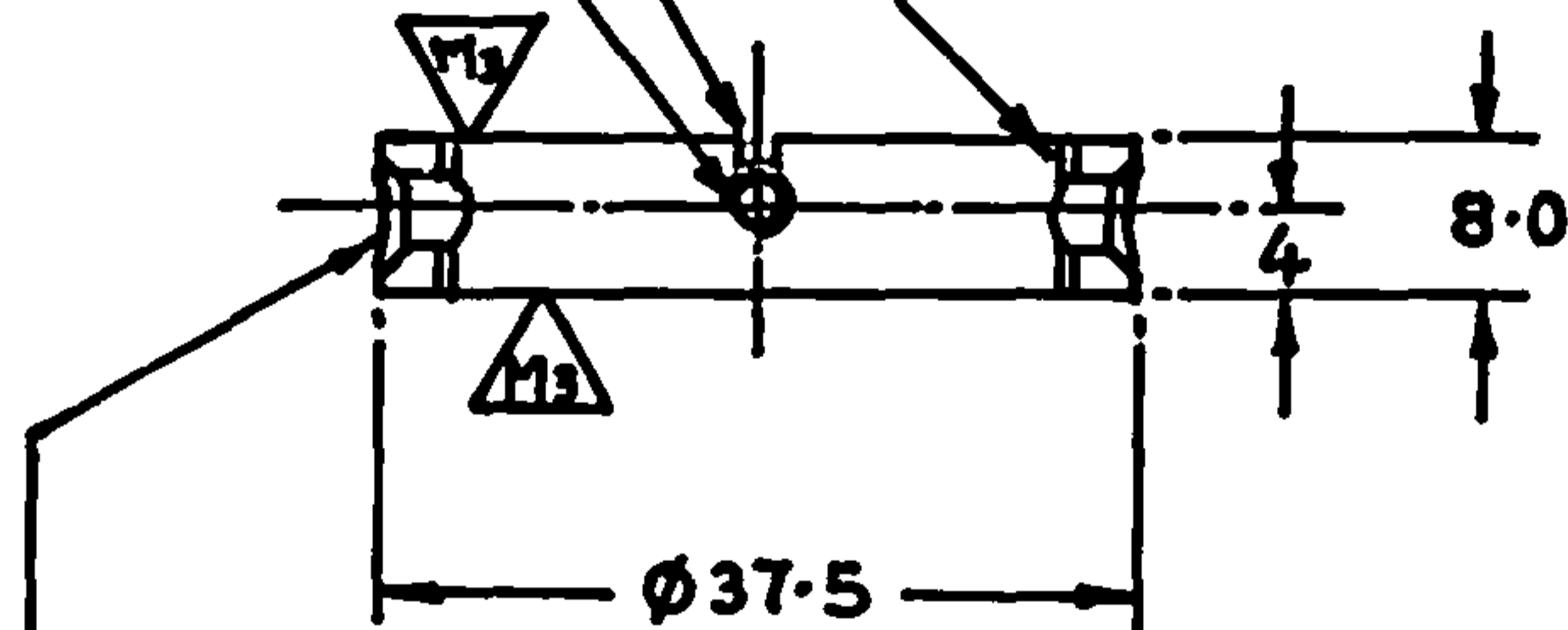

2-HOLES ϕ 3.1 & C'SK TO ϕ 6.2 AT 90° AS SHOWN.

NOTE:- FACES TO BE SQUARED TO THE AXIS.

(c)	D.C.- 5913-I. MATL. AMENDED.			5.12.94	DRN		APPROVED
	(b) D.C.(1):- 5448-I. MATL. AMENDED.			3.1.91	TRCD		FOR DIRECTOR
	D.C.(1):- 5361-I. DRG. SEALED.			2.4.90	CHKD		IRDE DEHRA DUN
	(a) D.C.(1):- 1193-I(P). CAT/PART. NO. ADDED.			9.9.86	CHKD		DATE:- 16.1.85
	D.C.(1):- 1169-I(P). DRG PROV. SEALED.			5.12.85	USED		
SYM	AMENDMENTS	CHKD	SIG	DATE	ON		
(c) MATL. & SPECN	BRASS Gde-HT-2 TO IS: 320-1980			(b)	ON		
FINISH	CLEAN				CAT./PT. NO.	5310-008841	(a)
TITLE	NUT, PLAIN, ROUND				DRG NO	IRDE 1175/30	
					SCALE	1:1	SHT. OF

D.C.(1):- 1169-I(P), 1193-I(P), 5361-I, 5448-I, 5913-I.