

NOTES:

- BREAK EDGES 0.076 +0.305 UNLESS OTHERWISE SPECIFIED.
- FLAT ON CROWNED HEAD WITHIN TOLERANCE PERMISSIBLE.
- R 0.076/0.127 PERMISSIBLE UNDER HEAD (B)
- ASME Y14.5M-1994 APPLIES.

REVISIONS				
ZONE	REV.	DESCRIPTION	DATE	APPROVED
	A	CREATE DRAWING	4/14/2008	J. HERSHBERGER
	B	CORRECTED CLERICAL ERROR, ADDED NOTE 3	2/6/2017	G. HERSHBERGER

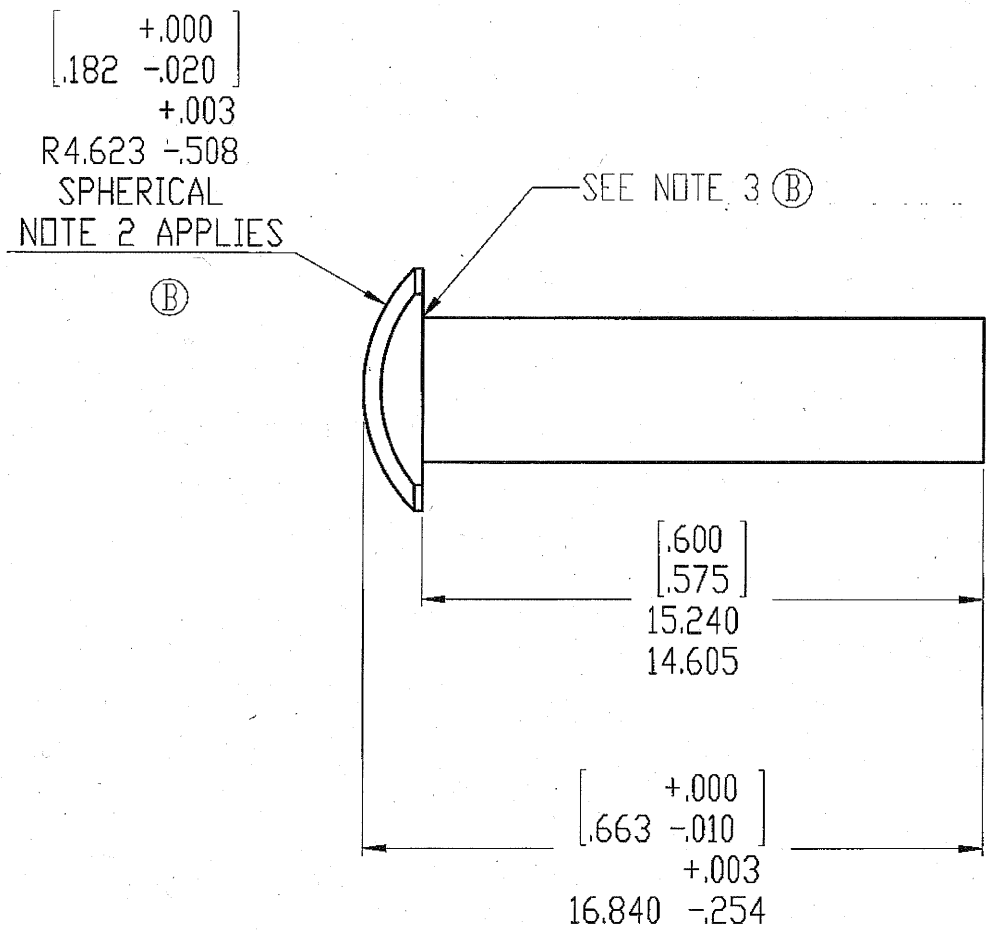
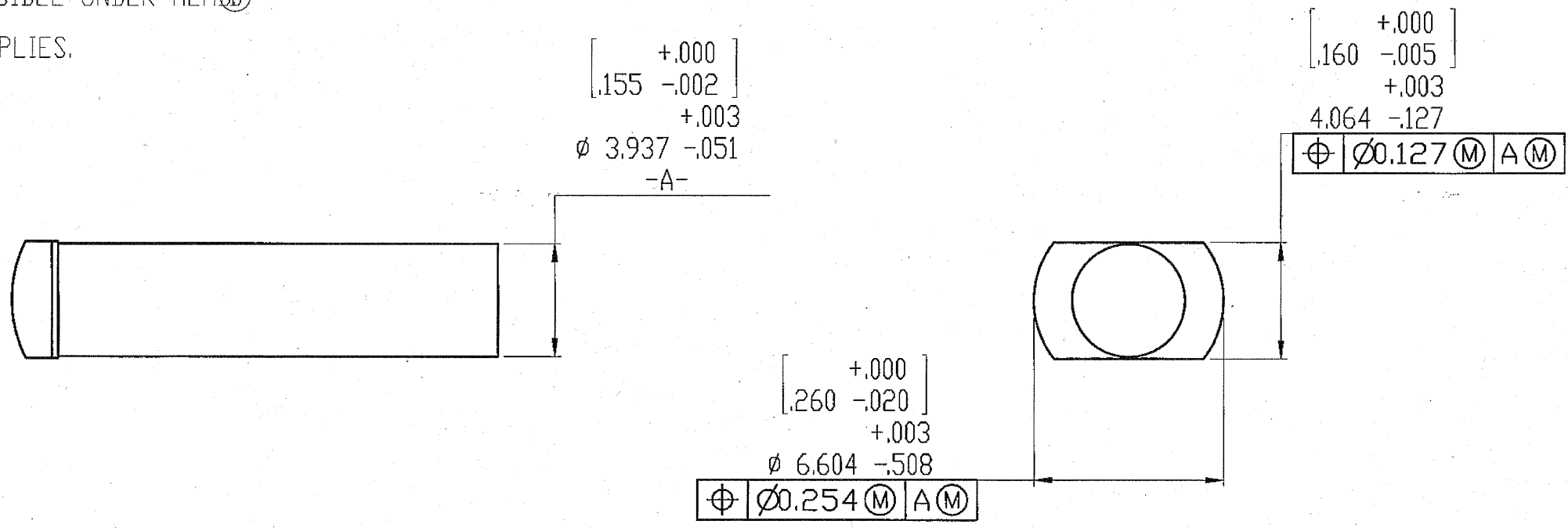

UN CONTROLLED COPY
 CERTIFIED CORRECT COPY OF APPROVED
 DRAWINGS AT THIS DATE. 29-09-2021
 DESIGN & DRAWING OFFICE,
 ORDNANCE FACTORY, TIRUCHIRAPPALI -620 016.

24 AUG 2021
 24
 हस्ताक्षर/Sig
 Forende (AP)

PROPRIETARY AND CONFIDENTIAL
 THE INFORMATION CONTAINED IN THIS
 DRAWING IS THE SOLE PROPERTY OF
 OHIO ORDNANCE WORKS, INC. ANY
 REPRODUCTION IN PART OR AS A WHOLE
 WITHOUT THE WRITTEN PERMISSION OF
 OHIO ORDNANCE WORKS, INC. IS
 PROHIBITED.

UNLESS OTHERWISE SPECIFIED	NAME	DATE
DIMENSIONS ARE IN MM/(INCHES)	HERSH	04/14/08
ALL THREAD DIM. ARE IN INCHES		
TOLERANCES:		
FRACTIONAL ±0.015	CHECKED	
ANGULAR MACH ±0.5° BEND	ENG APPR.	
TWO PLACE DECIMAL ±0.25	MFG APPR.	
THREE PLACE DECIMAL ±0.076		
INTERPRET GEOMETRIC TOLERANCING PER:	Q.A.	
MATERIAL	COMMENTS:	
AISI 1018		
FINISH		
DO NOT SCALE DRAWING		

OHIO ORDNANCE WORKS, INC.		
RIVET, BOLT LATCH BRACKET, 00W50BMG		
SIZE	5013522	REV B
SCALE: 5:1	WEIGHT:	SHEET 1 OF 1