

DC.19879-A.

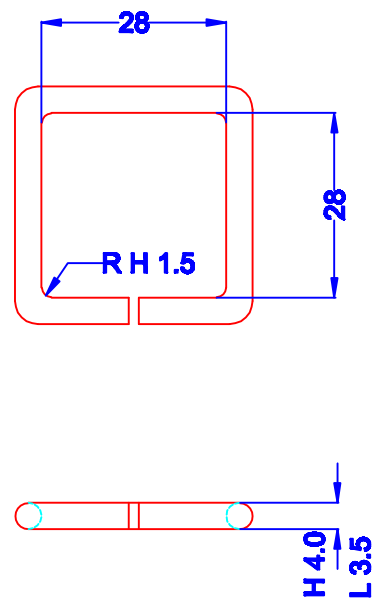

3

PART No. ISV 3

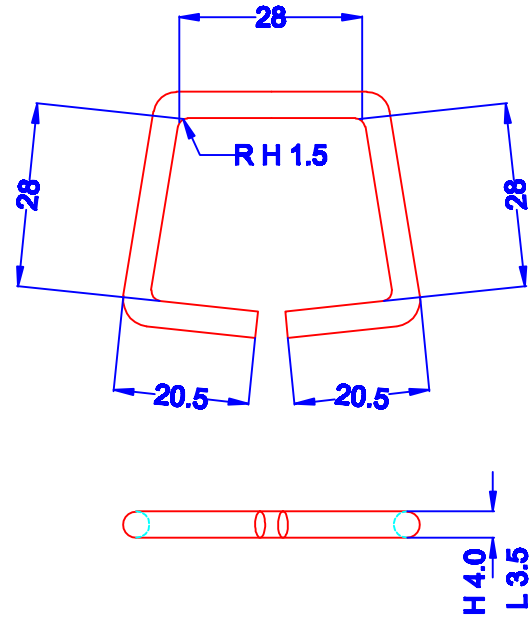

3A

ALTERNATIVE

PART No. ISV 4

NOTE :-
TOL. ON UNTOL. DIMS. ± 0.5
To BE RUST PROOFED BY ANY APPROVED PROCESS

MATERIAL :-
STEEL WIRE IN CONFORMITY WITH THE RELEVANT CLAUSE
IN SPEC. FOR WOODEN BOXES I.A. 948 (a,d)

TECHNICAL REQUIREMENT :-
AS PER SPEC. No. I.A. 1169 (n).

	13-7-04	D. C 36970 - A	REF. D.C.				DRN.	CHD.	TRD. M. S. B. / COMP. U. A. K.	ASSY. DRG.
	3 3 / 2000	D. C 36653 - A	REDRAWN WITHOUT CHANGE & NEW MASTER COPY REPLACED IN SUPERSESSON OF EXISTING DILAPIDATED COPY.				C.D. MAN	O I/C D. O.	SCALE :- 1:1	NOT APPLICABLE
			PREVIOUS D.C. NO. 19879 - A, 28870 - A, 29158 - A, 29474 - A, 29750 - A , 29886 - A, 35622 - A, & 35672 - A.		SD/-	SD/-	APPD.	FOR C. Q. A.(A)	EST. MASS :- 3 g (Approx.)	
R NO.	DATE	AUTHORITY	REVISION	ZONE	AHSP	D. O.	MATL. :- AS ABOVE		GAUGE SCHED :- NOT APPLICABLE	DESIGNER'S REF.
					SIG.		PROTECTIVE FINISH :- AS PER DRG. ISV 479 A		DATE :-	I. A. 793 SHT. 6 DET. NO.
DRG. SEALED :- 19-5-47										PART NO.
										AS ABOVE
										D. S. CAT NO.
										NOT APPLICABLE
										AHSP :- C.Q.A.(A) KIRKEE

LINK