

ENDS AND CARRYING STRAP SECURED BY DOUBLE LINE OF STITCHING RIGHT THROUGH

SINGLE DIMENSIONS SHOULD BE WORKED TO WITH REASONABLE APPROXIMATION

ENDS AND CARRYING STRAP SECURED BY DOUBLE LINE OF STITCHING RIGHT THROUGH AND REINFORCED BY SEWING THUS.

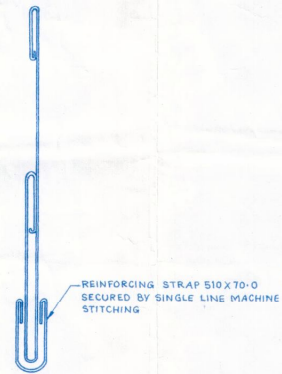
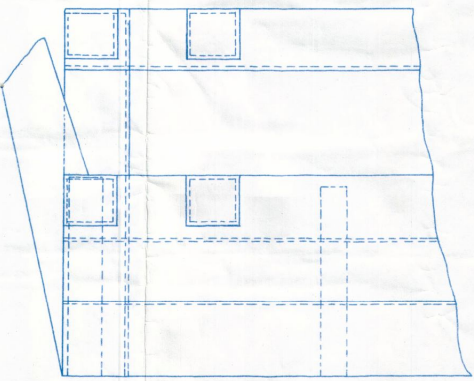

BODY
 METHOD OF CONSTRUCTION

TO BE MARKED IN BLACK PRINTER'S INK

BANDOLIER 3A

- * CONTRACTOR'S INITIALS OR RECOGNISED TRADE MARK
- + MONTH & YEAR OF MANUFACTURE IN FOUR DIGITS.

NOTE :-

TOL ON UNTOL DIMENSIONS ±0.5
 TECHNICAL REQUIREMENT SPEC. IA 1078 (J)

STITCHES :-

SEWING INDICATED THUS -----
 8 STITCHES PER 25

MATERIAL FOR FASTENER HOOK & LOOP -
 O.G TO SPEC. IS: 8156 - 1981

TESTS CLAUSE :-

FOLLOWING CHEMICAL PROPERTIES ARE REQUIRED TO BE TESTED BEFORE MANUFACTURE.

TEST	SPECIFIED
I) PH VALUE	6.0 TO 8.5
II) CHLORIDES AS NaCl	0.1% MAX.
III) SULPHATES AS Na ₂ SO ₄	0.50% MAX.

MATERIAL :-

THE BANDOLIER IS TO BE MADE OF DRILL COTTON DISRUPTIVE PATTERN (VAT PRINTED) TO SPEC N° J55 8315-08:2005. THE THREAD USED FOR STITCHING IS TO BE POLYESTER THREAD TO SPEC IS: 9543 - 1980 VARIETY N° 9 REAFFIRMED IN 1992 WITH SPECIAL CHEMICAL NEUTRALITY CLAUSE OF PH VALUE - 5.5 TO 9.5 AND SOLUBLE CHLORIDE NaCl 0.05% MAX.

18-3-83	DC 37334-A	UNDER TEST CLAUSE I & III	1-2-3		
8-7-07	DC 37123-A	YEAR OF MANUFACTURE EXTENDED IN FOUR DIGITS			
10-04-87	DC 37107-A	NOMENCLATURE ADDED IN HINDI.			
18-6-98	DC 36428-A	REPLACED WITHOUT CHANGE & NEW COPY REPLACED IN SUPERSESSION OF EXISTING DILAPIDATED COPY.			
		PREVIOUS DC N°s - 34087A, 34143-A, 34281A, 34559-A, 34879-A, 34917-A, 34999-A, 35111-A, 35141-A, 35351-A, 35407-A, 35514-A, 35555-A, 35597-A, 35308-A & 34343-A			
E N°	DATE	AUTHORITY	REVISION	ZONE	AHSE P. 9. SII

DRN- 883	CHD- PMW	TRD- (Amn) COMP- 2	ASBY DRG
SD/-	SD/-	SCALE:- 1:1	ISV 208 GA
C.D'MAN	OI/C.D.O.	EST MASS-100g (APPROX)	
SD/-	SD/-	GAUGE SCHED:- APPROX	
	FOR CQA (A)	DATE:- 24-10-86	
	MATL:- AS ABOVE		
	PROTECTIVE FINISH:- AS ABOVE		

DRG SEALED:- 15-3-87 (PROV)

BANDOLIER 3A
 FOR CARTRIDGE S. A. 7.62 mm IN CHARGERS.

DESIGNER'S REF	CIA/AMN/2464
PART N°	ISV 514 A
D.S. CAT N°	NOT APPLICABLE
AHSP	CQA (A) KIRKÉE.