

OPTICAL SPECIFICATIONS

MATERIAL	OPTICAL GRADE N TYPE MONO CRYSTALLINE SILICON	
	SURFACE R1	SURFACE R2
CLEAR APERTURE	6.5	6.9
POWER (RING) at 632.8 nm	1	1
IRREGULARITY (FRINGE) at 632.8 nm	1/3	1/3
COSMETIC QUALITY	80-40	60-40
EDGE CHAMFER	NOMINAL CHAMFERING ON EDGES	
ECCENTRICITY	1 min of an arc	

⊙ COATINGS : THE FOLLOWING SPECIFICATIONS APPLY TO BOTH SURFACES :

- HIGH DURABILITY AR COATING FROM 3.6-4.9 μm
- SEVERE ABRASION AS PER MIL-C-48497A 4.5.5.1
- SALT SOLUBILITY AS PER MIL-C-48497A 4.5.5.2.3
- HUMIDITY AS PER MIL-C-48497A 4.5.3.2.(4)
- TEMPERATURE AS PER MIL-C-48497A 4.5.4.1.(5)
- SOLUBILITY AND CLEANABILITY AS PER MIL-C-48497A 4.5.4.2.(6)
- ADHESION AS PER MIL-C-48497A 4.5.3.1
- AVERAGE TRANSMISSION ≥ 95% AS MEASURED THROUGH 1 mm THICK WITNESS SAMPLE COATED IN THE SAME COATING RUN

VETTED
Amul
 (A.K. GUPTA)
 S.E., IRDE

POLISHED FINE GROUND FINE A.R. COATING

MATERIAL : AS GIVEN ABOVE
 FINISH : AS GIVEN ABOVE

	NAME & SIG.	DATE
DRAWN BY	K S RAMA	
CHECKED BY	KANCHAN CHANDRA	
CHECKED BY	RANBIR NANDAL	
APPROVED BY	P K SHARMA	

⊙	COATINGS	1	<i>Rev</i>	<i>12/10/14</i>
SYMBOL	ZONE	ISSUE	AUTH.	DATE

BASED ON
 USED ON

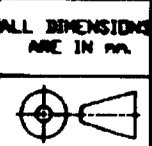

TITLE:
LENS - 4

IRDES INSTRUMENTS RESEARCH & DEVELOPMENT ESTABLISHMENT, BEHRA BUN
 DRG. NO. 096701030100 011
 SCALE NTS SHT OF