

A1-1  
30

D.C.(1):-1232-I(P), 5423-I

| SIZE | ZONE | REF.N | PART NO        | NOMENCLATURE          | Qty | REMARKS |
|------|------|-------|----------------|-----------------------|-----|---------|
|      |      |       |                | <u>DOCUMENTS</u>      |     |         |
| 22   |      |       | A45.935.058 CB | ASSEMBLY DRAWING      |     |         |
|      |      |       |                | <u>ASSEMBLY UNITS</u> |     |         |
| 11   | 1    |       | A45.944.010    | HEATING SHEET         |     |         |
|      |      |       |                | <u>COMPONENTS</u>     |     |         |
| 22   | 4    |       | A47.200.056    | PRISM                 | 1   |         |
| 11   | 5    |       | A47.842.049    | ADHESIVE FILM         | 1   |         |
| 11   | 6    |       | A47.842.050    | ADHESIVE FILM         | 1   |         |
| 11   | 7    |       | A47.842.051    | ADHESIVE FILM         | 1   |         |
| 11   | 8    |       | A47.842.052-02 | ADHESIVE FILM         | 2   |         |
| 11   | 9    |       | A48.210.013    | CUP                   | 1   |         |
| 11   | 10   |       | A48.683.234-01 | GASKET                | 10  |         |
|      | 11   |       | -02            | GASKET                | 10  |         |
|      | 12   |       | -03            | GASKET                | 10  |         |
|      | 13   |       | -04            | GASKET                | 10  |         |
|      | 14   |       | -05            | GASKET                | 10  |         |

SIGNATURE AND DATE

D.C.(1):-5423-I  
PT. LIST SEALED

up dated up to 31/5/89 DD(OL-F)

|    |   |           |         |
|----|---|-----------|---------|
| 7  | D.C.(1):-1232-I(P)<br>PART LIST<br>PROY. SEALED | 10        | 1.12.87 |
| AM | Serial No. of DOCUMENT                          | SIGNATURE | DATE    |

A45.935.058.

|            |                    |
|------------|--------------------|
| DESIGNER   |                    |
| CHECKED BY | <i>[Signature]</i> |
| INSPECTOR  |                    |
| APPROVED   | <i>[Signature]</i> |

HEATING PRISM

|                                 |       |              |
|---------------------------------|-------|--------------|
| LETTER                          | SHEET | No. OF SHEET |
|                                 | 1     | 2            |
| HEAVY VEHICLES FACTORY<br>AVADI |       |              |

①







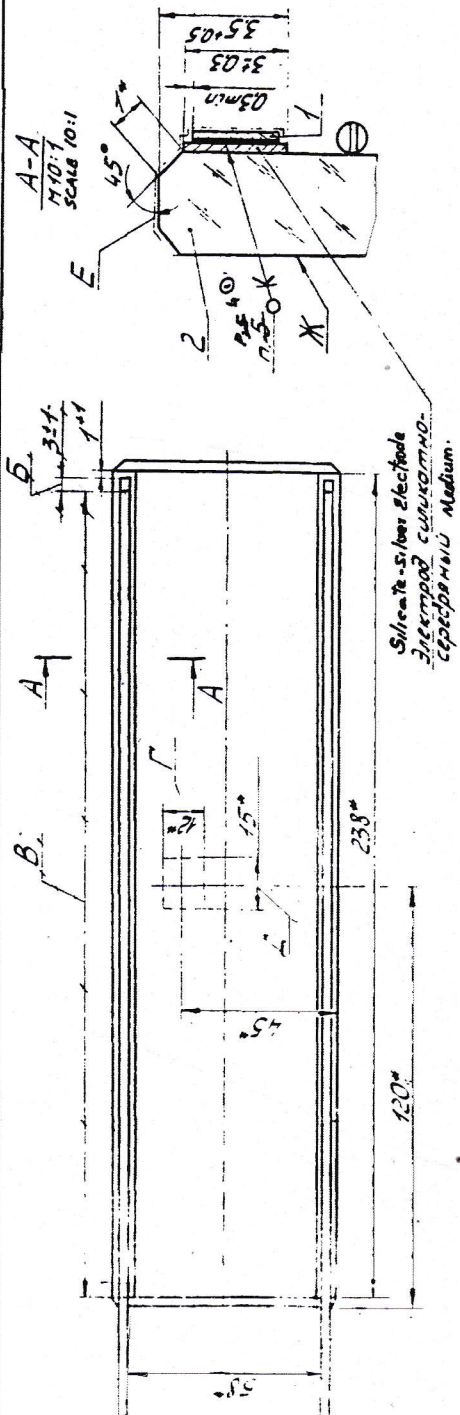

1. Conducting coating should be made of semiconductor dioxide of tin with the addition of fluorine.
2. Silicate-silver electrodes should be applied over conducting coating along its full length. Thickness of electrodes should be 0.02 to 0.03 mm. Thickness of sheet with electrodes should be hardened. Hardening degree should be 0.7 W/cm min.
3. Sheet with electrodes should be hardened. Hardening degree should be 0.7 W/cm min.
4. Ties 1 should be glued using conducting adhesive with nickel filler. TY 6-05-04-808-830
5. Liquid sublayer NC-4 146-06-1163-9 should be applied on surface "B" along the entire length of sheet.
6. Conducting coating resistance should ensure the fulfillment of point 1 of 145, 935, 0505.
7. Heating rate of the sheet should be checked by the method of melting thin layer of paraffin wax Gost 23988-79 which is applied on surface "A" with section specified by dimensions "r" and "A" with the temperature of sheet and the surrounding air of 25 ± 2° C. Melting time of the paraffin wax should be with in 45 to 65 sec from the moment the electric heating is switched on. The supply voltage of heating is to be 23 - 0.3 V. should be measured by voltmeter of accuracy class 1.5 having the scale from 0 to 37 V.
8. Dimensions for reference.
9. Rest of the technical requirements are as per TY3-3,834-73.

41315 KD 41-1

A45-944.010.05

HEATING SHEET

|            |       |           |          |                        |      |       |
|------------|-------|-----------|----------|------------------------|------|-------|
| DCO-5423-1 | 51090 | DCS       | SEALED   | SHEET                  | MASS | SCALE |
| 11287      | 018   | 018       | 018      | 141                    | 0.22 | 1:1   |
| 123        | 23    | 23        | 23       | 16                     |      |       |
| 123        | 23    | 23        | 23       |                        |      |       |
| 123        | 23    | 23        | 23       |                        |      |       |
| ISSUE      | DATE  | REFERENCE | MATERIAL | HEAVY VEHICLES FACTORY |      |       |
| APPROVED   | DATE  | REFERENCE | MATERIAL | AVADI                  |      |       |
| CHECKED    | DATE  | REFERENCE | MATERIAL |                        |      |       |
| DRAWN      | DATE  | REFERENCE | MATERIAL |                        |      |       |

up dated up to 31/05/09 09(01.F)



20 30  
A (D)

B = 8  
M 4:1

|                                 |     |
|---------------------------------|-----|
| Δ ПГ                            | 5   |
| Δ (ПГ-ПГ)                       | 5   |
| HOMOGENEITY                     | 5   |
| DOUBLE REFRACTION               | 5   |
| WEAKENING                       | 8   |
| NONSTRIATION                    | *   |
| BUBBLING                        | 7E  |
| P <sub>A</sub> , P <sub>B</sub> | VII |

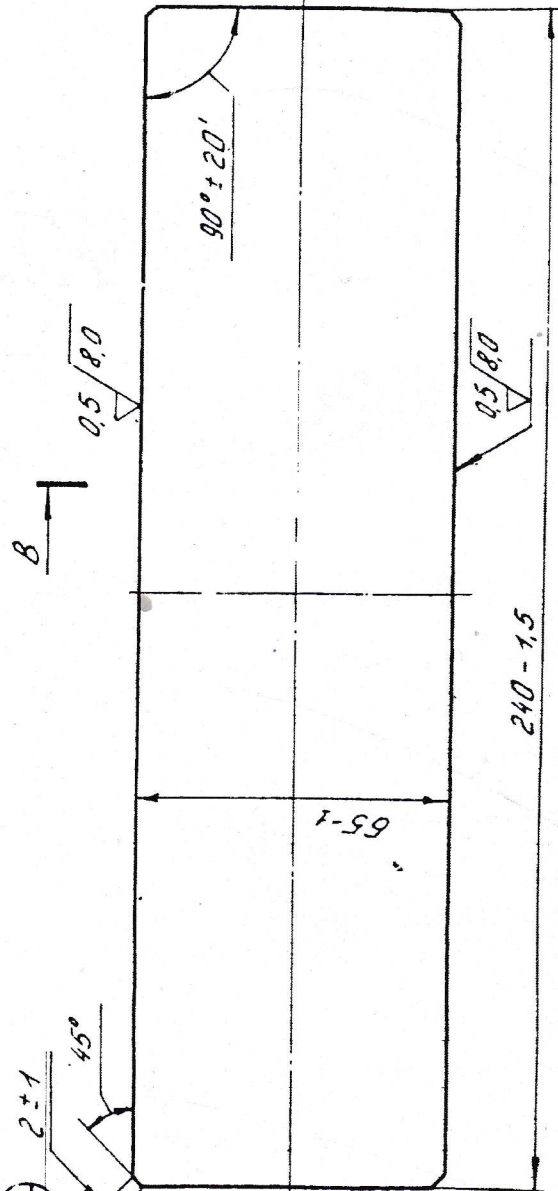
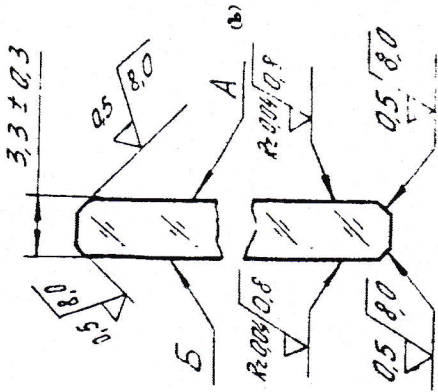

1. ФАСКИ НА РЕБРАХ 0,5 ± 0,5 × 45°, КРОМЕ  
 МЕСТ УКАЗАННЫХ ОБОДА  
 2\* БЕССВЯТНОСТЬ И ОСТАЛЬНЫЕ ТЕХНИЧЕС-  
 КИЕ ТРЕБОВАНИЯ ПО ТУЗ - 3834 - 78.  
 1. UNLESS OTHERWISE SPECIFIED THE CHAMFERS ON EDGES  
 SHOULD BE 0.5 ± 0.5 × 45°  
 2. NONSTRIATION AND OTHER TECHNICAL REQUIREMENTS  
 ARE AS PER ТУЗ - 3834 - 78

up dated up to 21/05/09 00 (D.L.F)  
 A-I

|   |          |         |         |         |          |      |           |
|---|----------|---------|---------|---------|----------|------|-----------|
| 12.10.93  | 12.10.93 | 5.10.90 | 10.7.90 | 1.12.87 | ISSUE    | DATE | REFERENCE |
| INV   | INV      | INV     | 16      | 16      | CHECKED  | DATE | REFERENCE |
| 12.10.93  | 5.10.90  | 10.7.90 | 1.12.87 | 16      | APPROVED | DATE | REFERENCE |
| (D.C. 5177-I. DETAIL OF MATL. & TABLE AMENDED.)<br>D.C. (1) - 5423-I.<br>DRG. SEALED (D.C. 701-1462-70)<br>NOM. MATL. AMENDED D.C. (1) - 1232-I (P).<br>DRG. PROV. SEALED |          |         |         |         |          |      |           |
| MATERIAL: GLASS JK 108<br>GOST 3544-76 E  |          |         |         |         |          |      |           |
| SHEET MASS SCALE<br>1/8 0.11 1:1  |          |         |         |         |          |      |           |
| SHEET MASS SCALE<br>1/8 0.11 1:1  |          |         |         |         |          |      |           |
| (A) PLATE<br>(B) (4) HEAVY VEHICLES FACTORY AVADI (45)  |          |         |         |         |          |      |           |
| ALL 8 640.107   |          |         |         |         |          |      |           |

ALL 8 640.107

D.C. (1) - 1232-I (P), 1462-I (P), 5423-I, 5777-I, TAND-1688-026 ALL 5.944.010 1:20-12 103, 10 X 15



АЦ7.842.049  
~~ТНПО-1688-044~~

А16-1  
 47

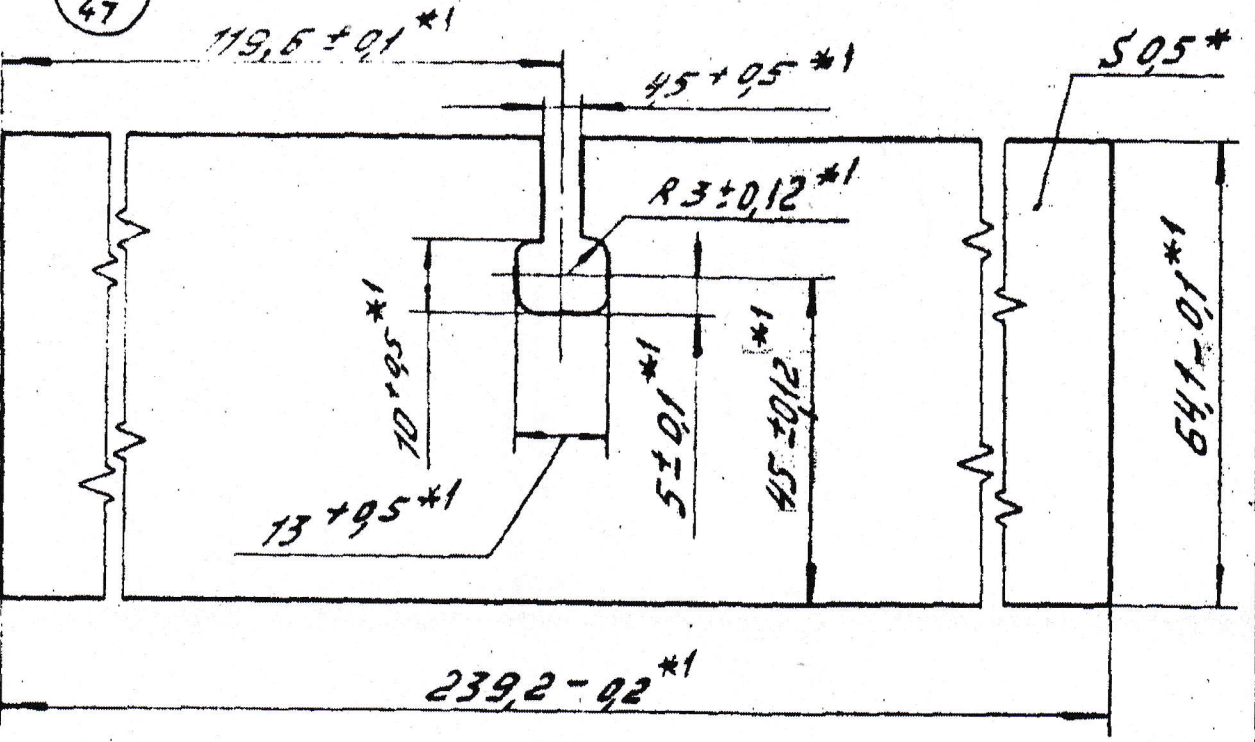

1. \* DIMENSION FOR REFERENCE  
 2. \*1 DIMENSION SHOULD BE ENSURED BY TOOL.

1. \* Размер для справок.  
 2. \*1 размеры обеспечиваются инструментом.

up dated up to 31/5/89 DO(PL.F)

АЦ7.842.049

|          |         |  |                                       |        |       |
|----------|---------|--|---------------------------------------|--------|-------|
|          |         |  | ADHESIVE FILM                         |        |       |
| W        | 5.10.90 | D.C.(1):-5423-I<br>DRG. SEALED.          | SHEET                                 | MASS   | SCALE |
| W        | 10.7.90 | (A)D.C.(1):-1462-I<br>MATL. AMENDED.     | log                                   | 0.0091 | 1:1   |
| 10       | 1.12.87 | D.C.(1):-1232-I(P).<br>DRG. PROV. SEALED |                                       |        |       |
| ISSUE    | DATE    | REFERENCE                                |                                       |        |       |
| APPROVED |         | 2/3/85                                   | MATERIAL:<br>TAPE A-17 0.5 x 1000 (A) |        |       |
| CHECKED  |         | 16/2/85                                  | HEAVY VEHICLES FACTORY                |        |       |
| DRAWN    |         | 5/2/85                                   | AVADI                                 |        |       |

D.C.(1):-1232-I(P), 1462-I(P), 5423-I.

Треб. применение  
 АЦ7.842.049  
 ТНПО-1688-050  
 АЦ7.842.049  
 ТНПО-1688-041

АЦ7.842.049  
 ТНПО-1688-041

1987-88

АЦ7.842.049  
 ТНПО-1688-041

①  
~~THNO-1688-0198~~  
 A47 842 050

ⓐ16-1  
 48

THNO-1688-0198  
 A45.935.058  
 1-8-685-056

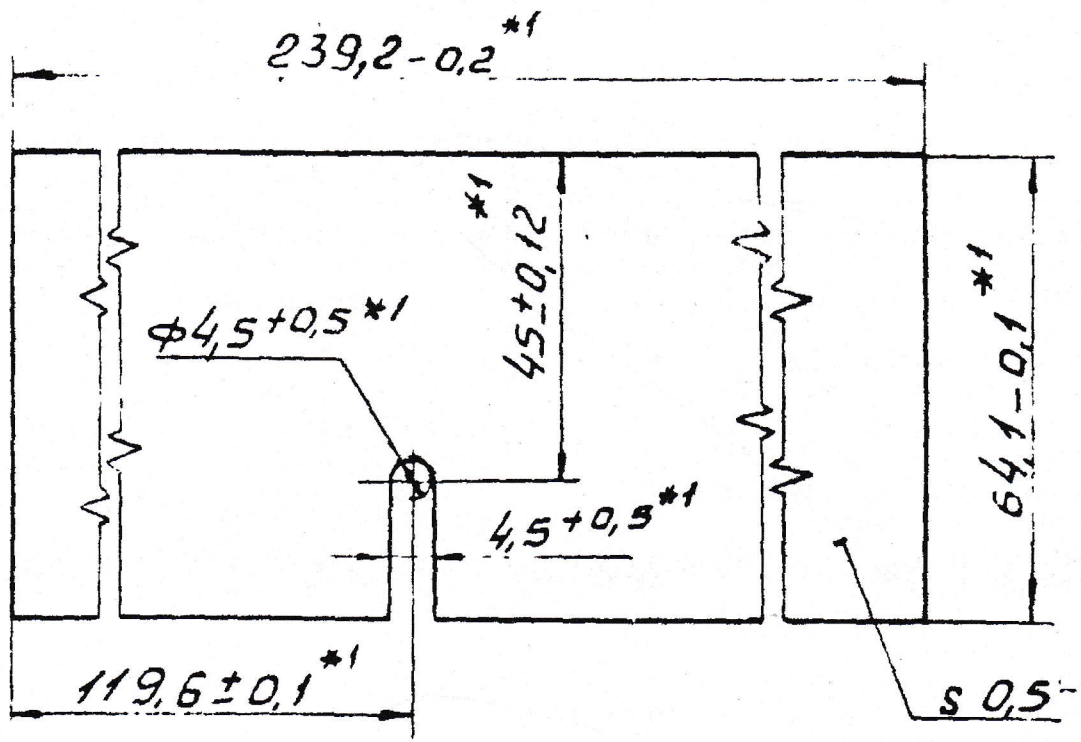

- 1.\* DIMENSION FOR REFERENCE
- 2.\* DIMENSIONS SHOULD BE ENSURED BY TOOL.

- 1.\* Размер для справок.
- 2.\* Размеры обеспечиваются инструментом

D.C.(1):-1232-I(P),1462-I(P), 5423-I

13927-291

up dated up to 31/5/89 DO (D.L.F)

A47.842.050

|                     |                    |   |                                      |        |       |
|---------------------|--------------------|---|--------------------------------------|--------|-------|
|                     |                    |   | ADHESIVE FILM                        |        |       |
| ISSUE               | DATE               | REFERENCE                               | SHEET                                | MASS   | SCALE |
| ✓                   | 5.10.90            | D.C.(1):-5423-I<br>DRG. SEALED.         | 102!                                 | 0.0091 | 1:1   |
| ✓                   | 10.7.90            | (A)D.C.(1):-1462-I(P)<br>MATL. AMENDED. |                                      |        |       |
| ✓                   | 1.12.87            | D.C.(1):-1232-I(P)<br>DRG. PROV. SEALED |                                      |        |       |
| APPROVED            | <i>[Signature]</i> | 21/3/85                                 | HEAVY VEHICLES FACTORY<br>AVADI (29) |        |       |
| CHECKED             | <i>[Signature]</i> | 16/5/85                                 |                                      |        |       |
| DRAWN               | <i>[Signature]</i> | 5/2/85                                  |                                      |        |       |
| MATERIAL:           |                    |   |                                      |        |       |
| TAPE A-17, 0.5x1000 |                    |   |                                      |        |       |
| GOST 9438-85        |                    |   |                                      |        |       |

7120 8891 01111  
 150 248 177  
 447.842.051

8

A16-1  
 49

145.935.058

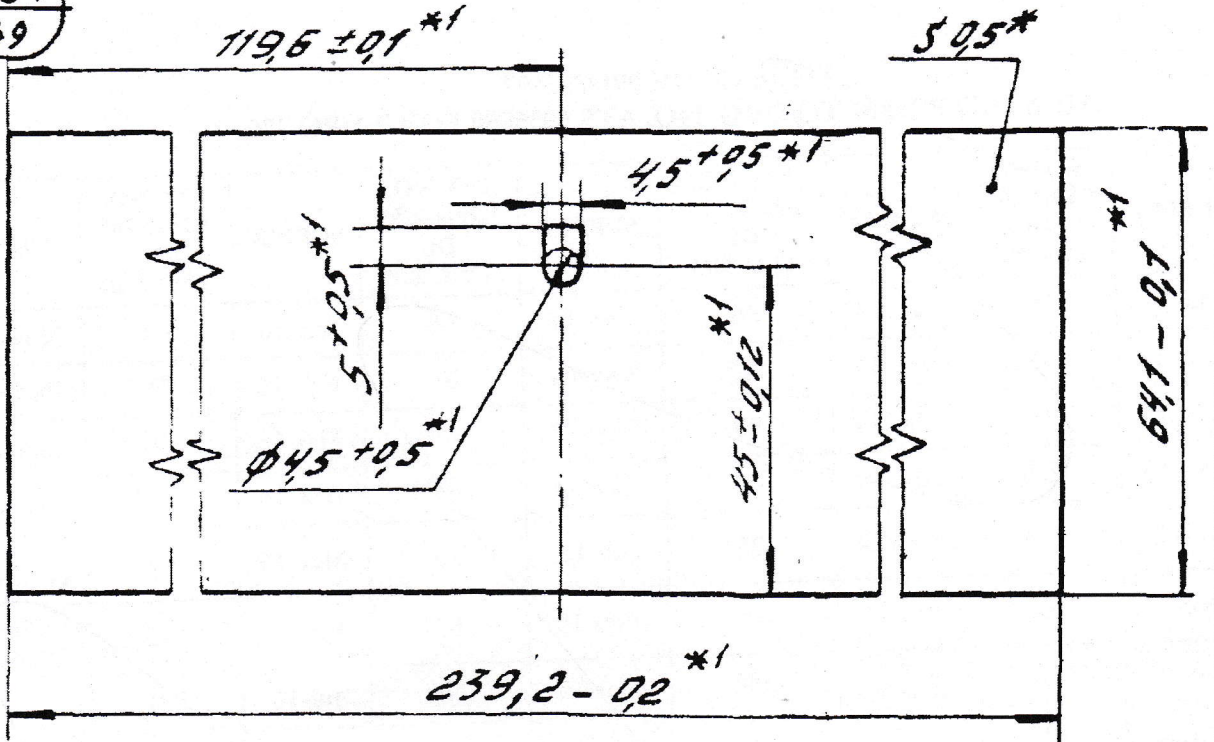

- 1. \* DIMENSION FOR REFERENCE
- 2. \*1 DIMENSION SHOULD BE ENSURED BY TOOL.

- 1. \* Размер для справок.
- 2. \*1 Размеры обеспечиваются инструментом.

up dated up to 31/5/89 00(04-1)

A47.842.051

|  |                    |                                      |                                  |        |       |
|--|--------------------|--------------------------------------|----------------------------------|--------|-------|
| D.C.(1):-1232-I(P), 1462-I(P), 5423-I. |                    |                                      | up dated up to 31/5/89 00(04-1)  |        |       |
| D.C.(1):-5423-I. DRG. SEALED.          |                    |                                      | A47.842.051                      |        |       |
| W                                      | 5.10.90            | (A) D.C.(1)-1462-I(P) MATL. AMENDED. | SHEET                            | MASS   | SCALE |
| W                                      | 10.7.90            | D.C.(1):-1232-I(P) DRG. PROUSEALED.  | 181                              | 0.0092 | 1:1   |
| 16                                     | 1.12.87            |                                      | ADHESIVE FILM                    |        |       |
| ISSUE                                  | DATE               | REFERENCE                            | MATERIAL: Т.П.А-17, 0,5x1000 (A) |        |       |
| APPROVED                               | <i>[Signature]</i> | 21/3/85                              | HEAVY VEHICLES FACTORY           |        |       |
| CHECKED                                | <i>[Signature]</i> | <i>[Signature]</i>                   | AVADI                            |        |       |
| DRAWN                                  | <i>[Signature]</i> | 5/3/85                               | GOST 9438-85                     |        |       |

D.C.(1):-1232-I(P), 1462-I(P), 5423-I.

145.935.058

145.935.058

145.935.058

АЦ7.842.052

А16-1  
50

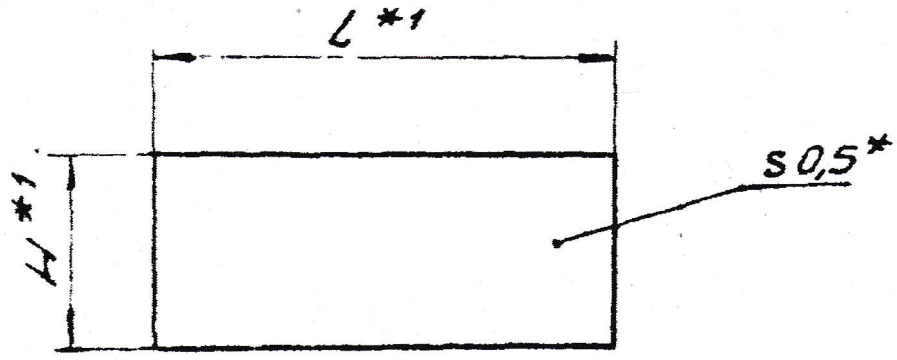

СРЕДСТВОУНЬЮ № ПЕРВ. ПРИНЕР. НУЕ  
ТНПО-168В-035А АЦ5.935.057

| PART NO<br>ОБОЗНАЧЕНИЕ | DIMENSIONS,<br>РАЗМЕРЫ, мм |          | MASS<br>МАССА,<br>кг |
|------------------------|----------------------------|----------|----------------------|
|                        | L                          | H        |                      |
| АЦ7.842.052            | 60С5                       | 3С5      | 0,00011              |
| -01                    | 227,2-0,2                  | 59,6-0,1 | 0,008                |
| -02                    | 239,2-0,2                  | 64,1-0,1 | 0,009                |

- 1. \* DIMENSION FOR REFERENCE
- 2. \*1 SHOULD BE ENSURED BY TOOL.

- 1. \* Размер для справок.
- 2. \*1 Обеспеч. инстру.

D.C.(1):-1232-I(P), 14.62-1(P), 5423-I

5040-95

up dated up to 31/5/89 00 (P.L.P)

АЦ7.842.052.

| ISSUE    | DATE | REFERENCE | MATERIAL:<br>ТАРЕ А-17, Ø 5 × 1000<br>ГОСТ 9438-85 | SHEET                                    | MASS      | SCALE |
|----------|------|-----------|--|--|-----------|-------|
| APPROVED |      |           |  | (A) HEAVY VEHICLES FACTORY<br>AVADI (31) |           |       |
| CHECKED  |      |           | 1/81   |  | SEE TABLE | -     |
| DRAWN    |      |           |  |  |           |       |

ALL

5.10.90 D.C.(1)-5423-I  
DRG. SEALED.  
10.7.90 (A) D.C.(1)-1462-10  
MATL AMENDED  
1.12.87 D.C.(1)-1232-I(P)  
DRG. PROV. SEALED

ADHESIVE FILM

Восстановлен с подлинника. Верно: 4/8

ТНД - 1688 - 042 АЦ.5.935.058

АЦ8 210 013

R280, (1)

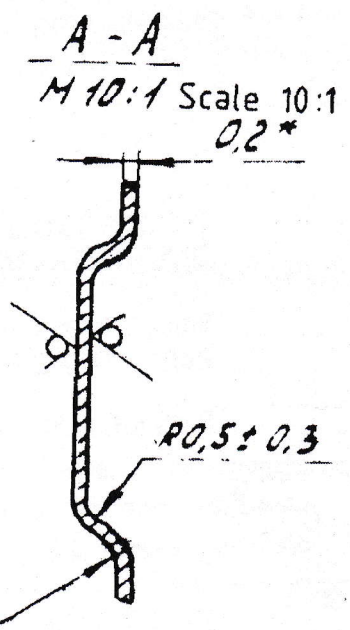
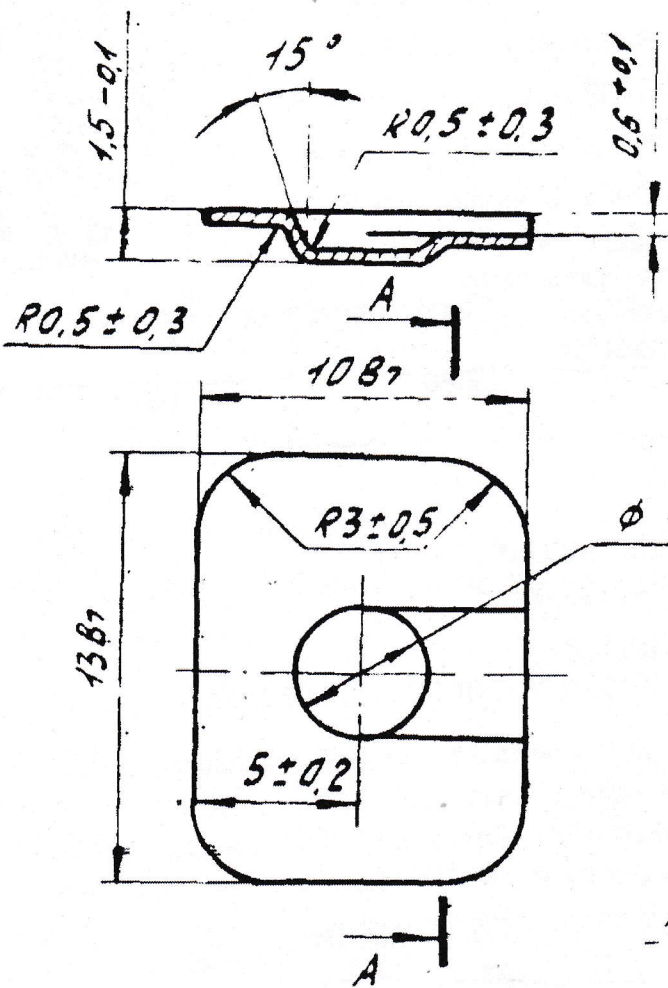

- 1. Burrs are not allowed.
- 2.\*Dimension for reference.

1. Заусенцы не допускаются в/ноч.  
2. \* Размер для справок.

D. C (I) - 1231-I (P), 5421-I, 5562-I.

G/No 413/85

CAT/PT.No. 5905-020255

up dated up to 31/5/89 DO (OL: F)

|          |             |           |                          |  |  |                        |  |        |       |
|----------|-------------|-----------|--------------------------|--|--|------------------------|--|--------|-------|
|          |             |           | АЦ8.210.013.             |  |  | (A2/6A)                |  |        |       |
|          |             |           | COVER, THERMAL RESISTOR. |  |  | SHEET                  |  | MASS.  | SCALE |
|          |             |           |                          |  |  | 1 OF 1                 |  | 0.0002 | 5:1   |
| ISSUE    | DATE        | REFERENCE |                          |  |  |                        |  |        |       |
| APPROVED |             |           | MATERIAL:                |  |  | HEAVY VEHICLES FACTORY |  |        |       |
| CHECKED  | K. Damodan  | 24.5.85   | COPPER MI GOST 1173-77.  |  |  | AVADI 40               |  |        |       |
| DRAWN    | M. Navidhan | 13/5/85   |                          |  |  |                        |  |        |       |

2