

D. A. NO.

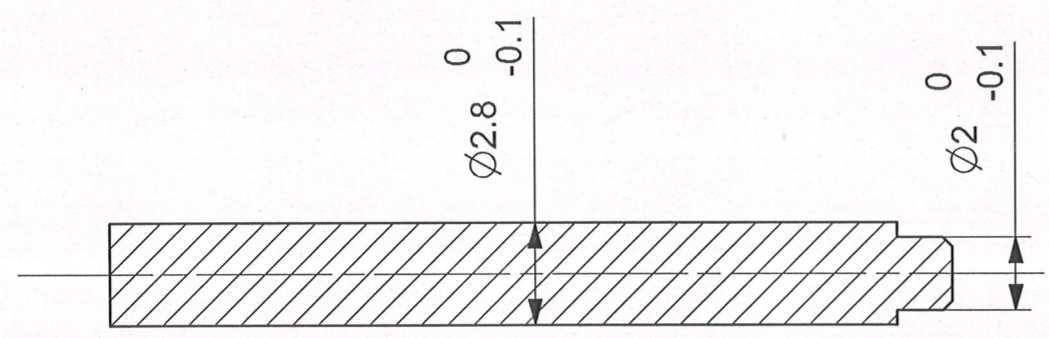

SECTION A-A

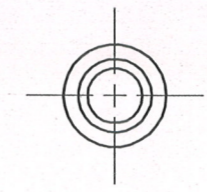
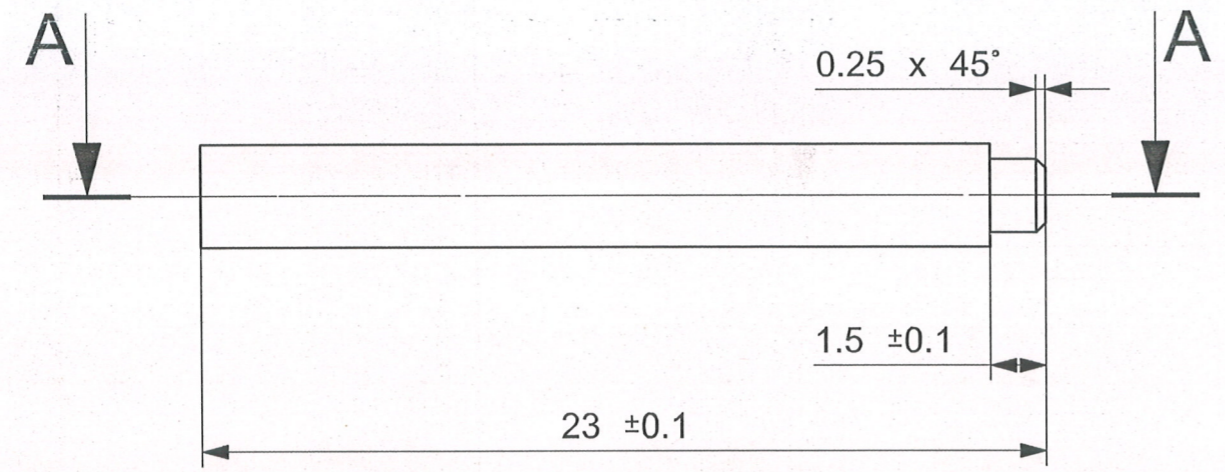
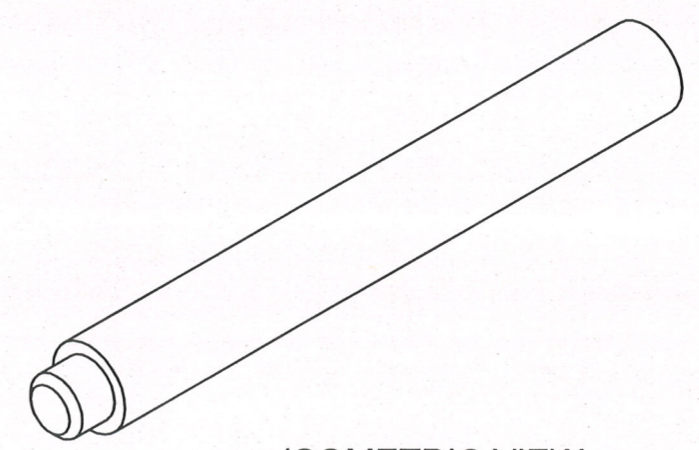

ISOMETRIC VIEW

MATERIAL:- STEEL BS970 Pt.1:1983 Gd.655M13 OR En-36

ALT.MATL.:- STEEL BS970 Pt.1:1983 Gd.835M15 OR En-39B

HEAT TREATMENT:- HARDENED & TEMPERED TO 550 - 600 H.V.
WITH CASE DEPTH 0.13 TO 0.26 mm.

PROTECTIVE FINISH:- PHOSPHATED TO SPECN. J.S.S.-0465-01:1988 CLASS II
(ACCELERATED) OIL FINISH.

DIMENSIONS ARE IN MM.

REVOLVER.32 (7.65 mm) SIDE SWING	DESIGNED BY	<i>A.S.RANA</i> A.S.RANA
	CHECKED BY	<i>JWM/DDO</i> JWM/DDO
PIN CENTER CYLINDER LATCH	APPROVED BY	<i>WM/DDO</i> WM/DDO
	DATE	29.06.2019
SCALE 5 : 1	DRAWING NO.	
	SMALL ARMS FACTORY	
	KANPUR	
		SHEET 1 OF 1
		A3