

700-54-139

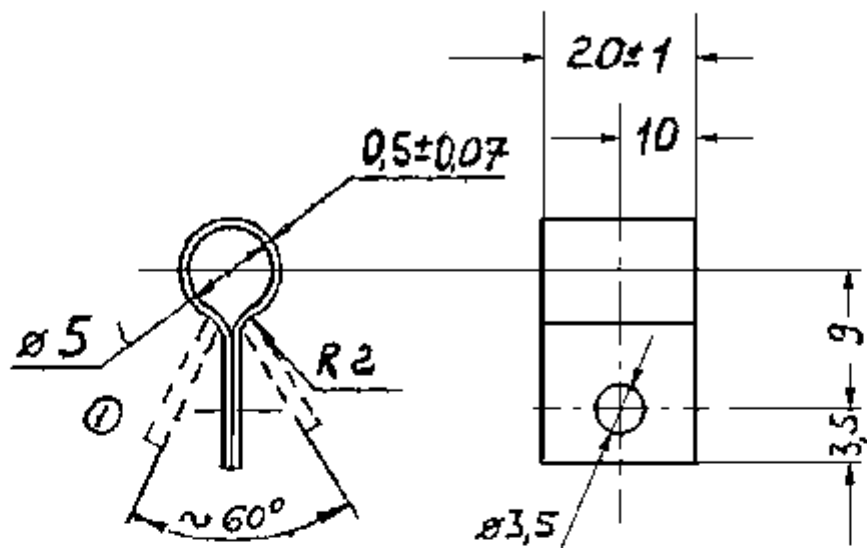

TECHNICAL CONDITIONS.

1. BURRS ARE NOT ALLOWED.
2. WITH AN ACCURACY OF ± 0.5 ACCOMPLISH DIMENSIONS, NO DEVIATIONS.
3. MATERIAL SUBSTITUTE 08,10 GOST 1050-74.
4. COATING $U_3 9 \div 15XP$ (CHROM). REMOVE PICKLE BRITTLENESS.
5. PREPARATION ALONG THE DOTTED LINE IS ALLOWED.

NEAREST EQ. MATERIAL

08кп GOST 1050-74

ORGL MATERIAL:-

DC(No. & DATE

ISSUE

ALL SHARP EDGES & CORNERS TO BE ROUNDED OF
DRG. NOT TO BE SCALED

ALL THREADS TO CONFORM TO SPECIFICATION

STAMP OR ETCH, PART NO. MANUFACTURERS NAME & YEAR OF MFR.

SCALE: 2:1

TOLERANCE ON DIMENSIONS UNLESS OTHERWISE SPECIFIED

USED ON: 773-82-Sb106

DATE:-

DRN.

WEIGHT: (Kg.)

TCD.

0.003

700-54-139

CHD.

APD.

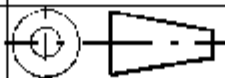

CLAMP

CONTROLLERATE OF QUALITY ASSURANCE
(INFANTRY COMBAT VEHICLES)