

2

THIS DOCUMENT AND THE INFORMATION CONTAINED IN IT ARE PROPRIETARY AND CONFIDENTIAL TO OET. NO PERSON OR ENTITY IS ALLOWED TO COPY, REPRINT, REPRODUCE OR PUBLISH ANY PART OF THIS DOCUMENT, NOR DISCLOSE ITS CONTENTS TO OTHERS, NOR MAKE ANY USE OF IT, NOR ALLOW OR ASSIST OTHERS TO MAKE ANY USE OF IT UNLESS BY THE PRIOR WRITTEN EXPRESS AUTHORIZATION OF OET AND THEN ONLY TO THE EXTENT AUTHORIZED.
COPYRIGHT © OET.

GENERAL TOLERANCES (FREE SIZE TOLERANCES) PER DIN 7185 m					
LINEAR DEVIATION	ANGULAR DEVIATION				
0.5	10	50	120	10	50
1	15	75	180	15	75
2	20	100	240	20	100
3	25	150	360	25	150
4	30	200	480	30	200
5	35	250	600	35	250
6	40	300	720	40	300
7	45	350	840	45	350
8	50	400	960	50	400
9	55	450	1080	55	450
10	60	500	1200	60	500
11	65	550	1320	65	550
12	70	600	1440	70	600
13	75	650	1560	75	650
14	80	700	1680	80	700
15	85	750	1800	85	750
16	90	800	1920	90	800
17	95	850	2040	95	850
18	100	900	2160	100	900
19	105	950	2280	105	950
20	110	1000	2400	110	1000
21	115	1050	2520	115	1050
22	120	1100	2640	120	1100
23	125	1150	2760	125	1150
24	130	1200	2880	130	1200
25	135	1250	3000	135	1250
26	140	1300	3120	140	1300
27	145	1350	3240	145	1350
28	150	1400	3360	150	1400
29	155	1450	3480	155	1450
30	160	1500	3600	160	1500
31	165	1550	3720	165	1550
32	170	1600	3840	170	1600
33	175	1650	3960	175	1650
34	180	1700	4080	180	1700
35	185	1750	4200	185	1750
36	190	1800	4320	190	1800
37	195	1850	4440	195	1850
38	200	1900	4560	200	1900
39	205	1950	4680	205	1950
40	210	2000	4800	210	2000
41	215	2050	4920	215	2050
42	220	2100	5040	220	2100
43	225	2150	5160	225	2150
44	230	2200	5280	230	2200
45	235	2250	5400	235	2250
46	240	2300	5520	240	2300
47	245	2350	5640	245	2350
48	250	2400	5760	250	2400
49	255	2450	5880	255	2450
50	260	2500	6000	260	2500
51	265	2550	6120	265	2550
52	270	2600	6240	270	2600
53	275	2650	6360	275	2650
54	280	2700	6480	280	2700
55	285	2750	6600	285	2750
56	290	2800	6720	290	2800
57	295	2850	6840	295	2850
58	300	2900	6960	300	2900
59	305	2950	7080	305	2950
60	310	3000	7200	310	3000
61	315	3050	7320	315	3050
62	320	3100	7440	320	3100
63	325	3150	7560	325	3150
64	330	3200	7680	330	3200
65	335	3250	7800	335	3250
66	340	3300	7920	340	3300
67	345	3350	8040	345	3350
68	350	3400	8160	350	3400
69	355	3450	8280	355	3450
70	360	3500	8400	360	3500
71	365	3550	8520	365	3550
72	370	3600	8640	370	3600
73	375	3650	8760	375	3650
74	380	3700	8880	380	3700
75	385	3750	9000	385	3750
76	390	3800	9120	390	3800
77	395	3850	9240	395	3850
78	400	3900	9360	400	3900
79	405	3950	9480	405	3950
80	410	4000	9600	410	4000
81	415	4050	9720	415	4050
82	420	4100	9840	420	4100
83	425	4150	9960	425	4150
84	430	4200	10080	430	4200
85	435	4250	10200	435	4250
86	440	4300	10320	440	4300
87	445	4350	10440	445	4350
88	450	4400	10560	450	4400
89	455	4450	10680	455	4450
90	460	4500	10800	460	4500
91	465	4550	10920	465	4550
92	470	4600	11040	470	4600
93	475	4650	11160	475	4650
94	480	4700	11280	480	4700
95	485	4750	11400	485	4750
96	490	4800	11520	490	4800
97	495	4850	11640	495	4850
98	500	4900	11760	500	4900
99	505	4950	11880	505	4950
100	510	5000	12000	510	5000

NOTES:

- INTERPRET THIS DRAWING IAW ASME Y14.100M.
- MATERIAL: STEEL ALLOY SAE 4340 PER SAE-AMS-S-5000. (EQUIVALENT STEEL IS PERMITTED AFTER ELBIT APPROVAL).
- HEAT TREATMENT: QUENCH AND TEMPER ENTIRE PART: HARDNESS 35±4 HRC.
- DEBURR AND REMOVE SHARP EDGES APPROX. 0.3X45°.
- GENERAL TOLERANCES ACCORDING TO DIN 7185-m.
- BLACK OXIDE CLASS 1 PER MIL-DTL-13924.
- QUALITY ASSURANCE PROVISIONS: 7.1 QUALITY ASSURANCE PROVISIONS FOR THIS ITEM PER RDMQD00012P. 7.2 MAJOR CHARACTERISTIC NO. 101.
- PACKAGING AND PACKING: THE FINISHED PART SHALL BE PRESERVED AND PACKAGED IN ACCORDANCE WITH COMMERCIAL PRACTICE.
- IDENTIFY PER MIL-STD-130 PARA 4.1.8, BY LABELLING ITS CONTAINER WITH THE PART NUMBER, CHARACTERS 3.2 MM HIGH.

4490303403, 41871

DWG NO 019895A-00
SHEET REV RECORD

SH 1
REV ECO DESCRIPTION DATE APVD

REV	ECO	DESCRIPTION	DATE	APVD
01		Freeze	11-Sep-08	
02		Freeze	08-Nov-09	
03		Restricted	13-Dec-09	
---		Top 20 Identical To Previous	20-Sep-18	L. Goldstein

REVISION RECORD

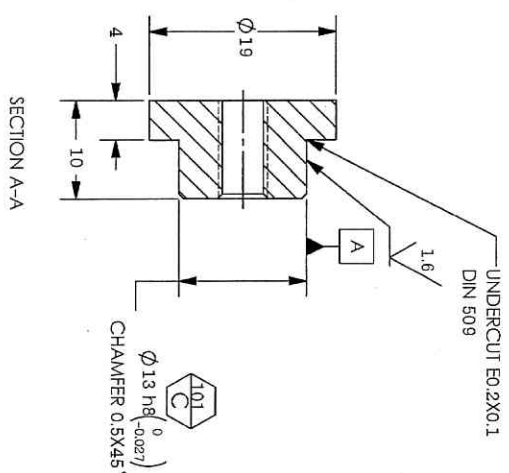
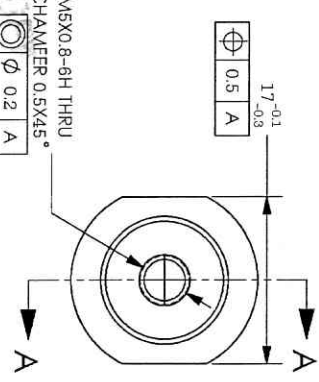

CERTIFIED CORRECT COPY
OF APPROVED DRAWINGS
AT THIS DATE: 26.11.2020

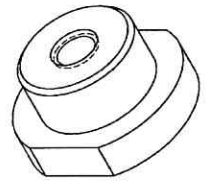

Design & Drawing Office
Ordnance Factory,
TIRUCHIRAPPALLI-620016

6.3
1.6

SEE ATTACHED MEDIA

UNLESS OTHERWISE SPECIFIED	DRAWN	SIGNATURE	DATE	TITLE	ORDNANCE FACTORY TIRUCHIRAPPALLI
DIMENSIONS ARE IN MM PER ASME Y14.5M-1994	CHECKED			BASE STOP B	FOR: SHOCK ABSORBER ASSY
TOLERANCES	HOS/DDO			SIZE	
LINEAR ANGULAR	OFFICER/PRODN			B 2291A	
SEE NOTE 5 SEE NOTE 5	OFFICER/QC			CAGE CODE	
1ST ANGLE PROJECTION	OFFICER/DO			DWG NO	019895A-00
SURFACE TEXTURE IN MICRO M	PLM Control			SCALE	2/1
					SHEET 1 OF 1

WEIGHT: 0.01 KG

2

1

A

B

A

B