

**ASHOK LEYLAND LTD.**  
ENMORE MADRAS

This design is strictly private and confidential. It is the exclusive property of Ashok Leyland Ltd., and must not be used, copied or reproduced in part or whole without the Company's written permission.

**ASHOK** **FIRST ANGLE PROJECTION** 

SURFACE FINISH AS PER IS: 3073 (CLA VALUE)	
MICROINCHES	MICROMETRES
BELOW 8	BELOW 0.2
8-16	0.2-0.4
16-32	0.4-0.8
32-64	0.8-1.6
64-125	1.6-3.2
125-250	3.2-6.4

**VFJ**

PART NO. **F7195914** (A)

ALTERATIONS		EDM DATE	GRADE	SUFFIX	MICRO FILMED
SURFACE PROTECTION NOTES 1, 2, 3 ADDED VGL/GP		8/17 5-01-93	1	A	1/11/93 22/01/93

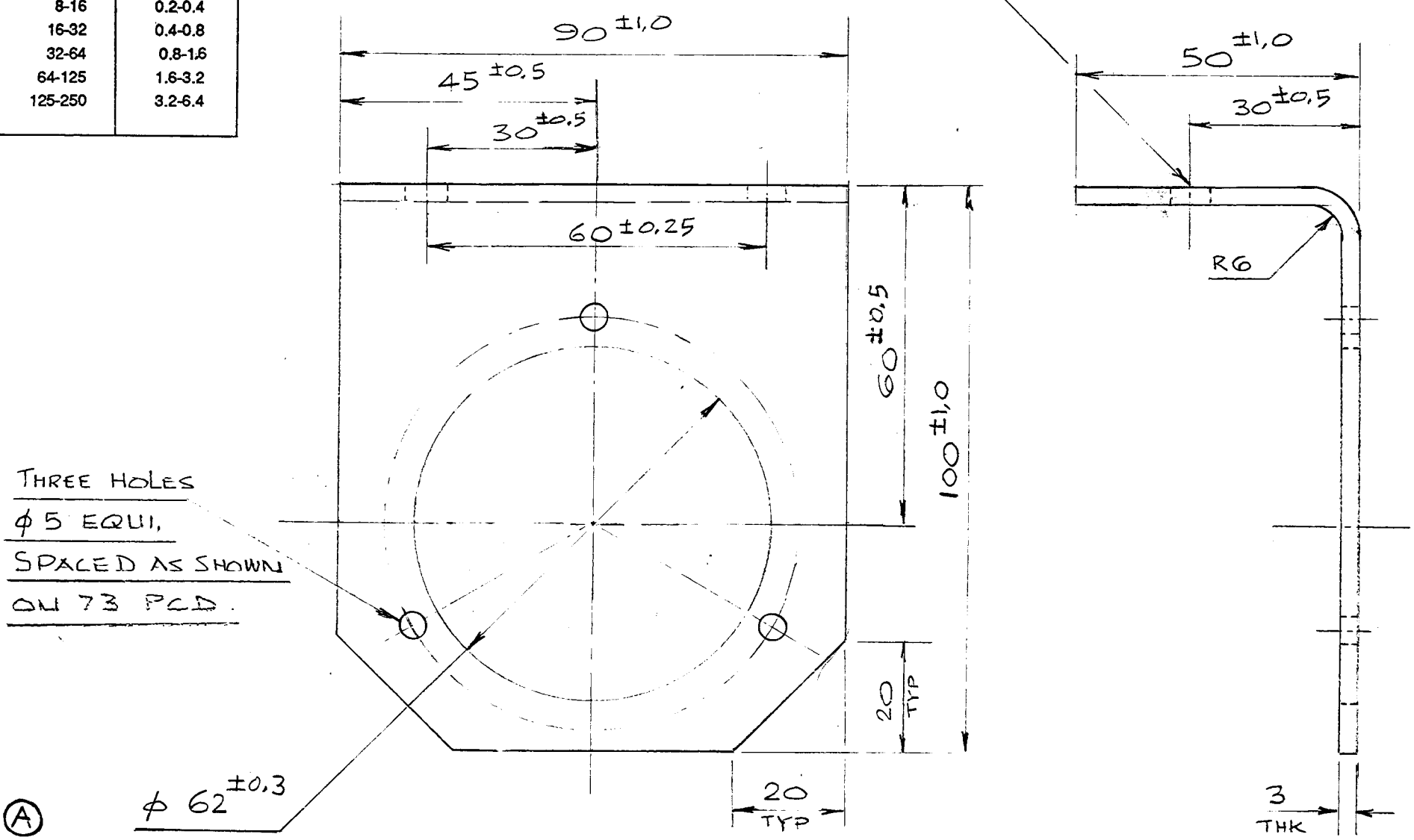

NOTE 1. AFTER PHOSPHATING AND PRIMER COATING, ALLOW THE SURFACE TO DRY.  
 2. ON DRY SURFACE APPLY SYNTHETIC ENAMEL OF STEEL GREY COLOUR CONFORMING TO IS 5 SHADE NO 698  
 3. TEST REQUIREMENTS OF THE STEEL GREY SYNTHETIC ENAMEL PAINT SHALL CONFORM TO IS 2932

SPECIAL INSTRUCTIONS / NOTE:  
 BEND TO PERPENDICULAR TO GRAIN FLOW

**UNLESS OTHERWISE SPECIFIED**  
 SURFACE PROTECTION: FABRICATED COMPONENTS TO BE PHOSPHATED TO CLASS 'C' AS PER IS: 3618 AND APPLIED IMMEDIATELY WITH RED OXIDE ZINC CHROMATE PRIMER TO IS: 2074. MACHINED SURFACE TO BE APPLIED WITH RUST PREVENTIVE OIL TO IS: 1154

MACHINING TOLERANCE FOR OPEN DIMENSIONS WILL BE AS PER IS: 2102									
DIMN.	OVER UPTO&INCLDG.	6	30	120	315	1000	2000	>4000	
TOLERANCE		±0.1	±0.2	±0.3	±0.5	±0.8	±1.2	±2	±3

SHARP EDGES TO BE REMOVED. DO NOT SCALE DRG. DIMENSIONS ARE IN MM. ANGULAR TOLCE. AS PER IS: 2102. METRIC SCREW THREADS SHALL CONFORM TO THE LIMITS AND TOLERANCES SPECIFIED IN THE CURRENT IS: 4218 CLASS 6g EXTERNAL OR 5H INTERNAL

S.L.No.	PART NO.	DESCRIPTION	SIZE	MATERIAL	QTY.
<b>BILL OF MATERIALS</b>					
REF. PT. NO.	ISSUED UNDER		MICRO FILMED		
SUPERSEDES	EDM/DIN	DATE	BY	THROU	
S/A. PT.NO.			DATE	1005914	
WEIGHT	ROUGH	FINISH	SUPPLIER'S DRAWING APPROVAL REQUIRED		
SCALE	1:1		APPROVAL NO. : -		
SPEC. NO.	A.L.B.		TESTING STD. : -		

STAGE	CHECKED	DATE	APPROVED	DATE	ALTERATION LEVEL
I					
II					
III					
DRAWN	DATE	KRN	RETRACED	CHECKED	
CHECKED	DATE	7/24/93	MED. APPROVAL	DATE	9/12/93
APPROVED	DATE	26/1/93	STDS APPROVAL	DATE	DQA 369

MATERIAL: STEEL TO IS: 1079 - 1988 Gr. 'C'  
 HEAT TREATMENT: -

REMARKS: REVERSE-BEEPER MOUNTING  
 DESCRIPTION: BRACKET. REV. BEEPER

PART NO. **F7195914** (A)  
 SHEET No. **ONE** OF **ONE**