

DRG. NO.-SK-6529/TE

D.A. NO.

SK- 6529/TE

Rz 20(✓)

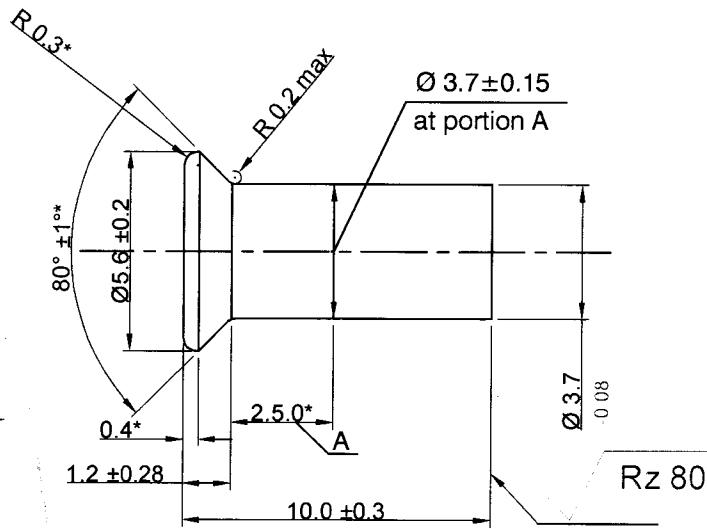

HSS/mm
13/10/23
.s

MATL:- Steel 35 GOST 1050-2013

NOTE:-

Weight:- 1.0g

1. * Dimensions to be ensured by tool.

2. Coating is Chem. Phos. accelerated chr.

Other Tech. data to be according to GOST 10304-80.

7.62X39mm AR-SAF

Rivet

DRAWN	TRACED	CHKD.
-------	--------	-------

A.VERMA

DATE

10-08-2023

APPROVED

JWM/DDO

SCALE

5 : 1

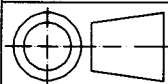

SMALL ARMS FACTORY
KANPUR

DRG.NO.

SK- 6529/TE

SHEET 1 OF 1