

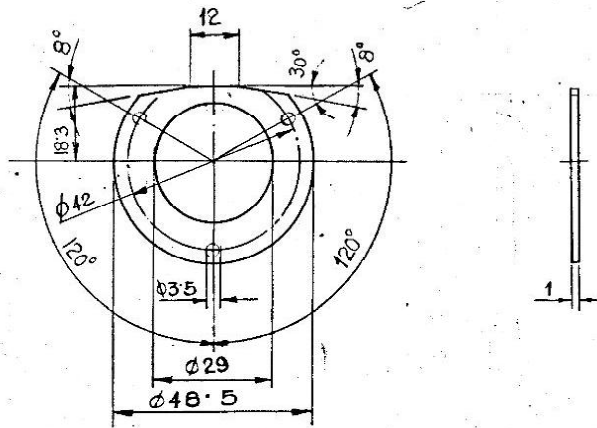

DRAWING PREPARED BY REVERSE ENGINEERING PROCESS, AS SUCH  
 SUITABLE NUMBER OF ADVANCE SAMPLES ARE TO BE TRIED OUT  
 BY FITMENT & FIRING BY CQA(SA) BEFORE BULK IS PRODUCED.

DRAWING CONVENTION CONFORM TO IS: 696.

TOLERANCES FOR UNTOLERANCED DIMENSIONS SEE MEDIUM IS: 2102.



MATERIAL:-  
 VULCANISED CHLOROPRENE RUBBER  
 COMPOUND CLASS C-5 TO IND/ME/884 (PROV.)

65P 11346

47

D.S. CAT. No. B310-252592

NO.	DATE	ZONE	DESCRIPTION	SIGNATURE	DATE	NAME	ASSEMBLY DRG. NO.	DESIGNER'S REF.
26679-SA	01.08.13		D.S. CAT. No. ADDED	<i>[Signature]</i>			5945-007666	CQA(SA) ICHAPUR
23651-SA	7-1-97		MATERIAL AMENDED	<i>[Signature]</i>		R.K.P.	MATERIAL, AS STATED	
23529-SA	17-10-96		MATL. AMENDED & PART NO. 12-30/617 WAS GROUP NO. 617/12-30	<i>[Signature]</i>			DIMENSIONS ARE IN MILLIMETRES	APPROVED. DT. 23-12-77 (NEG. PREPARED)
22141-SA	13-2-93		DRG. REVISED, RE-DRAWN & PROV. RE-SEALED	<i>[Signature]</i>		C.D.O.		DESIGNER'S REF. CISA-506/20
			PREVIOUS DC NOS 19935-SA, 19980-SA	<i>[Signature]</i>				PART. NO. 12-30/617
			AUTHY. DATE. ZONE BRIEF & RECORD					5310-252592

**GASKET**

SCALE: 1:1  
 SEALED: PROV. DC No. 19935-SA DT. 5-3-88

RING PROCESS, AS SUCH SUITABLE NUMBER OF ADVANCE SAMPLES ARE TO BE TRIED OUT BY FITMENT & FIRING BY CQA(SA) BEFORE BULK IS PRODUCED.

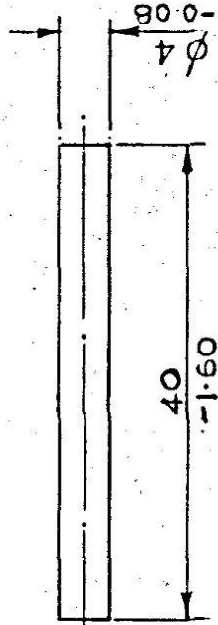

**MATERIAL: - BS:5216:75  
CODE 'NS' GD.I OR IS:4454 Pt.I:81 Gd.I**

**HARDNESS: - 280 - 320 HV.**

**PROTECTIVE FINISH: - PHOSPHATE TO SPECN. JSS:0465-01:1988 CLASS II. (ACCELERATED), OIL FINISH.**

65P 11347

48

D.S. CAT. No. 5330-020894

ASSY. DRG: - 5945-007666 (Q.A(SA) (CHAPIR

MATERIAL: - AS ABOVE  
DIMENSIONS ARE IN MILLIMETRES

APPROVED: DT: 19-8-77  
(NEG. PREPARED)

DESIGNER'S REF.  
G/3A 506/14  
PART NO.

**PIN STRAIGHT  
HEADLESS CATCH**

23428 -SA	8-8-96	MATERIAL AMENDED	DATE	NAME	SIG.
22938 SA	28-1-95	NOMEN. AMENDED D.S. CAT. NO. ADDED			
22141 -SA	13-2-93	DRG. REVISED, RE-DRAWN & PROV. RE-SEALED			
		PREVIOUS DC. No. 19931-SA, 20635-SA.			
		BRIEF RECORD			
		DATE			
		DGN.			
		DRN.			
		CHD.			
		TRD.			
		COMP.			
		AUTHY DATE ZONE			
		DRAWING CONVENTIONS CONFORM TO IS: 696.			
		TOLERANCES FOR UNTOLE ERANCED DIMENSIONS SEE 'MEDIUM' IS: 2102.			
		SCALE: - 2:1			
		SEALED: - PROV. DC			

dhm/c; D.O  
SCALE: - 2:1  
SEALED: - PROV. DC

DRAWING PREPARED BY REVERSE ENGINEERING PROCESS. AS SUCH SUITABLE NUMBER OF ADVANCE SAMPLES ARE TO BE TRIED OUT BY FITMENT & FIRING BY C.Q.A(SA) BEFORE BULK IS PRODUCED.

DRAWING CONVERSIONS CONFORM TO IS: 696  
TOLERANCE FOR UNTOLERANCED DIMENSIONS SEE 'MEDIUM' IS: 2102.

No. OF COILS - 5.5  
WOUND - - - R.H.

MATERIAL - STEEL DEF 106  
OR IS: 4454 PET: B1 Gd. 3

PROTECTIVE FINISH: PHOSPHATE TO SPECN.  
JSS 0465-01-1988 CLASS II (ACCELERATED)  
OIL FINISH.

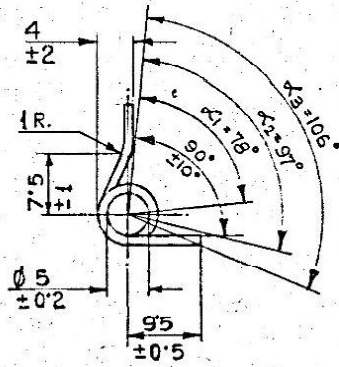
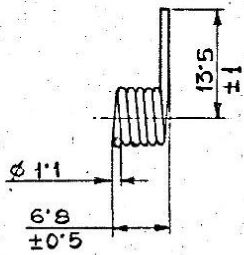
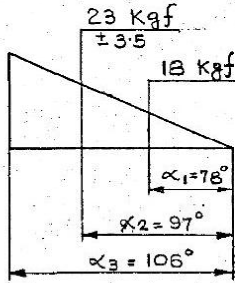

65P 11348

49

DS-CAT.NO.5360-006227

AUTH.	DATE	ZONE	BRIEF RECORD	SIG.	DGN.	DATE	NAME	ASSY: 5945-007666	C.R.A(SA) ICHAPUR
23428 - SA	8-8-96		MATERIAL AMENDED		DRN.			MATERIAL :- AS STATED	APPROVED. DT. 21.3.78 (NEG. PREPARED)
22837 - SA	27-1-95		NOMENCLATURE AMENDED AND DS. CAT. NO. ADDED		CHD.			DIMENSIONS ARE IN MILLIMETRES	
22158 - SA	3-3-93		NEG. RETRACED & DRG. PROV. RESEALED		TRD	13.12.89	By: [Signature]	SCALE: - 2:1	DESIGNER'S REF. C.I.SA. 506/15
			PREVIOUS D.C. Nos. 19935 - SA. & 20086 - SA.	COPY	COMP.			SEAL: -	PART NO. 607/12-27

DS CAT NO. 5360-006227

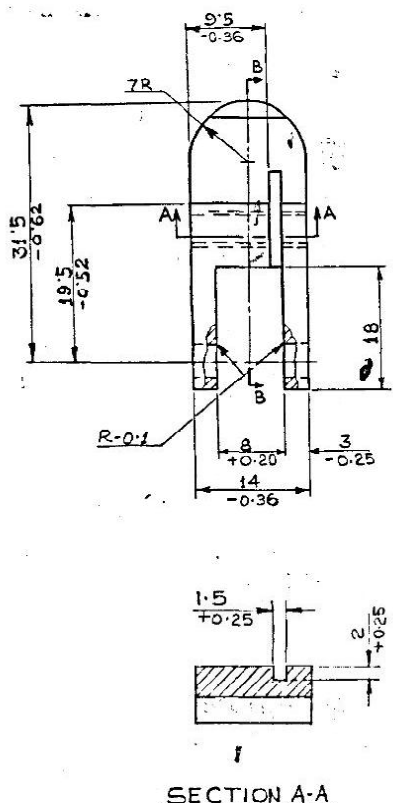

SECTION A-A

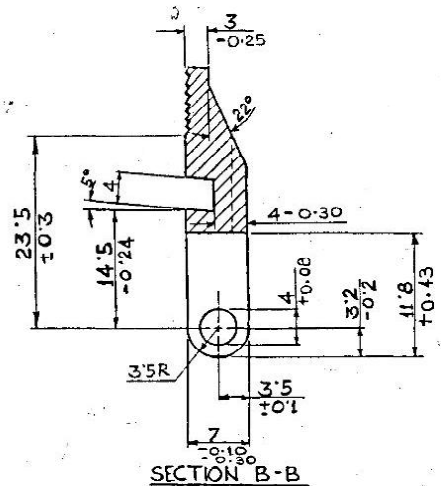

SECTION B-B

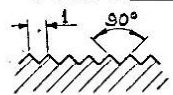

SCALE: 5:1

65P 11349

DRAWING PREPARED BY REVERSE ENGINEERING PROCESS, AS SUCH SUITABLE NUMBER OF ADVANCE SAMPLES ARE TO BE TRIED OUT BY FIT-MENT & FIRING BY CQA(SA) BEFORE BULK IS PRODUCED. DRAWING CONVENTIONS CONFORM TO IS: 696. TOLERANCES FOR UNTOLERANCED DIMENSIONS SEE MEDIAN IS: 2102.

NOTE :-

- i) MACROETCH TEST AND DETERMINATION OF INCLUSION CONTENT TO IS: 4163 ARE TO BE CARRIED OUT AS PER COLUMN 'C' OF CQA(SA) NOTE SHEET NO.1.
- ii) SELECTIONS OF SAMPLES ARE 2 NOS. UP TO 5 MT FROM BULK.

MATERIAL:

BS 970 PT. 5 : 72% GD 070 A72 OR 070 A7B

HARDNESS:-

360-444 HV.

PROTECTIVE FINISH:-

PHOSPHATE TO SPECN. JSS: 0465-01-1988 CLASS II (ACCELERATED), OIL FINISH.

50

NO.	REV.	DATE	ZONE	MATL. & HARDNESS AMENDED	SIG.
23405	- SA	24.7.96.			<i>[Signature]</i>
22877	- SA	20.2.95		ASSEMBLY NO. ADDED	<i>[Signature]</i>
22600	- SA	15.7.94		MATL. AMENDED AND NOTE ADDED	<i>[Signature]</i>
22340	- SA	2-12-93		NOMENCLATURE AMENDED AND D.S.CAT. No. ADDED.	<i>[Signature]</i>
22141	- SA	13.2.93.		DRG. REVISED, REDRAWN & PROV. RESEALED.	<i>[Signature]</i>
				PREV. D.C. NOS 19935-SA, 20492-SA.	<i>[Signature]</i>

D.S.CAT.No.1005-007583

DATE	NAME	ASSY.	CQA(SA)
		CISA-5945-007666	ICHAPUR
		MATERIAL:- AS STATED.	
		DIMENSIONS ARE IN MILLIMETRES	
		<p><b>CATCH SAFETY FIRE</b></p>	
		APPROVED:- DT 12/97 (NEG. PREPARED)	
		DESIGNER'S REF. CISA-506/15	
		PART NO. S07/12-25	

D.S.CAT.No.1005-007583.



SUITABLE NUMBER OF ADVANCE SAMPLES ARE TO BE TRIED OUT BY FITMENT & FIRING BY CGA(SA) BEFORE BULK IS PRODUCED.

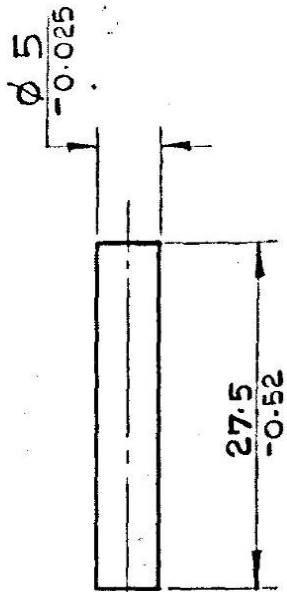

**MATERIALS:** BS:5216:75 CODE 'NS'  
G.I. OR IS:4454 P.I.1:81 Gd. I.

**HARDNESS:-**  
400 - 450 HV.

**PROTECTIVE FINISH:-**

PHOSPHATE TO SPECN JSS 0435-01:1999  
CLASS II (ACCELERATED) OIL FINISH.

65P 11351

26679	01.08.13	D.S.CAT. No. ADDED.	350
23394	18.7.94	MATL. AMENDED	350
22827	24.7.95	NOMEN. AMENDED	350
22529	6.5.94	NOMENCLATURE AND DESIGNER'S REF. NO. AMENDED.	350
22141	13.2.93	DRG. REVISED, REDRAWN & PROV. RESEALED.	MAT.
		PREVIOUS DC No. 19931-SA, 20491-SA.	COPY.

AUTHY.	DATE	ZONE	BRIEF RECORD	SIG.
DRAWING CONVENTIONS CONFORM TO IS: 696.				
TOLERANCES FOR UNTOLERANCED DIMENSIONS SEE MEDIUM IS: 2102.				
DGN	DATE	NAME		
DRN				
CHD				
TRD				
COMP				

D.S. CAT. No. 5315-052.604

Assy. No. 5945-007666

CGA(SA) ICHAPUR

MATERIAL:- AS STATED  
DIMENSIONS ARE IN MILLIMETRE



LARGE RELEASING  
APPROVED DT: 19-8-77  
(NEG. PREPARED)

DRAWING PREPARED BY REVERSE ENGINEERING PROCESS, AS SUCH SUITABLE NUMBER OF ADVANCE SAMPLES ARE TO BE TRIED OUT BY FITMENT & FIRING BY CQA(SA) BEFORE BULK IS PRODUCED.

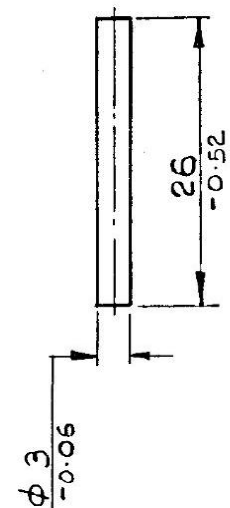

MATERIAL: ISI: 4454 PT. 1: 01 Gd. 1

HARDNESS: 400 - 450 HV.

PROTECTIVE FINISH: PHOSPHATE TO SPEC. JSS. 0465-01-1988

CLASS II (ACCELERATED) OIL FINISH.

23304 - SA	18-79K	MATL. AMENDED	DATE	65P 11352
22837 SA	27-1-95	NOMENCLATURE AMENDED & DS. CAT. NO. ADDED	DATE	
22529 - SA	6-5-94	NOMENCLATURE AND DESIGNER'S REF. NO. AMENDED	DATE	
22141 - SA	13-2-93	DRG. REVISED, RE-DRAWN & PROV. RE-SEALED.	DATE	
		PREVIOUS DC	DATE	
		BRIEF RECORD	DATE	
		DATE	NAME	
		DGN.		
		DRN.		
		CHD.		
		TRD.		
		CMR.		
		SCALE: - 2:1		
		SEALED: - PROVDC		
		19935-SA.DT.5-3-88		
		DRAWING CONVENTIONS CONFORM TO IS: 696		
		TOLERANCES FOR UNTOLEANCED DIMENSIONS SEE MEDIUM IS: 2102.		
		APPROVED: DT. 18-8-77		
		(NEG. PREPARED)		
		DESIGNER'S REF. CISA-506/5		
		PART No. 607 12-21		

65P 11352

DS. CAT. NO. 5315-00771

ASSY. DRG. 5945-007666

CQA(SA) ICHAPUR

PIN STRAIGHT HEADLESS

SPRING LEVER LARGE





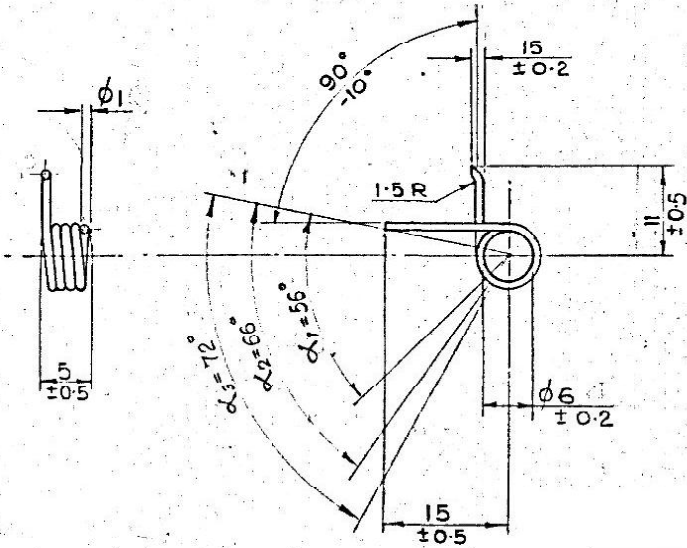
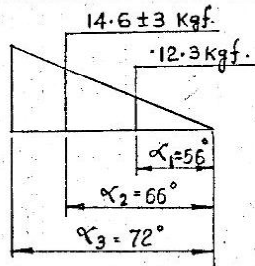

65P 11354

DRAWING CONVENTIONS CONFORM TO IS: 6955  
 TOLERANCE FOR UNTOLERANCED  
 DIMENSIONS SEE "MEDIUM" IS: 2102

DRAWING PREPARED BY REVERSE ENGINEERING  
 PROCESS AS SUCH SUITABLE NUMBER OF  
 ADVANCE SAMPLES ARE TO BE TRIED OUT  
 BY FITMENT & FIRING BY CQA(SA) BEFORE  
 BULK IS PRODUCED.

No. OF TURNS = 4

WOUND = R-H

SPRING IS TO BE TESTED WITH CONTINUOUS  
 LOAD AT  $\alpha_3$  DURING 24 HOURS.

MATERIAL :-  
 BS 5216:75 GRADE 400R STEEL, DEF. 106

PROTECTIVE FINISH :-  
 PHOSPHATE TO SPECN. JSS: 0465-01388  
 CLASS II (ACCELERATED), OIL FINISH.

DS. CAT. NO. 5360-006231

AUTHY	DATE	ZONE	BRIEF RECORD	SIG.	DATE	NAME	ASSY. #	CQA(SA)
					DGN		5945-007666	CQA(SA) CHAPUR
					DRN	14.10.93	MATERIAL :- AS STATED	
					CHK		DIMENSIONS ARE IN MM.	APPROVED: 21.8.76
					TRD		SPRING HELICAL	(NEG. PREPARED)
					COMP		TORSION LEVER	DESIGNER'S SEAL
					ST. COL.		CONTROL HAND	CISA: 506/8
					MAJ.	SCALE: 2:1	(LARGE)	PART NO.
					COPY	SEALED: - PROV.		607/12-80
					SIG.	D.C. (I) 19935-SA		
						DT. 2.3.86		

22349-  
SA 10.12.93  
MATERIAL AMENDED.  
22295-  
SA 16.10.93  
NOMENCLATURE AMENDED  
& DS. CAT. No. ADDED  
22158-  
SA 3.3.93  
NEG. RETRACED AND  
DRG. PROV. RE-SEALED  
PREVIOUS D.C. (I) NOS.  
19931-SA & 20513-  
SA.

11/01/00  
SCALE: 2:1  
SEALED: - PROV.  
D.C. (I) 19935-SA  
DT. 2.3.86

APPROVED: 21.8.76  
(NEG. PREPARED)  
DESIGNER'S SEAL  
CISA: 506/8  
PART NO.  
607/12-80









ADVANCE ORDER TO BE MADE BY CQA(SA), BEFORE  
 BY FITMENT & FIRING BY CQA(SA), BEFORE  
 BULK IS PRODUCED.

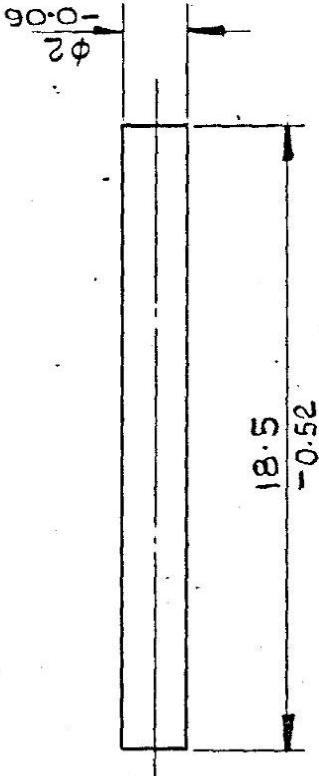

MATERIAL:-

IS:4454 PI-1:81-GD-1.

PROTECTIVE FINISH:-

PHOSPHATE TO SPECN. JSS 0465 -  
01:1988 CLASS II, OIL FINISH.

65P 11359

26679 SA	01.08.13	D.S. CAT. No. ADDED.	60
23513 -SA	4-10-96	MATERIAL AMENDED	
22143 -SA	13-2-93	ORG. REVISED RE-DRUMMED AND PROV. RE-SEALED.	
		PREVIOUS DC (U) No. 19935-SA, 20003-SA. COPY	
AUTHY.	DATE	ZONE	BRIEF RECORD
			SIG
DRAWING CONVENTIONS CONFORM TO IS: 696		DATE NAME	
TOLERANCES FOR UNTOLE RANCED DIMENSION		DGN	Sketch
SEE MEDIUM IS 2102.		DRN	Sketch
		CHD	Sketch
		TRD	
		LOM	

D.S. CAT. No: 5315-052605

ASSY. DRG. 5945-007666

CQA(SA) ICHAPUR



MATERIAL:- AS STATED

DIMENSIONS ARE IN MILLIMETRES

SIFVE REST