

PART NO. **15M347** FOR EXPLANATION SEE DD NOTE SHEET NO. 3
 THIRD ANGLE PROJECTION. DIMENSIONS ARE IN MILLIMETRES

NOTE :-

WHERE TOLERANCES ARE NOT SHOWN
 DIMENSIONS IN WHOLE NUMBER OR WITH
 ONE DECIMAL PLACE ± 0.27 mm.
 DIMENSIONS WITH TWO DECIMAL PLACES ± 0.13 mm.

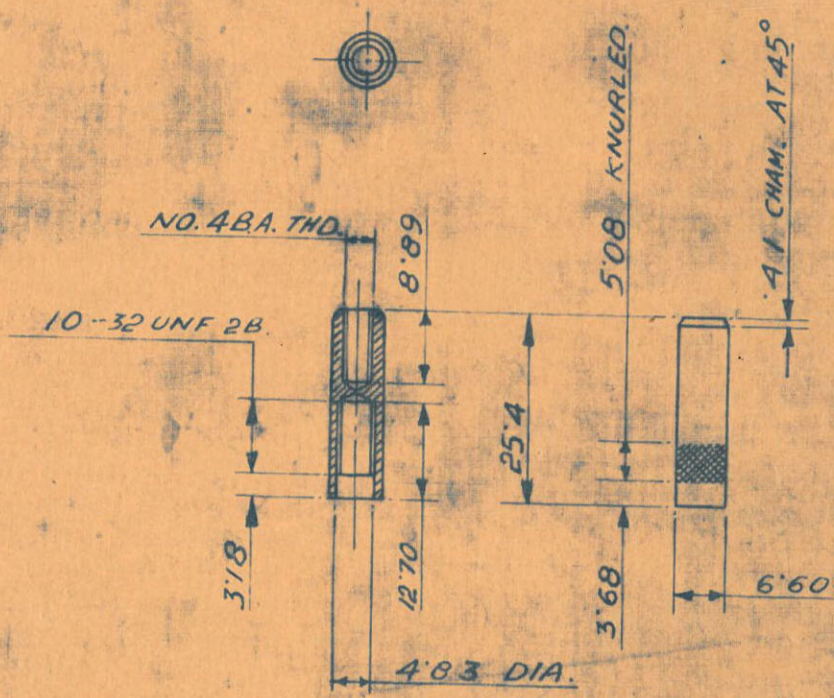

METRIC

ASSY. DRG. DS CAT. NO. 1005-000332
 INSP. INSTRNS.

| | | | |
|-------|---------|--------------------|--------------------|
| DRAWN | CHECKED | TRACED | TRN. CHD. |
| | | <i>[Signature]</i> | <i>[Signature]</i> |

APPROVED
 DSS
 SIG. *[Signature]*

DATE: 27.6.67
 DESIGNER'S REF. *[Signature]* / C.D.O.

CISA/171

DS CAT NO.
 1005-005474

CISA. ICHAPUR

| DATE | AUTHY. | ZONE | NATURE | SIG. |
|----------|----------|------|------------------------------------|----------------------------|
| 16.9.92 | 21966-SA | | MATERIAL AMENDED | <i>[Signature]</i> MAJ. |
| 20.11.76 | 14905-SA | | PART NO. DELETED & DSCAT NO. ADDED | DSS |
| 15.5.74 | 12021-SA | | DRAWING SEALED | <i>[Signature]</i> DSS |

AMENDMENTS

SEALED :- DC(I) 12021-SA DT. 15.5.74
 MATERIAL :- BRASS BSS 2874-1986 CZ-121 PB-3
 PROTECTIVE FINISH :- AS STATED
 ESTIMATED WEIGHT :-
 SCALE :- 1/1

STEM