

DRAWING CONVENTIONS CONFORM TO IS: 696.

MATERIAL:-
STEEL 40X GOST 4543-71

MATL. FOR INDIA:-
IS 5517-1993 DESIGN 400C4 OR DESIGN 42 C4 M02 LRS-63mm

- BS 970 P11H 33 GR. 530 M 40 CONDITION T
- BS 970 P11H 33 GR 709 M 40 CONDITION W
- BS 970 P11H 33 GR 708 M 40 CONDITION X

SURFACE FINISH :-
AS PER IS: 3073-1967
WHERE NOT SPECIFIED SHOULD BE 'A'

1. ALTERNATE MATERIAL - STEEL 40X GOST 3-98-80.

2. HARDENING :- 39-46 HRC

3. SHARP EDGES SHOULD BE BLUNTED TO R=0.2mm.

4. ALLOWED TOLERANCE ON CONTOUR'S 'AB6' AND '2C' IS ± 0.25 mm.

5. COATING :- CHEMICAL PHOSPHATING, HASTENED OIL FINISHED, COATING/PROTECTIVE FINISH FOR INDIA :-

PHOSPHATE TO SPEC. ISS. 0465-01/1988 CLASS-II, OIL FINISH.

6. STAMP 'K' (DIMENSIONAL ACCEPTANCE) AND 'N' (HARDNESS CORRECTNESS) IN COMPLIANCE WITH GINITY.

7. STAMP C IDENTIFICATION MARK OF SELECTIVE SIZE WITH TYPE No-3 GOST 2930-62

8. REMAINING TECHNICAL REQUIREMENTS ARE AS PER GINITY SPECIFICATIONS.

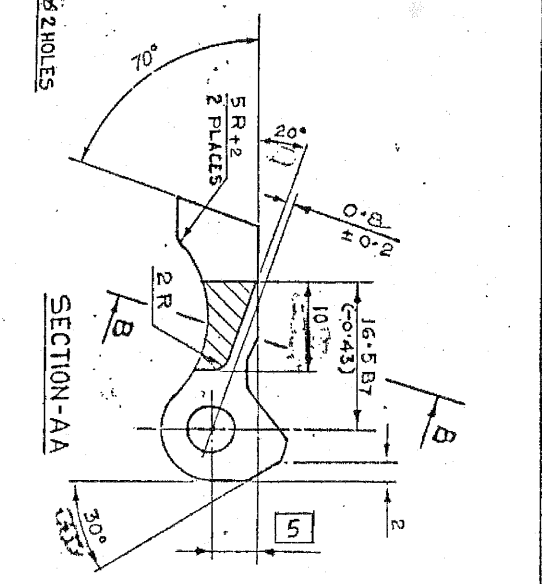
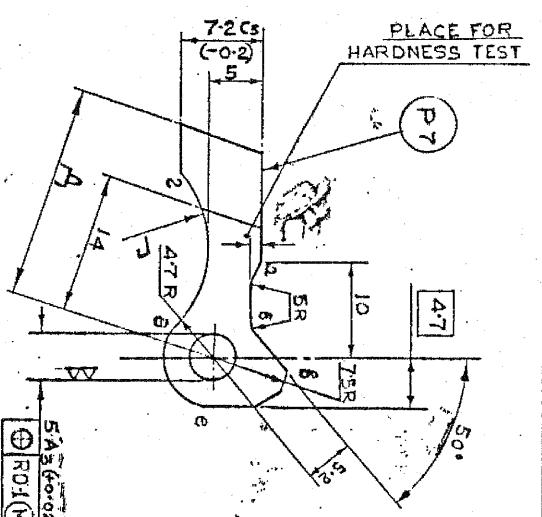

DIMENSION	22.5 C5	24.5 C6
A	(-0.25)	(-0.25)
F	9R	11R
SELECTIVITY GROUP	1	2

SECTION B-B

UN CONTROLLED COPY
CERTIFIED CORRECT COPY OF APPROVED DRAWINGS AT THIS DATE

DESIGN & DRAWING OFFICE
MATERIALS FACTORY, THIRUPPALLI-620 016.

A 6026

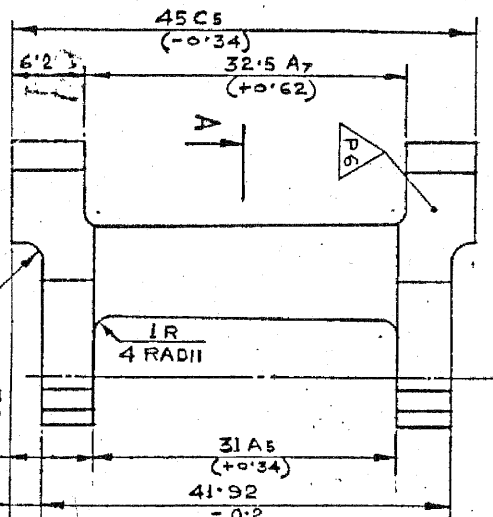

NOTE:-
ACCEPTANCE STANDARDS FOR MACRO ETCHES AND MICROSCOPIC DETERMINATION OF NON METALLIC INCLUSIONS FOR STEEL:-
UMACRO ETCH TEST AS PER ASTM E-381 WITH ACCEPTANCE STANDARD AS G.R. 252
UMMIR TEST AS PER IS: 4163-82

DESIGN NO.	DATE	ZONE	BRIEF RECORD	SIG.	DATE	NAME
2099/88	13/12/86					
21952-6-9-92						
2133-4-6-8-91	15/5-6					
21118-5-14-2-91						
20990-14-11-90						
20702-31-3-93						

DESIGN NO.	DATE	ZONE	BRIEF RECORD	SIG.	DATE	NAME
24962-7-3-						
24962-7-3-						
22066-28-1-						

DESIGN NO.	DATE	ZONE	BRIEF RECORD	SIG.	DATE	NAME
3040-003453						
3040-003453						