

675-05-145

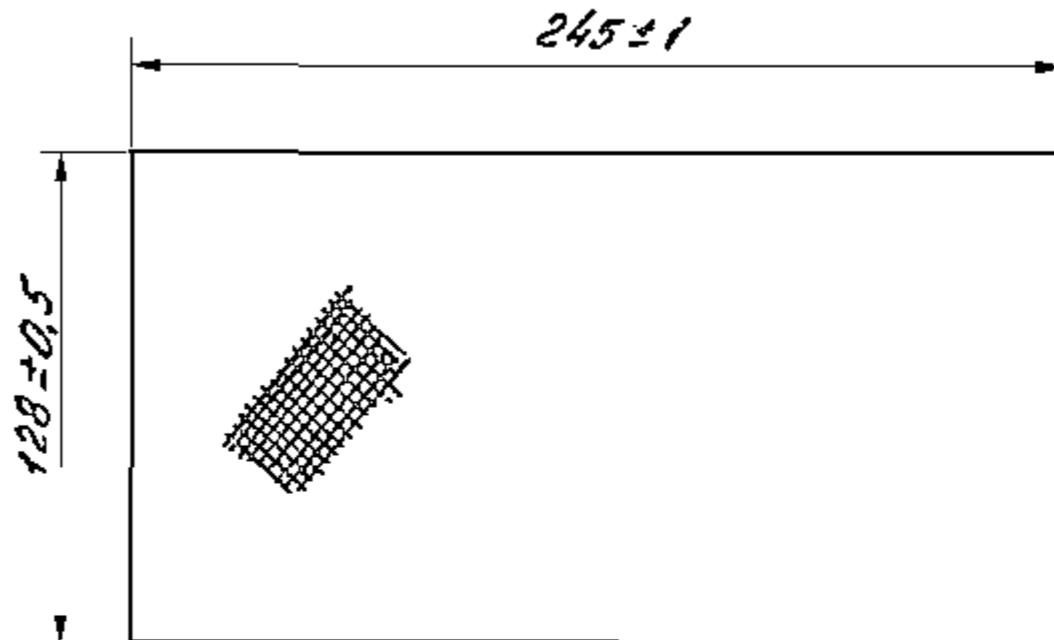

**CHEMICAL COMPOSITION OF WIRE**  
(GOST 15527-70 MARK 180)

COPPER — 79.81%

ZINC — Rem.

ADMIX:

(i) LEAD — 0.03

(ii) IRON — 0.10

(iii) ANTIMONY — 0.005

(iv) BISMUTH — 0.002

(v) PHOSPHORUS — 0.01

ADMIX SHOULD NOT EXCEED 0.3%

NOTE: -

All Dimensions are in mm.

NEAREST EQVT MATERIAL

SEMI COPPER ZINC ALLOY N-008  
GOST 6613-73.

DRGL MATERIAL

ALL SHARP EDGES & CORNERS TO BE ROUNDED OFF

DRG. NOT TO BE SCALED

SCALE: - 1:2

DATE :- 13-11-2000

DRN.

TCD.

CHD.

APD.

WT :-(Kg)

0.01

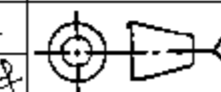

GAUGE (MESH)

CONTROLLERATE OF QUALITY ASSURANCE  
(INFANTRY COMBAT VEHICLES)

|                                      |       |  |
|--------------------------------------|-------|--|
| 00830-ICV<br>N.A. Bely<br>13.11.2000 | Amn   | DRAWING REVISED & RETRACED.  |
| 00132-ICV<br>25-9-83                 | -     | NEW DRAWING PREPARED BASED ON MASTER PRINT RECEIVED FROM COLLABORATION (D-405/ICV) |
| DECISION & DATE                      | ISSUE | NATURE   |
| AMNDMENTS                            |       |  |

ALL THREADS TO CONFORM TO SPECIFICATION.

TOLERANCE ON DIMENSIONS UNLESS OTHERWISE SPECIFIED

STAMP OR ETCH, PART NO. MANUFACTURER'S NAME & YEAR OF MFR.

USED ON: -

675-05-145

PART NO

675-05-146

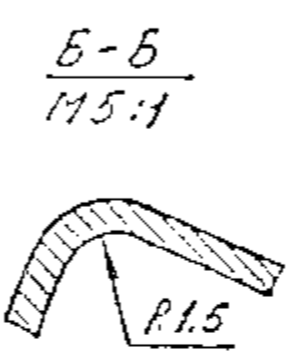
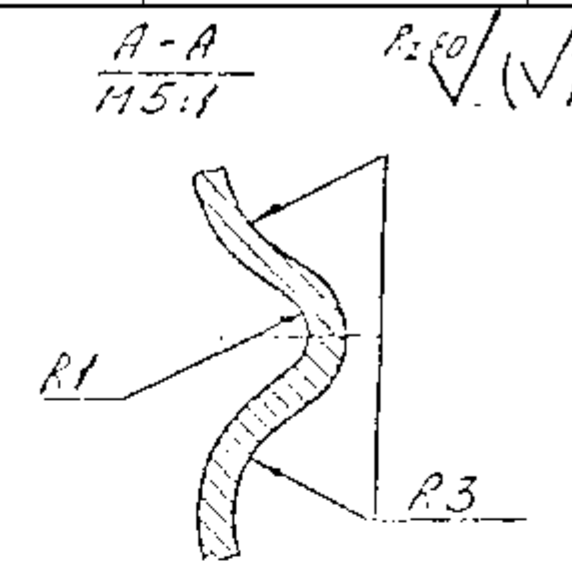
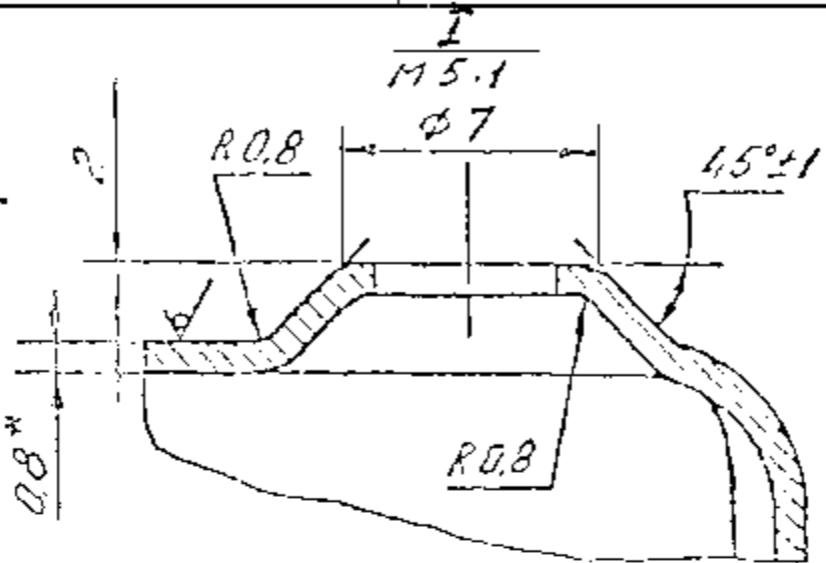
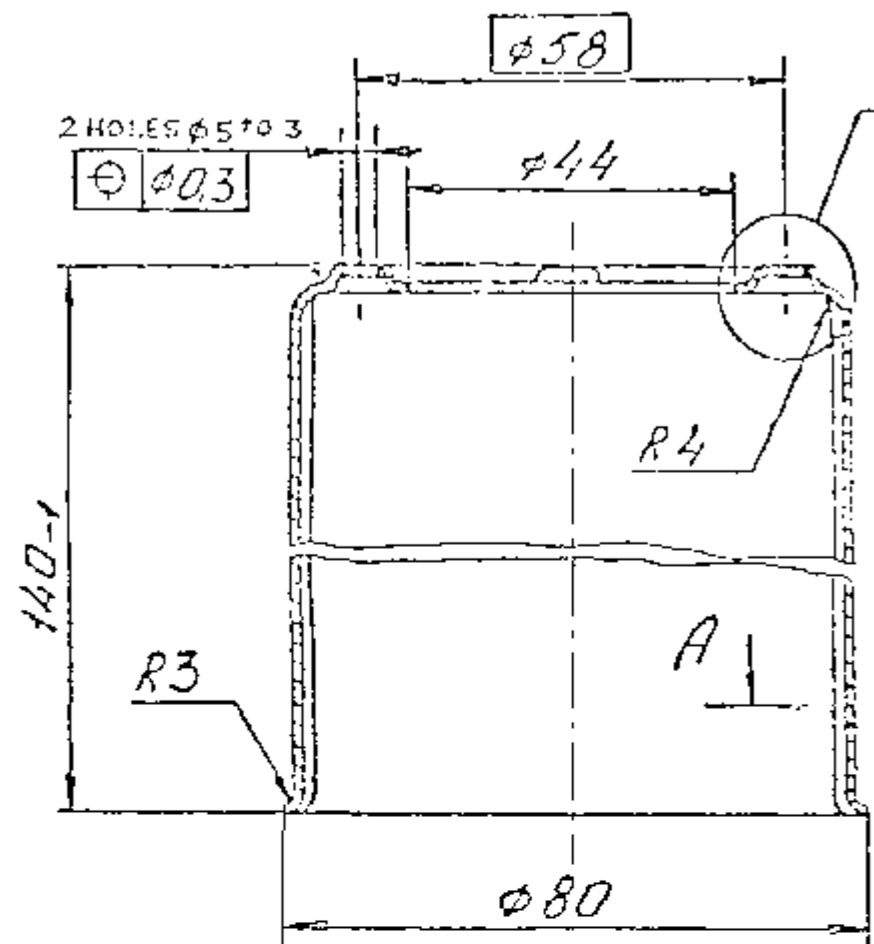

- 1 UNSPECIFIED LIMIT DEVIATIONS OF DIMENSION to 5mm
- 2 # DIMENSION IS GIVEN FOR REFERENCE
- Ⓐ EQ MATERIAL CU ZN 37 TO IS 4-10-77 '0' Condition

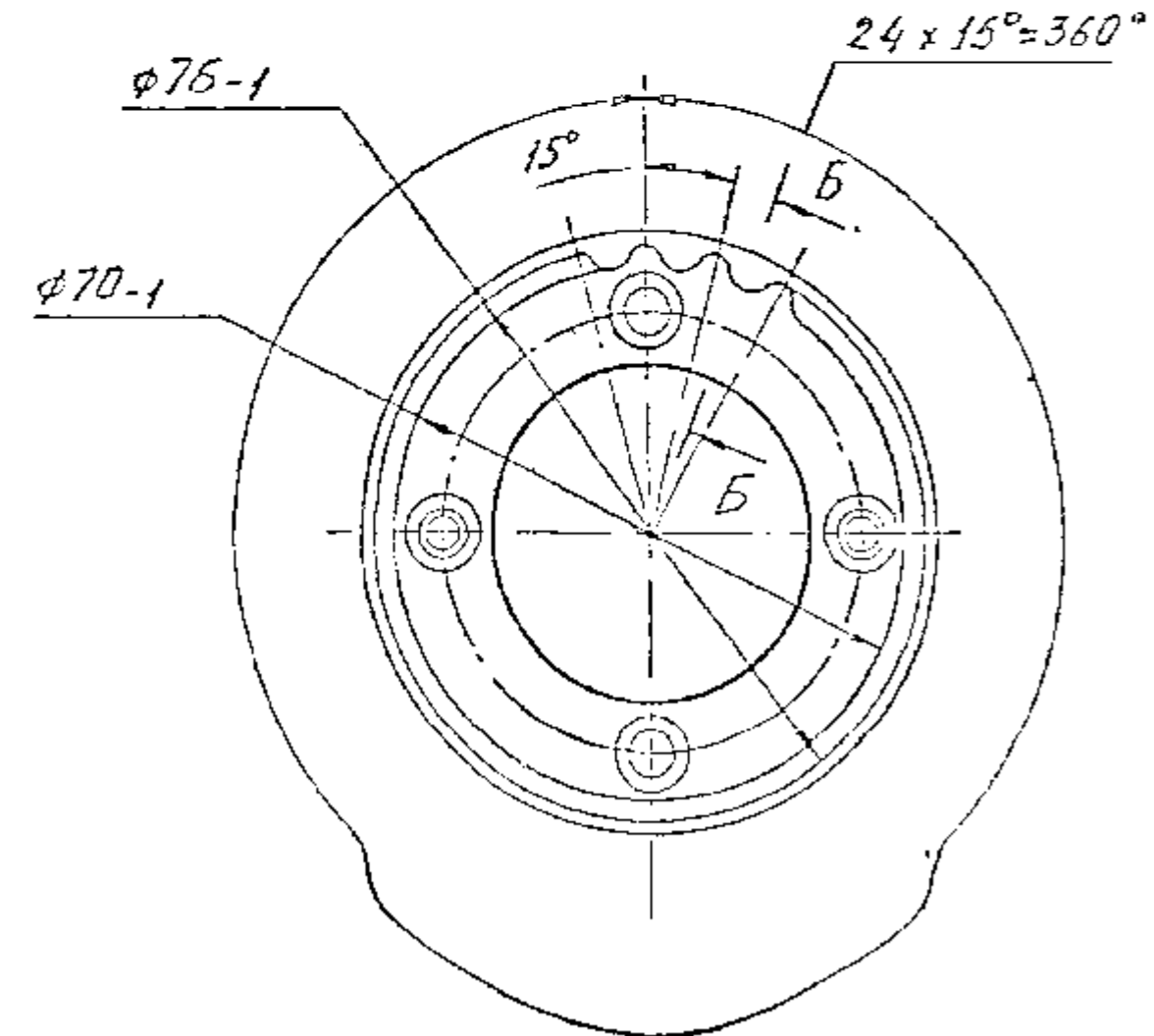

|                                   |  |
|-----------------------------------|--|
| DRESSING<br>22-09-83<br>00102-ICV | EQ. MATERIAL ADDED.  |
| 25-03-85                          | NEW DRAWING PREPARED BASED ON MASTER PRINT RECEIVED FROM COLLABORATORS (D-105/ICV) |
| DCI/NO. & DATE                    | ISSUE AMENDMENTS   |

|  |                                    |
|--|------------------------------------|
| APPROVED<br><i>[Signature]</i>           | 675-05-146                         |
| CHECKED<br><i>[Signature]</i>            | WEIGHT SCALE<br>0.304 1:1          |
| CONTROLLERATE OF QUALITY ASSURANCE (ICV) | SHEET 8 ПРМ 0.8 А63<br>GOST 931-78 |
|  | SHT SHTS                           |

A  
B  
C  
D  
E  
F

A  
B  
C  
D  
E  
F

1 2 3 4 5 6 7 8 A3

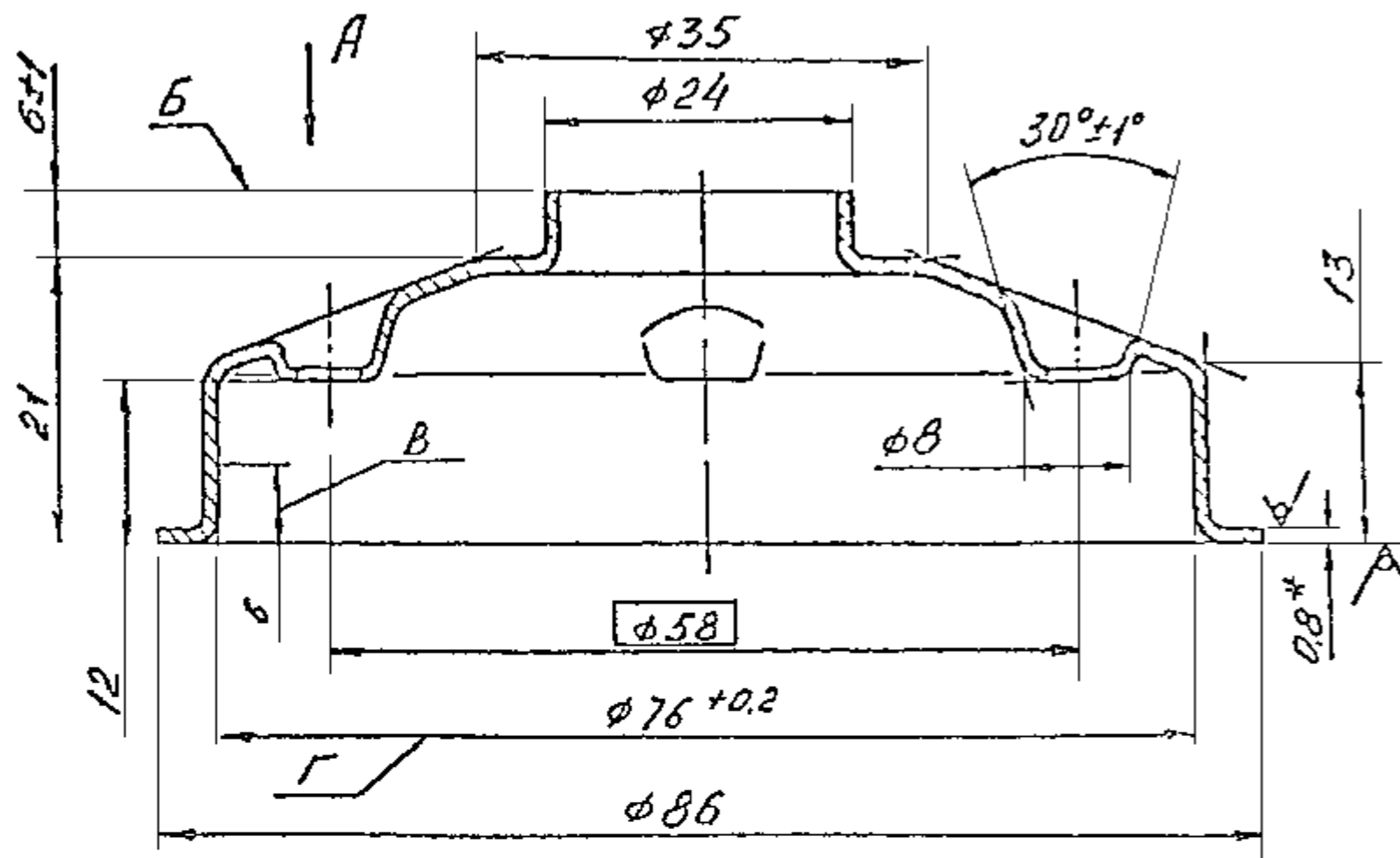

**TECHNICAL CONDITIONS**

- 1 UNSPECIFIED LIMIT DEVIATIONS OF DIMENSIONS ± 0.5mm
- 2 UNSPECIFIED RADIUS 0.8mm
- 3 \* DIMENSION IS GIVEN FOR REFERENCE.
- 4 FURTURES HAVING DEPTH NOT MORE THAN 1/3mm ON SURFACE ARE ALLOWED.
- 5 CHECK THE DIMENSION P ON SECTION B.
- Ⓐ EQ MATERIAL: CU ZN 37 TO IS: 4-10-77 '0' Condition

VIEW-A  
1:1

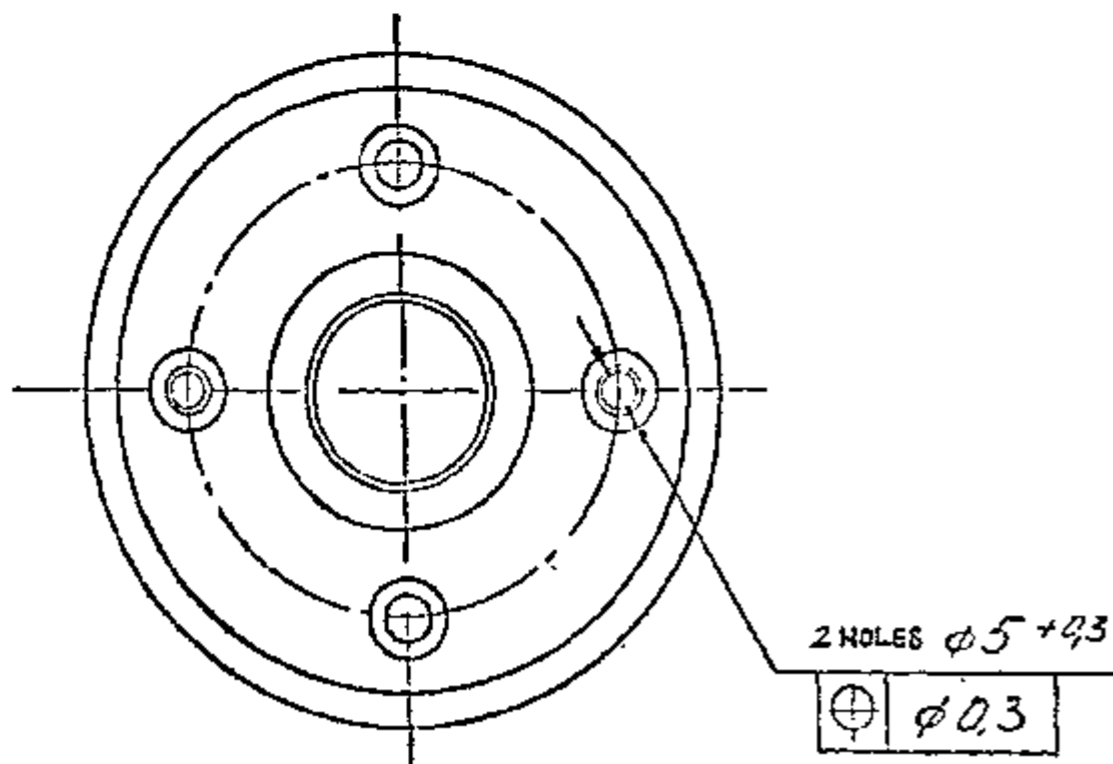

|  |       |  |
|--|-------|--|
| 00733-ICV<br>V. P. 22-09-99<br>00132-ICV | Ⓐ     | EQ. MATERIAL ADDED.  |
| 25-09-89                                 |       | NEW DRAWING PREPARED BASED ON MASTER PRINT RECEIVED FROM COLLABORATORS (D-406/ICV) |
| DC(I) No. & DATE                         | ISSUE | AMENDMENTS   |

|   |                    |            |       |
|---|--------------------|------------|-------|
| APPROVED  | <i>[Signature]</i> | 675-05-147 |       |
| CHECKED   | <i>[Signature]</i> |            |       |
| CONTROLLERATE<br>OF<br>QUALITY ASSURANCE<br>(ICV) | COVER              | WEIGHT     | SCALE |
|   |                    | 0.055      | 2:1   |
|   |                    | SHT        | SHTS  |
| SHEET APPROX 0.8 A63<br>GOST 931-78               |                    |            |       |

675-05-148

R280/√(√)

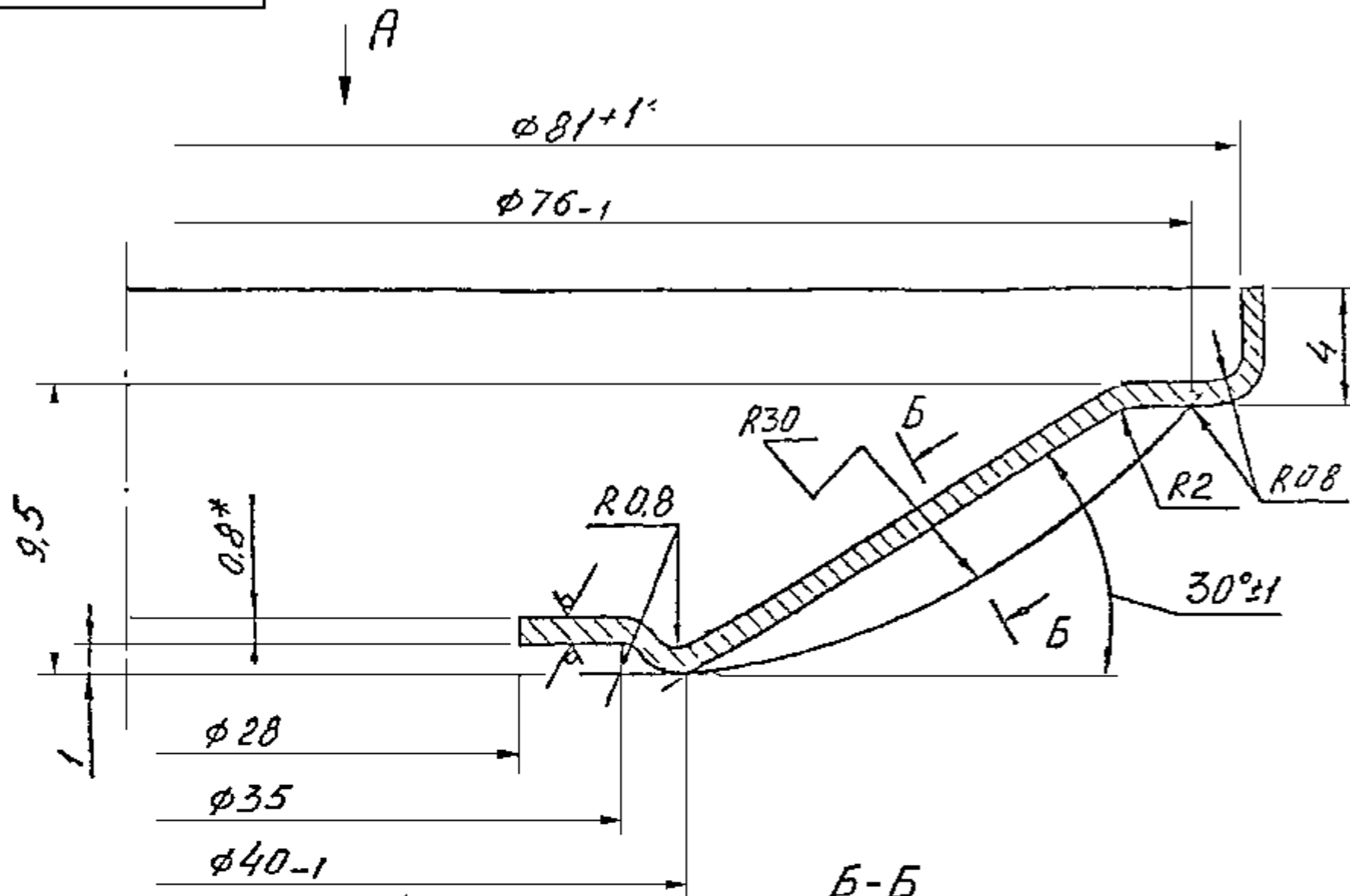

TECHNICAL CONDITIONS

1. UNSPECIFIED LIMIT DEVIATIONS OF DIMENSIONS ± 0.5 mm.
2. \*DIMENSION IS GIVEN FOR REFERENCE.
- Ⓐ EQ. MATERIAL: CU ZN 37 TO IS: 4-10-77 (0) Condition.

VIEW A  
M1:1

B-B

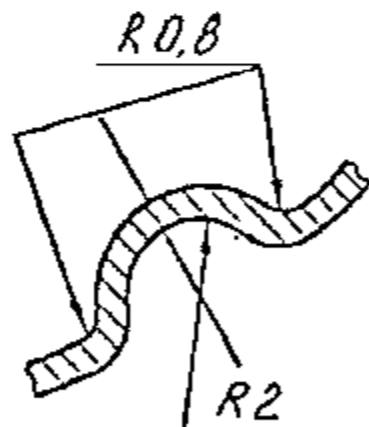
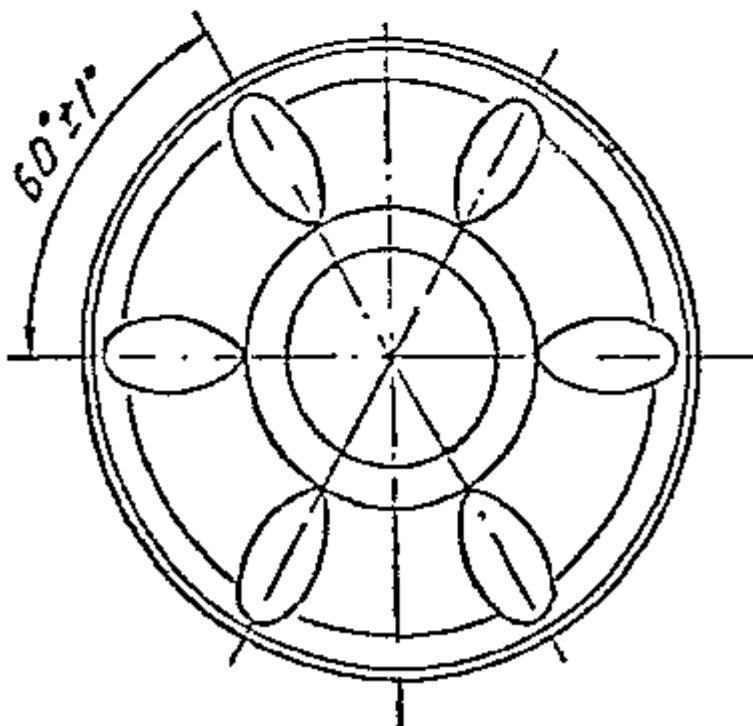

|   |         |  |
|---|---------|--|
| 00733-ICV<br>V. Kozlov<br>22-09-99<br>00152-ICV | Ⓐ<br>Cw | EQ. MATERIAL ADDED.  |
| 25-09-99  |         | NEW DRAWING PREPARED BASED ON MASTER PRINT RECEIVED FROM COLLABORATORS (D-406/ICV) |
| DC(1) No. & DATE                                | ISSUE   | AMENDMENTS   |

|  |                            |            |       |
|--|----------------------------|------------|-------|
| APPROVED                                 | <i>[Signature]</i> G. YASU | 675-05-148 |       |
| CHECKED                                  | <i>[Signature]</i>         |            |       |
| CONTROLLERATE OF QUALITY ASSURANCE (ICV) |                            | WEIGHT     | SCALE |
|  |                            | 0.042      | 5:1   |
| SHEET 0.8 / 63<br>GOST 931-78            |                            | SHT        | SHTS  |
|  |                            |            |       |

BOTTOM

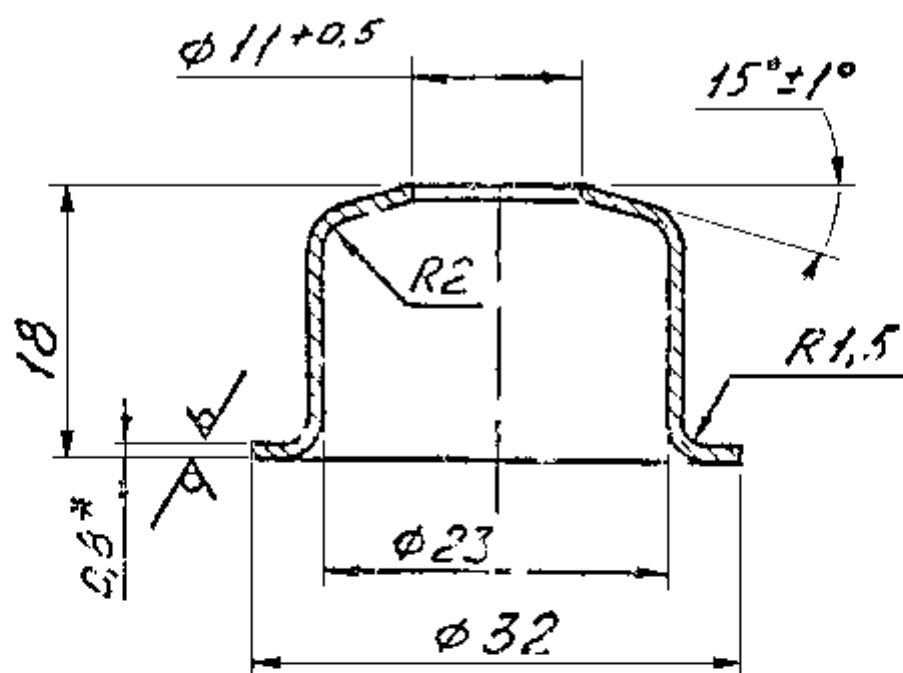

1. UNSPECIFIED LIMIT DEVIATIONS OF DIMENSIONS  $\pm 0.5$  mm.
2. \* DIMENSION IS GIVEN FOR REFERENCE.

(A) EQ. MATERIAL: CU Zn 37 TO IS: 410-77 'O' CONDITION.

|                                     |             |  |
|-------------------------------------|-------------|--|
| 00733-ICV<br>V. Romanov<br>22-09-89 | (A)<br>Cv-r | EQ. MATERIAL ADDED.  |
| 00132-ICV<br>K<br>25-09-89          |             | NEW DRAWING PREPARED BASED ON MASTER PRINT RECEIVED FROM COLLABORATORS (D-406/ICV) |
| DC(I) No. & DATE                    | ISSUE       | AMENDMENTS   |

APPROVED

675-05-149

CHECKED

WEIGHT

SCALE

CONTROLLERATE  
OF  
QUALITY ASSURANCE  
(ICV)

CAP

0.02

2:1

SHT

SHTS

SHEET 2/1 PPHM 0.8 1/63  
GOST 931-78





675-05-Sb155Sb

**TECHNICAL CONDITIONS**

1. SOLDER ПРБ КР 5 ПОСЫ 30-2 ГОСТ 21931-76
2. PARTS BEFORE ASSEMBLY ARE WASHED IN 20% Na<sub>2</sub>CO<sub>3</sub> SOLUTION AT (50<sup>+10</sup>)°C FOR (20<sup>±5</sup>) MIN. AND SUBSEQUENTLY WITH WATER AT (60<sup>+10</sup>)°C
3. WASH THE UNIT WITH COLD WATER FOR (5<sup>+2</sup>) MIN DRY AT (100<sup>+10</sup>)°C FOR (20<sup>+5</sup>) MIN.

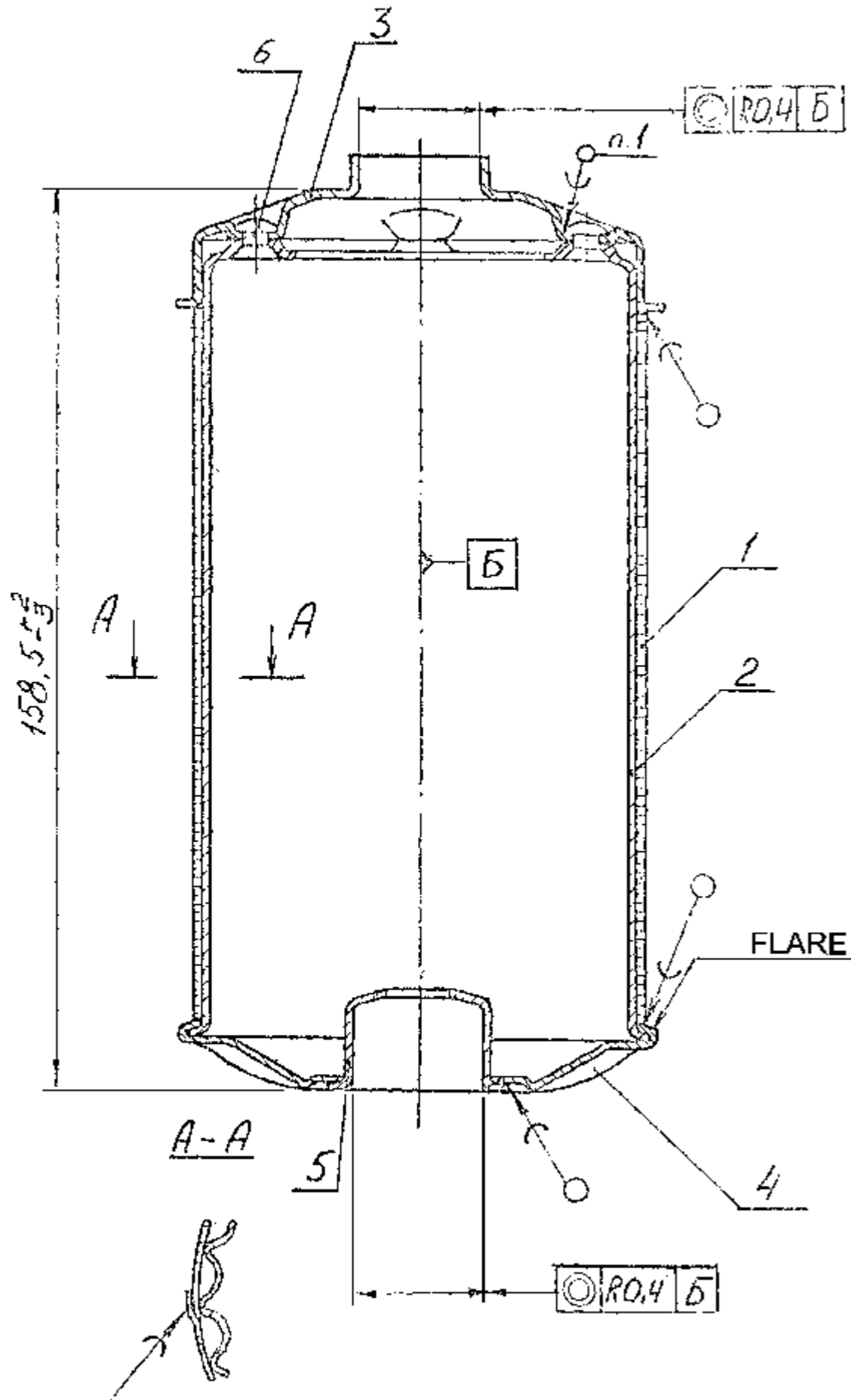

|               |       |  |
|---------------|-------|--|
| 00132-ICV     |       | NEW DRAWING PREPARED BASED ON MASTER PRINT RECEIVED FROM COLLABORATORS AS AN ALTERNATE TO KB-C6 05-35, (D-404/ICV) |
| 25-9-89       |       |  |
| WCU NO & DATE | ISSUE | NATURE   |
| AMENDMENTS    |       |  |

|  |               |                       |      |
|--|---------------|-----------------------|------|
| APPROVED                                 | <i>H VASU</i> | <b>675-05-Sb155Sb</b> |      |
| CHECKED                                  | <i>R. ...</i> |                       |      |
| CONTROLLERATE OF QUALITY ASSURANCE (ICV) |               | <b>FILTER SECTION</b> |      |
|  |               |                       |      |
|  |               | 0.56                  | 1:1  |
|  |               | SHT                   | SHTS |