

D. A. NO.

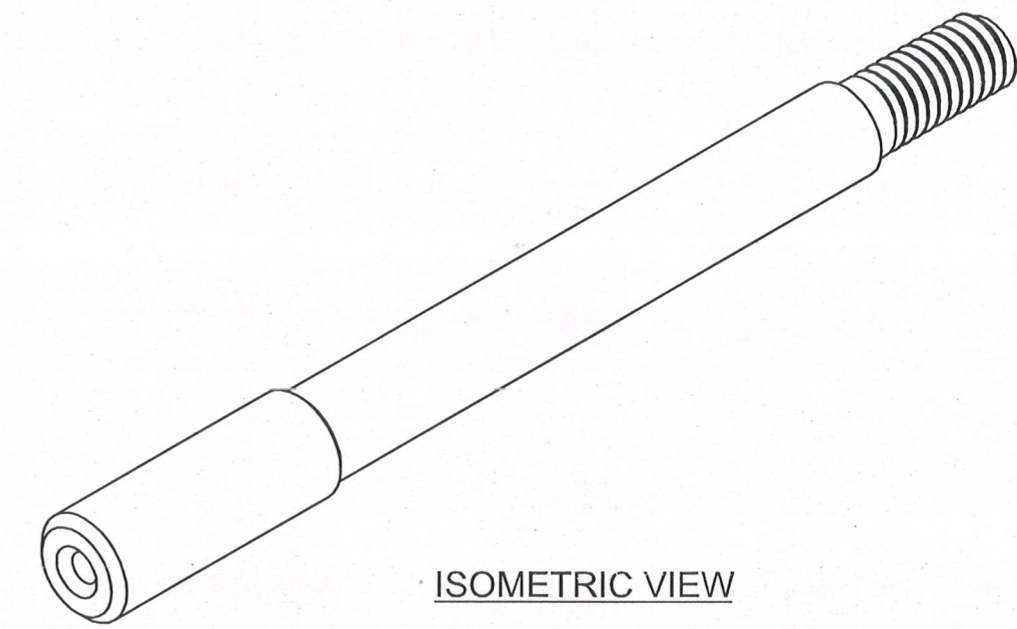
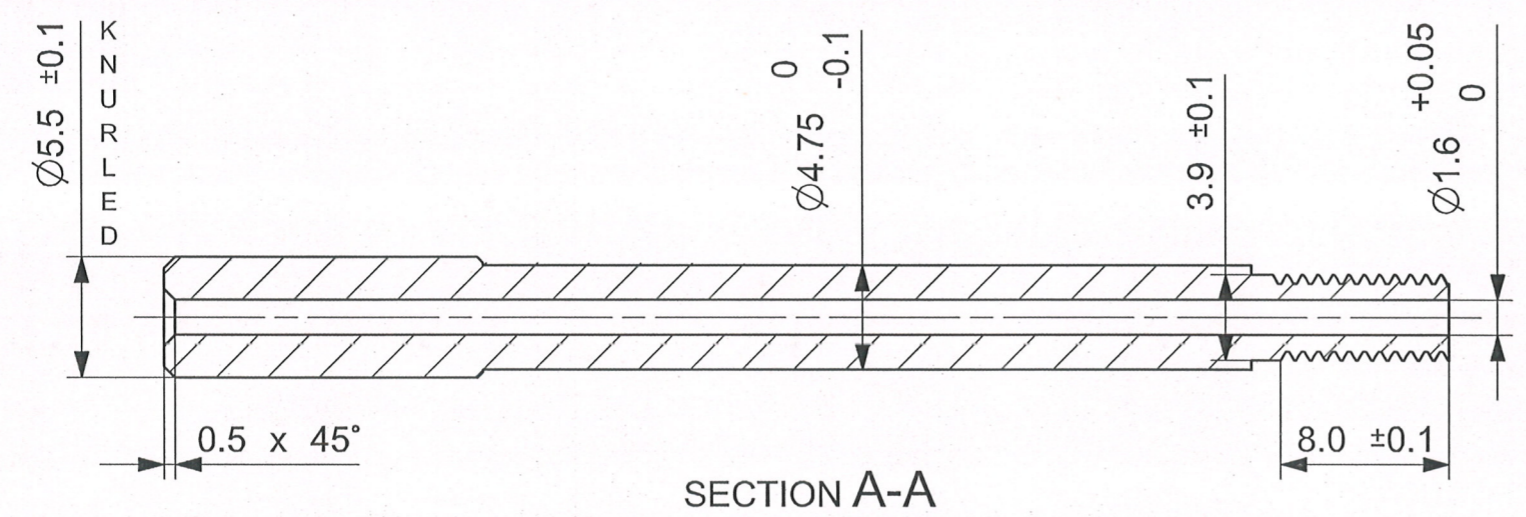
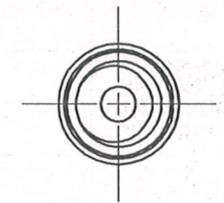
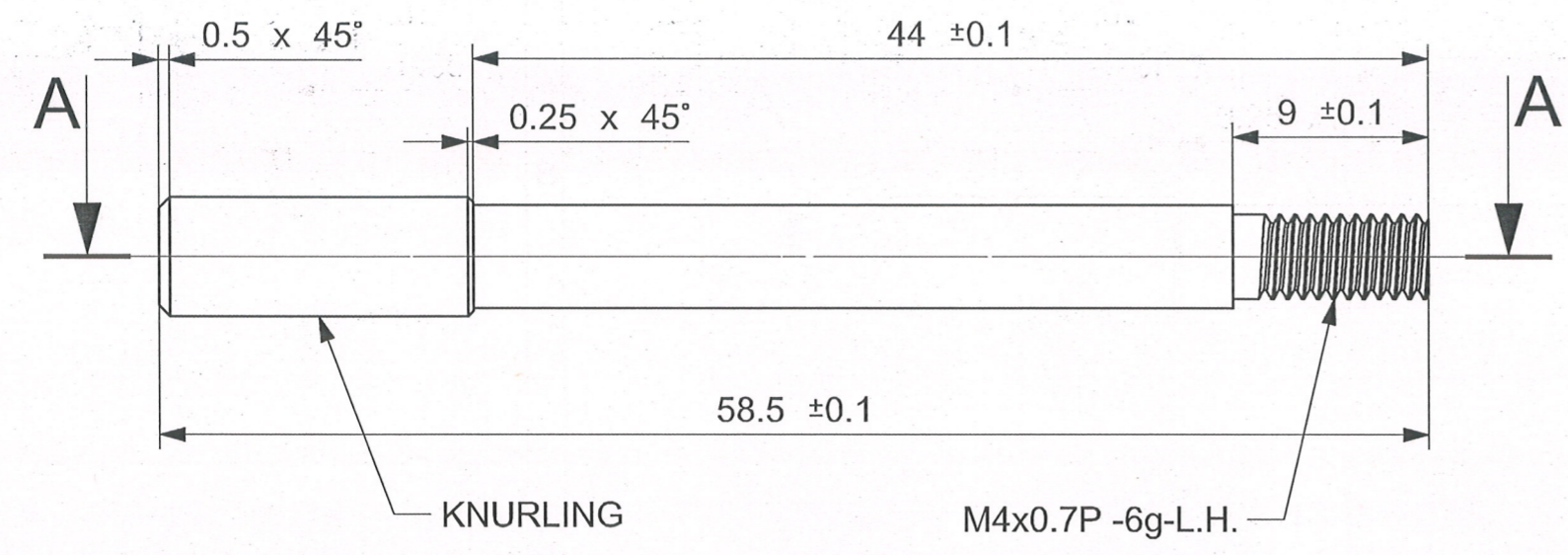

**MATERIAL:-** STEEL BS970 Pt.1:1983 Gd.080M40 OR En-8  
**HARDNESS:-** 250-300 H.V.  
**PROTECTIVE FINISH:-** PHOSPHATED TO SPECN. J.S.S.-0465-01:1988  
 CLASS II (ACCELERATED) OIL FINISH.

<b>REVOLVER.32 (7.65 mm) SIDE SWING</b>  <b>EJECTOR ROD</b>	DESIGNED BY	<i>A.S.RANA</i> A.S.RANA
	CHECKED BY	<i>JWM/DDO</i> JWM/DDO
	APPROVED BY	<i>WM/DDO</i> WM/DDO
	DATE	27.06.2019
SCALE 3 : 1	<b>SMALL ARMS FACTORY</b> <b>KANPUR</b>	
DRAWING NO.		<b>RV-04/6 SW</b>
SHEET		1 OF 1
A3		

DIMENSIONS ARE IN MM.