

27 OCT 2014

आरेखन की नवीनतम प्रति आरेखन कार्यालय,
 आयुध विभाग, भुसावल में जारी की गई है।
 Latest Drawing is available in Drawing
 Office, Ordnance Factory, Bhusawal.

[Signature]
 आरेखन विभाग, भुसावल कार्यालय,
 Head of Section, Drawing Office.

CENTRE PART
 IN TWO PIECES
 THICKNESS 2.5

BRACKET
 OUTER PART

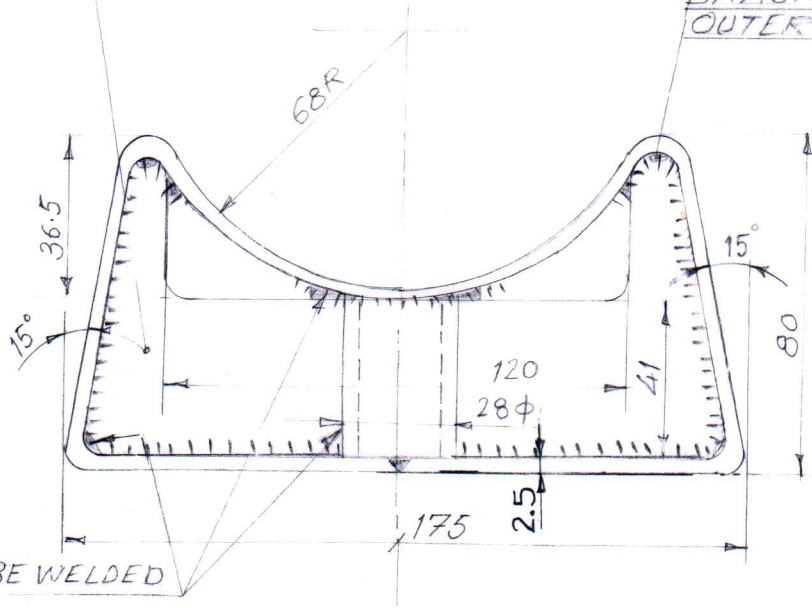

MATERIAL:-

- STEEL CONFORMING TO ANY ONE OF THE FOLLOWING SPEC.
- i) IS: 513.1994 COLD ROLLED & ANNEALED BEST SURFACE TYPE D
 - ii) BS: 1449 PART-I-1972 SEC 2 CS CORE COLD ROLLED & ANNEALED

NOTE:-

- 1) DRG CONVERSION CONFORM TO IS: SPECN.
- 2) ALL DIM ARE IN mm., TOL. CONFORMING TO IS: 2102 (MEX)
- 3) WITHOUT CROSSLINKED POLYETHYLENE FOAM

ITEM	DESCRIPTION	NO. OFF	MATL.	TREATMENT	REMARK
	<u>BRACKET-B2</u> <u>FOR BOX-C-53-A</u> <u>REF DRG NO ISV 2050</u>			1992002	SIGN
				DRN	19/12/01
				CHD	22/11
				F/DO	31/01
				APPD	4/12
SCALE :- 1:2		ORDNANCE FACTORY BHUSAWAL		DRG NO.	
				OFB/C/1483	