

DRG. NO. 2753-57-31
(ITEM NO. 2)

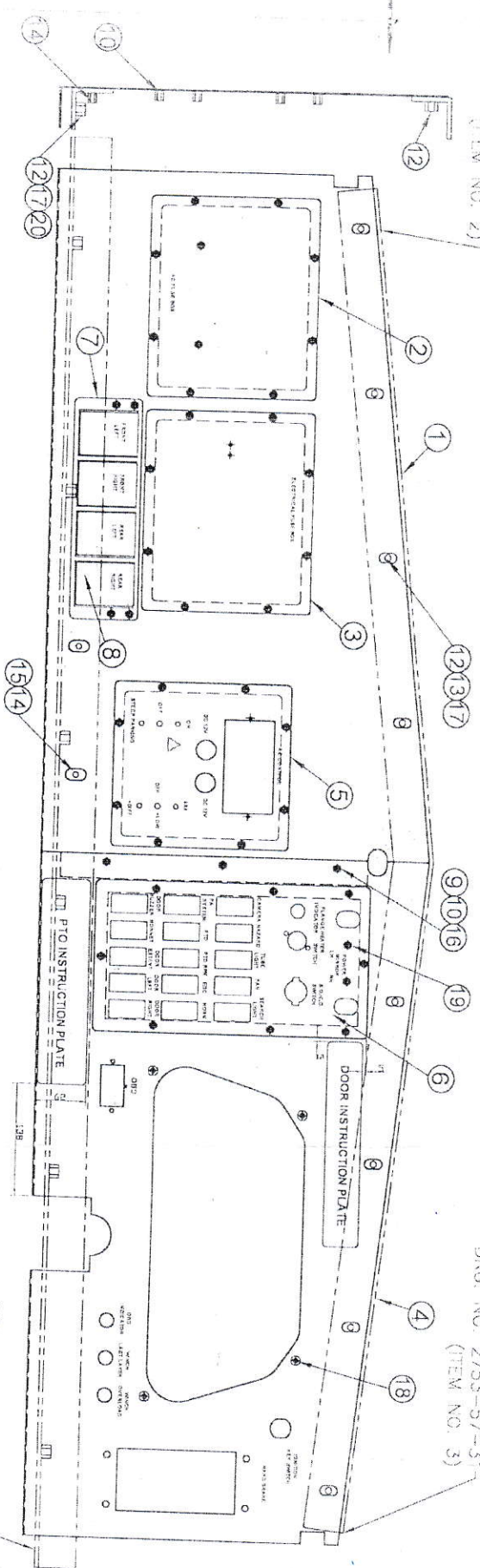

DRG. NO. 2753-57-31
(ITEM NO. 3)

DRG. NO. 2753-57-31
(ITEM NO. 4)

NOTE: SAMPLE TO BE APPROVED BEFORE BULK SUPPLY.

- AMENDMENT- A-1 MATERIAL SPECIFICATION ADDED.
 (MATERIAL - MS SHEET 2mm THICK, IS-1079 GR 'D').
 **MATERIAL - C/S SHEET 1mm THICK, IS-513 GR 'D').
1. ALL DIMS. ARE IN MM.
 2. UNSPECIFIED LIMIT DEVIATIONS ARE ±0.5mm
 3. POCKETS FOR SEARCH LIGHT REMOTE ARE TO BE BOLTED ON DASH BOARD AS SHOWN IN THE ASSY. DRG.
 4. SHUTTERS ARE TO BE BOLTED ON DASH BOARD AS SHOWN IN THE ASSY. DRG.
 5. COLOUR OF THE DASHBOARD PANEL LH, RH, POCKET BASE PLATE & POCKET (ITEM NO. 1, 4, 7 & 8) TO BE POWDER COATED: BLACK, FINE FINISH AS PER IS:13871.
 6. SHUTTERS (ITEM NO. 2, 3, 5 & 6) TO BE POWDER COATED: WHITE, FINE FINISH AS PER IS 13871 LABELING ON THE DASHBOARD PANEL RH & POCKET (ITEM NO. 4 & 8): WHITE, FINE FINISH (FONT TYPE: ARIAL (BOLD), SIZE:5) & SHUTTERS (ITEM NO. 2, 3, 5 & 6): RED, FINE FINISH (FONT TYPE: ARIAL (BOLD), SIZE:5)
 7. ITEM NO. 10 SHOULD BE TACK WELDED ON PLATE PROPERLY
 8. PASTING OF INSTRUCTION PLATES ON DASHBOARD PLATE AS SHOWN.
 9. ITEM NO. 12, 6 NOS. ON FRONT DASHBOARD ANGLE, 4 NOS. ON REAR DASHBOARD ANGLE LEFT.
 10. 4 NOS. ON REAR DASHBOARD ANGLE RIGHT SHOULD BE WELD AS PER DRG. NO. 2753-57-31.
 11. ITEM NO. 14, 2 NOS. ON FRONT DASHBOARD ANGLE SHOULD BE WELD AS PER DRG. NO. 2753-57-31.

1. MATERIAL - MS SHEET, 2mm THICK, IS-1079 GR 'D'.
2. MATERIAL - C/S SHEET 1mm THICK, IS-513 GR 'D'.

1. DIMS. AMENDED IN ITEM NO. 1 & 4.
2. SWITCH FOR DOOR BUZZER ADDED.
3. 2 NO. (C/S) FE HOLES ADDED IN ITEM NO. 3.
4. FITMENT HOLES POSITION AMENDED TO SUIT DRG. NO. 2753-57-31.
5. DRG. & DIMENSIONING PATTERNS TOTALLY MODIFIED.
6. 10. FONT TYPE & SIZE ADDED. (TYPE: ARIAL (BOLD), SIZE:5)

INDEX	DRG. NO.	DESCRIPTION	QTY	UNIT	REMARKS
20		SCREW HEX HD. M8X49L	6	STD.	
19		SCREW HEX HD. M6X40L	4	STD.	
18		SCREW CHEESE HD. M6X20L	4	STD.	
17		SPRING WASHER B8	14	STD.	
16		SPRING WASHER B6	5	STD.	
15		SCREW FOUR HD. M6X30L	2	STD.	
14		THREADDED BOSS M6X12mm-X12mm	2	MS	
13		SCREW HEX. HD. M8X25L	8	STD.	
12		THREADDED BOSS M8X15mm-X12mm	14	MS	
11		ELECTRICAL FUSE HTG. BKT.	1	MS	
10		THREADDED BOSS M6X12mm-X12mm	47	MS	
9		SCREW HEX. HD. M6X12L	39	STD.	
8		POCKET SEARCH LIGHT REMOTED	4	**	
7		POCKET BASE PLATE	1	**	
6		METAL SHUTTER	1	AS SHOWN	
5		METAL SHUTTER	1	AS SHOWN	
4		METAL DASHBOARD PANEL RH	1	AS SHOWN	
3		METAL SHUTTER	1	AS SHOWN	
2		METAL SHUTTER	1	AS SHOWN	
1		METAL DASHBOARD PANEL LH	1	AS SHOWN	

INDEX	ALTERATION	SIGN.	DATE
1			

DRG. NO.	VEHICLE FACTORY JABAL PUR
DRG. NO.	2679-57-31/A
SCALE	1:4
DATE	13/08/20

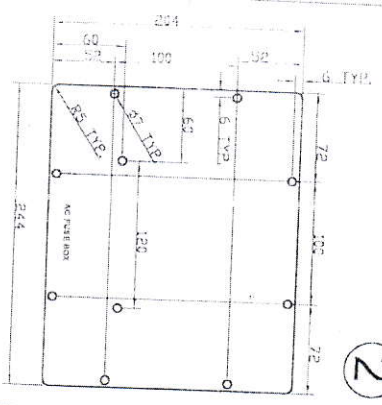
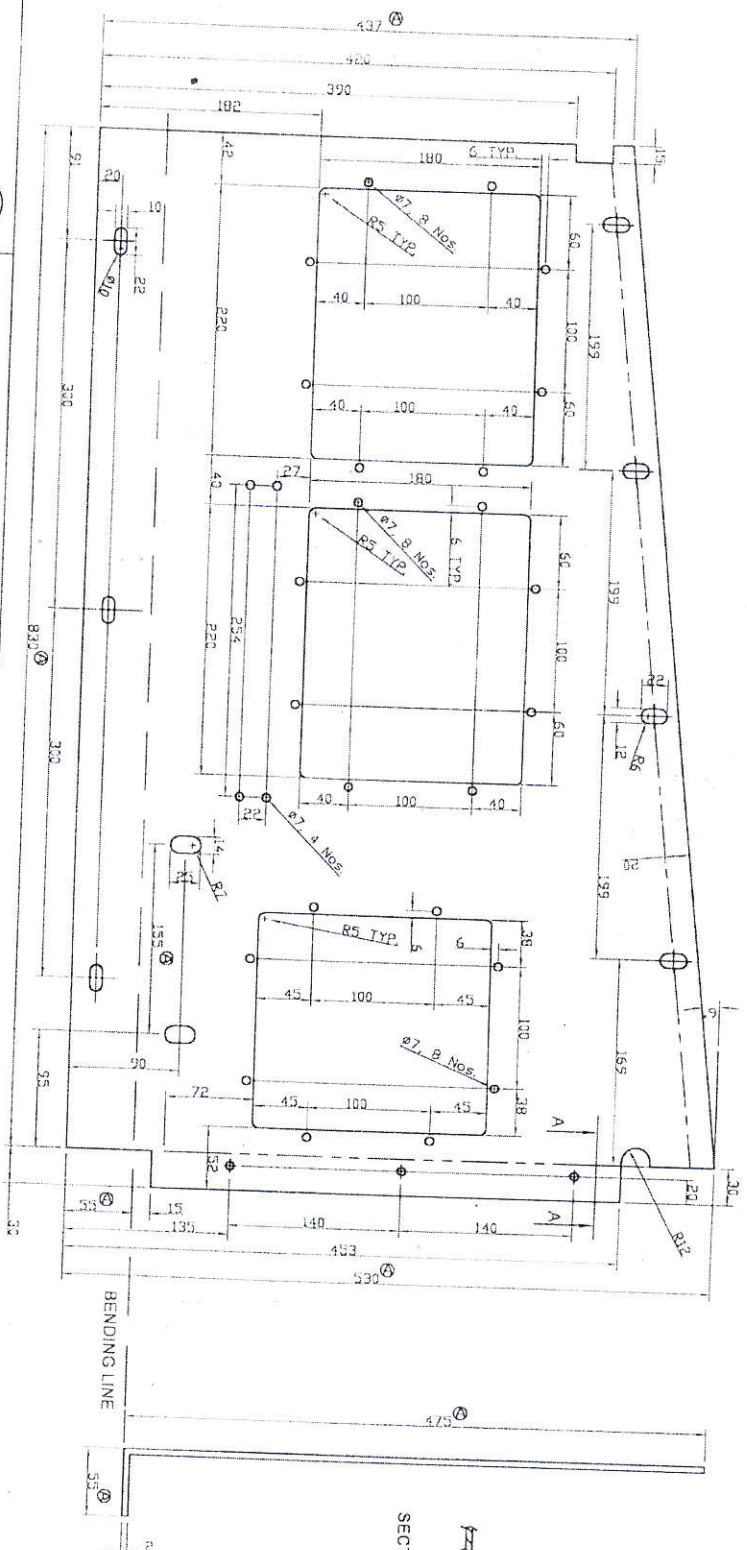

2

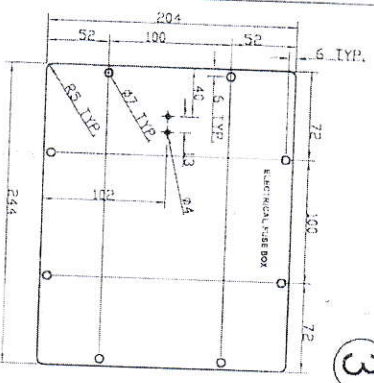

3

INDEX	ITEM	DESCRIPTION	NO. OFF. MATL.	TREAT./SIZE	REMARKS
1	METAL SHUTTER		1	AS SHOWN	
2	METAL SHUTTER		1	AS SHOWN	
3	METAL DASHBOARD PANEL LH		1	AS SHOWN	

INDEX	ALTERATION	SIGN.	DATE	ALTERNATE NOTE APPLICABLE	MODEL	DIR/ODC	AD/ODC	JVM/ODC	DRN	CKD.
0.30					MPV					
30.250					4X4					
250.800										
800.2000										
>2000										
40.8										
GEN. TOL.										

DDC	VEHICLE FACTORY JABALPUR	REPLACEMENT FOR	DRG.ND.	2079-57-31/A	2/4
		UPGRADED MPV 4X4			SHT
					DATE
					SCALE
					1:1
					13.08.20

SECTION A-A

4

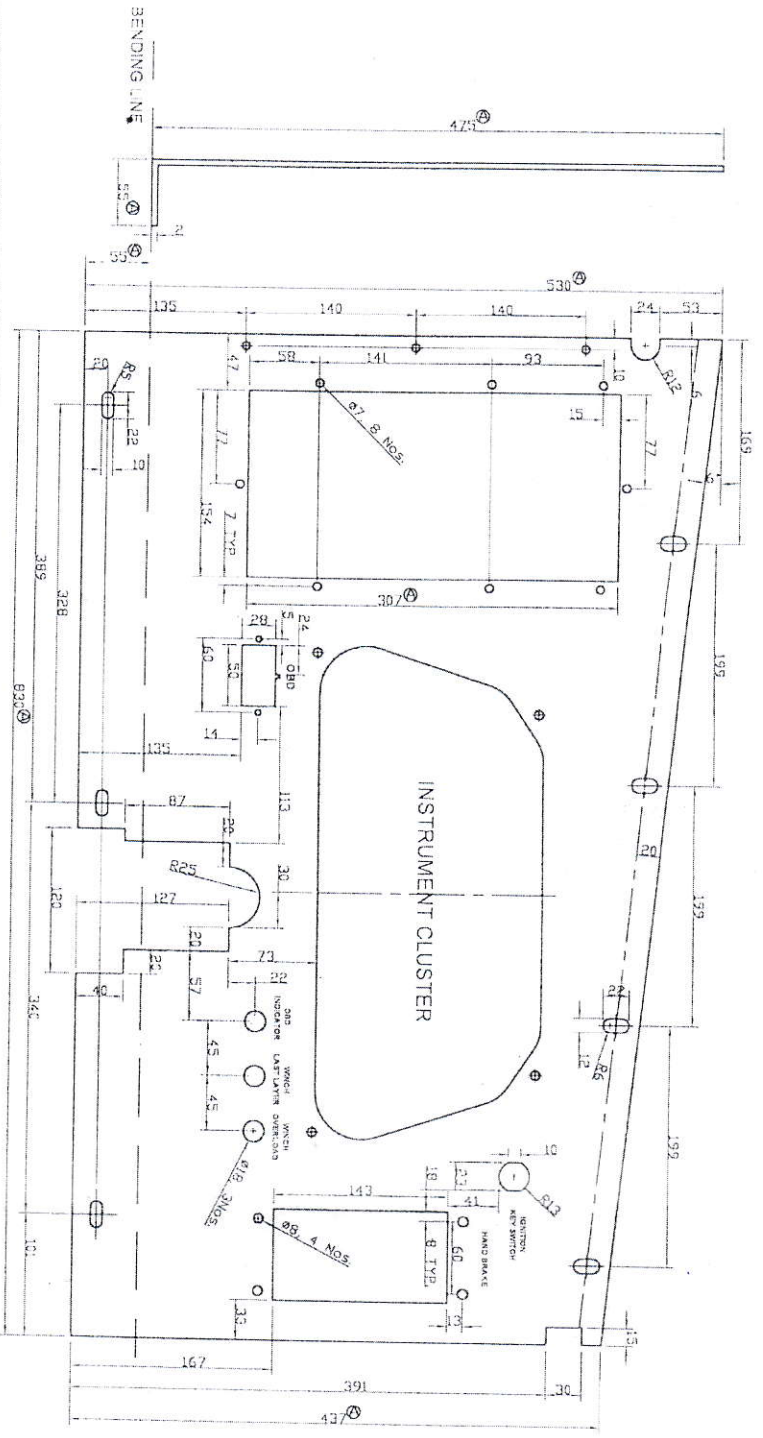

PROFILE DETAIL OF INSTRUMENT CLUSTER

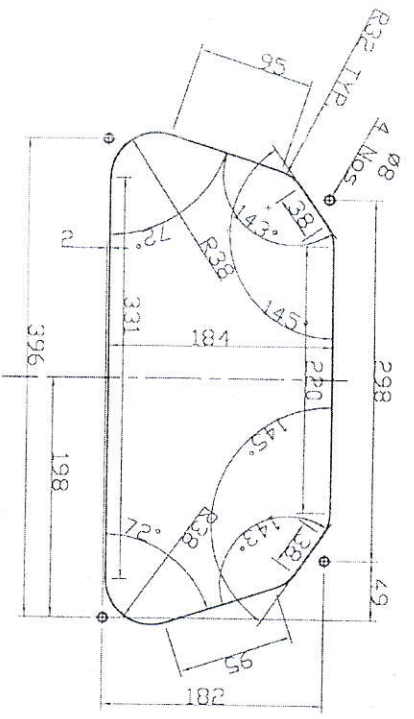

4	METAL DASHBOARD PANEL RH	1	*	AS SHOWN	TREAT/SIZE	REMARKS
ITEM	DESCRIPTION	NO. OFF MATL.				
				UPG	DIR/DDC	
				MPV	AD/DDC	
				4X4	JWM/DDC	
INDEX	ALTERATION	STGN	DATE	ALTERNATE MODEL	DRN	CKD
DIMS. TOL.	METAL DASHBOARD PANEL					
0-30	±0.1					
30-250	±0.2					
250-800	±0.3					
800-2000	±0.5					
>2000	±0.8					
GEN. TOL.	±0.8					
DDC	VEHICLE FACTORY JABALPUR					
	REPLACEMENT FOR					
	DRG. NO. 2679-57-31/A					
	REPLACED BY					
	DATE 13/08/20					
	SCALE 1:1					
	37/4					
	SHT					

