

881 X0

ON LWD

DRG. CONVENTIONS CONFORM TO IS: 696
DIMS. ARE IN mm

D.S.I. 18749-A.

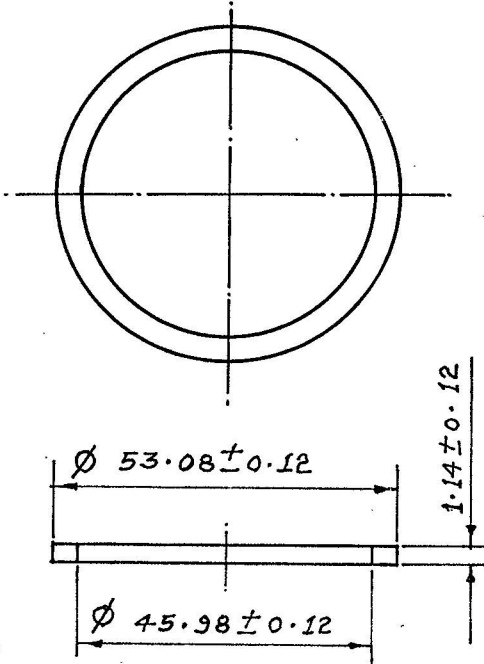

WASHER TO BE IMPREGNATED
WITH MINERAL JELLY.

30-6-88

RETRACED WITHOUT CHANGE.

PREVIOUS D.C.^S(I) Nos 18749-A, 20884-A, 30318-A,
32465-A & 34168-A.

SDI

R. NO.	DATE	AUTHORITY	REVISION	ZONE	AHSP. D.O. SIG.
--------	------	-----------	----------	------	-----------------

DRG. SEALED:- 14-8-44

DRN.	CHD.	TRD. RDT	COMP.	ASSY. DRG.
C.D. MAN	O/C. D.O.			
APPD.	SDI- FOR C.Q.A.(A)			
SCALE:- 2/1				
EST. MASS:-				
GAUGE SCHD:- DATE:- 26-7-44				

MATL:- BOX CLOTH.

DESIGNER'S REF.

PROTECTIVE FINISH:-

F.D. 2790

WASHER

PART NO. **QX 188**

D.S. CAT. NO.
1390-000267

AHSP:- C.Q.A.(A). KIRKEE