

M 1372

NOTES:

1. APPLICABLE SPECS/STANDARDS:  
A. ASME Y14.5M-1994
2. MATERIAL:  
A. WROUGHT STEEL, ASTM A108: 1018-1022, ASTM A322, A331, 4118, 8615, OR 8620.  
B. CASTING STEEL, MIL-S-22141, 10B620, TENSILE TEST SHALL NOT APPLY. CASTING SHALL BE IN ACCORDANCE WITH CLASS 4 OF SAE AMS 2175.
3. FINAL PROTECTIVE FINISH APPLIED AFTER ASSEMBLY.
4. HEAT TREATMENT: CARBURIZE FOR 3 TO 5 MINUTES AT 802 ° TO 816 °C, OIL QUENCH, TEMPER ALL OVER AT 149 °C FOR 1 HOUR MINIMUM TO FILE HARDNESS.
5. FINISH  $\sqrt{32}$  ALL OVER.
6. BREAK EDGES 0.076 + 0.305 UNLESS OTHERWISE SPECIFIED.

REVISIONS				
ZONE	REV.	DESCRIPTION	DATE	APPROVED
A		CREATE DRAWING	12/10/2015	G. HERSHBERGER

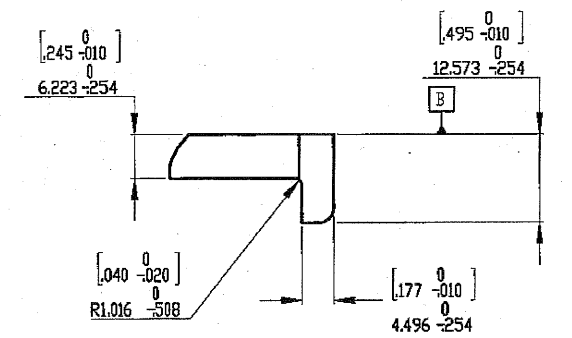
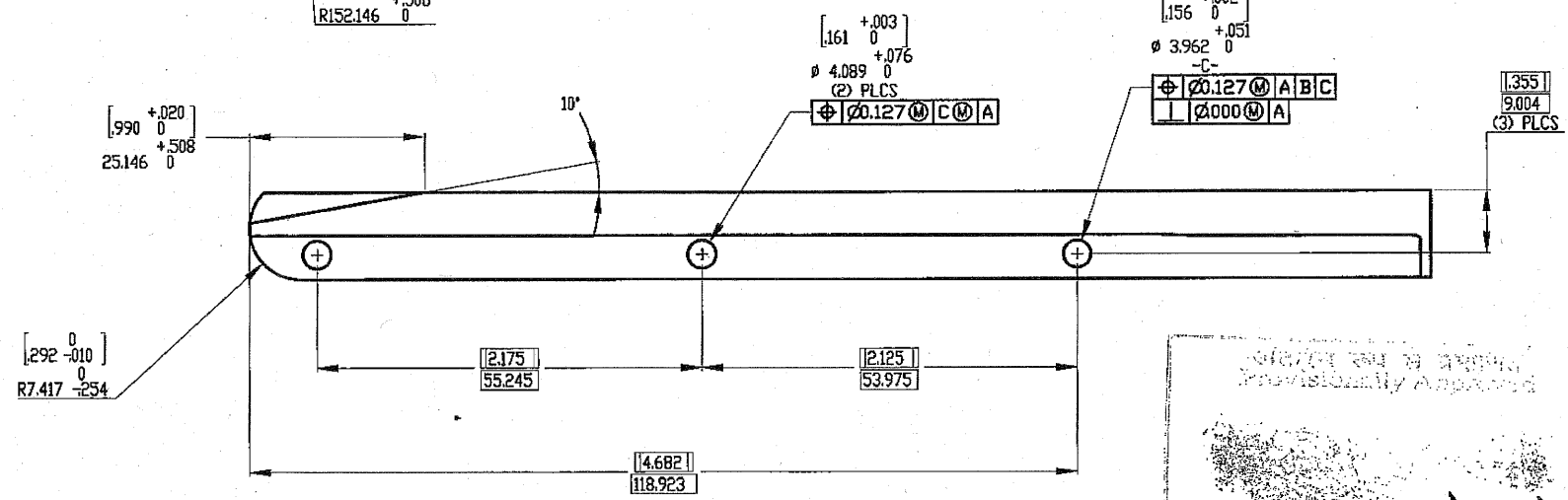
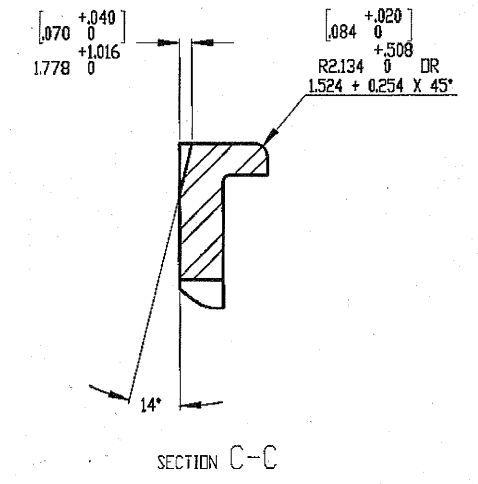
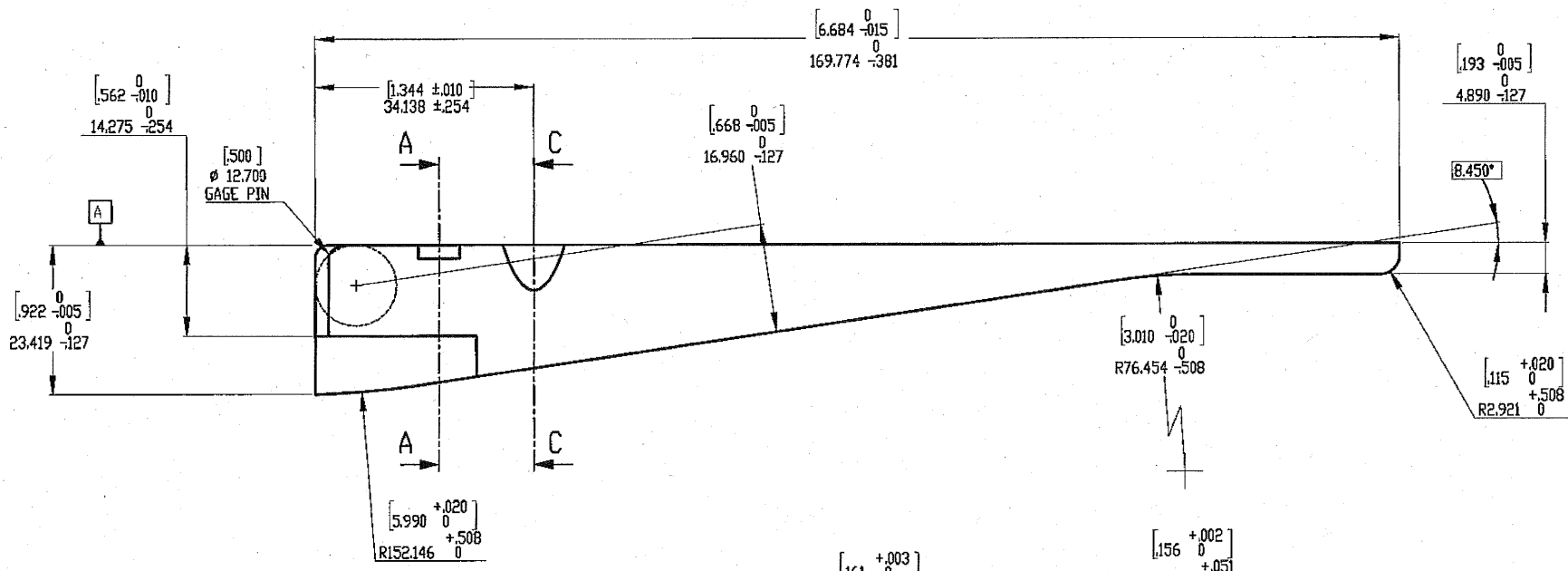
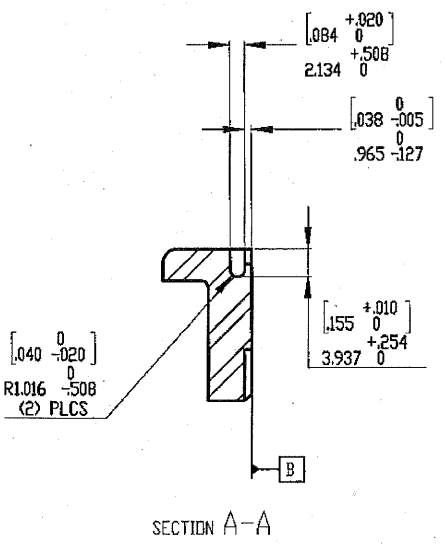
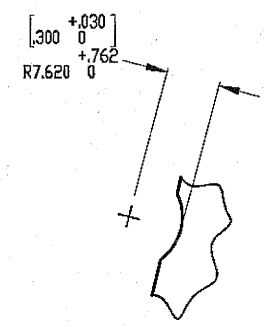
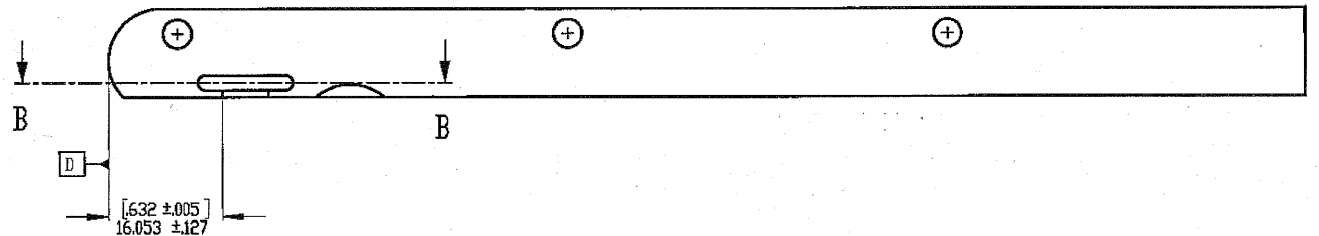
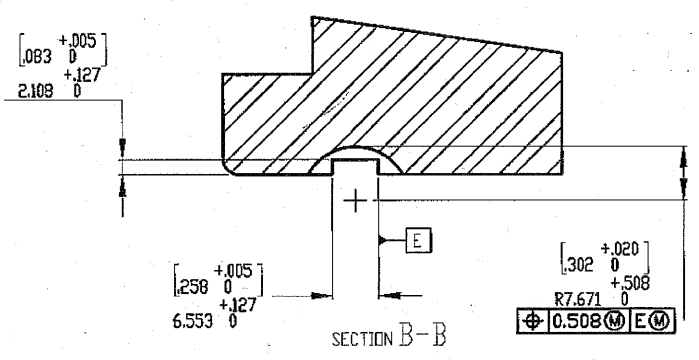

UN CONTROLLED COPY  
CERTIFIED CORRECT COPY OF APPROVED  
DRAWINGS AT THIS DATE: 29.06.2021

24 AUG 2021 For (Inde (AP))

DESIGN & DRAWING OFFICE,  
ORDNANCE FACTORY, TELICHERRAPALLI, 500 016

UNLESS OTHERWISE SPECIFIED	MMC	DATE	DHIO ORDNANCE WORKS, INC.	
ALL DIMENSIONS ARE IN MILLIMETERS	PSD	11/27/21		
ALL DIMENSIONS ARE TO BE SHOWN TO TOLERANCES				
FINISHES ARE TO BE SHOWN TO TOLERANCES				
PROPRIETARY AND CONFIDENTIAL				
THE INFORMATION CONTAINED IN THIS DRAWING IS THE SOLE PROPERTY OF DHIO ORDNANCE WORKS, INC. ANY REPRODUCTION IN PART OR AS A WHOLE WITHOUT THE WRITTEN PERMISSION OF DHIO ORDNANCE WORKS, INC. IS PROHIBITED.				
DATE	REV	DESCRIPTION	SIZE	REV
			D	A
			SCALE: 2:1	WEIGHT: SHEET 1 OF 1

D 55564279