

- NOTE :-
1. REMOVE THE RETAINER DISC WHILE ASSEMBLY IN NOZZLE
 2. INSERT THE IGNITER IN NOZZLE FROM CONVERGENT SIDE
 3. FIX THE IGNITER IN THE DIVERGENT PORTION BY SCREWING RETAINER DISC TO THE IGNITER

LIST OF COMPONENTS

S.No.	DESCRIPTION	DRG.No. HEMRL	DET.No.	ND DEF./QTY
1	RETAINER DISC	IGN/PIN MK-II/024	14	1
2	CANISTER SUB ASSEMBLY	IGN/PIN MK-II/024	1	1
3	GUN POWDER G-4	---	---	25g
4	BOOSTER BAG ANNULAR (FILLED)	IGN/PIN MK-II/024	7	1
5	GRANULES OF ME-445 COMPOSITION	---	---	40g
6	ANNULAR DISC	IGN/PIN MK-II/024	9	2
7	PYROTECHNIC IGNITER PELLET OF ME-445 COMPOSITION SIZE ϕ 10MM X HT. 7MM	IGN/1006	6	60g
8	IGNITER RING	IGN/PIN MK-II/024	13	1
9	IGNITER CLOSURE SUB ASSEMBLY	IGN/PIN MK-II/024	10	1

R. No.	DATE	AUTHORITY	ZONE	BRIEF RECORD	CD. I. GD. SIGN.

DEVIATION FOR INTOLERANCED DIMENSIONS TO CONFORM TO SPEC. IS: 2102 MEDIUM TO 1S SPEC.

SCALE: _____

EST. MASS: _____

GALUGE SCHD: _____

ALL DIMNS. ARE IN MM UNLESS OTHERWISE STATED

MATL: _____

PROTECTIVE FINISH: _____

TITLE: **IGNITER FILLED FOR PINAKA MK-II**

DESIGN AUTHORITY: HIGH ENERGY MATERIALS RESEARCH LABORATORY, PUNE - 411021

DRG. No. _____

HEMRL/IGN/PIN MK-II/024

DET.No. - 2 SHTS SHT No. 1

PART No. _____

D.S. CAT. No. _____

A.H.S.P. _____

DRAWING: DRN. P R PANDA DATE: 08-6-20 CHD. PASSED

APPROVED: _____

FOR DIRECTOR

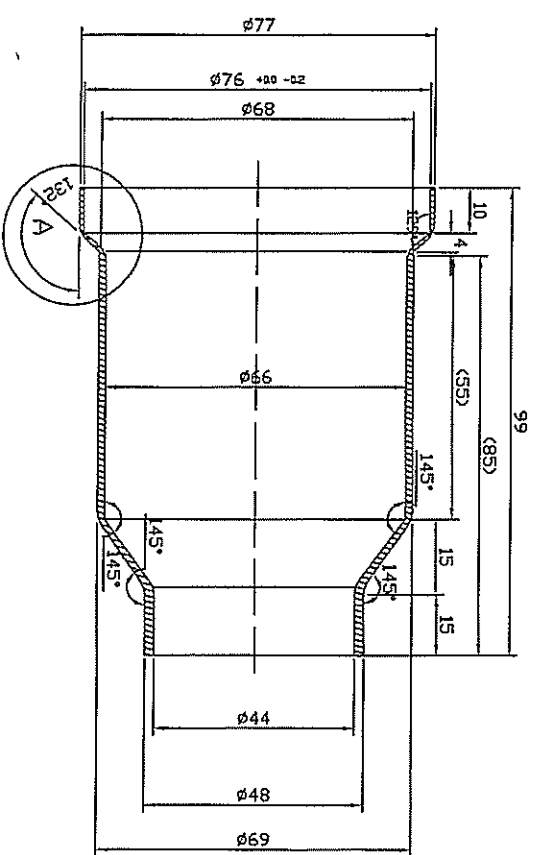

VIEW A

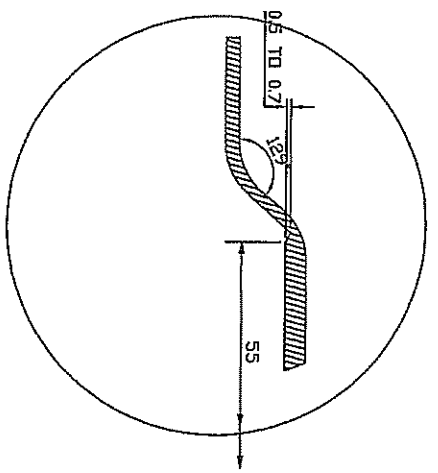
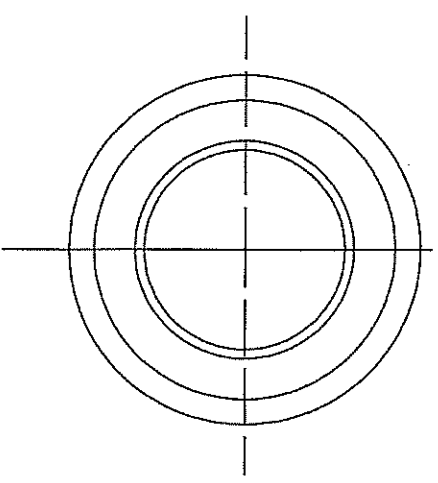

REVISION		BRIEF RECORD	
R. No.	DATE	AUTHORITY	ZONE
		CD. J. GD.	SIGN.

DEVIATION FOR UNTOLERANCED DIMENSIONS TO CONFORM TO SPEC. IS, 2102 MEDIUM TO IS SPEC.		DRAWING CONVENTIONS CONFORM TO IS SPEC.	
SCALE: 1:1		DRAWING: DRN. P. R. PANDA DATE: 08-6-20	
EST. MASS:		CHD.	PASSED
GAUGE SCHD:	ALL DIMS. ARE IN mm UNLESS OTHERWISE STATED	APPROVED	
MATL: ALUMINIUM ALLOY HE-30, GR. 64430/ AA6351 AS PER SPECN. IS 733		FOR DIRECTOR	
PROTECTIVE FINISH:		ASSY/DRG. HEMRL/IGN/PIN/KK-II/024/ DET.1	
TITLE: CANISTER FOR PINAKA MK-II (EMPTY)	DRG. No.	HEMRL/IGN/PIN MK-II/024	
DESIGN AUTHORITY: HIGH ENERGY MATERIALS RESEARCH LABORATORY, PUNE - 411021	DET. No. 3	SHTS: 3	SHTS No.
	PART No.		
	D.S. CAT. No.		
	AH.S.P.		

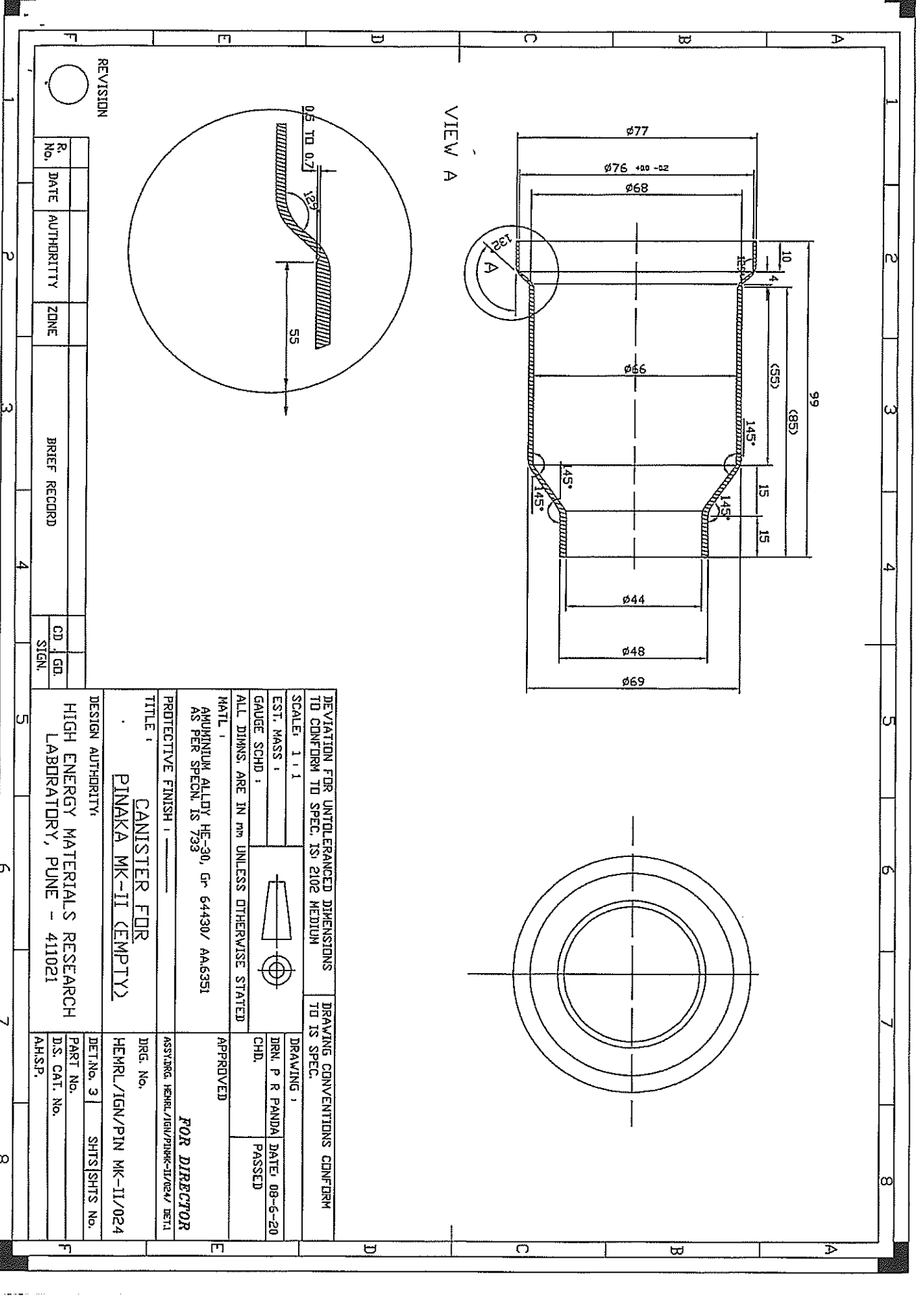

F
E
D
C
B
A

DESIGN AUTHORITY:
HIGH ENERGY MATERIALS RESEARCH
LABORATORY, PUNE - 411021

A.H.S.P.
D.S. CAT. No.
PART No.
DET.No. 14 SHTS SHT No.

RETAINER DISC

DRG. No.
HEMRL/IGN/PIN MK-II/024

TITLE :

PROTECTIVE FINISH : AS ON DRG.

ASSY.DRG HEMRL/IGN/PIN MK-II/025/SHT.1
FOR DIRECTOR
APPROVED

MATL : HYLAM /SP-16

ALL DIMNS. ARE IN mm UNLESS OTHERWISE STATED

CHD. PASSED

GAUGE SCHD :

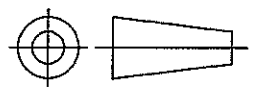

EST. MASS : 41 ±2g

DRN. P R PANDA DATE: 08-6-20
DRAWING :

SCALE: 1 : 1

DEVIATION FOR UNTOLERANCED DIMENSIONS TO CONFORM TO SPEC. IS: 2102 MEDIUM TO CONFORM TO IS SPEC.

DRAWING CONVENTIONS CONFORM TO IS SPEC.

R. No.	DATE	AUTHORITY	ZONE	BRIEF RECORD	CD.	GD.	SIGN.

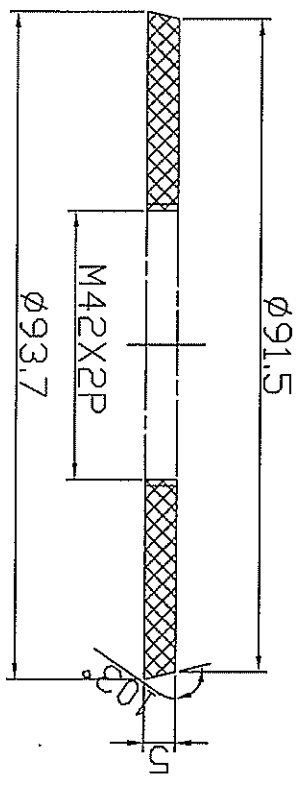

1
2
3
4

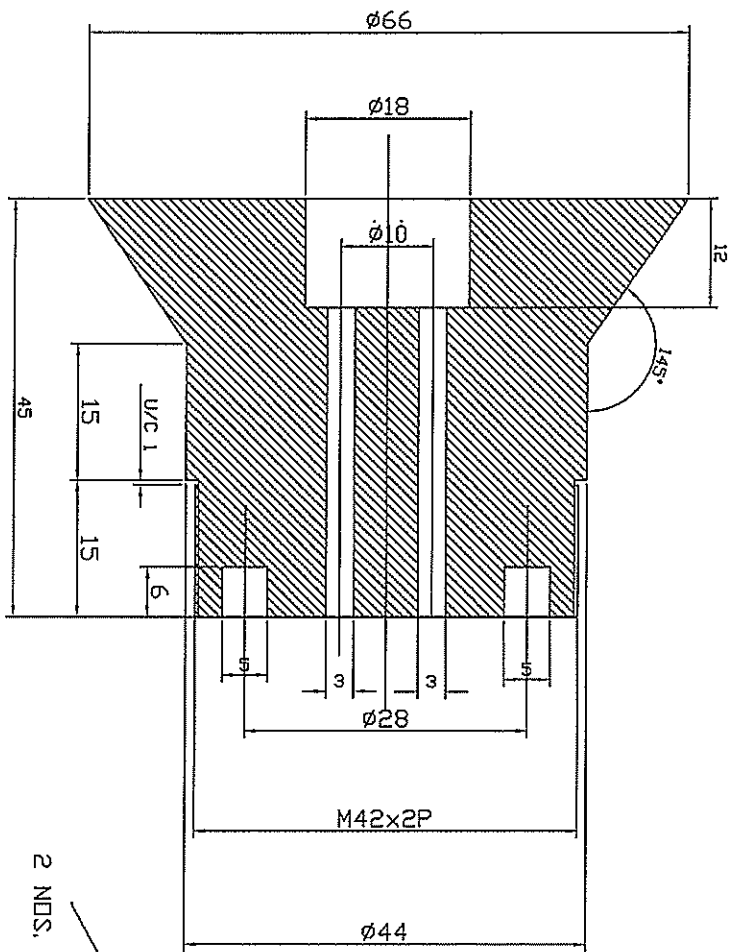

2 NOS OF GROOVES OF DIA 5MM &
DEPTH 6MM DN 28 PCD

2 NOS. OF 3MM HOLES DN 10 PCD AS SHOWN

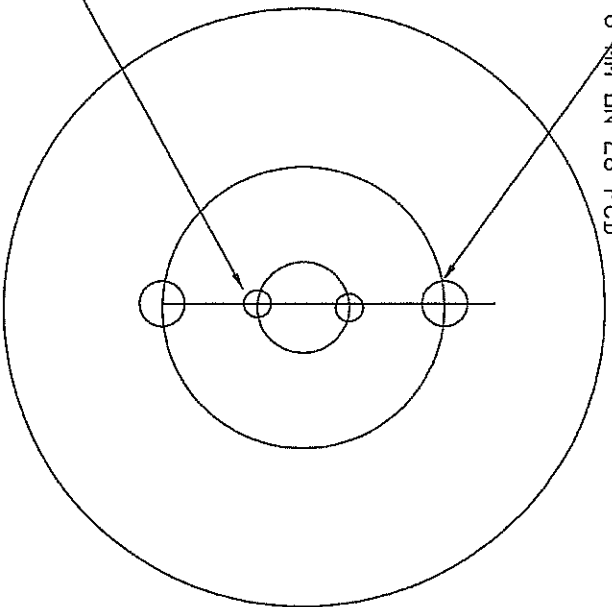

DEVIATION FOR UNTOLERANCED DIMENSIONS TO CONFORM TO SPEC. IS 2102 MEDIUM DRAWING CONVENTIONS CONFORM TO IS SPEC.

SCALE: 2 : 1

EST. MASS: 103±3g

GAUGE SCHD: 1

ALL DIMNS. ARE IN mm UNLESS OTHERWISE STATED

MATL: HYLAN / SP 16



DRAWING: 1

DRN. P R PANDA DATE: 09-6-20

CHD. PASSED

APPROVED

FOR DIRECTOR

ASSY. DRG. HEMRL/IGN/PIN MK-II/024/ DET.2

TITLE: SQUIB HOLDER

DESIGN AUTHORITY:

HIGH ENERGY MATERIALS RESEARCH
LABORATORY, PUNE - 411021

DRG. No. HEMRL/IGN/PIN MK-II/024

DET. No. 4 SHTS/SHTS No.

PART No. D.S. CAT. No.

AH.S.P.

REVISION

R. No.	DATE	AUTHORITY	ZONE	BRIEF RECORD	CD. SIGN.	GO. SIGN.

1 2 3 4 5 6 7 8

A.H.S.P.		HIGH ENERGY MATERIALS RESEARCH LABORATORY, PUNE - 411021	
D.S. CAT. No.		DESIGN AUTHORITY:	
PART No.		"O" RING	
DET. No. 13	SHTS	TITLE :	
HEMRL/IGN/PIN MK-II/024		PROTECTIVE FINISH : AS ON DRG.	
DRG. No.		MATERIAL : NITRIL RUBBER TO SPECN. IND/ME/884 CLASS C40	
ASSY. DRG. HEMRL/IGN/PIN MK-II/024 SHT 1		APPROVED	
FOR DIRECTOR		ALL DIMS. ARE IN mm UNLESS OTHERWISE STATED	
GAGE SCHD :		SCALE: 1 : 1	
EST. MASS :		DRAWING :	
DRN. P R PANDA DATE: 08-6-20		CHD. PASSED	
TO CONFORM TO SPEC. IS: 2102 MEDIUM		TO IS SPEC.	
DEVIATION FOR UNTOLERANCED DIMENSIONS		DRAWING CONVENTIONS CONFORM	
R. No.	DATE	AUTHORITY	ZONE
BRIEF RECORD		SIGN.	
CD.	GD.		

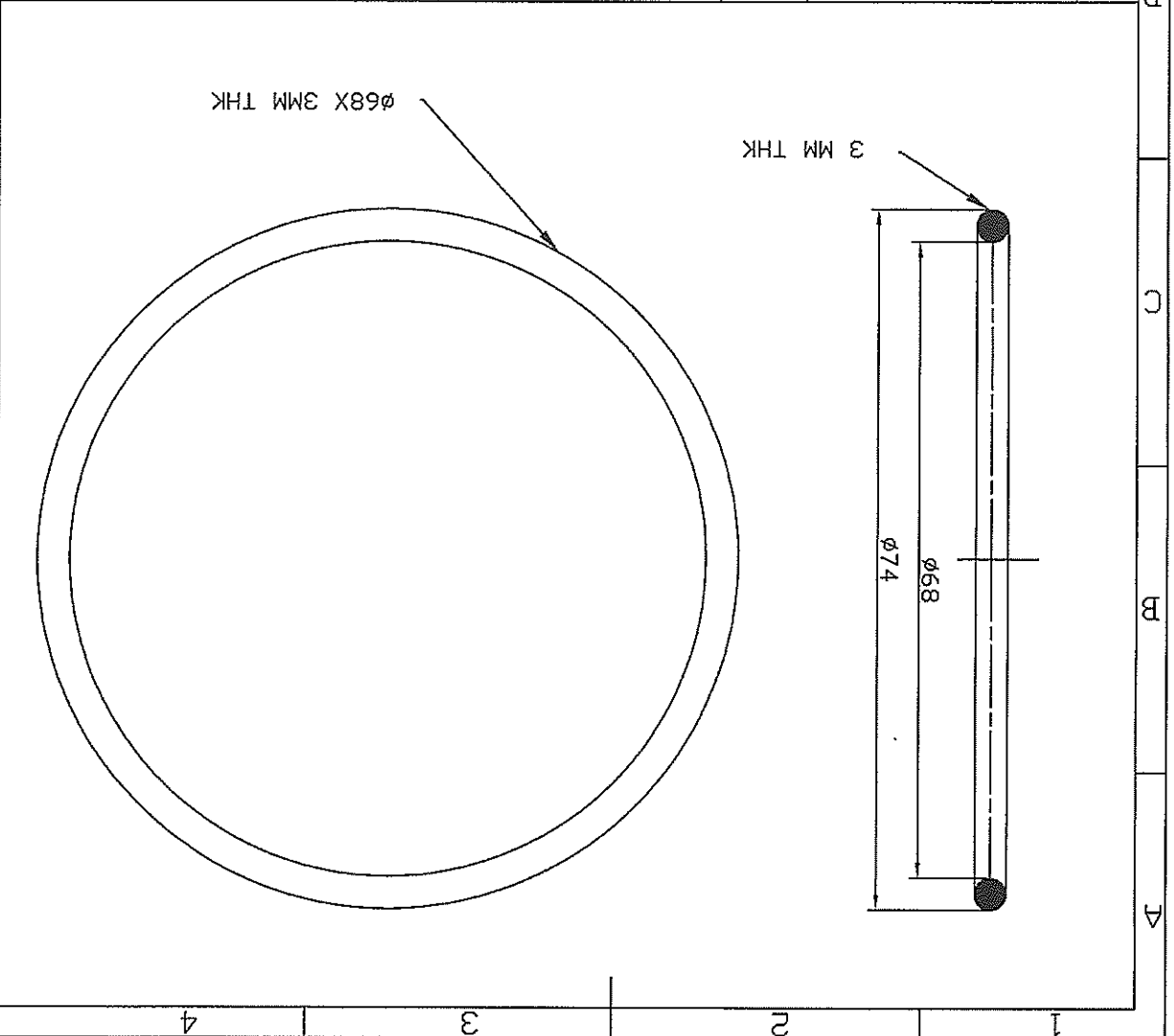

DESIGN AUTHORITY: HIGH ENERGY MATERIALS RESEARCH LABORATORY, PUNE - 411021
 TITLE: IGNITER CLOSURE
 DRG. No. HEMRL/IGN/PIN MK-II/024
 DET.No. II SHTS SHT No.

PROTECTIVE FINISH: AS ON DRG.
 2008, DESIGNATION 19500, CONDITION-H2.
 ALUMINUM 0.2mm THICK TO SPEC. IS:737-1986
 MATL:

ALL DIMNS. ARE IN mm UNLESS OTHERWISE STATED
 APPROVED:

GAUGE SCHD: EST. MASS: $2 \pm 0.5g$
 SCALE: 1:1
 DRAWING: DRN. P R PANDA DATE: 08-6-20
 CHD. PASSED

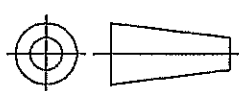

DEVIATION FOR UNTOLERANCED DIMENSIONS TO CONFORM TO SPEC. IS: 2102 MEDIUM
 DRAWING CONVENTIONS CONFORM TO IS SPEC.

R. No.	DATE	AUTHORITY	ZONE	BRIEF RECORD	SIGN.
					CD. GD.

PROTECTIVE FINISH :-
 ANODIC COATING OF CHROMIC ACID ON ALUMINUM TO SPEC. IS:7088-1973,
 2006, TYPE 2, COAT THICKNESS 10 TO 15 MICRON.

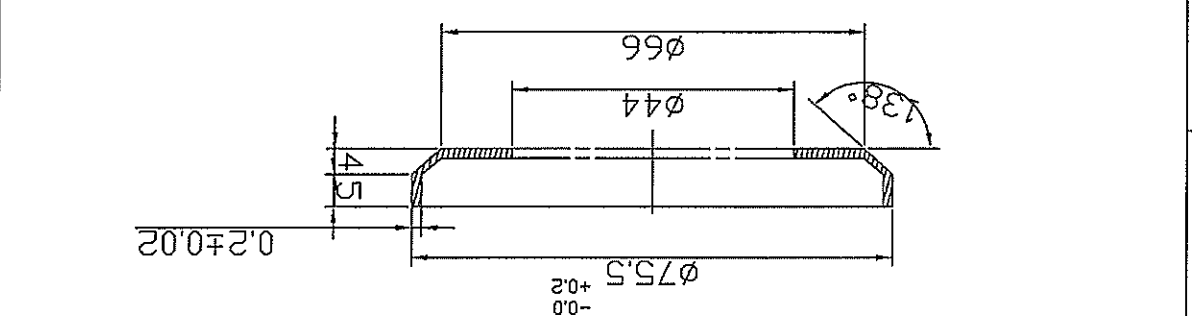
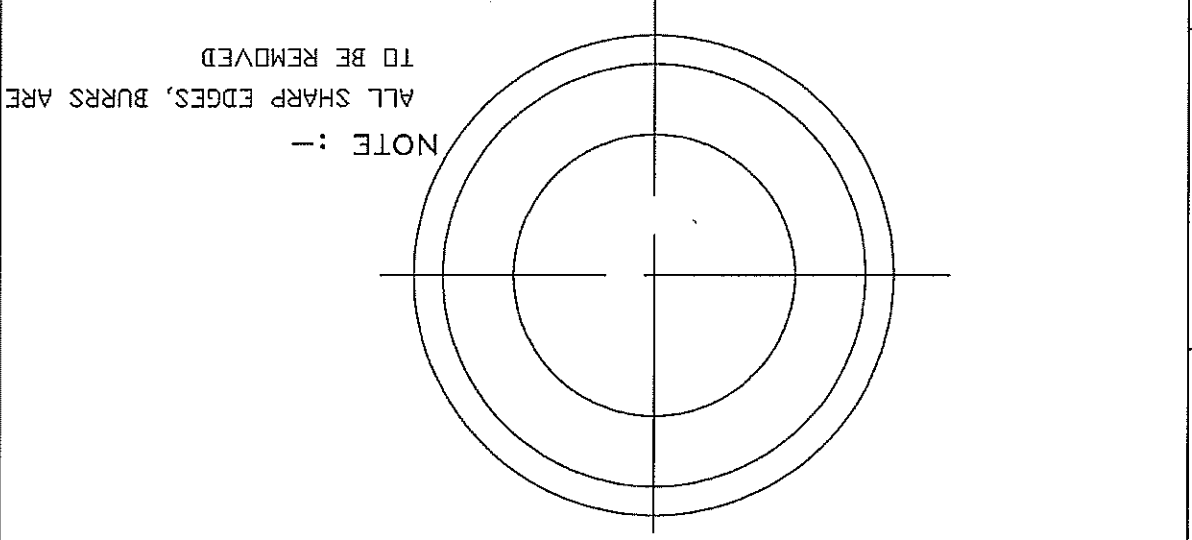

NOTE :- ALL SHARP EDGES, BURRS ARE TO BE REMOVED
 0.2 \pm 0.02

1	2	3	4
---	---	---	---