

Amendment List

Name of document	Pages (sheet) No				Total No. of (sheets) pages in the document.	Document No	Entry No. of accompanying document and date	Signature	Date
	Amended.	Removed.	New	Cancelled					

Technical specifications for overhauling directional gyro ГПК-59.

Catalogue of parts and
and assembly units of
Electrical directional

gyro ГПК -59

127 КД.

127 КД.

Edition 1-73.

Catalogue of parts and

assembly units of

Electrical directional

gyro ГПК-59

127 КД.

Edition 1-73.

1. Introduction.

The catalogue is intended to facilitate the agencies using the directional gyro is making up orders to be placed the manufacturing factory for spare parts required for repairing the material.

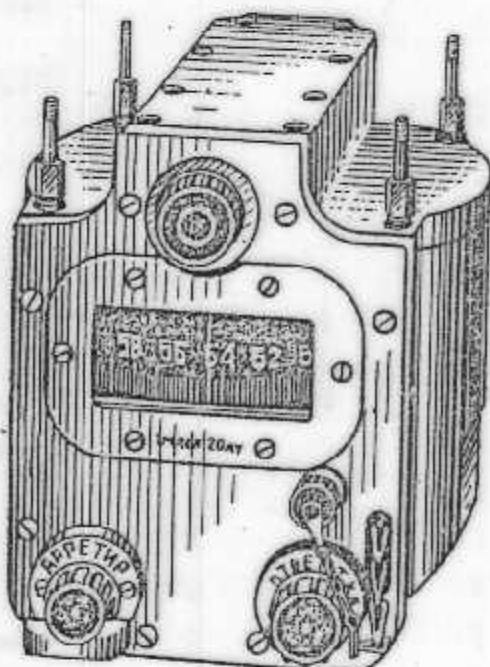

Fig. I. External view of the electrical directional gyro ГПК-59.

Page 4	Catalogue of parts and assembly units	Electric directional gyro ГПК -59
-----------	--	--------------------------------------

2. Units and parts of the article

2.1 Electric directional gyro ГПК -59 (fig.2)

Designation	Description	Fig. No.	Ref. No. in the fig.	Designation of the unit	Quantity of the assembly unit	Mass g	Remarks
1	2	3	4	5	6	7	8
127-cd	Electrical directional gyro -59	2	4			2200	
127-cd1	Body with components	2	5	127-cd	I	500	
127-cd5	Front wall with parts	2	3	127-cd	I	310	
127-cd10	Block assembly unit	2	26	127-cd	I	2,7	
127-cd14	Gimbal unit	2	6	127-cd	I	800	
9 6. 354.001	Control knob	2	1	127-cd	I	II	
127-1	Corrugated band	2	II	127-cd	I	0,14	
127-3	Corrugated band	2	33	127-cd	I	0,1	
127-30	Cover	2	23	127-cd	I	220	
127-62	Cover	2	18	127-cd	I	30,5	
127-63	Gasket	2	19	127-cd	I	1,74	
127-64	Threaded plug	2	13	127-cd	I	2,87	
127-70	Factory trade mark	2	10	127-cd	I	0,11	
127-85	Upper top plug 127-85	2	32	127-cd	I	2,8	
127-94	Gasket	2	15	127-cd	I	0,47	
127-100	Stud	2	20	127-cd	4	5,4	
127-101	Nut	2	31,6	127-cd	I	0,8	
9 8. 632.000	Stopper	2	16	127-cd	I	10,1	
9 8. 683.011	Gasket	2	24	127-cd	I	0,65	
9 8. 683.012	Gasket	2	4	127-cd	I	1,8	
252-114	Nut II	2	14	127-cd	I	I	
075.00. 00.007	Spring washer	2	12	127-cd	I	0,2	
352.00. 00.034	Gasket	2	28	127-cd	I	0,31	Adjusting

1	2	3	4	5	6	7	8
352.10.00.002	Gasket	2	27	127-cd	I	0,15	
352.10.00.003	Gasket	2	29	127-cd	I	0,12	Adjusting.

Standard Components

2T PKM 13-III	Washer GOST 6402-70	2	35	127-cd	4	0,026	
3T65T 02 9	Washer GOST 6402-70	2	8	127-cd	8	0,101	
4 5T 02 9	Washer GOST 6402-70	2	21	127-cd	4	0,267	

~~1. Fig. 2 Electrical directional gyro 127-cd.~~

2.2. Body with components 127-cd1 (fig.3)

Handwritten signature/initials

1	2	3	4	5	6	7	8
127-cd2	Bracket with slide block	3	26	127-cd1	I	59	
127-cd3	Bracket with bush	3	25	127-cd2	I	23,3	
127-cd4	Cage, fork with dogs	3	41	127-cd1	I	37	
160-cd30	Gear Z=65 with bush	3	38	160-cd31	I	23	
160-cd31	Cage clutch	3	36	127-cd1	I	27	
252-cd11	Step gear	3	34	127-cd1	I	19,1	
127-4	Slide block	3	18	127-cd2	I	7,4	
127-7	Latch	3	19	127-cd2	I	1,4	
127-13	Pin	3	20	127-cd2	I	0,58	
127-15	Spring	3	17	127-cd2	I	0,12	
127-34	Body	3	28	127-cd1	I	280	
127-72	Fork axle	3	46	127-cd1	I	2,5	
127-73	Cage spring	3	44	127-cd1	I	2,3	
127-74	Stop	3	45	127-cd1	I	4	
127-76	Axle	3	35	127-cd1	I	4,3	

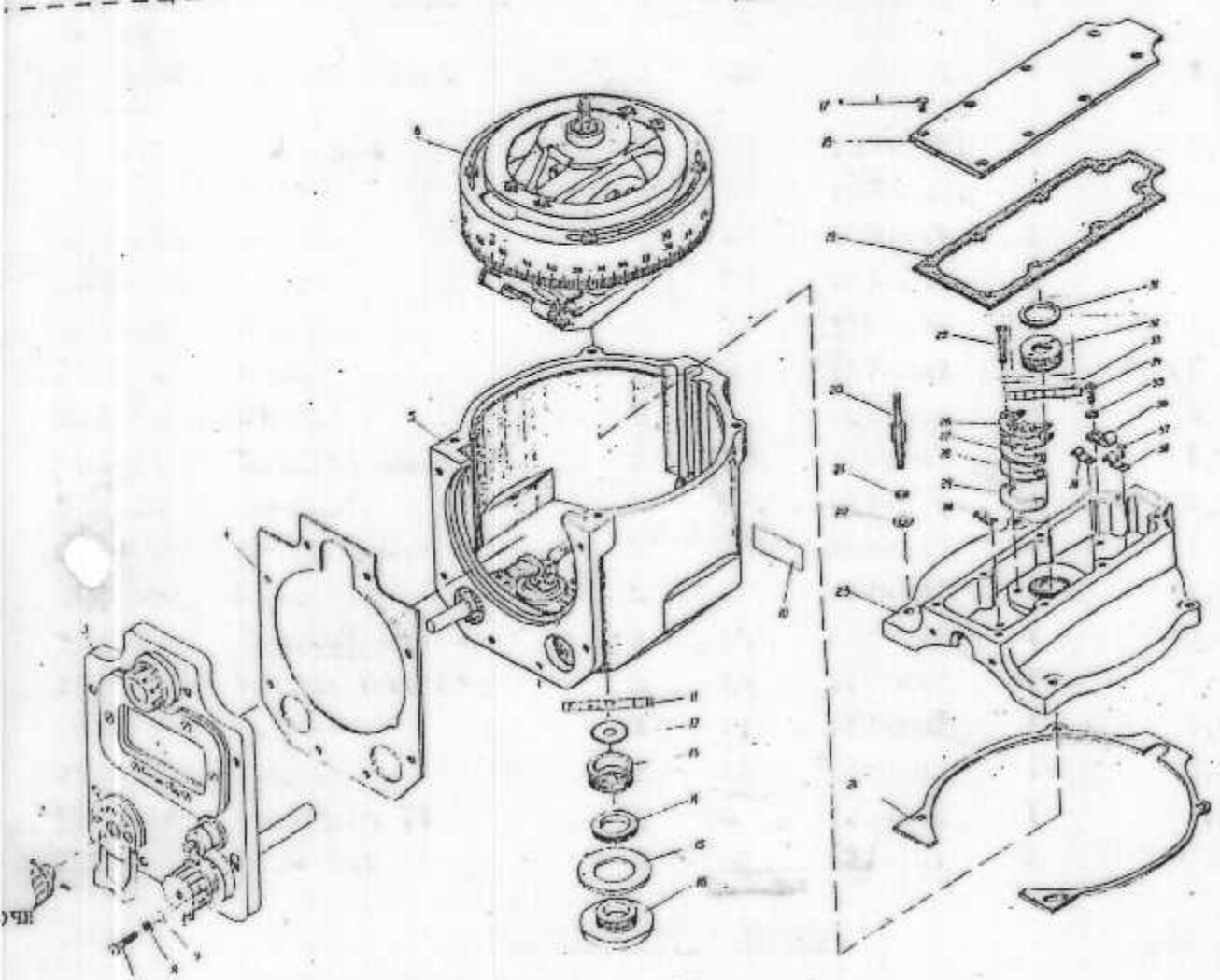

Fig. 2. ELECTRICAL DIRECTIONAL GYRO I27-C8.
Рис. 2. Гироскоп компас электрический I27-06

1	2	3	4	5	6	7	8
9-8.927.	Special stud	3	43	127-cd1	I		1,45
001-1							
9 8.927.	Special stud	3	47	127-cd1	I		1,45
001-2							
160-125	Lock pin	3	39	150-cd31	4		0,04
160-139	Gasket	3	37	160-cd31	I		0,6
160-196	Block	3	40	127-cd1	2		0,5
160-208	Gasket	3	27	127-cd1	3		0,6 Adjusting
252-25	Washer	3	10	127-cd2	I		0,14 Adjusting
252-26	Worm	3	9	127-cd2	I		7
252-27	Block	3	8	127-cd2	2		0,11
252-28	Special washer	3	7	127-cd2	I		1,4
252-30	Lock pin	3	5	127-cd2	I		0,02
252-31	Shaft 252 -31	3	1	127-cd2	I	13	
252-32	Disc	3	3	127-cd2	I		1,6
252-34	Special washer	3	13	127-cd2	I		0,19
252-36	Thrust bushing	3	14	127-cd2	I		0,36
252B-140	Washer	3	11	127-cd2	I		0,07 Adjusting
252B-141	Washer	3	12	127-cd2	I		0,035 Adjusting
252-299	Lock pin II	3	6	127-cd2	I		0,019
253B-192	Lock nut	3	42	127-cd1	2		0,84

Standard Items

3T65T029	Washer GOST 6402-70						
	cotter pin 0,9 x 6	3	23	127-cd1	5		0,101
2046A	GOST 397-79	3	15	127-cd2	I		0,027
2046A-1-7	End pieces 2046A-1-7	3	50	127-cd1	3		0,007
1-3-2 OCT	Seal cup	3	52	127-cd1	I		0,03
110066-71							
3157A-3-	Screw	3	54	127-cd1	4		0,66
8K							
3157A-3-	Screw	3	22	127-cd1	I		0,77
10K							
3177A-1,	Screw	3	4	127-cd2	3		0,05
4-3							
3177A-5-	Screw	3	29	127-cd1	I		I
9K							
HK21.21.	Screw	3	21	127-cd1	I		0,54
24							
3402A-0,	Washer	3	31	127-cd1	I		0,18
1-5-14							
3402A-0,	Washer	3	53	127-cd1	I		0,36
2-5-14							

1	2	3	4	5	6	7	8
3402A-0, 5-6-14	Washer	3	32	127-cd1	I	0,96	
3402A-0, 8-3-6	Washer	3	16	127-cd1 127-cd2	I I	0,16	
3436A-3	Thrust washer	3	30	127-cd1	I	0,3	
3481A-2C ₃ -8	Pin	3	24	127-cd1	2	0,197	
3494A- I-8	Tapered pin	3	2	127-cd2	2	0,06	
4381A- 2-1	Gasket	3	49	127-cd1	I	0,53	

Commercial Items

2PMT 2PMT 1854 5E2	Plug socket TEO.364.141Ty	3	51	127-cd1	I	27	
--------------------------	------------------------------	---	----	---------	---	----	--

2.3. Front wall with components 127-cd5 (fig.4)

127-cd5	Screw driver	4	34	127-cd5	I	12,5	
9 6.115. 001	Body	4	7	9 6.115.002	I	8	
9 6.115. 002	Oilseal body	4	9	127-cd5	I	11,7	
9 6.424. 000	Front wall	4	28	127-cd5	I	160	
9- 6.433. 001	Plug special	4	29	127-cd5	I	5,8	
9- 6.615. 003	Lamp holder	4	14	127-cd5	I	5,9	
9 6.430. 019	With contact point	4	19	127-cd5	I	9	
127-5	Gasket	4	26	127-cd5	I	I	
127-17	Packet	4	12	127-cd5	I	0,08	
127-20	Bush	4	31	127-cd5	I	8,6	
127-22	Gasket	4	36	127-cd5	I	0,36	
127-24	Tube	4	30	127-cd5	I	0,17	
127-31	Gasket	4	27	127-cd5	I	1,5	Adjusti
9 7.326. 000	Socket	4	35	127-cd5	I	9,8	
9 8.229. 001	Threaded bushing	4	16	127-cd5	I	42	
9 8.300. 005	Axle	4	5	9 6.115.002&I		0,6	

I-1052

ГПК-59

CATALOGUE OF PARTS
AND ASSEMBLY.

- 189 -

ELECTRICAL DIRECTIONAL GYRO ГПК-59.

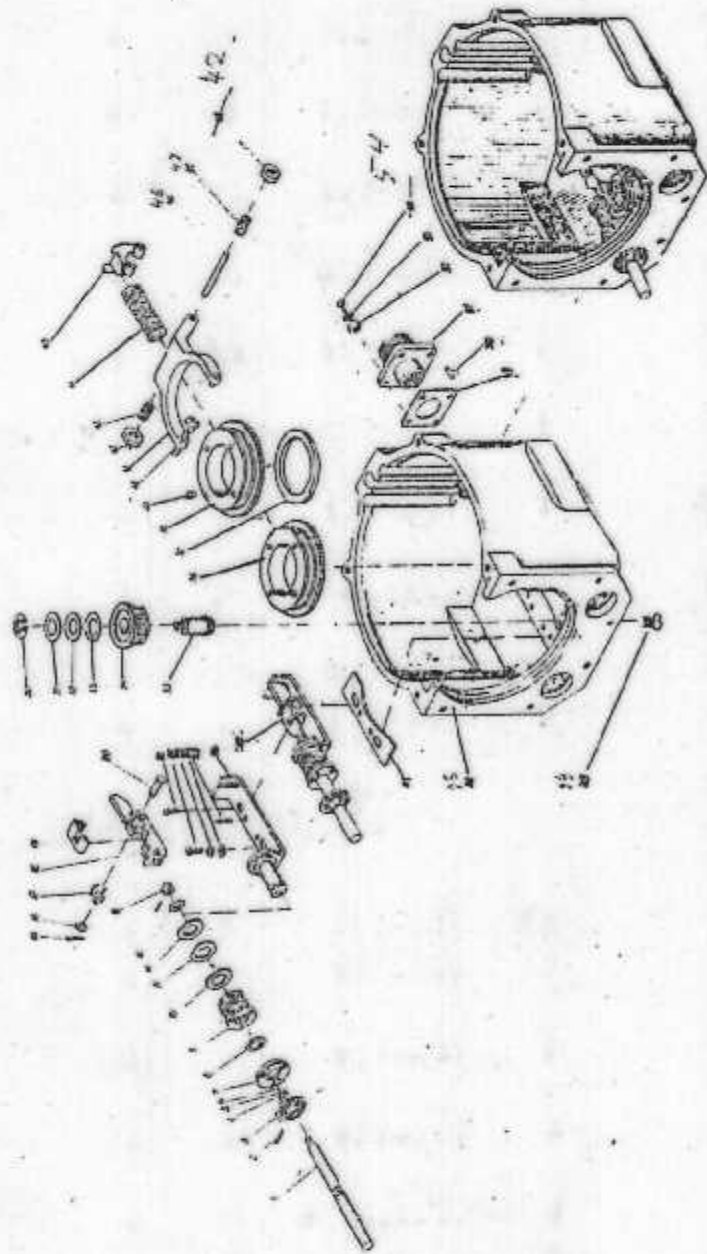

1	2	3	4	5	6	7	8
9 8.352. Pusher 002		4	32	127-cd5	2		0,5
9 8.362. Retainer 016		4	1 9	6.115.002	I		3,5
9 8.383. Spring 015		4	33	127-cd5	2		0,18
9 8.604. Coverplate 001		4	23	127-cd5	I		16,6
9 8.683. Gasket 007		4	24	127-cd5	I		0,65
9 8.683. Gasket 008		4	20	127-cd5	I		0,07
9 8.683. Gasket 029		4	10	127-cd5	I		0,2
9 8.683. Gasket 031	99,08.683.031	4	15	127-cd5	I		0,17
9 8.683. Gasket 037		4	17	127-cd5	I		0,1
9 8.942. Washer 009		4	6 9	6.115.002	2		0,09
252-97	Squeezing cup	4	13	127-cd5	I		0,4
252-98	Packing	4	11	127-cd5	3		0,05 Adjusting

Standard Articles

3T 65T 02 9	Washer GOST 6402-70	4	3	127-cd5	2		0,101
3157A-3- 6K	Screw	4	2	127-cd5	2		0,2
3177A-2- BK	Screw 3177A-2	4	22	127-cd5	2		0,17
3177A-2- BK	Screw	4	21	127-cd5	4		0,21
3370A-1,6	Nil	4	8 9	6.115.002	I		0,12
3481A-I, 6C ₃ -10	Pin	4	4	127-cd5	2		0,15

Commercial Items

127-6	Glass	4	25	127-cd5	I		14,2
MH26- 012-1	Bulb GOST 2204-80	4	18	127-cd5	I		1,9

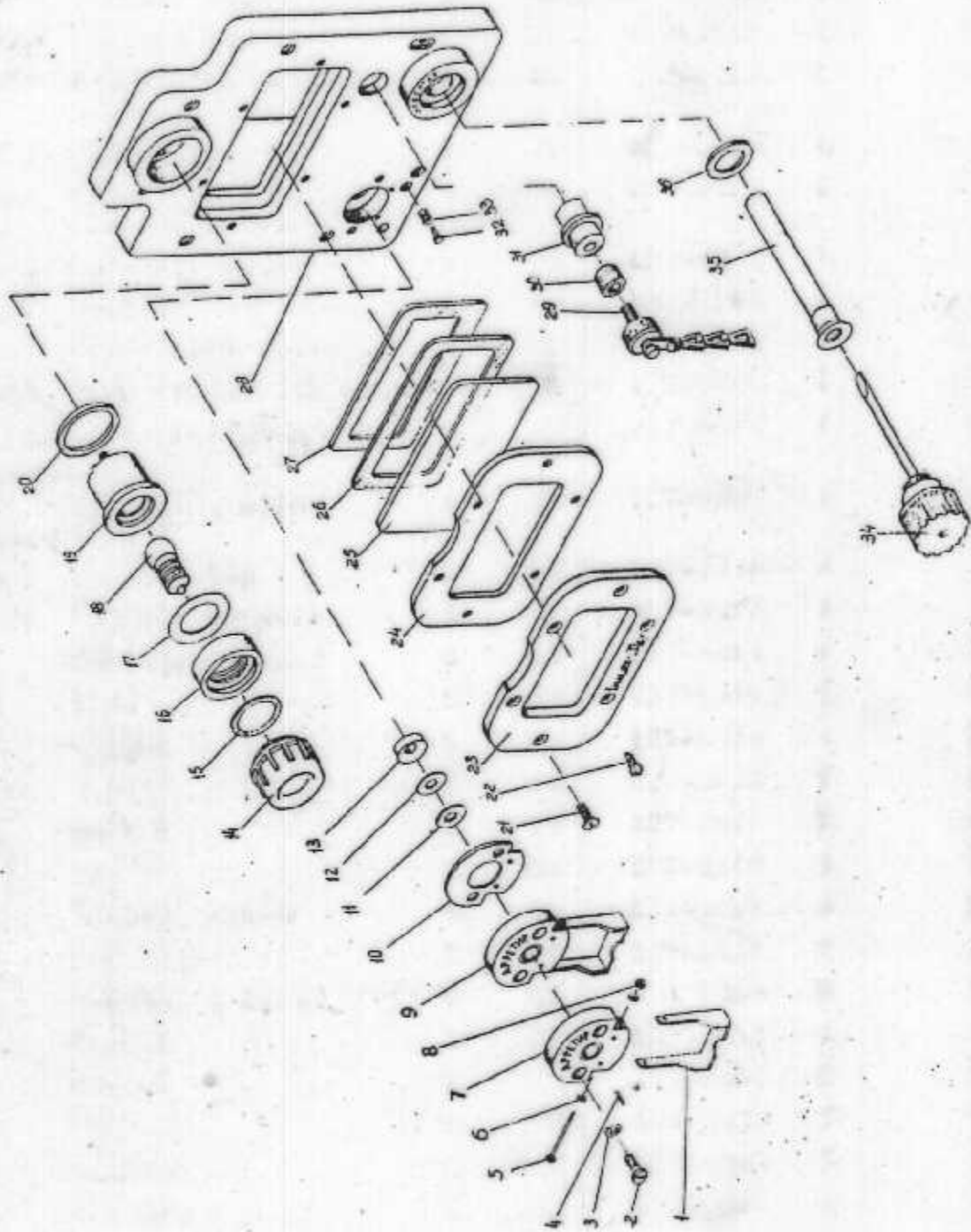

Fig. 4. Front wall with Components 127-c.65.

~~Итого: 127-065~~

1	2	3	4	5	6	7	8
127-cd7	Contact tap	5	62	127-cd18	2	0,2	
127-cd9	Contact tap	5	64	127-cd18	I	0,2	
127-cd12	Contact tap	5	37	127-cd22	I	0,9	
127-cd15	Frame with components	5	44	127-cd14	I	143	
127-cd18	Gyro unit	5	45	127-cd14	I	562,5	
127-cd19	Gyromotor body with nozzles	5	55	127-cd18	I	58,2	
127-cd20	Gyrounit cover	5	49	127-cd18	I	23,4	
127-cd22	Unit of contacts	5	42	127-cd14	I	4	
127-cd25	Frame with axles	5	13	127-cd15	I	98	
127-cd28	Cage frame with tooth	5	12	127-cd15	I	16,83	
9 5.617.	Collector 9 5.617.000	5	17	127-cd15	I	2,9	
160-cd14	Cage ring with struts	5	3	127-cd15	I	11	
160-cd22	Contact tap	5	35	127-cd22	2	0,9	
160-cd71	Contact support	5	41	127-cd22	I	1,4	
127-2	Corrugated band	5	28	127-cd14	2	0,08	
127-25	Stud	5	67	127-cd18	I	0,66	
127-39	Weight	5	25	127-cd14	4	3,39	
127-cd40	Weight	5	24	127-cd14	7	1,67	
127-43	Weight	5	23	127-cd14	7	0,85	
127-45	Cam	5	56	127-cd18	I	7,5	
127-46	Special screw	5	58	127-cd18	I	2,8	
127-50	Bushing	5	29	127-cd14	2	2,8	
7-57	Balancing load	5	51	127-cd18	6	1,6	
127-59	Gasket	5	61	127-cd18	I	0,02	
127-61	Gasket	5	63	127-cd18	3	0,05	Adjusting
127-66	Nut	5	59	127-cd18	I	1,67	
127-67	Bracket	5	48	127-cd18	I	1,12	
127-68	Bushing	5	66	127-cd18	I	0,11	
127-69	Gasket	5	65	127-cd18	3	0,12	Adjusting
127-82	Clamp	5	68	127-cd18	I	0,24	
127-84	Gyrounit stop	5	18	127-cd14	I	0,46	
127-86	Nut	5	1	127-cd15	I		
				127-cd14	2	0,23	
127-87	Protective washer	5	15	127-cd15	I	0,28	
127-93	Thrust spring	5	8	127-cd15	I	0,65	
9 7.021.010	Card	5	21	127-cd14	I	37	
9 8.383.015	Spring	5	60	127-cd18	I	0,18	

1	2	3	4	5	6	7	8
160-33	Insulation washer	5	34	127-cd22	3	0,05	
160-34	Washer	5	33	127-cd22	5	0,017	Adjusting.
160-39	Gasket	5	36	127-cd22	3	0,045	
160-56	Axle	5	11	127-cd15	1	2,9	
160-57	Special washer	5	9	127-cd15	2	0,4	
160-75	Wire	5	4	127-cd15	2	0,029	
160-95	Washer	5	32	127-cd22	1	0,15	
160-86	Special screw	5	31	127-cd22	1	0,7	
160-112	Gasket	5	43	127-cd14	1	0,36	Adjusting.
160-265	Thrust screw	5	6	127-cd14	2	0,43	Adjusting.
160-29	Threaded bushing 160-329	5	69	127-cd18	1	0,9	
160-330	Lock nut 160-330	5	70	127-cd18	1	0,5	
160-332	Special nut	5	5	127-cd15	2	0,26	
252-193	Thrust screw	5	7	127-cd15	2	0,43	Adjusting.
953-40	Lock nut	5	30	127-cd14	2	2	
953-116	Protective washer	5	26	127-cd14	2	0,2	
132.03. 83.013	Balancing screw	5	47	127-cd13	1	2	
3yII-53- 28	Special screw	5	53	127-cd13	1	0,63	

Standard Items

27 upKM 3-I II	Washer ГОСТ 6402-70	2760KM43	5	22	127-cd14 127-cd18	4 3	0,026
3157A-2-3	Screw		5	46	127-cd18	2	0,16
3157A-2-6	Screw		5	20	127-cd14 127-cd18	9 3	0,22
3157A-2, 5-8	Screw		5	38	127-cd14	2	0,47
3320A-2,5	Nut		5	50	127-cd18	5	0,3
3402A-0, 5-2-4,5	Washer		5	19	127-cd14 127-cd15	9 2	0,06
3402A-0, 5-2,5-5,5	Washer		5	39	127-cd14 127-cd18	2 5	0,07
3481A-IC ₃ - 6	Cylindrical pin		5	40	127-cd14	2	0,037

1	2	3	4	5	6	7	8
3484A-0, 8C ₃ -5	Cylindrical pin	5	54	127-cd18	I	0,02	
3484A-I, 6C ₃ -6	Cylindrical pin	5	57	127-cd18	2	0,095	
3494A-I- 10	Tapered pin	5	10	127-cd15	2	0,075	

Commercial Items

5-23yM	Bearing	5	27	127-cd14	2	1,56	
5-6005KI	Bearing	5	2	127-cd15	I	4,9	
5-10000 95y	Bearing 5-10000	5	14	127-cd15	I	2,5	
359.00. 00.000	Gyromotor	5	52	127-cd18	I	450	

I-1052

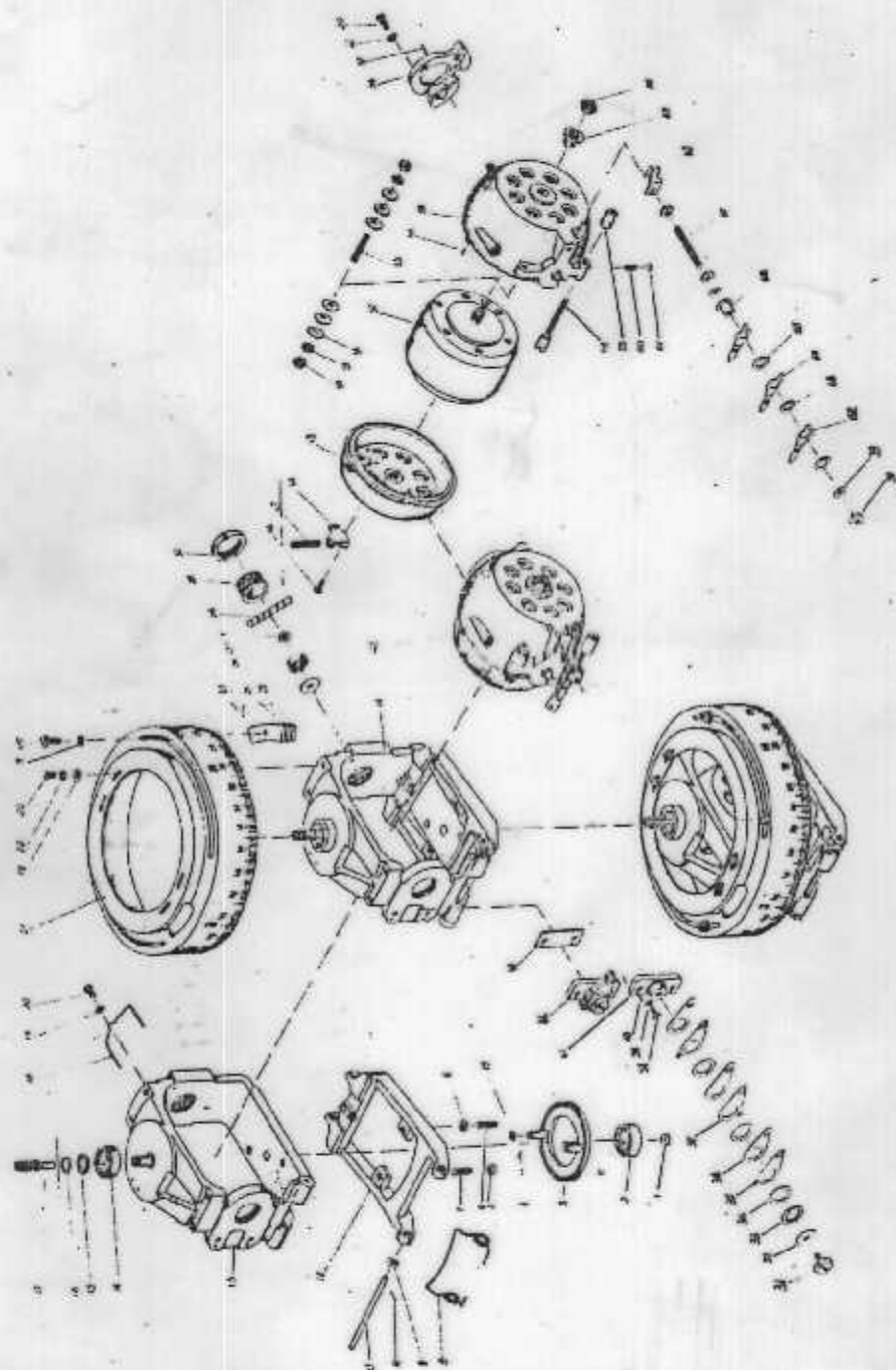

Fig. 5. Gimbal unit 127.Сб14.

~~Рис. 5. Узел-серванто 127-Сб14~~

(1)

CONTENTS.

1. Introduction
2. Units and parts of the article
 - 2.1. Electrical directional gyro ГПК-59 (fig.2)
 - 2.2 Body with compenents 127-Cd1 (fig.3)
 - 2.3. Front wall with parts 127-cd5 (fig.5)
 - 2.4. Gimbal assembly unit 127-cd14 (fig.5).