

2

THIS DOCUMENT AND THE INFORMATION CONTAINED IN IT ARE PROPRIETARY AND CONFIDENTIAL TO OFTI. NO PERSON OR ENTITY IS ALLOWED TO COPY, REPRINT, REPRODUCE OR PUBLISH ANY PART OF THIS DOCUMENT, NOR DISCLOSE ITS CONTENTS TO OTHERS, NOR MAKE ANY USE OF IT, NOR ALLOW OR ASSIST OTHERS TO MAKE ANY USE OF IT, UNLESS BY THE PRIOR WRITTEN EXPRESS AUTHORIZATION OF OFTI AND THEN ONLY TO THE EXTENT AUTHORIZED.  
 COPYRIGHT © OFTI.

NOTES:

1. INTERPRET THIS DRAWING IN ACCORDANCE WITH ASME Y14.100M.
2. MATERIAL: ALLOY STEEL BAR RND SAE 4130 NORMALIZED PER SAE-AMS-S-6758 OR SAE 4340 NORMALIZED PER SAE-AMS-S-5000.
3. UNLESS OTHERWISE SPECIFIED, UNDEFINED MACHINED FILET RADII SHALL BE 0.2...0.3
4. DEBURR AND REMOVE SHARP EDGES, APPROX. 0.2X45 Deg. BEFORE COATING.
5. ALL DIMENSIONS ARE AFTER HEAT TREATMENT AND GENERAL TOLERANCES ACCORDING TO ISO 2768-m.
6. HEAT TREATMENT TO 35 ± 3 HRC PER AMS 2759/1.
8. COATING: A DRY FILM LUBRICATION IN A FLUOROPOLYMER ORGANIC RESIN CLASS 2 COLOR MATTE BLACK TYPE I; 5-13 MICRON THICK PER VS-1-3-1-165 (OR EQUIVALENT).
- 8.1. PROTECT THREAD AFTER PHOSPHATE.
9. QUALITY ASSURANCE PROVISIONS:  
 9.1. QUALITY ASSURANCE PROVISIONS FOR THIS ITEM PER RDM000012P
10. PARENTHETICAL FIGURES ARE FOR REFERENCE ONLY.
11. PACKAGING AND PACKING: THE FINISHED PART SHALL BE PRESERVED AND PACKAGED IN ACCORDANCE WITH MANUFACTURER'S BEST COMMERCIAL PRACTICE.
12. IDENTIFY PER MIL-STD-130 PARA 4.1 B, BY LABELING ITS CONTAINER WITH THE PART NUMBER, CHARACTERS MINIMUM TEXT HEIGHT 1.25 MM.

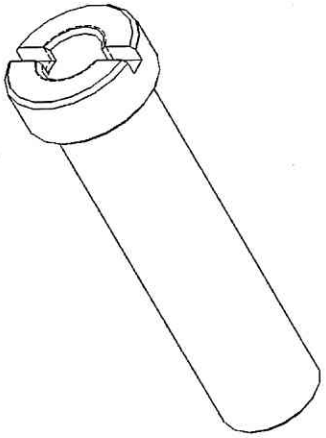

(WEIGHT: 0.025 Kg APPROX.)

2

1

DWG NO: 066427A-00  
 SHEET REV RECORD  
 ALL SHEETS ARE THE SAME REVISION

REV	ECO	DESCRIPTION	DATE	APVD
01		Freeze	06-Sep-12	
02		Freeze	28-Nov-13	
03		Restricted	28-May-14	L. Goldstein
04		Restricted	18-Sep-14	D. Nave
TO0056 Identical To Previous			09-Apr-18	L. Goldstein

1

REVISION RECORD

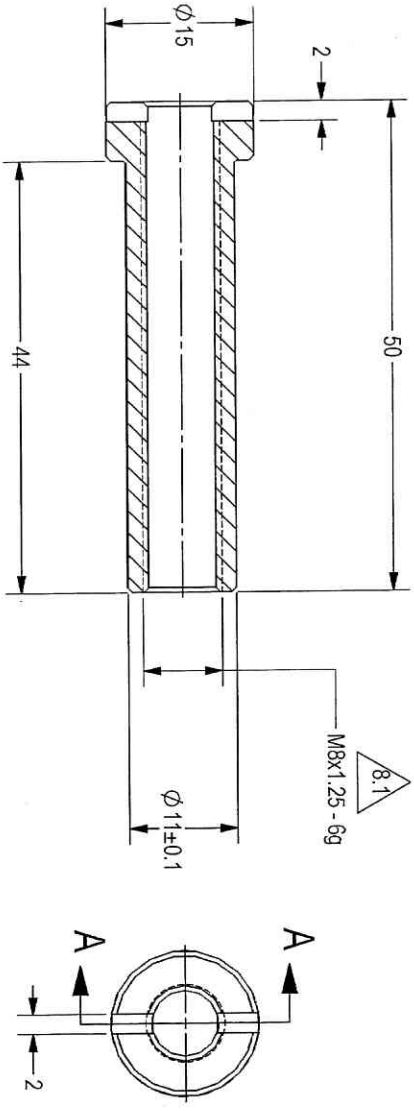

SECTION A-A

SEE ATTACHED MEDIA

32/

26-11-2020

UNLESS OTHERWISE SPECIFIED		DRAWN		SIGNATURE		DATE	
DIMENSIONS ARE IN MM PER ASME Y14.5M - 1994		CHECKED		A. Z...		11/10	
TOLERANCES		HOS/DOO		OFFICER/PRODN		OFFICER/DO	
LINEAR		SEE NOTE 6		OFFICER/OC		OFFICER/DO	
ANGULAR		SEE NOTE 6		OFFICER/DO		OFFICER/DO	
1st ANGLE PROJECTION		SURFACE TEXTURE IN Micro Meter		PROJECT OFFICER		PLM Control	

ORDNANCE FACTORY  
 TRICHIRAPPALLI

TITLE  
 SLEEVE LIMITER

SIZE  
 2291A

SCALE 2:1  
 AUTOMATED DRAWING (SD)

SHEET 1 OF 1

A

B

42026 - 7490315208