

OFB

NOTE:

1. CHAMFERED 1x45°

ORDNANCE DEVELOPMENT CENTRE  
 COMPANY PROPRIETARY INFORMATION  
 USE OR DISCLOSURE IN WHOLE OR  
 IN PART SHALL NOT BE MADE  
 WITHOUT THE WRITTEN PERMISSION  
 OF OFB

केवल लिखित हेतु  
 क्रमांक भीम पर 380157  
 दिनांक 24-04-2018

99 ref.

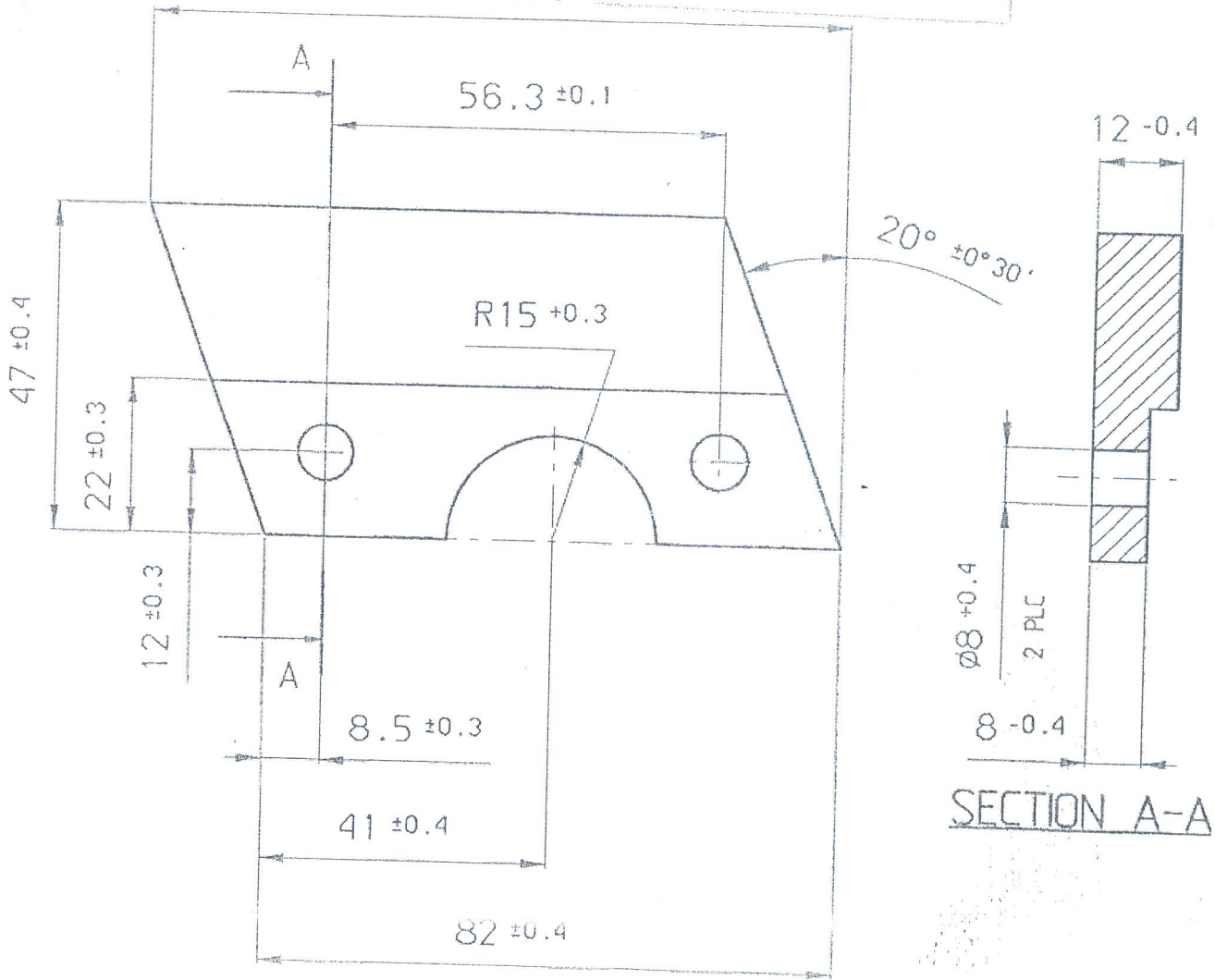

12.5/  
 ∇

DATE: 01.01.2007	ALTERNATE/INDIGENOUS MATERIAL SPCN: IS:1875-1978 CLASS-2 (REF: CQA(W) JABALPUR LN. 3B2402/CQAW/11 Dt. 12 JULY 2005)	177 JWM/CDD
---------------------	--	----------------

ID No. 2005  
 Location 01/04/01

18912-W  
 Dt. 27-5-2005  
 DRAWING SEALED  
 CQA (W), JABALPUR

MACHINING INSTRUCTIONS UNSPECIFIED TOLERANCES FOR DIMENSIONS AND ANGLES DIMENSIONS
ANGLES
HEAT TREATMENT
FINISH PHOSPHATE COATING ACCORDING TO DDD-P-16232 TYPE M CL. 2
MATERIAL 110x60 PLATE 16 DIN 1543-st.37-2

SHARANG 130/155MM_UG_OFB_SLB	UPDATED Sh: 1 of: 1
PART NO.	1:1 A4 SCALE SIZE
ASSEMBLY 176-1002	
NAME LOCKING PLATE	

PREP GHD JWM/DO	DO/DO DIR/ODC
APPROVED	
ORDNANCE DEVELOPMENT CENTRE, OFC, KANPUR	
PART NO. 176-1481	