

MCT-1403/5

MCT-1404/1 - 1 OFF.

* SCREW C'SK. HD. STEEL M4.0 x 18 LG.
IS: 1365 - 1978 - - - - 2

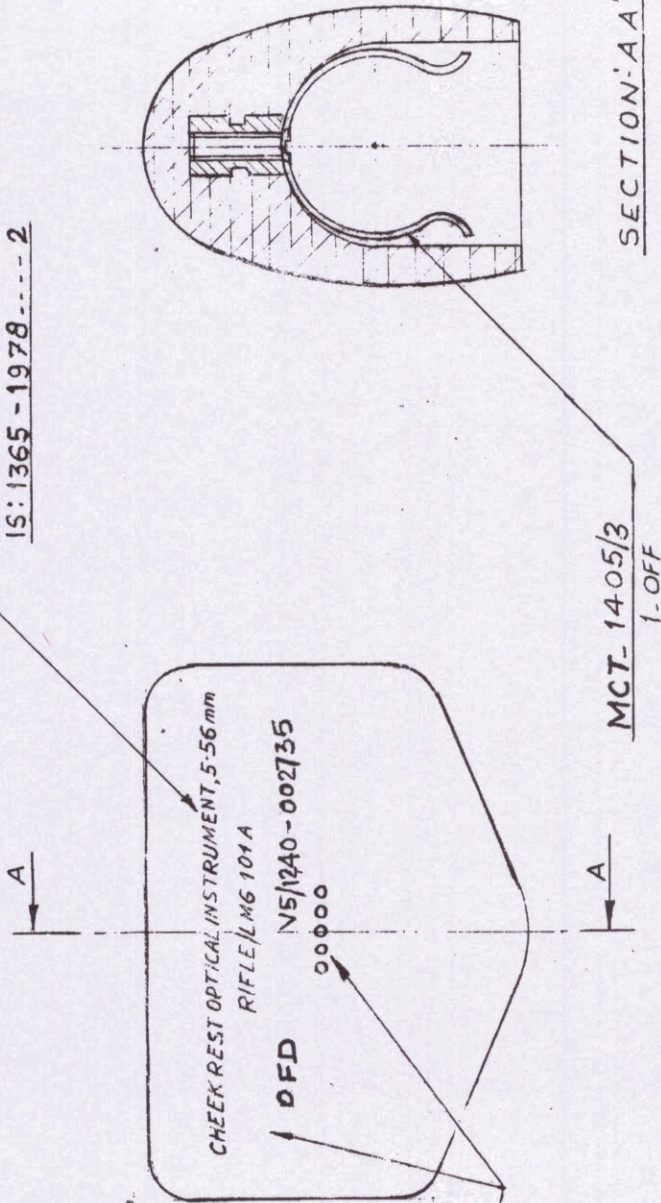

SECTION 'A-A'

MCT-1405/3
1-OFF

* TO BE ENGRAVED
& FILLED IN WHITE
EMBOSSED
IN SUITABLE
SIZE

NOTE:-
00000 YEAR OF SUPPLY.

ICA TRADE OEM
Date of Issue: 11/02/2014

ORD. FY.		DR. CP/05/14		D.A. NO. 23/2014	DT. 9/11/2014	D/-30-11-95	SCALE 1:1
DE HRADUN		TR. CH		D.A. 3/2001	DT 15-5-2001	MATL	TREAT
		APPROVED		D.A. NO. 14	DT. 25/02/2003	SEE DETAIL	SEE DETAIL
		AWM/PL-2		D.A. NO. 12/97	DT. 16-3-97	REF. - JMM/PL	DS/95 DT. 29/95
		1/CDO		D.A. NO. 13/95	DT. 17.6.96	SHTS. 1	SHT. NO. 1
				AMENDMENTS		DRG. NO.:- MCT-1403/5	
				DFD/BO/1002			
CHEEK REST OPTICAL INSTRUMENT							
5.56 mm RIFLE/LMG 101A							
DIMENSIONS ARE IN MM							

DRG. No 18 DE 2628.

TESTS :-

- THE CHEEK REST SHOULD NOT SHOW ANY SIGN OF CRACKING/DEFORMATION.
1. WHEN A LOAD OF 50 Kg. IS GRADUALLY APPLIED ON SIDE AS SHOWN.
 2. WHEN SUBJECTED TO - 50°C FOR 12 HOURS AND TESTED FOR 50 Kg. LOAD AS SHOWN.
 3. WHEN SUBJECTED TO +60°C FOR 12 HOURS AND TESTED FOR 50 Kg. LOAD AS SHOWN.
 4. WHEN SUBJECTED TO STANDERD DROP TEST.

SCALE 1:2

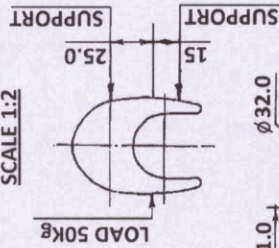

CHAMFERED 1.3 AT 45°

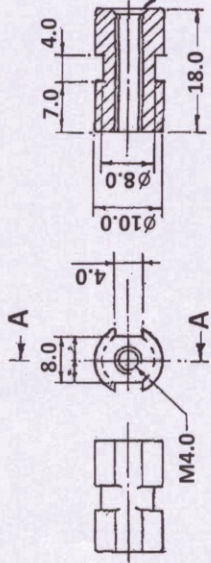

SECTION A-A

SCALE 2:1

INSERT 'A'

2-OFF

MATL.- STEEL, Gde- 40C8 TO IS:1570(Pt-2)1979
FINISH- PHOSPHATISED CLASS 'B', IS:3618-1966

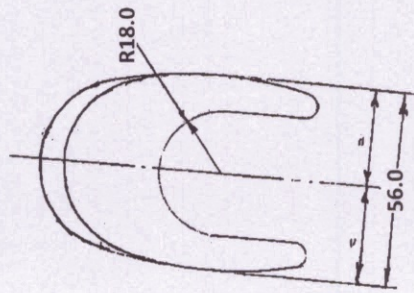

VIEW IN DIRECTION 'Z'

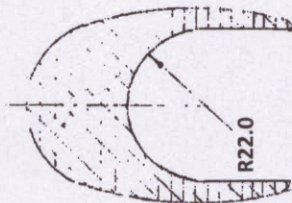

PART SECTION B-B

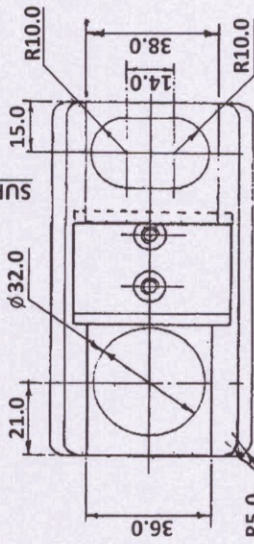

VIEW IN DIRECTION 'X'

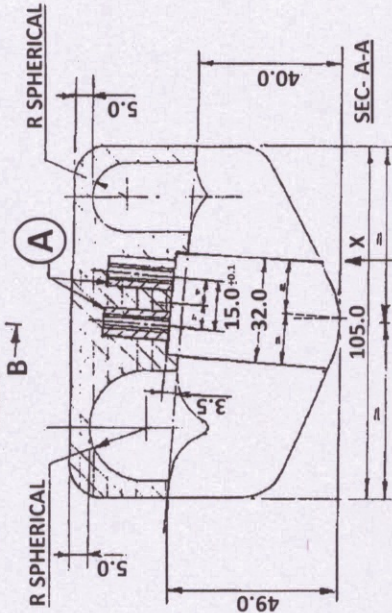
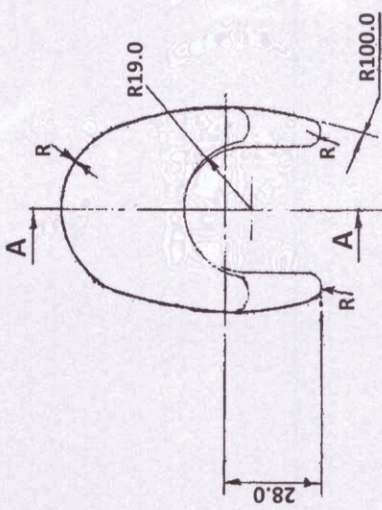
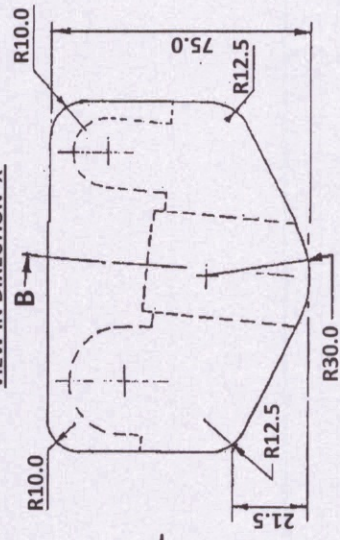

SEC-A-A

FOR TRADE ONLY
Date of Issue: _____

MATL.- TUFNYL ST-635 NYLON OR EQUIVALENT.
FINISH- VAPOCURE MATT FINISH LEAF BROWN TO IS:5-1978
No. 489/MRF SHADE No.,407.

DT.- 01.12.95	SCALE-NTS
MATL. AS ABOVE	FINISH AS ABOVE
D.A. NO.- 30/2018, DT-08.12.2018	SHEETS- 1
D.A. NO.- 12/97, DT-16.03.1997	SHEET NO.- 1
AMENDMENTS	DRAWING NO.-
OFD/DO/002	MCT-1404/1

CHEEK REST OPTICAL INSTRUMENT 5.56 mm. RIFLE/L.M.G. 101A

BLOCK

DRG. No. IRDE-2628/1	<p>आयुध निर्माजी देहरादून.</p> <p>संस्थान - दे.सं. १३ अवस्थान - जालंधी आयुधोदित प्र/आ.आ</p>
----------------------	---

CHEEK REST OPTICAL INSTRUMENT 5.56MM RIFLE/LMG 101A.

DRG. No: IRDE-2628/2

CLAMP

2 HOLES ϕ 6.6 P.C'S K TO 8.0

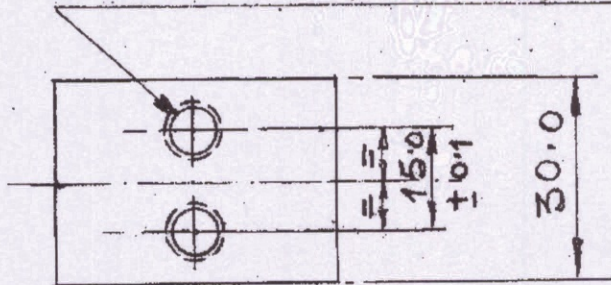

FOR TRADE OFF
Date of Issue: _____

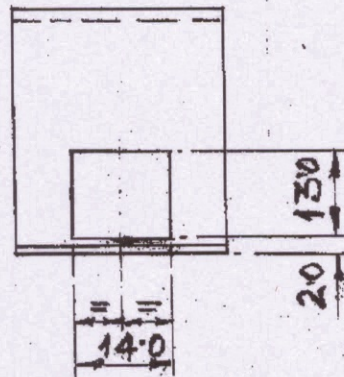
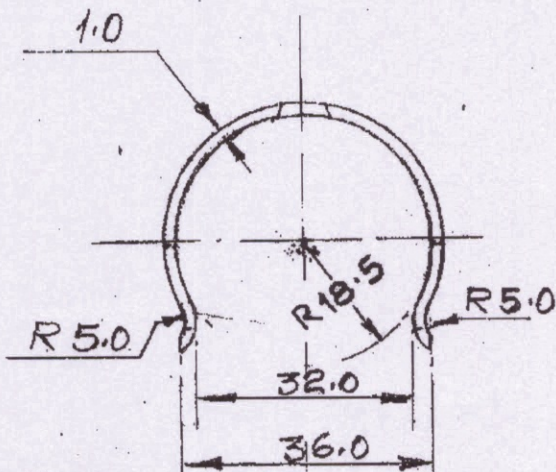

* MATL. & SPECN-

STEEL B.S. 1449 Pt. I, 1972 C-80 OR IS: 2507-1975 Gde. 6 -
DESIG. 80 C6 HARDENED AND TEMPERED 400-450 VPN.

PROTECTIVE FINISH-

DULL NICKLE CHROMIUM PLATED / CADMIUM PLATED.

		DT/-30-11-95	SCALE-1:1
		MATL AS ABOVE	TREAT. AS ABOVE
*D.A. No 32/2013 Dt 5/12/2013	DR - <i>mas</i>	JWM MEMO NO REF:- PO/DS/95/BL 29-11-95	
DA 3/2001 DT 15-5-2001	TR -	SHTS - 1	SHT. NO 1
D.A. No 12/97 dt. 16.3.97	CH - <i>hist</i>	DRG. No	
AMENDMENTS	APPROVED	MCT-1405/3	
OFD/DO/002	<i>11CDO</i> <i>AJM/PL-2</i>		

DRG. No: IRDE-2628/2