

DRG. No. GCF/50/41049

ALL DIMENSIONS ARE IN mm UNLESS OTHERWISE STATED

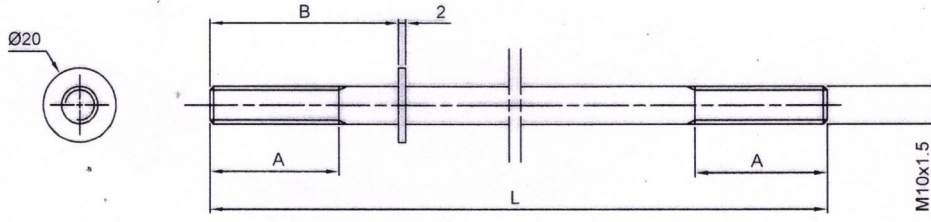

Sl. No.	Nomenclature	L	A	B	Material	Qty.
1	Stud 1	275	45	60	Stainless Steel Gd. 304	2
2	Stud 2	230	25	40	Stainless Steel Gd. 304	1

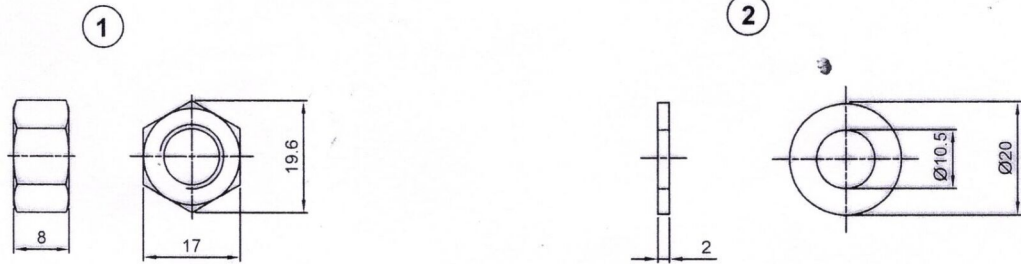

Sl. No.	Nomenclature	Description	Material	Qty.
1	Nut	M10x1.5	Stainless Steel Gd. 304	6
2	Washer	M10	Stainless Steel Gd. 304	6

P.No.	NOMENCLATURE	No. OFF	MATERIAL	HARDNESS	STANDARD	REMARKS
GEN. TOL. NOT SPECIFIED						FOR Sr. GM G.C.Fy.
LINEAR DIMENSIONS						
0-6	±0.1					2021 NAME DATE
6-30	±0.2					DRN. DEEPAK 07/12
30-120	±0.3					CKD.
120-315	±0.5					
315-1000	±0.8					
1000-2000	±1.2					
ANGULAR DIMENSIONS		INDEX	AMENDMENTS	SIGN	DATE	APPROVED <i>ds</i> <i>alr</i>
0-10°	±1'					
10-50°	±30					
50-100°	±20'					
>100°	±10'					
~ UNMACHINED	▽ ROUGH	<h2 style="text-align: center;">STUD AND NUT</h2> <h3 style="text-align: center;">FOR BATTERY COVER</h3> <p style="text-align: center;">FOR</p> <h3 style="text-align: center;">INDEGENOUS APU 155mm DHANUSH</h3> <p style="text-align: center;">GUN CARRIAGE FACTORY, JABALPUR</p>				MATERIAL
▽ SMOOTH	▽▽ FINISH					SCALE
						ASSY/SUB ASSY NO.
						SHEET NO. OF SHEETS

DRG No. GCF/50/40434

DRAWING CONVENTIONS CONFORM TO SP-46-1988. DIMNS. ARE IN mm. UNLESS OTHERWISE STATED.

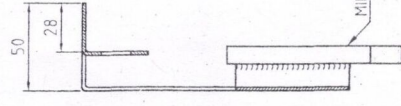
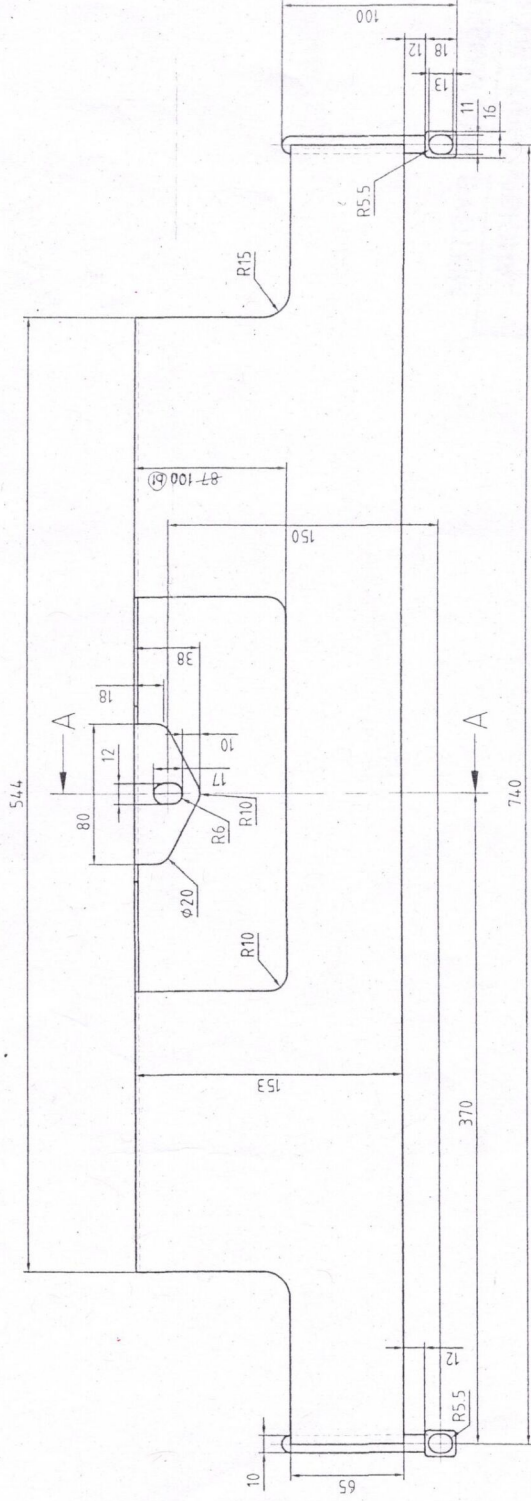
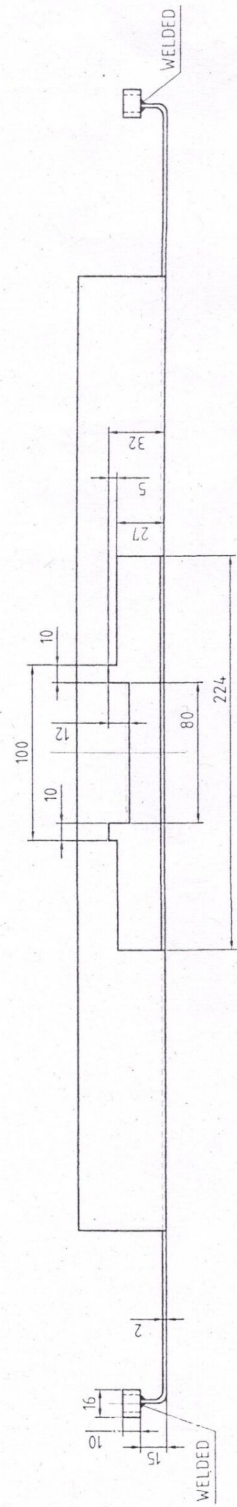

SECTION A-A

09

PT No.	NOMENCLATURE	No. OF	MATERIAL	HARDNESS	STANDARD	SIZE	REMARKS																										
1	COVER PLATE	1	MILD STEEL																														
<table border="1"> <tr> <td>FOR Sr. GM GCFX</td> <td>DATE</td> <td>APPROVED</td> </tr> <tr> <td>2019</td> <td></td> <td></td> </tr> <tr> <td>DRN</td> <td>EC-10-13</td> <td></td> </tr> <tr> <td>EXTD</td> <td></td> <td></td> </tr> <tr> <td>3rd/1st</td> <td>SIGNATURE</td> <td>DATE</td> </tr> <tr> <td></td> <td></td> <td>14/06/20</td> </tr> <tr> <td>INDEX</td> <td>AMENDMENTS</td> <td>SIGN</td> <td>DATE</td> </tr> <tr> <td></td> <td></td> <td></td> <td></td> </tr> </table>								FOR Sr. GM GCFX	DATE	APPROVED	2019			DRN	EC-10-13		EXTD			3rd/1st	SIGNATURE	DATE			14/06/20	INDEX	AMENDMENTS	SIGN	DATE				
FOR Sr. GM GCFX	DATE	APPROVED																															
2019																																	
DRN	EC-10-13																																
EXTD																																	
3rd/1st	SIGNATURE	DATE																															
		14/06/20																															
INDEX	AMENDMENTS	SIGN	DATE																														
<table border="1"> <tr> <td>SCALE</td> <td>REF. DRG.</td> </tr> <tr> <td>N.T.S.</td> <td>REF. DRG. No. 40434.5</td> </tr> <tr> <td colspan="2">DRG. No. GCF/50/40434</td> </tr> <tr> <td colspan="2">SHEET NO. OF SHEETS</td> </tr> <tr> <td colspan="2">8</td> </tr> </table>								SCALE	REF. DRG.	N.T.S.	REF. DRG. No. 40434.5	DRG. No. GCF/50/40434		SHEET NO. OF SHEETS		8																	
SCALE	REF. DRG.																																
N.T.S.	REF. DRG. No. 40434.5																																
DRG. No. GCF/50/40434																																	
SHEET NO. OF SHEETS																																	
8																																	

(b) 3mm THK RUBBER SHEET TO BE FIXED BELOW THE PLATE.

MATL. IS IS-513-1994, COLD ROLLED AND ANNEALED, BEST SURFACE TYPE DD.

SHARP CORNERS TO BE ROUNDED OFF.

NOTE:- TO BE PHOSPHATED FOLLOWED BY PAINTED WITH WHITE PAINT - MATT FINISH.