

**DRG. NO. 2614 7080 3201**

ALL DIMENSIONS ARE IN m.m.

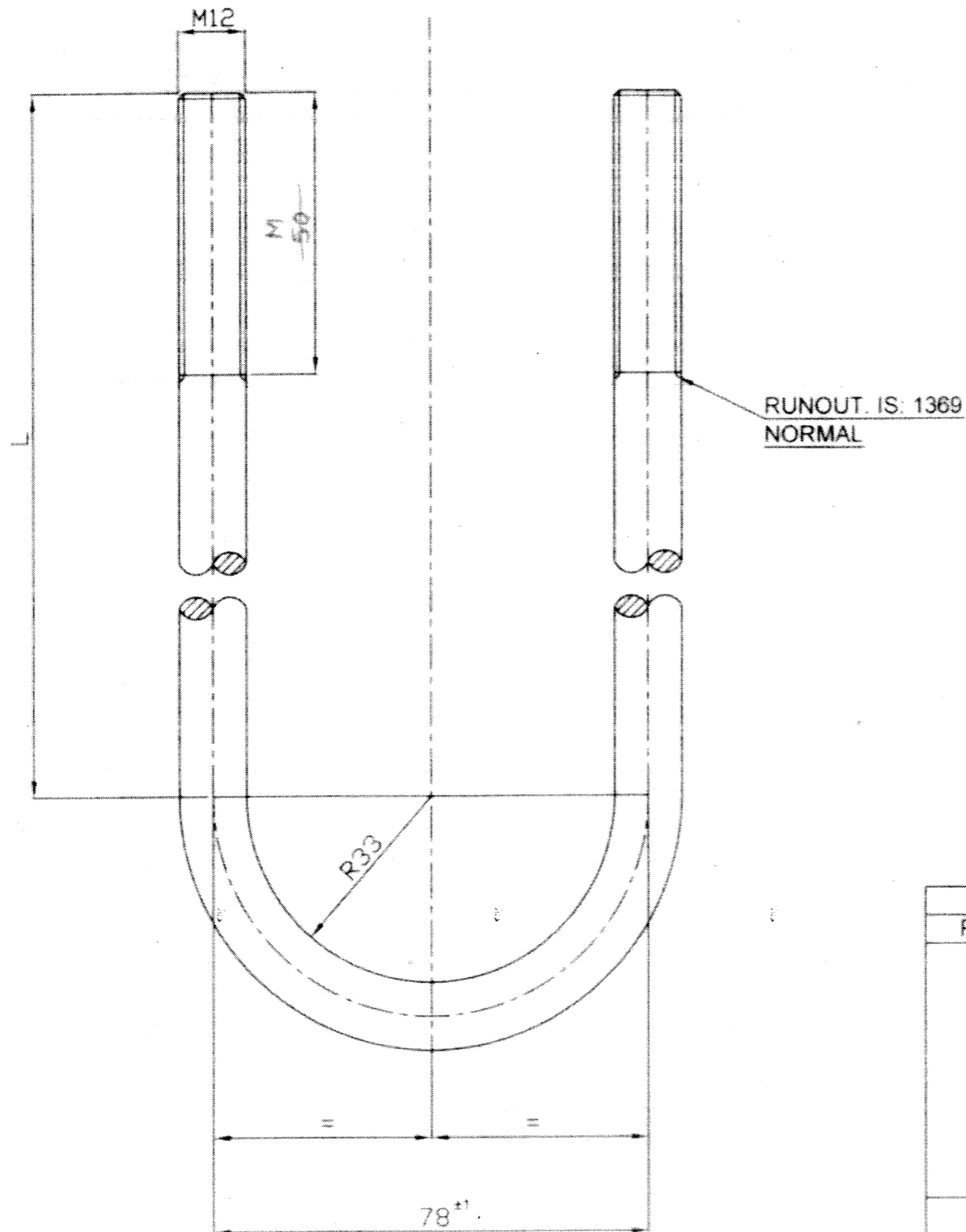

PART NO.	DIMN. 'L'	DIMN - M
2614 7080 3202 N	340	50
2614 7080 3203 N	310	65
2614 7080 3204 N	285	50

V2

**MATERIAL:- RD 11 BRIGHT 27 C 15 SS: 4029 OR  
RD 12.3 BRIGHT AISI 1146 SS: 4023**

**NOTE:-**

**TO BE ZINC PLATED AND YELLOW CHROMATE PASSIVATED TO IS: 1573,  
PLATING THICKNESS 5 MICRONS MINIMUM. THREADS TO BE RETAPPED  
AFTER PLATING AND PASSIVATION AND OIL TO BE APPLIED ON  
RECUT THREADS.**

**SURFACE PROTECTION AS PER STD. SS 8451 - 21**

PART NO.	DESCRIPTION	MATERIAL	NO. OFF	DRG. NO.	DIFFERENCE
				Date	Name
				Drawn	
				Traced	25.01.06 M SAHA
				Checked	25.01.06
	V2 DIMN. 'M' Added.	28.01.06		JWM	25.01.06
	DRG. RETRACED.	25.01.06		Shop	
INDEX	ALTERATION	DATE	JWM	D.O	AWM/CSS
~ Unmachined	Description:	<b>'U' BOLT</b>		SCALE	Ref Drg.
v Rough		<b>TABLE DRAWING</b>		1:1	
∞ Smooth	For:	<b>LOAD BODY</b>			
∞∞ Finish	Group:	<b>LPTA 713TC/32</b>			
⊕ C.Hard		<b>VEHICLE FACTORY</b>			
⊕ Hardened		<b>JABALPUR</b>			
⊕ GR					
				<b>2614 7080 3201</b>	
				V1	

CHG NO.