

BEARING DESIGNATION	ød	øD	b	T	r	r1	α	LIMIT DEVIATIONS IN MICRON AS PER GOST-520-71.					CLASS OF ACCURACY (GOST ETY-500)	EQUIVALENT BEARING			
								DIAMETER OF 'd' CYLINDRICAL HOLE		WIDTH OF RING.		INCONSISTENCY OF WIDTH OF RING.			RUN OF BASE END FACE RELATIVE THE HOLE.	RADIAL RUN OUT OF ROLLING TRACK.	AXIAL RUN OUT OF ROLLING TRACK.
								LOWER	UPPER	LOWER	UPPER						
46305 П	25	62	17	17	2.0	1.0	26°	-6	0	0	-120	5	8	4	8	5	KNK MAKE ⑤

⑤ JT=INDICATES CAGE IS MADE OF BRASS.

⑤ Authority:- CQA(HV) letter no. 98704/04/ID COORD/ALTCOM dtd. 23.05.2008

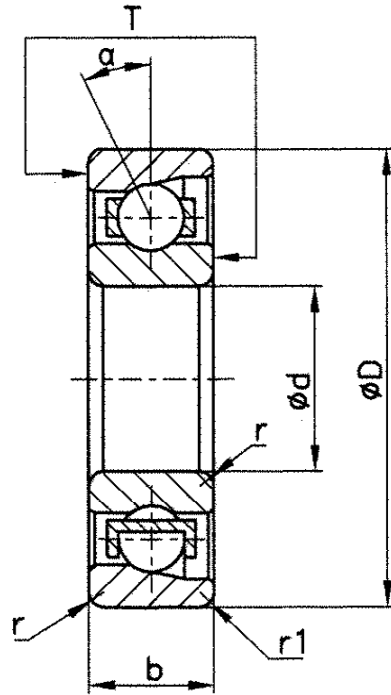

### CHEMICAL COMPOSITION

MATERIAL	C %	Si %	Mn %	Cr %	NOT MORE THAN				
					S %	P %	Ni %	Cu %	Ni+Cu %
ШX15 GOST 801-78	0.95-1.05	0.17-0.37	0.20-0.40	1.30-1.65	0.02	0.027	0.30	0.25	0.50
SAE 52100	0.95-1.10	0.20-0.35	0.25-0.45	1.30-1.60	0.025	0.025	--	--	--

THIS SKETCH ALONG WITH ALL DETAILS IS AN ABSTRACT BASED ON GOST-831-75

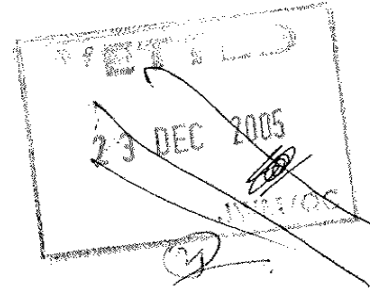

HARDNESS RC:61-65

NON-SEPARABLE TYPE WITH TAPERED OUTER RING.

ALTERNATE MATERIAL: SAE 52100

(AUTHORITY - CQA(HV), AVADI, LETTER NO. 98704/04/ID-CO-ORD/ALT COM, DATED 03/05/2005.)

#### NOTES:-

- BEARING SHOULD BE FREE FROM CRACKS, CORROSION AND ALSO GRINDING BURRS IN THE SHAPE OF SPOTS OF SECONDARY HARDENING AND SECONDARY TEMPERING.
- BEARING PARTS SHOULD BE DEMAGNETISED.
- SURFACE QUALITY IS INSPECTED BY NON-DESTRUCTIVE METHODS SURFACE QUALITY MAY BE CHECKED, WITHOUT THE USE OF MAGNIFYING DEVICES.
- ABSENCE OF SHRINK HOLES MAY BE CHECKED ON DISCS. CUT FROM TWO ENDS OF A ROD OR BUNDLE, BY MAGNETIC METHOD.

SINGLE ROW RADIAL THRUST BEARING		ШX15 GOST 801-78					
संख्या NO.OFF	विवरण DESCRIPTION	पुर्जा क्र. PART NO.	पदार्थ MATERIAL	मानक STANDARD	परिमाणु DIMENSIONS	अव्यक्ति REMARKS	
	सामान्य सहिष्णुता GENERAL TOLERANCE		②	NOTE ADDED ON 02/04/07		02/04/07	
	रेखिक परिमाणु LINEAR DIMENSION		⑤	Equivalent bearing added		10.12.08	
	0-6 ±0.1		③	DRG UPTO DATE ON. 18.6.11			
	6-30 ±0.2						
	30-120 ±0.3						
	120-315 ±0.5						
	315-1000 ±0.8						
	1000-2000 ±1.2			188-45-001 CD-3			
कोणिक परिमाणु ANGULAR DIMENSION	संख्या NO.OFF	संबंधित पुर्जा क्र. DRG. NO. OF ASSOCIATED PART	सूचक INDEX	संशोधन ALTERATION	2005	दिनांक DATE	नाम NAME
1-10 ±1°							
10-50 ±30'							
50-100 ±20'							
> 100 ±10'							
मापोंक 'म्यू एम' में VALUE IN 'um'							
~ >25							
▽ 8-25							
▽▽ 1.6-8							
▽▽▽ 0.025-1.6							
▽▽▽▽ <0.025							
SINGLE ROW RADIAL THRUST BEARING TRANSMISSION GEAR UNIT CODE - 45 / T-72 & T-90				मापमान SCALE	आरेखित DRAWN	20/09/05	
				NTS	जाँचा CHECKED	23.12.05	
					अनुमोदित APPROVED	23.12	
				द्वारा बदला REPLACED BY	हेतु बदला REPLACED FOR		
				कार्यालय OFFICE	आरेखण क्र. DRAWING NO.		
				D.O.	MPF/1GB/ 831		

इन आरेखणों तथा इसके साथ की सम्पूर्ण सामग्री का स्वत्वाधिकार भारत सरकार रक्षा मंत्रालय की भारतीय आयुध निर्माणियों के पास है। भारतीय आयुध निर्माणियों के महानिदेशक की लिखित अनुमति के बिना इनकी नकल या किसी भी रूप में इनके उद्धरण या इनमें समाहित सूचना किसी अनधिकृत व्यक्ति को उपलब्ध नहीं कराई जानी चाहिए।

THE COPYRIGHT OF THESE DRAWINGS AND ALL ATTACHMENTS THERE TO BELONGS TO THE INDIAN ORDNANCE FACTORIES, MINISTRY OF DEFENCE, GOVT. OF INDIA. THEY SHOULD NOT BE COPIED, REPRODUCED IN ANY WAY OR THE INFORMATION CONTAINED THEREIN MADE AVAILABLE TO UNAUTHORISED PERSONS WITHOUT THE WRITTEN PERMISSION OF THE DIRECTOR OF ORDNANCE FACTORIES.

मूलमाप व अन्वयोजन NOMINAL SIZE & FIT  
विचलन DEVIATION

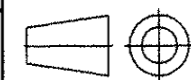

मशीनी औजार आदिरूप फैक्टरी, अम्बरनाथ  
MACHINE TOOL PROTOTYPE FACTORY, AMBERNATH