

SECTION F-F

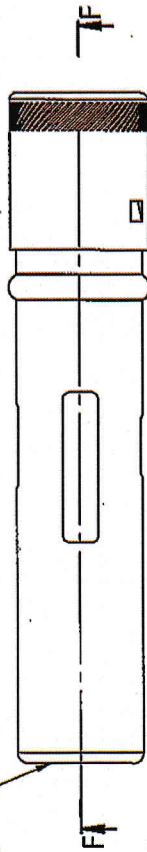
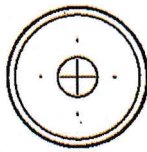

Mark
Manufacture Code
and Year

**CERTIFIED CORRECT COPY
OF APPROVED DRAWINGS
AT THIS DATE.....**

01.04.2021

Design & Drawing Office
Ordnance Factory,
Tiruchirappalli-620016

UN CONTROLLED COPY

Finish:
Paint Black Matt Finish

ITEM NO.	PART NUMBER	QTY.
2	CAP	1
1	BOX	1

SCALE NTS	SUB: BOX For Accessories	SIGNATURE & DATE.	TRACED	DRAWN	CHECKED	D/C/D&DO	OFFICER/ PRODN.	DIV.OFFICER/ D&DO	APPROVED ON. 25/11/2019	SIC.	AMENDMENTS & DATE	1
QPG 1	OF: Trichy Assault Rifle											2
Weight(g) 41.57	DES.REF.NO.											1
SHEETS: 3	DRG. No.: TAR-K-9021- 11 *	<i>P. Fort</i>										2
SHEET No.: 1	ORDNANCE FACTORY TIRUCHIRAPPALLI-16.	<i>& K</i>										1
	FT											1

* DA No 59/20. 12.3.20
Dt. 22/9/20. 12.3.20
DA No. 25/20. 12.3.20

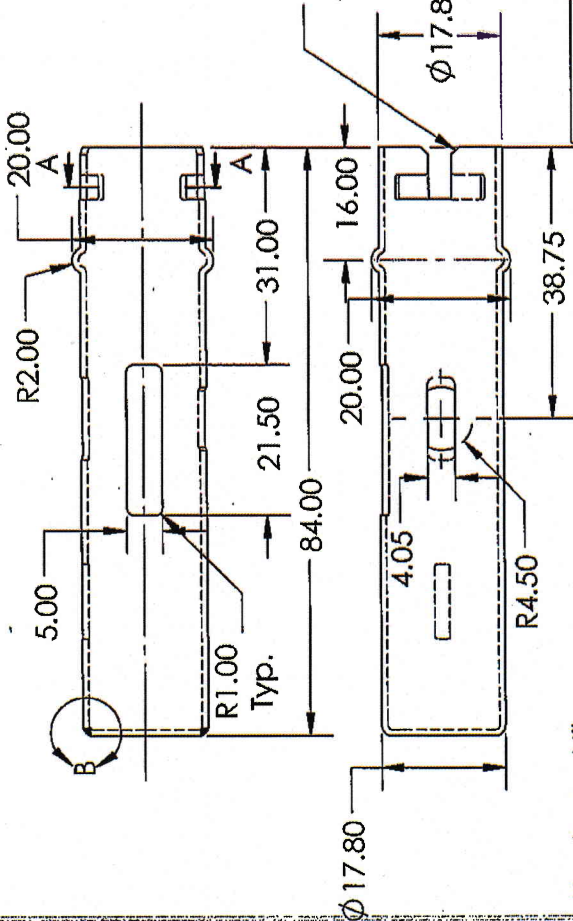
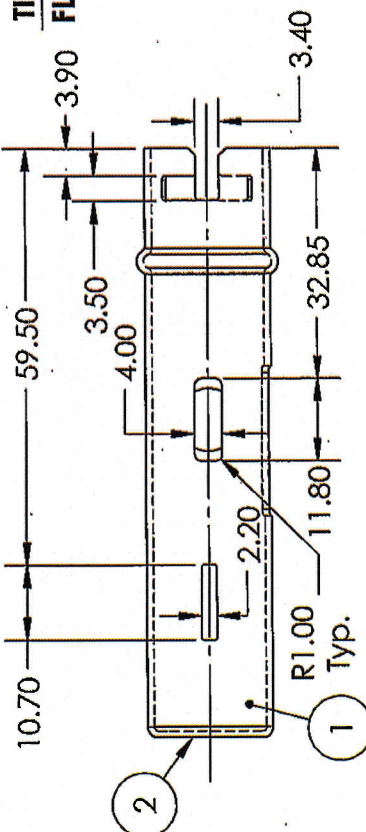
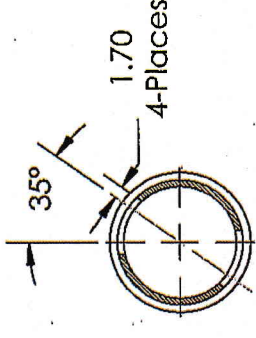
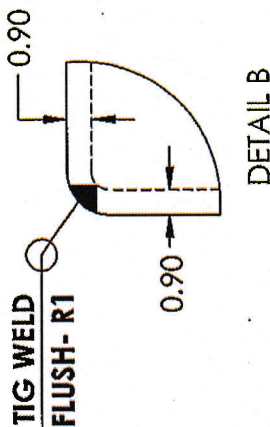
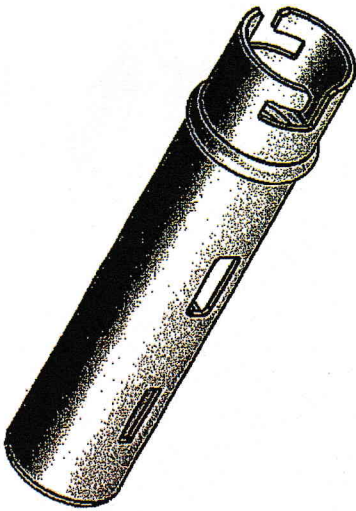

Material:-Cold Drawn Seamless Steel Tube -
 BS:6323 Pt.4 1982 Design: CFS 3 BK
 BS:6323 Pt.4 1982 Design: CFS 4 BK
 BS:6323 Pt.4 1982 Design: CFS 5 BK
 BS:6323 Pt.4 1982 Design: CFS 6 BK

IS:3074-2005 Sec.2 CDS-1, Annealed
 IS:3074-2005 Sec.2 CDS-2, Annealed
 IS:3074-2005 Sec.2 CDS-3, Annealed
 IS:3074-2005 Sec.2 CDS-4, Annealed
 IS:3074-2005 Sec.2 CDS-6, Annealed

CEW Pipes
 IS:3074-2005 Sec.2 CDS-1, Annealed
 IS:3074-2005 Sec.2 CDS-2, Annealed
 IS:3074-2005 Sec.2 CDS-3, Annealed

Steel Sheet:
 IS:513, Gr. CR1, CR2, CR3, CR4 OR CR5

UN CONTROLLED COPY
CERTIFIED CORRECT COPY
OF APPROVED DRAWINGS
AT THIS DATE.

01.04.2021
 Design & Drawing Office
 Ordnance Factory,
 Tiruchirappalli-620016

OIC/D&DO	P. Forth	SIC.	APPROVED ON.
OFFICER/PRODN.		DATE	25/11/2019
DIV OFFICER/D&DO	S. K. e		

Hardness: Nil
 Protective Finish:-
 Phosphate to Specn. JSS 0465-01:1994
 Class II, Oil Finish
 Untolerated Dimension IS:2102 Medium

ITEM NO.	PART NUMBER	QTY.
2	END PLATE	1
1	TUBE	1

SUB: Box	SCALE: NTS
FOR: Box For Accessories	QPG: 1
OF: Trichy Assault Rifle	Weight(g): 30.85
DES. REF. NO.	SHEETS: 3
DRG. No.: TAR-K-9021- 16 *	SHEET No.: 2
FT ORDNANCE FACTORY TIRUCHIRAPPALLI-16.	

CERTIFIED CORRECT COPY
OF APPROVED DRAWINGS
AT THIS DATE

01.04.2021

Designed & Drawing Office
Ordnance Factory,
Tiruchirappalli-620016

UN CONTROLLED COPY

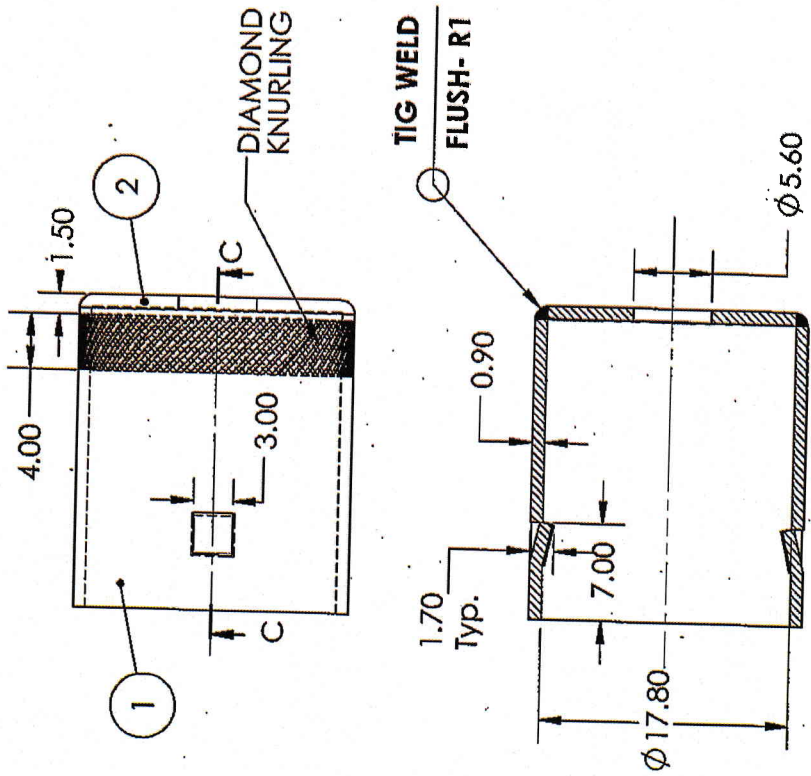

SECTION C-C
SCALE 2:1

Hardness: Nil

Protective Finish:-
Phosphate to Specn.JSS 0465-01:1994
Class II, Oil Finish

Untolerated Dimension IS:2102 Medium

2	End Plate	1
1	Tube Cover	1
ITEM NO.	PART NUMBER	QTY.

Material :- Cold Drawn Seamless
Steel Tube -

BS:6323 Pt.4 1982 Design: CFS 3 BK
BS:6323 Pt.4 1982 Design: CFS 4 BK
BS:6323 Pt.4 1982 Design: CFS 5 BK
BS:6323 Pt.4 1982 Design: CFS 6 BK

IS:3074-2005 Sec.2 CDS-1, Annealed
IS:3074-2005 Sec.2 CDS-2, Annealed
IS:3074-2005 Sec.2 CDS-3, Annealed
IS:3074-2005 Sec.2 CDS-4, Annealed
IS:3074-2005 Sec.2 CDS-6, Annealed

CEW Pipes

IS:3074-2005 Sec.2 CDS-1, Annealed
IS:3074-2005 Sec.2 CDS-2, Annealed
IS:3074-2005 Sec.2 CDS-3, Annealed

Steel Sheet:

IS:513, Gr. CR1, CR2, CR3, CR4 OR CR5

SIGNATURE & DATE:	SUB: CAP	SCALE
		NTS
TRACED	FOR: Box For Accessories	QPG
DRAWN	OF: Trichy Assault Rifle	1
CHECKED	DES. REF. NO.	Weight(g)
OIC/D&DO	DRG. No.: TAR-K-9021- 11 *	10.72
OFFICER/PRODN.	ORDNANCE FACTORY TIRUCHIRAPPALLI-16.	SHEETS: 3
DIV.OFFICER/D&DO		SHEET No.: 3
APPROVED ON: 25/11/2019	1	



3

4

5

6

A