

ORDNANCE FACTORY, DEHRADUN

L/OUT No.

**TRIPOD, FIRE CONTROL INSTRUMENT, PERISCOPE
BATTERY COMMAND BINOCULAR 20x70, 102A
TUBE, EXTENSION (LARGE)**

DRG No
IRDE 1253/1

MCT-1516

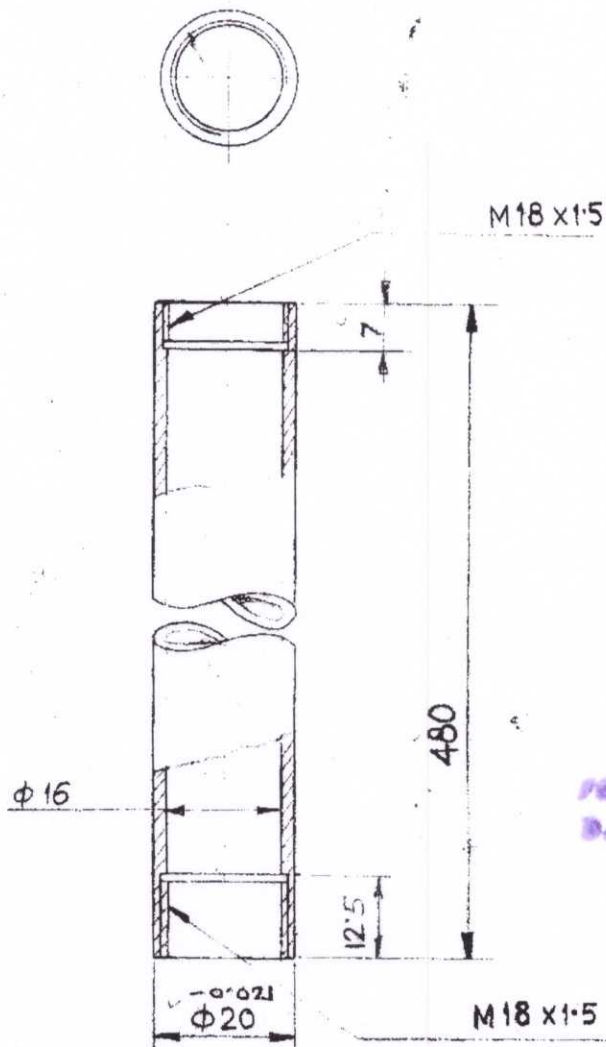

FOR TRADE USE
Date of Issue 26/09/21

Kaini

MATL:- BRASS TUBE CU Zn 37 TA OF IS:407-1981 (REAFFIRMED 1986)

FINISH:- BLACK BRONZED 38 μ MIN THICKNESS TO IS:1378 1987 .

DIMENSIONS ARE IN M/M.

IMPORTANT DIMENSIONS MARKED THUS. ⊙

INFORMATION MARKED THUS † TO BE MARKED ON.

		DATE-29 ⁵ /97	SCALE-1:1
DR- <i>Sabesh</i>		MATL. AS ABOVE	TREAT. AS ABOVE
TR-		SHEETS- 1	SHT. No. 1
CH- <i>SB</i>		DRAWING No. MCT-1516	
APPROVED			
<i>[Signature]</i> I/C D. O.			
AMENDMENTS			
OFD/DO/002			

L/OUT No.

**TRIPOD, FIRE CONTROL INSTRUMENT, PERISCOPE
BATTERY COMMAND, BINOCULAR 20x70, 102A.**

DRG. No.:-

IRDE 1253/2

SHOE

MCT-1517

ORDNANCE FACTORY, DEHRADUN

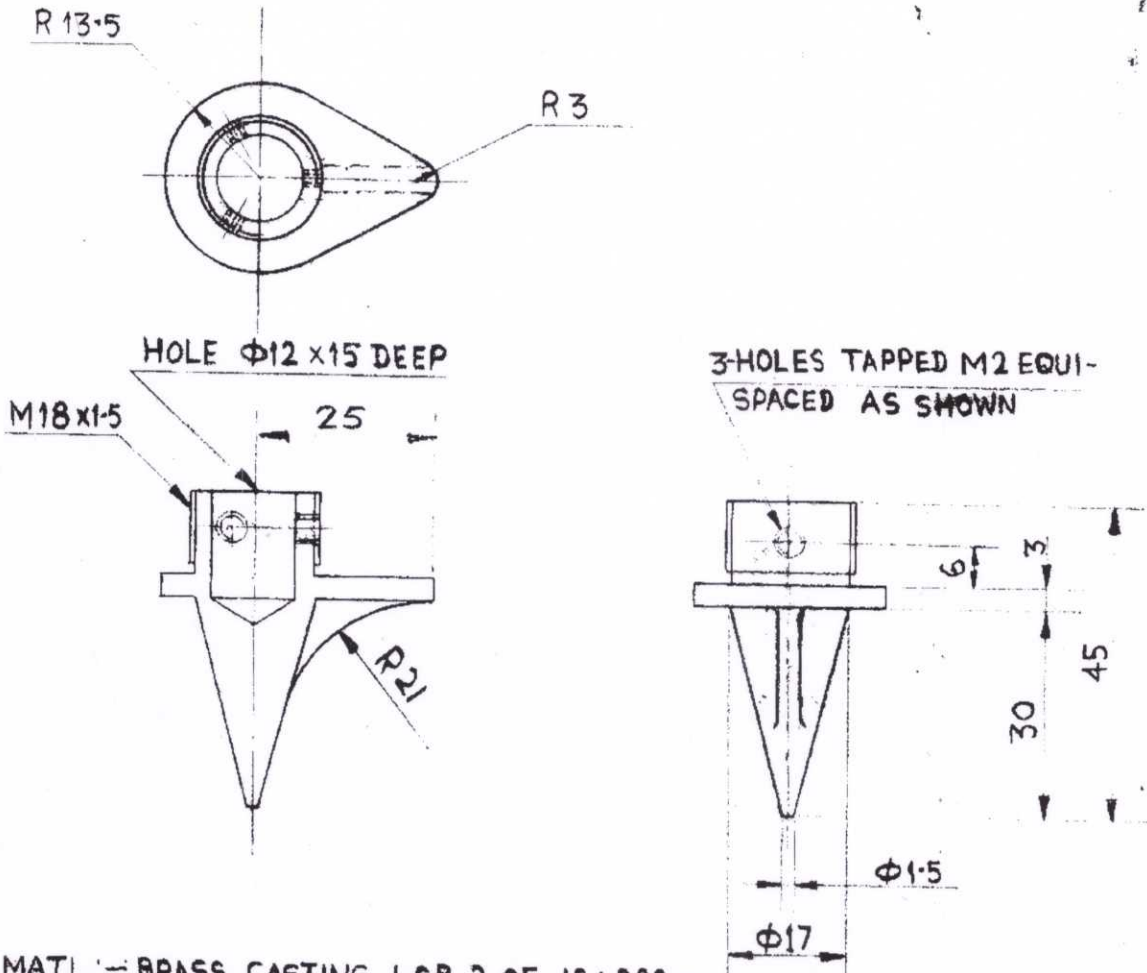

MATL:- BRASS CASTING LCB 2 OF IS: 292 - 1983 (REAFFIRMED 1988)

FINISH:- TO BE PAINTED WITH MATT ISC No. 220 OR ISC No. 225 OF IS: 188-1973 (REAFFIRMED 1988) EXCEPT BEARING SURFACES.

DIMENSIONS ARE IN M/M.
IMPORTANT DIMENSIONS MARKED THUS ϕ
INFORMATION MARKED THUS † TO BE MARKED ON.

FOR TRADE MARK
Date of Issue 26/09/21
Kaini

	DR- <i>Rehant</i>	DATE-29 ⁵ /97	SCALE-1:1
	TR-	MATL. AS ABOVE	TREAT. AS ABOVE
	CH- <i>26/09/21</i>	SHEETS-1	SHT. No. 1
	APPROVED		DRAWING No.
AMENDMENTS	<i>Sub</i>	<i>MLT</i>	MCT-1517
OFD/DO/002	V/C D. O.	WM/PL	

L/OUT No.

**TRIPOD, FIRE CONTROL INSTRUMENT, PERISCOPE
BATTERY COMMAND, BINOCULAR (20x70) 102 A.**

DRG. No. - **1RDE 1253/3**

CLAMP SPLIT (SMALL)

MCT-1518

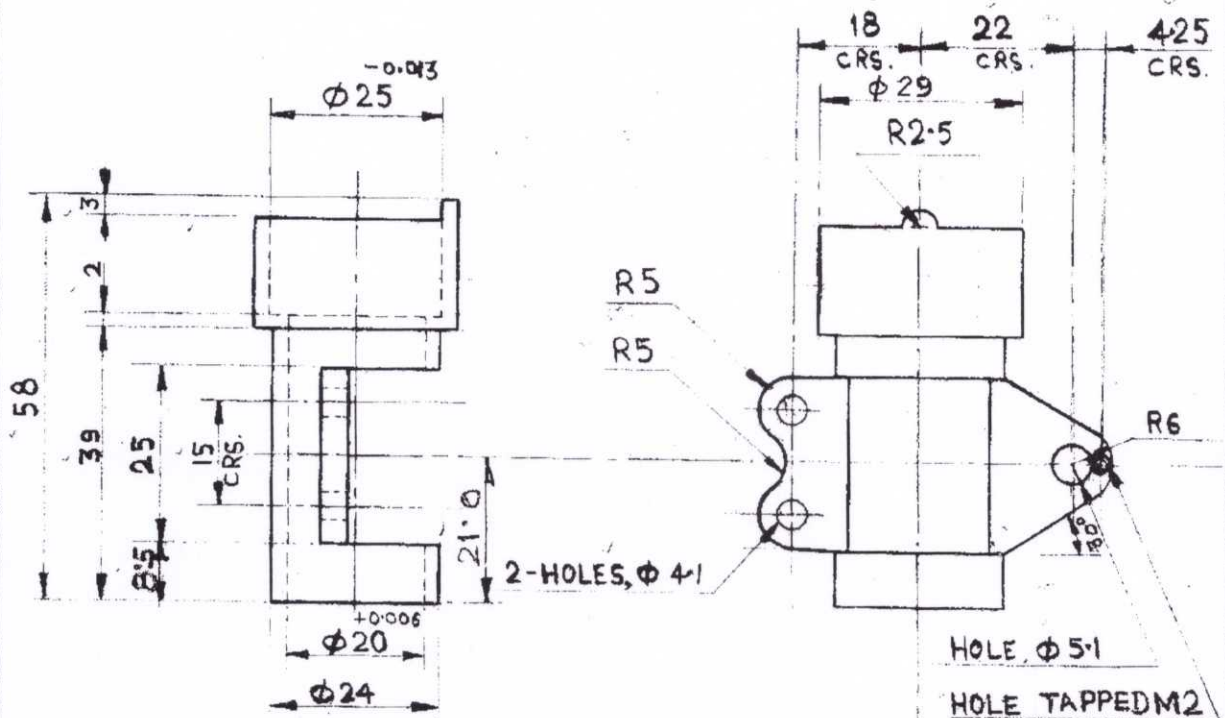
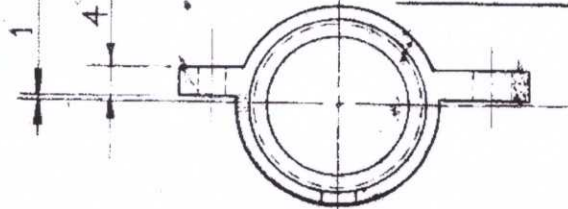

MATL :- BRASS CASTING LCB 2 OF IS: 292-1983 (REAFFIRMED 1988).

FINISH :- TO BE PAINTED WITH MATT ISC No 220
OR ISC No. 225 OF IS: 168-1973 (REAFFIRMED 1988)
EXCEPT BEARING SURFACES.

DIMENSIONS ARE IN M/M.
IMPORTANT DIMENSIONS MARKED THUS. Ⓞ
INFORMATION MARKED THUS † TO BE MARKED ON.

FOR TRADE OFF
Date of issue 26/9/21
Yairi

		DATE-29 ⁵ /97	SCALE-1:1
	DR- <i>Rakesh</i>	MATL. AS ABOVE	TREAT. AS ABOVE
	TR-	SHEETS- 1	SHT. No. 1
	CH- <i>DO</i>	DRAWING No. MCT-1518	
	APPROVED		
AMENDMENTS	<i>Jay</i> I/C D. O.		
O.F.D/DO/002		MLT WM/PL	

ORDNANCE FACTORY, DEHRADUN

ORDNANCE FACTORY, DEHRADUN

L/OUT No.

TRIPOD, FIRE CONTROL INSTRUMENT, PERISCOPE
BATTERY COMMAND, BINOCULAR 20x70, 102A.

DRG No:- IRDE 1253/4 PLUG (SMALL)

MCT-1519

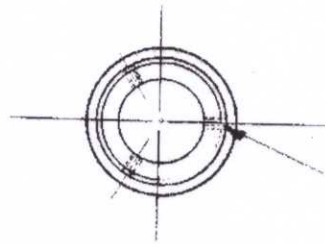

3-HOLES TAPPED M2 EQUI-SPACED AS SHOWN

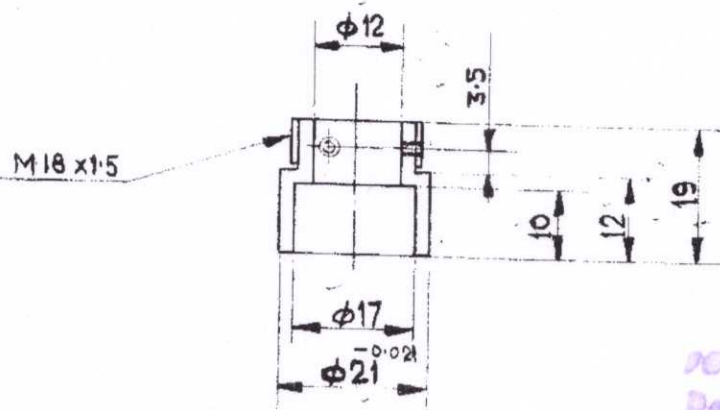

FOR TRADE USE
 Date of Issue: 26/02/23

MATL:- BRASS Gde-I HB OF IS: 319 - 1989 .

DIMENSIONS ARE IN M/M.
 IMPORTANT DIMENSIONS MARKED THUS. ⊙
 INFORMATION MARKED THUST TO BE MARKED ON.

Kaini

		DATE-29 ⁵ /97	SCALE-1:1
DR- <i>Rakesh</i>		MATL.	TREAT.
TR-		AS ABOVE	AS ABOVE
CH- <i>56</i>		SHEETS- 1	SHT. No. 1
APPROVED		DRAWING No. MCT-1519	
<i>[Signature]</i>			
I/C D. O. <i>MLTaj...</i> WM/PL			
AMENDMENTS			
OFD/DO/002			

ORDNANCE FACTORY, DEHRADUN

L/OUT No.

**TRIPOD, FIRE CONTROL INSTRUMENT, PERISCOPE
BATTERY COMMAND, BINOCULAR 20X70, 102 A**

DRG. No.
IRDE 1253/5

CLAMP, SPLIT (SMALL)

MCT-1520

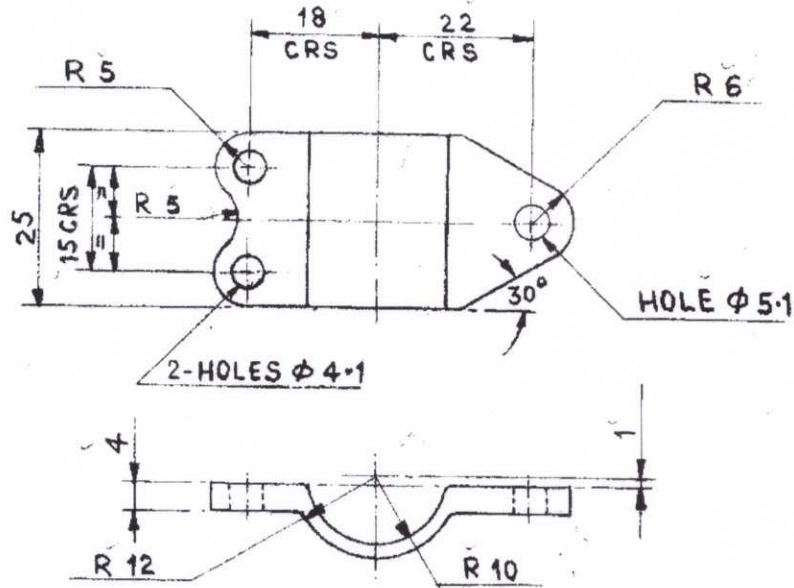

NOTE:-

SHARP EDGES TO BE ROUNDED OFF

MATL.

BRASS CASTING LCB 2 OF IS: 292-1983 (REAFFIRMED 1988)

FINISH:-

TO BE PAINTED WITH MATT ISC No 220 OR
ISC No 225 OF IS: 168-1973 (REAFFIRMED
1988) EXCEPT BEARING SURFACES

DIMENSIONS ARE IN M/M.
IMPORTANT DIMENSIONS MARKED THUS. Ⓞ
INFORMATION MARKED THUS † TO BE MARKED ON.

FOR TRADE MARK
Date of Issue 26/03/97

Kaini

	DR- <i>Chakraborty</i>	DATE-29 ⁵ /97	SCALE-1:1
	TR-	MATL. AS ABOVE	TREAT. -
	CH- <i>S.S.</i>	SHEETS- 1	SHT. No. 1
<u>AMENDMENTS</u>	<u>APPROVED</u>		<u>DRAWING No.</u> MCT-1520
<i>OFD/DO/002</i>	<i>[Signature]</i> I/C D. O.	<i>[Signature]</i> WM/PL	

ORDNANCE FACTORY, DEHRADUN

L/OUT No.

**TRIPOD, FIRE CONTROL INSTRUMENT, PERISCOPE
BATTERY COMMAND, BINOCULAR 20X70, 102 A
NUT, PLAIN, ROUND**

DRG. No.
IRDE 1253/6

MCT-1521

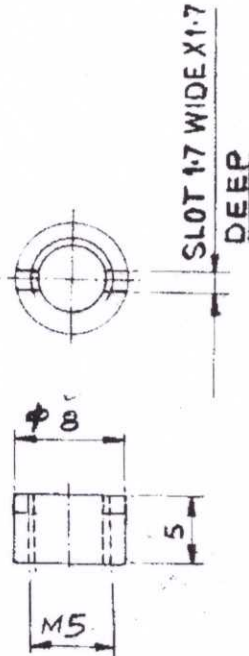

✓ MATL.

BRASS Gde I HB OF IS: 319-1989

✓ FINSH

TO BE PAINTED WITH MATT ISC No.
220 OR 225 OF IS: 168-1973 (REAFF-
IRMED 1988) EXCEPT BEARING SURFACES

FOR TRADE OEM
Date of issue: 26/07/21

Kaini

DIMENSIONS ARE IN M/M.
IMPORTANT DIMENSIONS MARKED THUS ⊙
INFORMATION MARKED THUST TO BE MARKED ON.

		DATE-29 ⁵ /97	SCALE- 2:1
	DR- <i>Adhikari</i>	MATL. AS ABOVE	TREAT. -
	TR-	SHEETS- 1	SHT. No. 1
	CH- <i>DL</i>	DRAWING No. MCT-1521	
APPROVED			
AMENDMENTS	<i>[Signature]</i> I/C D. O.		
OFD/DO/002		WM/PL	

ORDNANCE FACTORY, DEHRADUN

L/OUT No.

**TRIPOD, FIRE CONTROL INSTRUMENT, PERISCOPE
BATTERY COMMAND, BINOCULAR 20 X 70, 102 A
STOP (SMALL)**

DRG. No.
IRDE 1253/7

MCT-1522

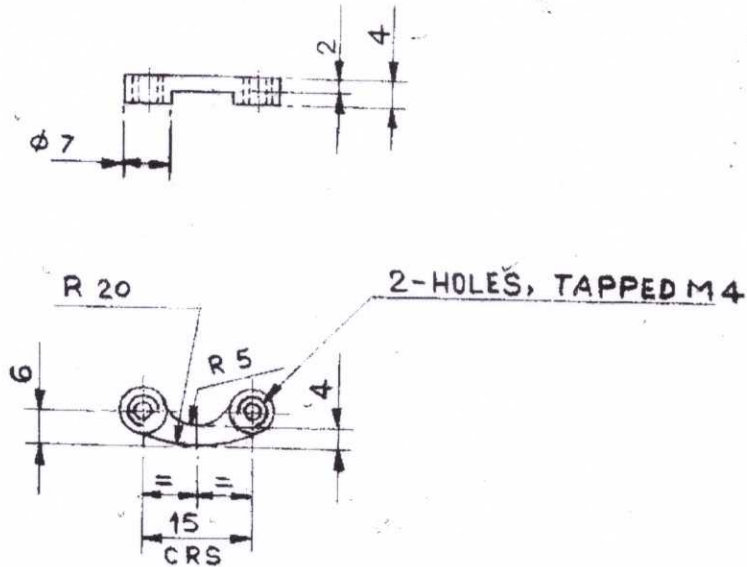

MATL.

BRASS CASTING LCB 2 OF IS: 292-1983 (REAFFIRMED 1988)

FOR TRADE OFF
Date of issue 26/03/21

FINISH:-

TO BE PAINTED WITH MATT ISC No. 220 OR
ISC No. 225 OF IS: 168-1973 (REAFFIRMED
1988) EXCEPT BEARING SURFACES

Handwritten signature

DIMENSIONS ARE IN M/M.
IMPORTANT DIMENSIONS MARKED THUS ⊙
INFORMATION MARKED THUS † TO BE MARKED ON.

		DATE-29 ⁵ /97	SCALE-1:1	
	DR- <i>Atadun</i>	MATL. AS ABOVE	TREAT. -	
	TR-	SHEETS- 1	SHT. No. 1	
	CH- <i>DE</i>	DRAWING No. MCT-1522		
AMENDMENTS	APPROVED			
OFD/DO/002	<i>[Signature]</i> I/C D. O.			<i>[Signature]</i> WM/PL

ORDNANCE FACTORY, DEHRADUN

L/OUT No.

**TRIPOD, FIRE CONTROL INSTRUMENT, PERISCOPE
BATTERY COMMAND, BINOCULAR (20X70) 102 A**

DRG. No.
IRDE 1253/8

TUBE EXTENSION (MEDIUM)

MCT-1523

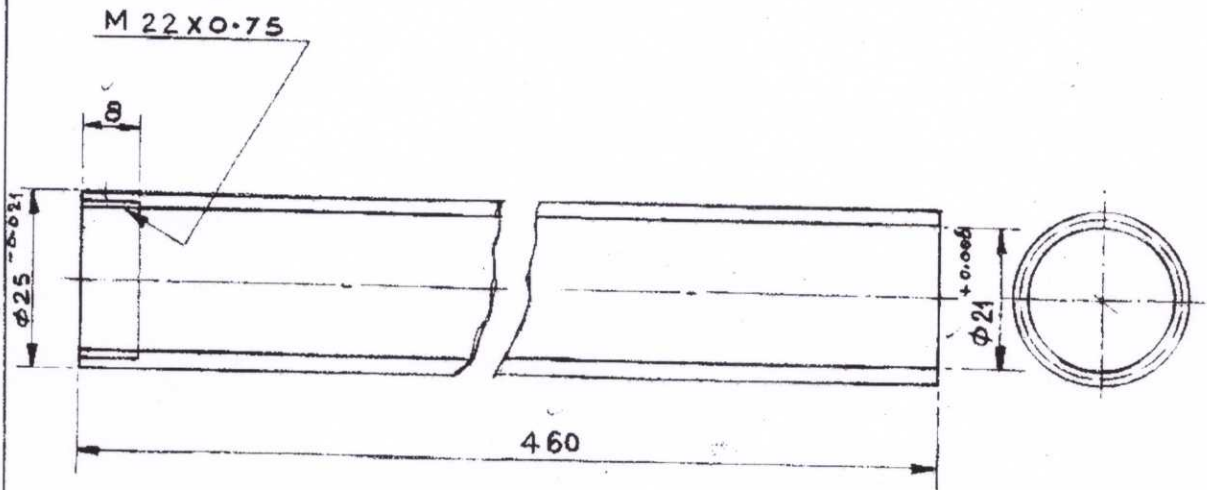

MATL.

BRASS TUBE CUZIN 37 TA OF IS:
407-1981 (REAFFIRMED 1986)

FINISH:-

BLACK BRONZED 38μ MIN.
THICKNESS TO IS: 1378-1987

FOR TRADE SHIP
Date of Issue 26/03/97

Yours

DIMENSIONS ARE IN M/M.
IMPORTANT DIMENSIONS MARKED THUS. Ø
INFORMATION MARKED THUS † TO BE MARKED ON.

		DATE-29 ⁵ /97	SCALE-1:1
	DR- <i>Chandras</i>	MATL. AS ABOVE	TREAT. -
	TR-	SHEETS- 1	SHT. No. 1
	CH- <i>Ch</i>	DRAWING No. MCT-1523	
APPROVED			
AMENDMENTS	<i>Chandras</i> I/C D. O.		
OFD/DO/002			

ORDNANCE FACTORY, DEHRADUN

L/OUT No.

**TRIPOD, F.C. INSTRUMENT, PERISCOPE,
BATTERY COMMAND, BINO. (20x70), 102A.**

Drg. No.
IRDE-1253/13

STOP (LARGE)

MCT-1524

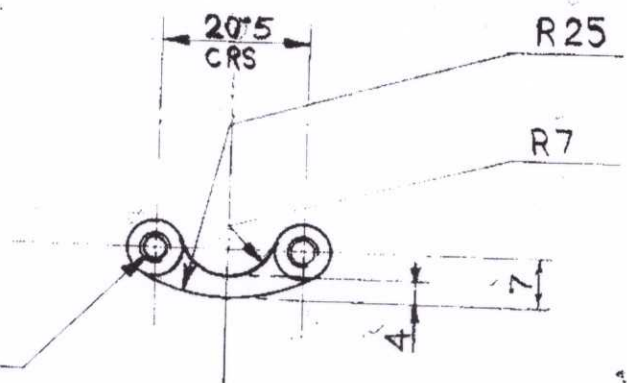
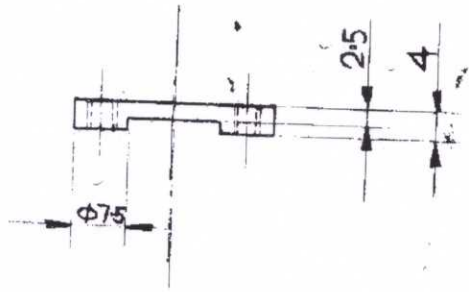

✓ 2-HOLES, TAPPED
M4

FOR TRADE SHM
Date of issue 26/07/21
Sharma

MATL. & SPECN. :- BRASS CASTING LCB2 OF IS:292-1983 (REAFFIRMED 1988)

FINISH:- TO BE PAINTED WITH MATT ISC No. 220 OR ISC No. 225 OF IS:168-1973 (REAFFIRMED 1988) EXCEPT BEARING SURFACES.

DIMENSIONS ARE IN M/M.
IMPORTANT DIMENSIONS MARKED THUS. Ⓞ
INFORMATION MARKED THUS † TO BE MARKED ON.

		DATE-29 ⁵ /97	SCALE-1:1
DR- <i>Rakesh</i>		MATL. AS ABOVE	TREAT. AS ABOVE
TR-		SHEETS- 1	SHT. No. 1
CH- <i>SG</i>		DRAWING No. MCT-1524	
APPROVED <i>[Signature]</i> I/C D. O.		ML To WM/PL	
AMENDMENTS OFD/DO/002			

ORDNANCE FACTORY, DEHRADUN

L/OUT No.

TRIPOD, F.C. INSTRUMENT, PERISCOPE,
BATTERY COMMAND, BINO. (20x70), 102A.
TUBE

Drg. No.
IRDE-1253/14

MCT-1525

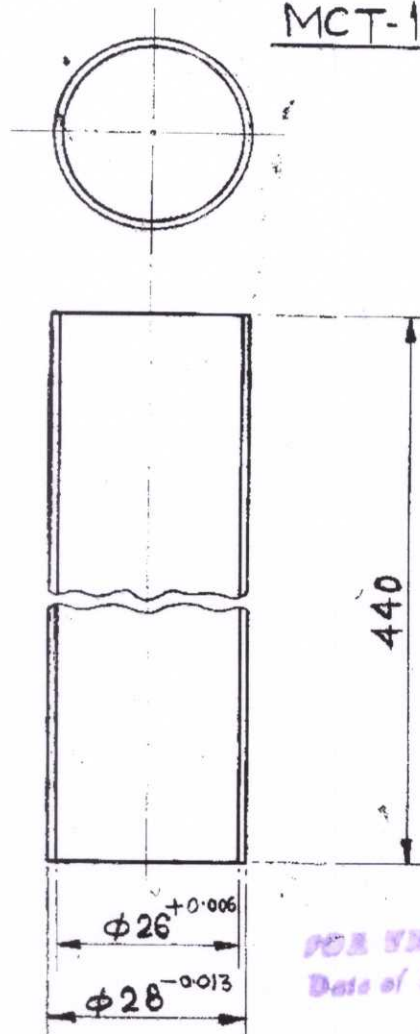

FINISH:- TO BE PAINTED WITH MATT
ISC No. 220 OR ISC No. 225
OF IS:168-1973 (REAFFIRMED
1988) EXCEPT BEARING
SURFACES.

FOR TRADE COPY
Date of issue 26/07/21
Kaini

MATE & SPECN. :- BRASS
TUBE CuZn37 TA OF IS:407-1981
(REAFFIRMED 1986)

DIMENSIONS ARE IN M/M.
IMPORTANT DIMENSIONS MARKED THUS. Ⓞ
INFORMATION MARKED THUST TO BE MARKED ON.

		DATE-29 ⁵ / ₉	SCALE- 1:1
	DR-	MATL.	TREAT.
	TR-	AS ABOVE	AS ABOVE
	CH- <i>58</i>	SHEETS- 1	Sheet No. 1
AMENDMENTS		APPROVED	
OFD/DO/002		DRAWING NO.	
		MCT-1525	
		M.L. T. <i>WM/PL</i>	
		V.C.D. O.	

L/OUT No.

TRIPOD, FIRE CONTROL INSTRUMENT, PERISCOPE BATTERY COMMAND BINOCULAR 20x70, 102A

DRG. No

IRDE 1253/15

PIVOT

MCT-1526

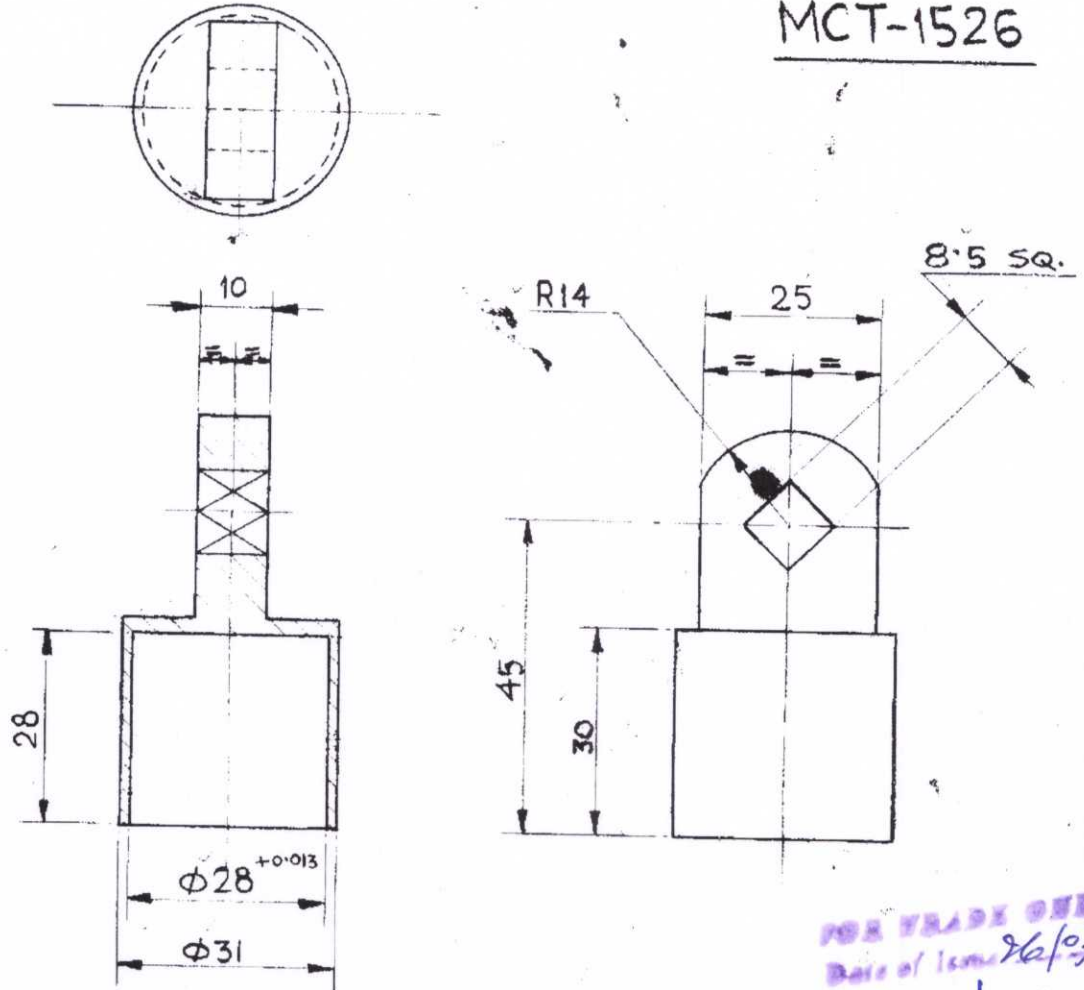

FOR TRADE USE
Date of Issue 26/07/21
Xaini

MATL: - BRASS Gde-I HB OF IS: 319 - 1989

FINISH: - TO BE PAINTED WITH MATT ISC 220 OR ISC 225 OF IS: 168-1975 (REAFFIRMED-1988) EXCEPT BEARING SURFACES.

DIMENSIONS ARE IN M/M.
IMPORTANT DIMENSIONS MARKED THUS ⊙
INFORMATION MARKED THUS † TO BE MARKED ON.

		DATE- 29 ⁵ / ₃₇	SCALE- 1:1
DR- <i>Baksh</i>		MATL. AS ABOVE	TREAT. AS ABOVE
TR-		SHEETS-	SHT. No.
CH- <i>gk</i>		DRAWING No. MCT-1526	
APPROVED			
<i>[Signature]</i> I/C D. O.			
AMENDMENTS			
OFD/DO/002			

ORDNANCE FACTORY, DEHRADUN

L/OUT No.

**TRIPOD, FIRE CONTROL INSTRUMENT, PERISCOPE
BATTERY COMMAND, BINOCULAR 20x70 102A.**

DRG. No.:-
IRDE 1253/17

BOLT, SHOULDER, SPECIAL

MCT-1528

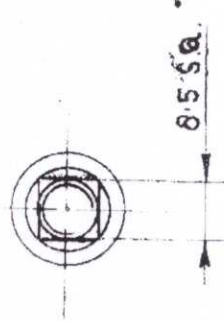

M8x1

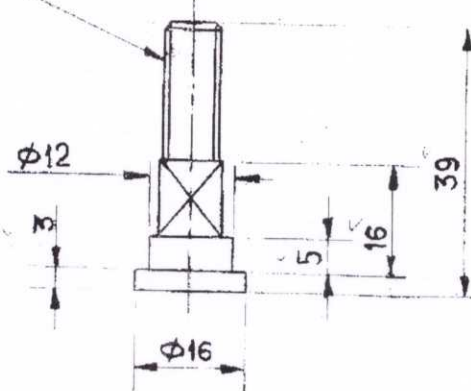

FOR TRADE OFF
Date of Issue 26/07/24

Khins

MATL :- BRASS Gde-I HB OF IS: 319 - 1989 .

FINISH :- TO BE PAINTED WITH MATT ISC NO. 220 OR ISC 225 OF IS: 168 - 1973 (REAFFIRMED - 1988) EXCEPT BEARING SURFACES.

DIMENSIONS ARE IN M/M.
IMPORTANT DIMENSIONS MARKED THUS ⊗
INFORMATION MARKED THUS † TO BE MARKED ON.

		DATE-30 ⁵ /97	SCALE-1:1
	DR- <i>Raksh</i>	MATL.	TREAT.
	TR-	AS ABOVE	AS ABOVE
	CH- <i>DB</i>	SHEETS-	SHT. No.
		APPROVED	
AMENDMENTS		DRAWING No. MCT-1528	
OFD/DO/002			
<i>[Signature]</i> I/C D. O.		<i>[Signature]</i> WM/PL	

ORDNANCE FACTORY, DEHRADUN

L/OUT No.

TRIPOD, F.C. INSTRUMENT, PERISCOPE,
BATTERY COMMAND, BINO. (20x70), 102A.
WASHER

DRG. No.
IRDE-1253/18

MCT-1529

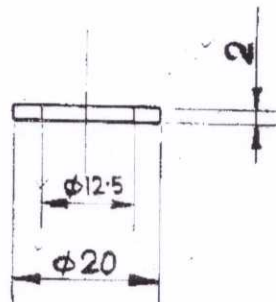
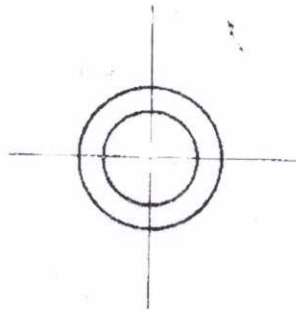

FOR TRADE USE
Date of Issue 26/07/21

Kaini

MATL :- BRASS SHEET TO IS: 3487 - 1966 .

DIMENSIONS ARE IN M/M.
IMPORTANT DIMENSIONS MARKED THUS. ϕ
INFORMATION MARKED THUS† TO BE MARKED ON.

	DR- <i>Rakesh</i>	DATE-30 ⁵ /07	SCALE-1:1
	TR-	MATL. AS ABOVE	TREAT. -
	CH- <i>SL</i>	SHEETS- 1	SHT. No. 1
AMENDMENTS	APPROVED	DRAWING No.	
OFD/DC/002	<i>[Signature]</i> MCT-1529	MCT-1529	

ORDNANCE FACTORY, DEHRADUN

ORDNANCE FACTORY, DEHRADUN

L/OUT No.

**TRIPOD FIRE CONTROL INSTRUMENT PERISCOPE
BATTERY COMMAND BINOCULAR 20x70 102A**

DRG No: - IRDE 1253/19

WASHER

MCT-1530

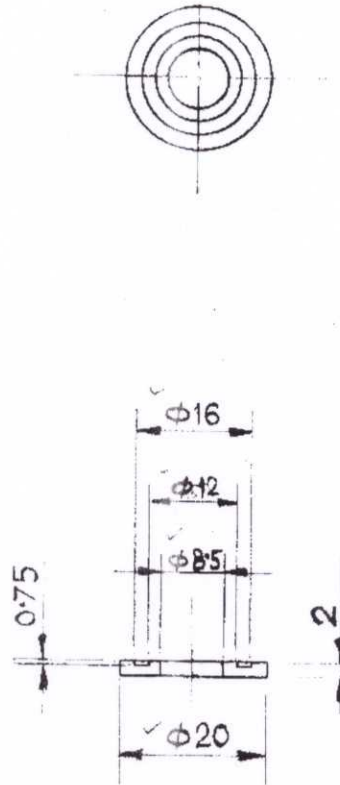

FOR TRADE OFFICE
Date of Issue 16/05/97

Kumar

MATL :- BRASS SHEET TO IS: 3487 -1966

DIMENSIONS ARE IN M/M.
IMPORTANT DIMENSIONS MARKED THUS. ©
INFORMATION MARKED THUST TO BE MARKED ON.

		DATE-30 ⁵ /97	SCALE-1:1
		MATL AS ABOVE	TREAT. -
		DR- Rakesh	SHEETS- 1
		TR-	SHT. No. 1
		LH- <i>SE</i>	
AMENDMENTS		APPROVED	
OFD/DO/002		<i>[Signature]</i> I/C D. O.	<i>[Signature]</i> WM/PL
		DRAWING No. MCT-1530	

ORDNANCE FACTORY, DEHRADUN

L/OUT No.

TRIPOD, F.C. INSTRUMENT, PERISCOPE,
BATTERY COMMAND, BINO. (20x70), 102A.

DRG. No.
IRDE-1253/20

WASHER

MCT-1531

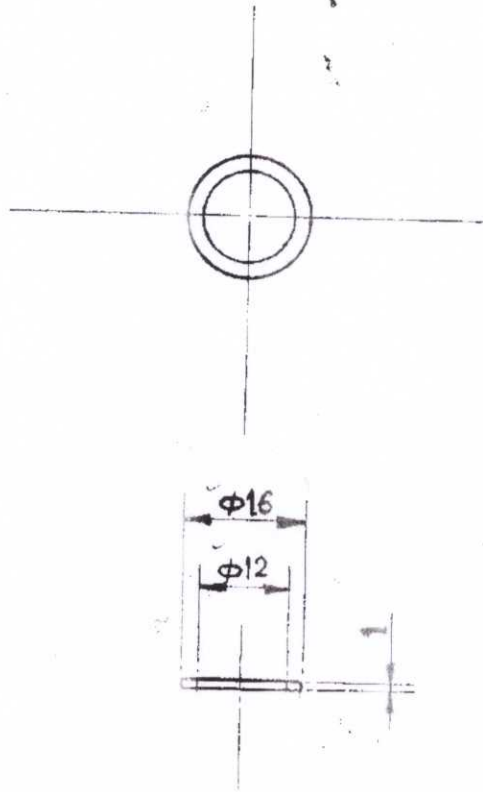

FOR TRADE USE
Date of Issue: 26/07/97

Handwritten signature

MATL &
SPECN. :- BRASS SHEET TO IS: 3487-1966.

DIMENSIONS ARE IN M/M.
IMPORTANT DIMENSIONS MARKED THUS Ⓞ
INFORMATION MARKED THUS † TO BE MARKED ON.

		DATE-30 ⁵ /97	SCALE- 1:1
DR- <i>Revised</i>		MATL.	TREAT.
TR-		AS ABOVE	-
CH- <i>52</i>		SHEETS- 1	SHT. No. 1
		APPROVED	
AMENDMENTS		DRAWING No.	
OFD/DO/002		MCT-1531	
I/C D. O.		<i>Handwritten initials</i> WM/PL	

TRIPOD, FIRE CONTROL INSTRUMENT, PERISCOPE
BATTERY COMMAND, BINOCULAR 20X70, 102A

DRG. No.:-

IRDE 1253/23

PIN, HOLDER, HEADLESS

MCT-1532

ORDNANCE FACTORY, DEHRADUN

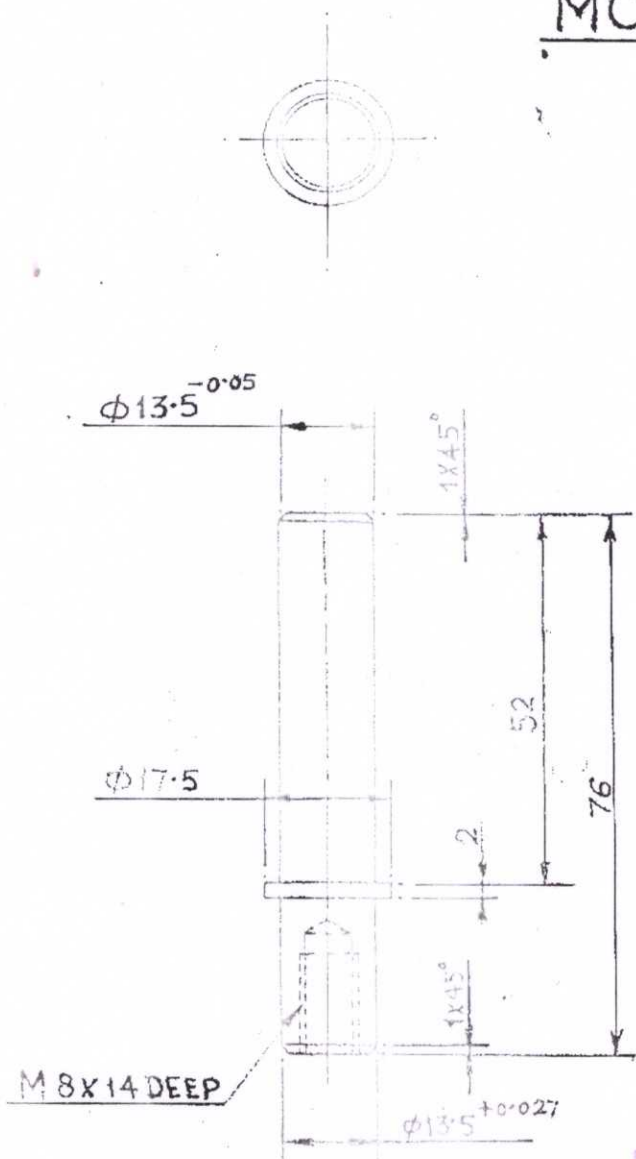

MATL:- BRASS, Gde-I HB OF IS: 319 - 1989.

FOR TRADE OMM
 Date of Issue 26/07/21

Kauri

DIMENSIONS ARE IN M/M.
 IMPORTANT DIMENSIONS MARKED THIS @
 INFORMATION MARKED THIS † TO BE MARKED ON.

	DR- Kauri	DATE-30/5/97	SCALE-1:1
	IR	MATL. AS ABOVE	TREAT.
	IR	SHEETS- 1	SHT. No. 1
AMENDMENTS	APPROVED	DRAWING No.	
OFD/DO/002	VE D. O. WVR/PL	MCT-1532	

THIRD ANGLE PROJECTION



IF IN DOUBT 'ASK'

MCT-1533

WEB, THICK, 0. G. 25 WIDE X 83 (CAT/PT No. H2/8305 - 000265) TO BE STITCHED WITH IRDE 1253/14 AFTER ASSY. AT SUITABLE PLACE

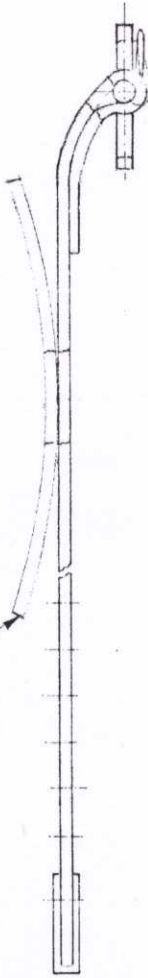

BUCKLE & LOOP QUICK RELEASE, BRASS 25 (TO BE STITCHED WITH WEB AS SHOWN) CAT./PT. No. M3/8315-000035 - - - - - 1

TIP BRASS 25 (CAT/PART No. CN/8315-000061) - - - - - 1

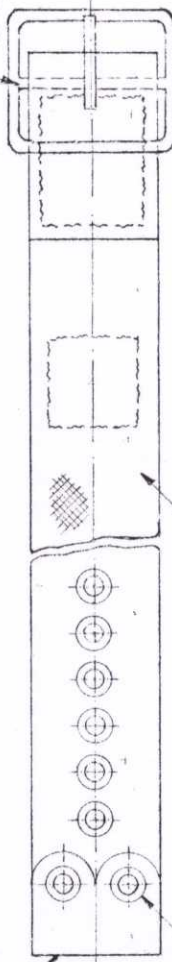

WEB, THICK, 0. G. 25 WIDE X 308 - - - - - 1 (CAT./PART No. H2/8305-000265)

EYE LET BRASS (CAT./PART No. CN/8315-000048) - - - - - 8

FOR TRADE USE
Date of Issue 26/01/21
K. Srinivas

TRIPOD, F. C. INSTRUMENT, PERISCOPE.
BATTERY COMMAND, BINO. (20x70) 102A.
STRAP, WEBBING.

DRG. No. IRDE-1253/24

DRG. No.	MCT-1533
DATE	26/01/21
SCALE	1:1
TREAT	AS ABOVE
SHT. NO. 1	1
SHT. NO. 2	1
SHT. NO. 3	1
SHT. NO. 4	1
SHT. NO. 5	1
SHT. NO. 6	1
SHT. NO. 7	1
SHT. NO. 8	1
SHT. NO. 9	1
SHT. NO. 10	1
SHT. NO. 11	1
SHT. NO. 12	1
SHT. NO. 13	1
SHT. NO. 14	1
SHT. NO. 15	1
SHT. NO. 16	1
SHT. NO. 17	1
SHT. NO. 18	1
SHT. NO. 19	1
SHT. NO. 20	1
SHT. NO. 21	1
SHT. NO. 22	1
SHT. NO. 23	1
SHT. NO. 24	1
SHT. NO. 25	1
SHT. NO. 26	1
SHT. NO. 27	1
SHT. NO. 28	1
SHT. NO. 29	1
SHT. NO. 30	1
SHT. NO. 31	1
SHT. NO. 32	1
SHT. NO. 33	1
SHT. NO. 34	1
SHT. NO. 35	1
SHT. NO. 36	1
SHT. NO. 37	1
SHT. NO. 38	1
SHT. NO. 39	1
SHT. NO. 40	1
SHT. NO. 41	1
SHT. NO. 42	1
SHT. NO. 43	1
SHT. NO. 44	1
SHT. NO. 45	1
SHT. NO. 46	1
SHT. NO. 47	1
SHT. NO. 48	1
SHT. NO. 49	1
SHT. NO. 50	1

आयुध निर्माणा	ORDNANCE FACTORY
देहरादून	DEHRADUN
अनुमोदित	APPROVED
मल्टी	MULTI
सहस्र	THOUSAND
रुपये	RUPEES

ORDNANCE FACTORY, DEHRADUN

L/OUT No.

**TRIPOD, F.C. INSTRUMENT, PERISCOPE,
BATTERY COMMAND, BINO. (20 x 70), 102A.
LEVER**

Drg. NO.
CH-698

MCT-1534

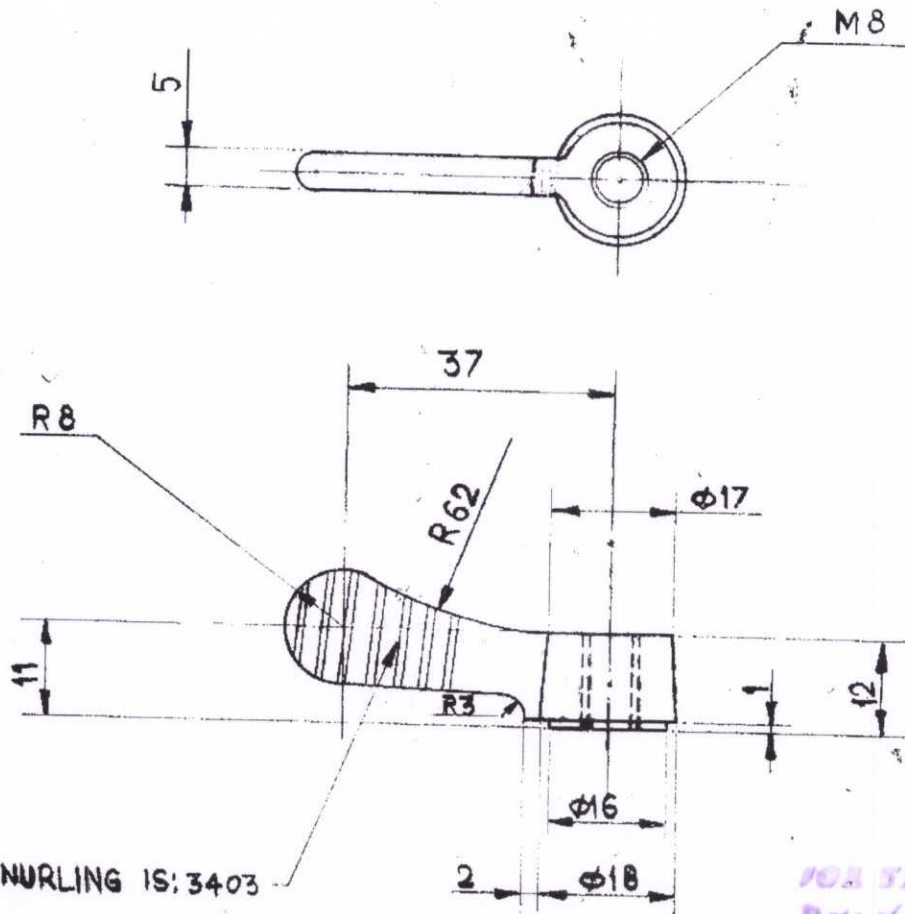

STRAIGHT KNURLING IS: 3403

FOR TRADE ONLY
Date of Issue 26/2/21

Kaini

MATL:- BRASS CASTING LCB 2 OF IS: 292-1983 (REAFFIRMED 1988)

FINISH:- TO BE PAINTED WITH MATT ISC No 220 OR ISC 225 OF IS: 168-1973 (REAFFIRMED 1988) EXCEPT BEARING SURFACES.

DIMENSIONS ARE IN M/M.
IMPORTANT DIMENSIONS MARKED THUS Ø
INFORMATION MARKED THUS † TO BE MARKED ON.

	DR- <i>Rakesh</i>	DATE-30 ⁵ /97	SCALE-1:1
	TR-	MATL. AS ABOVE	TREAT. AS ABOVE
	CH- <i>5/6</i>	SHEETS- 1	SHT. No. 1
AMENDMENTS	APPROVED	DRAWING No. MCT-1534	
OFD/DO/002	<i>[Signature]</i> I/C D. O.		
	<i>Mh. J. [Signature]</i> WM/PL		

**TRIPOD FIRE CONTROL INSTRUMENT PERISCOPE
BATTERY COMMAND BINO (20x70) 102 A.**

DRG. No. :-

IRDE 1253/9

CLAMP SPLIT (LARGE)

जुगाड़कानाम

TITLE OF

संक्रिया

OPERATION

THIRD ANGLE PROJECTION

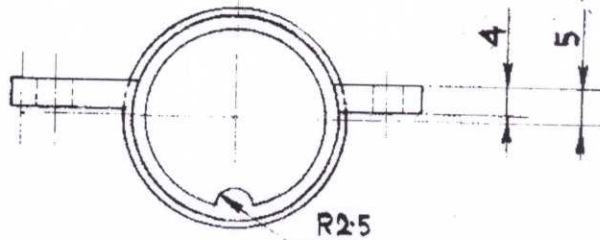

MCT-1535

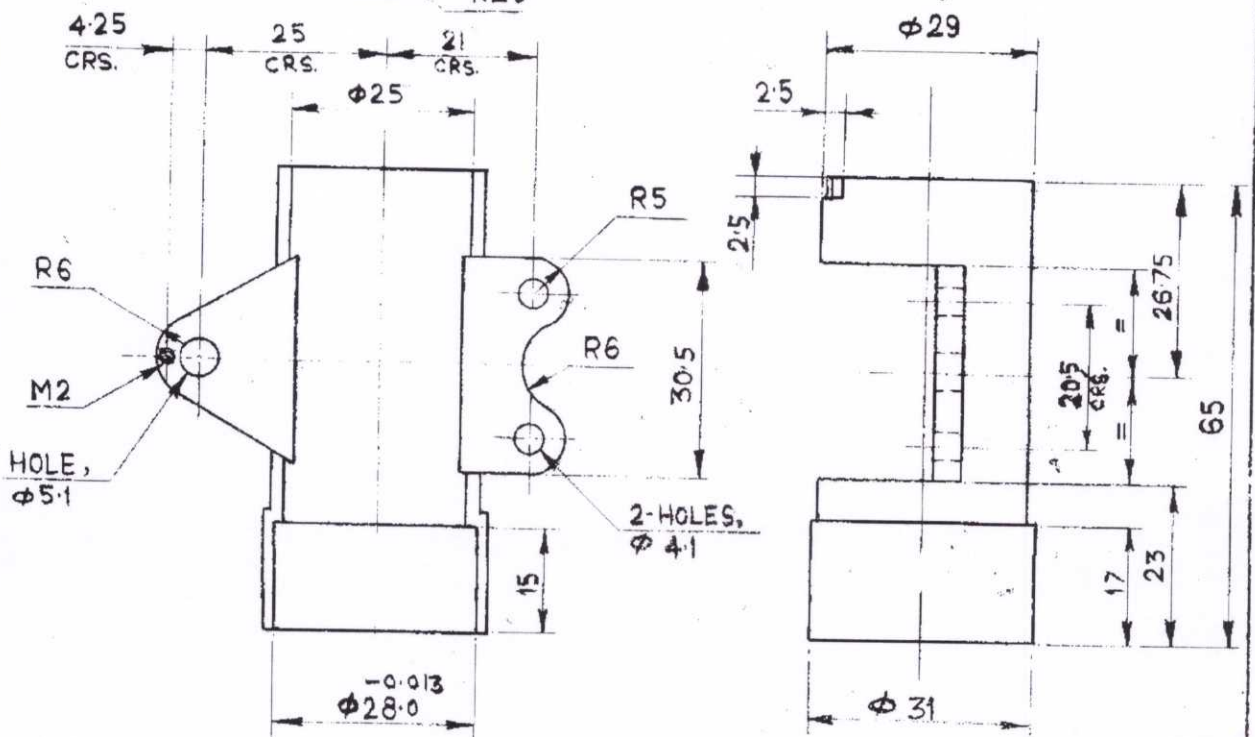

MATL. :-

BRASS CASTING LCB2 OF IS: 292-1983 (REAFFIRMED 1988)

FINISH :-

TO BE PAINTED WITH MATT ISC No. 220 OR ISC No. 225 OF IS: 168-1973 (REAFFIRMED 1988) EXCEPT BEARING SURFACES.

DIMENSIONS ARE IN M/M

IMPORTANT DIMENSIONS MARKED THUS ⊕

INFORMATION MARKED THUS TO BE MARKED ON

	प्रारं. DR- <u>Rokesh</u>	दि. 2-6-97	पैमाना SCALE 1:1
	अनुरे. TR-	धातु/स्वामणी MATL AS ABOVE	व्यवहार TREAT -
	पड़ता. CH-	SHEETS	SHEET No.
AMENDMENTS OF D/DG, 002	अनुमोदित APPROVED	ऐस्वाचित अनुक्रमिक DRAWING No MCT-1535	

आयुध निर्माजी देहरादून
ORDNANCE FACTORY, DEHRADUN

FOR TRADE SEM
Date of Issu. 26/6/77
Kainu

**TRIPOD, F.C. INSTRUMENT, PERISCOPE, BATTERY
COMMAND BINO (20x70), 102 A.**

DRG. No. :- IRDE 1253/11

CLAMP SPLIT (LARGE)

जुगाड़कानाम TITLE OF

संख्या OPERATION

THIRD ANGLE PROJECTION

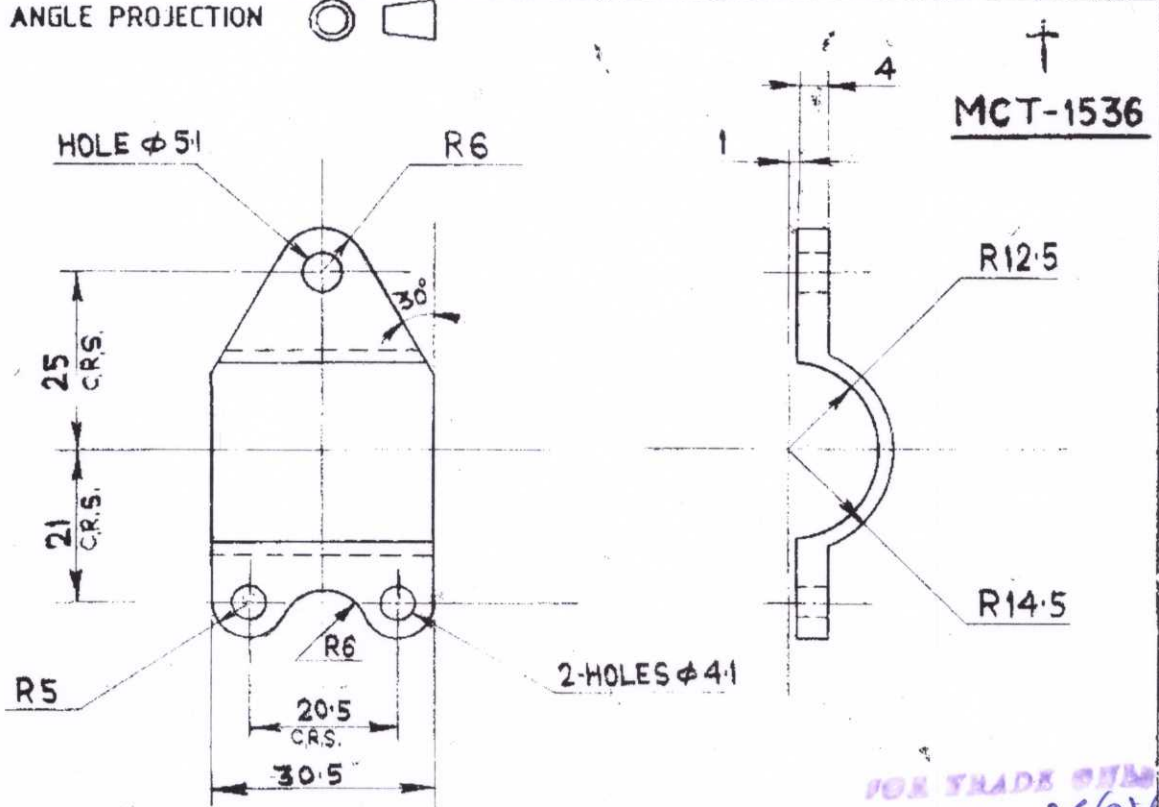

FOR TRADE SHIP
Date of Issue 26/07/97
Xuina

FINISH :- TO BE PAINTED WITH MATT ISC NO 220 OR ISC NO. 225 OF IS: 168-1973 (REAFFIRMED 1988) EXCEPT BEARING SURFACES.

NOTE :- SHARP EDGES TO BE ROUNDED OFF.

MATL. & SPECN.

:- BRASS CASTING LCB 2 OF IS: 292-1983 (REAFFIRMED 1988.)

DIMENSIONS ARE IN M/M

IMPORTANT DIMENSIONS MARKED THUS ⊕

INFORMATION MARKED THUS ⊕ TO BE MARKED ON

	डि. 2-6-97	रेखांक SCALE 1:1
	डि. / सामग्री MATT	आवृत्ति TREAT.
	अनुरे. TR-	AS ABOVE
	पड़ता. CH-	SHEETS 1 SHEET No. 1
	अनुमोदित APPROVED	रेखांकित अनुक्रमिक DRAWING No
AMENDMENTS OF D/DO/002	<i>[Signature]</i> V.C. DO.	MCT-1536
	<i>[Signature]</i> M.L. Tapr WM/PL	

आयुध निर्माणी बेहरादून
ORDNANCE FACTORY, DEHRADUN

TRIPOD, F.C. INSTRUMENT, PERISCOPE

BATTERY COMMAND. BINO (20X70)102A

DRG
No

IRDE-1253/10

PLUG (LARGE)

जुगाड़कानाम TITLE OF

संक्रिया OPERATION

THIRD ANGLE PROJECTION



MCT 1541

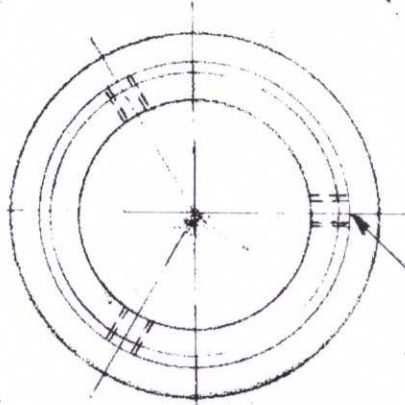

3 HOLES, TAPPED
M2 EQUI-SPACED
AS SHOWN

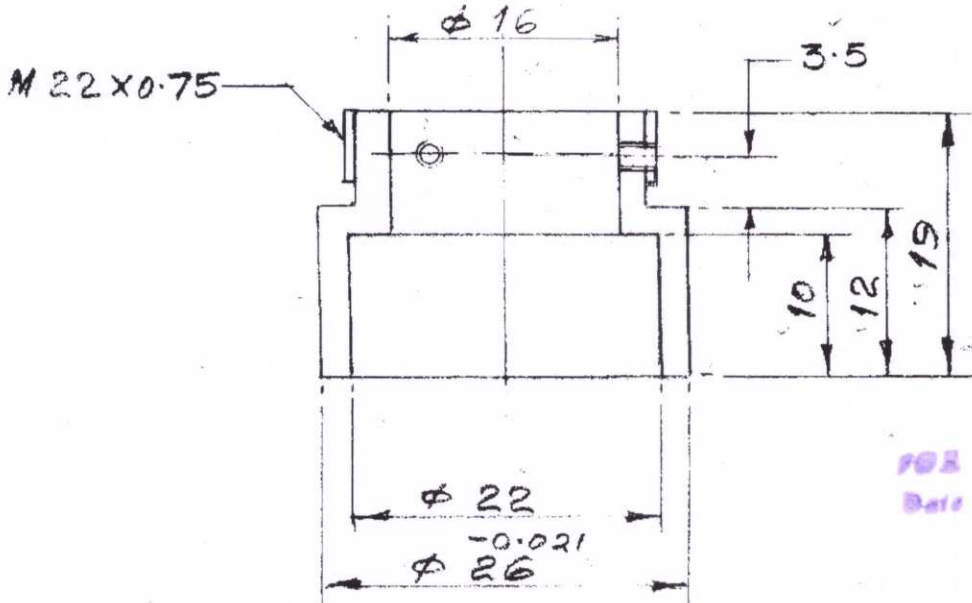

FOR TRADE COPY
Date of Issue 26/07/71

Handwritten signature

MATL & SPECN:- BRASS, Gde I HB OF IS:319-1989

FINISH:- CLEAN

DIMENSIONS ARE IN M/M

IMPORTANT DIMENSIONS MARKED THUS ⊕

INFORMATION MARKED THUS TO BE MARKED ON

	प्रारं. DR- <i>MLT</i>	दि. 3-6-97	पैमाना SCALE 2:1
	अनुरे. TR-	धातु/सामग्री MATL AS ABOVE	व्यवहार TREAT.
	पड़ता. CH-	SHEETS 1	SHEET No. 1
	अनुमोदित APPROVED	रेखाचित्र अनुक्रमांक DRAWING No	
AMENDMENTS OF D/DO/002	<i>Handwritten signature</i> K.S.D.	MLT WM/PL	MCT-1541

आयुध निर्माणी देहरादून
ORDNANCE FACTORY, DEHRADUN

TRIPOD, F.C. INSTRUMENT, PERISCOPE BATTERY COMMAND BINO. (20X70) 102A

DRG. No

IRDE-1253/12

SCREW, M/C. SPECIAL

जुगाड़का नाम

TITLE OF

सक्रिया

OPERATION

THIRD ANGLE PROJECTION



+

MCT 1542

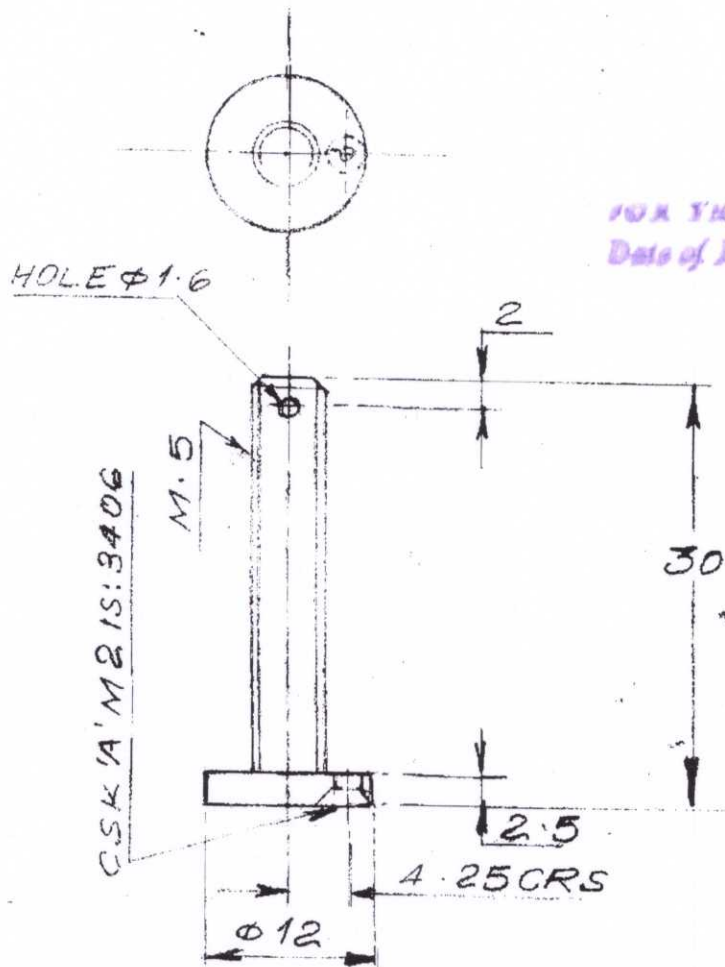

FOR TRADE USE

Date of Issn: 26/04/11

Kaini

आयुध निर्माणी देहरादून
ORDNANCE FACTORY, DEHRADUN

MATL & SPECKI - BRASS Gde I HB OF IS: 319-1989

FINISH:- CLEAN

DIMENSIONS ARE IN M/M

IMPORTANT DIMENSIONS MARKED THUS ⊕

INFORMATION MARKED THUS TO BE MARKED ON

	दि. 3-6-97 DT.	समान SCALE 2:1
प्रा. DR- <i>M. Singh</i>	धातु/साजगी MATL AS ABOVE	व्यवहार TREAT.
अनुरे. TR-	SHEETS 1	SHEET No. 1
पड़ता. CH-	अनुमोदित APPROVED	रेखाचित्र अनुक्रमांक DRAWING No
AMENDMENTS	<i>[Signature]</i> VC DO.	MCT. 1542
OFD/DO/002	M.L. Top WM/PL	