

VETTED BY: *[Signature]*
I/C QM.

D.C. (I) :- 0454-I(P), 1939-I, 2929-I, 3511-I, 6105-I

POLYESTER NEGATIVE PREPARED AT CQA(I)D.DUN
PREPARED BY: *[Signature]*
CHECKED BY: *[Signature]* DATE: *[Date]*

FOR EXPLANATION OF DIMENSIONING ETC., SEE CQA(1)GULDI: NO.001-1997,
THIRD ANGLE PROJECTION. DIMENSIONS ARE IN MILLIMETRES

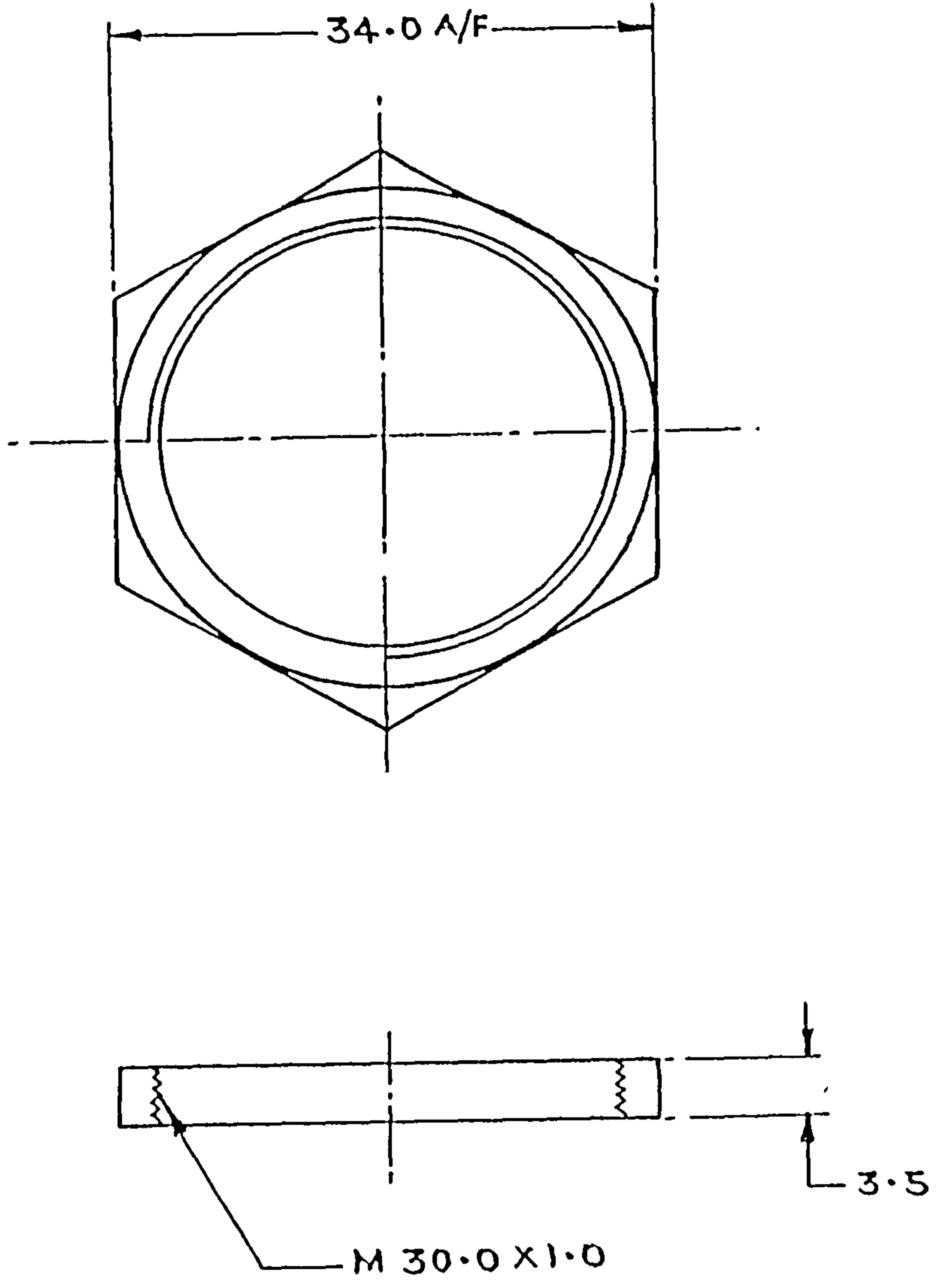

D.C. - 6105-I - POLY NEG PREPARED & NEW COPY SEALED IN SUPERSESSION OF EXISTING ONE		13.4.96	DRAWN	TRACED	APPROVED
(b) D.C. (I) :- 3511-I. NOM. & CAT./PT. No. AMENDED.	Sd/-	17.12.75	CHECKED		FOR DIRECTOR IRDE DEHRADUN
(a) D.C. (III) :- 2929-I. CAT./PT. No. 105 3694 ADDED.	Sd/-	23.7.74		Sd/-	
D.C. (I) :- 1939-I. DRG. SEALED.	Sd/-	26.11.69	SCALE: -2:1		DATE: -22.4.68
D.C. (III) :- 0454-I(P). DRG. PROV. SEALED.	Sd/-	12.7.69	DRG. No.		
AMENDMENTS	SIG.	DATE	IRDE 335/52		
MATL: -BRASS, Gde HT-2 COND.M OF IS:320-1980			CAT./PART No. (a)(b)		
FINISH: -BRONZED BLACK DULL TO IS:1378-1975			5310-003245		
(b) NUT, PLAIN, HEXAGON			SHEETS SHEET		